

140mm

Product Structure

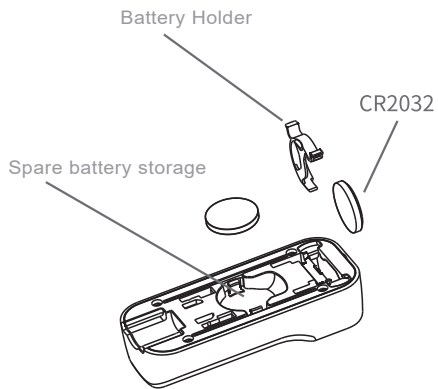
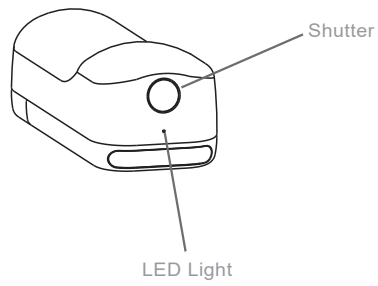

Product feature:

The product is used by Bluetooth. It supports most of mobile phones models to remote shutter and taking photo

Specification

Model: CT13032
 Item No.: XXXX
 Range: 10M
 Function: Photograph
 Battery: CR2032 button cell
 Phone holder support 4.5-6inch mobile phone

Instruction

1. Long press shutter button 3 seconds and blue LED light would flash, then set your phone on Bluetooth and would find "Shutter Camera" to link your phone.
2. you could open phone camera to take photo after successfully link

FCC Statement:

This device complies with Part 15 of the FCC Rules. Operation is subject to the following two conditions: (1) This device may not cause harmful interference, and (2) This device must accept any interference received, including interference that may cause undesired operation.

Warning:

Changes or modifications not expressly approved by the party responsible for compliance could void the user's authority to operate the equipment.

FCC ID : 2ABHA0079
MADE IN CHINA



120mm

Front

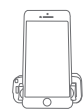
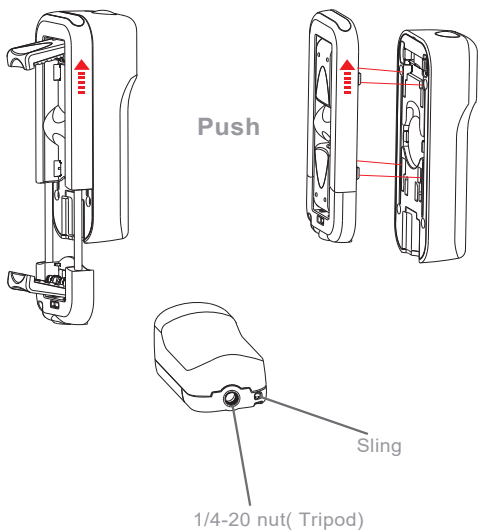

Desktop

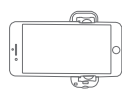

Handheld



Phone holder
Large 6cm max

**Smartphone
Photography Kit**

It provides a much better user experience

Mobile Shutter Grip



Photograph

Back