

55mm

70mm

TRUE WIRELESS EARBUDS

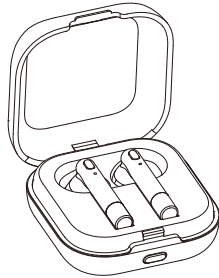

QUICK START GUIDE

FCC ID: 2ABHA0069

GETTING STARTED

- ① Micro USB charging port
- ② Charging Case LED indicators
- ③ Left earbud LED indicator
- ④ Left control button
- ⑤ Right earbud LED indicator
- ⑥ Right control button
- ⑦ Left Mic
- ⑧ Right Mic
- ⑨ Charging Case Power Button (For checking capacity only)

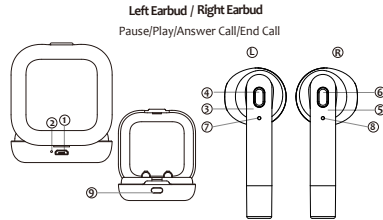

CHARGING YOUR CASE

- Charge the charging case, with the included micro-USB cable for 1.5 hours. The LED indicator flash red during charging and solid red after fully charged
- Do not charge longer than suggested time. Do not charge overnight.*

CHARGING YOUR EARBUDS

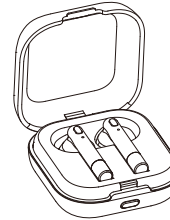

- Place Right and Left Earbuds in charging case
- Charging case LED indicator (2) will illuminate Blue and the earbud LED indicators (3, 5) will illuminate Red, indicating that the earbuds are charging properly. When Earbuds LEDs (3, 5) turn off, earbud batteries are fully charged.

MONO MODE (SINGLE EARBUD USE)

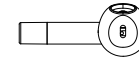

- Remove earbud from charging case
- Once earbud is powered on, It will automatically proceed to **PAIRING**

STEREO MODE (DUAL EARBUD USE)

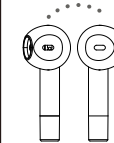

- Remove both earbuds from charging case and hold close each other
- Earbuds will automatically link together after a few seconds and you will hear an alert tone. One of the earbuds will flash red and blue, the other earbud will turn off LED indicator.

Note: If the earbuds do not automatically pair after 20 seconds, double press the control button of one earbuds to make both earbuds pair with it.

- Once Earbuds are linked together you may proceed to pairing with your mobile device.

Note: If you attempt to pair before the earbuds have paired to each other, the earbuds will go into single earbud use. In this case, restart the process (Select forget device from your Bluetooth List). Once they are paired successfully, the indicator of one earbuds will turn off.

Front

PAIRING

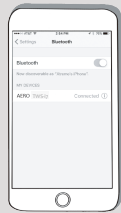

- Enable Bluetooth search mode on your mobile device and search for pairing name “ True Wireless headset” and select it on your mobile phone. Once the earbuds are successfully paired, a notification will sound .
- Now you can enjoy your true wireless Bluetooth Earbuds.

*Note: Once earbuds have been initially paired successfully with your mobile device, they will automatically pair the next time they are powered on.

OPERATING BLUETOOTH EARBUDS

Model: SL353
Item No.: 2443
Capacity(Cradle): 300mAh / 3.7V (1.11Wh)
Capacity(Earbuds): 35mAh / 3.7V (0.1295Wh)
Input of earbuds: 5V / 60mA
Input of Cradle: 5V / 250mA

Function	Operation
Power On	Press (4) or (6) for 3 seconds or remove the earbuds from charging case
Power Off	Press (4) or (6) for 5 seconds or place the earbuds in the charging case
Play/Pause	Single press (4) or (6)
Answer	Single press (4) or (6)
Reject	Press (4) or (6) for 2 seconds
Recall	Double (4) or (6)
Earbuds	LED indications (3) & (5)
Power On	Red and Blue LED will flash alternately
Link Mode	Flashing Blue + Red
Two earbuds paired successfully each other	One earbuds will flash red and blue, another earbuds will turn off LED indicator.
Paired Successfully	LED Off
Power Off	LED Off
Earbuds in Cradle	
Charging	Flash Red
Fully Charged	Solid Red
Charging Case	See CHARGING YOUR CASE

FCC STATEMENT

This device complies with Part 15 of the FCC Rules. Operation is subject to the following two conditions:
(1) This device may not cause harmful interference, and
(2) This device must accept any interference received, including interference that may cause undesired operation.

Warning:
Changes or modifications not expressly approved by the party responsible for compliance could void the user's authority to operate the equipment.

- This device complies with Part 18 of the FCC Rules
 - The interference potential of the device or system.
 - Maintenance of the system.
 - Simple measures that can be taken by the user to correct interference.
 - For RF lighting devices, provide an advisory statement, either on the product packaging or with other user documentation, similar to the following:
This product may cause interference to radio equipment and should not be installed near maritime safety communications equipment or other critical navigation or communication equipment operating between 0.45-30 MHz.
- The Bluetooth® word mark and logos are registered trademarks owned by Bluetooth SIG, Inc. and any use of such marks by (Shenzhen C-Star Electronic Tech. Co., Ltd.) is under license. Other trademarks and trade names are those of their respective owners.

Troubleshooting

Problem	Reason	Solution
One earbuds is working but no sound in double earbuds use	Two earbuds has not paired successfully each other before paired phone	Clear the connecting record of device and follow the instruction to repair again
No sound after pairing	Incorrect pairing	Try pairing process again
No indicator during charging	Earbuds positioned into cradle incorrectly	Readjust earbuds in cradle until indicator glows
Automatic shut down	Low battery	Charge earbuds and
Noise, or interruption	Earbuds are too far away from device	Move device closer to earbuds

Bluetooth Listing Declaration ID:D035790
Made in China

Back