

User Manual

Congratulations on your BT Home speaker with wireless charger!
This BT speaker allows you to enjoy your music without wires and charge your phone at the same time.
Please read this manual before use.

NOTE: Wireless charging option is only possible if the micro USB cable is connected.

DEVICE LAYOUT:

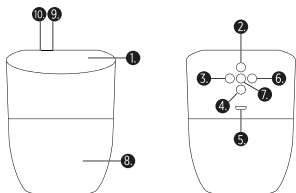

1. Wireless charger transmitter
2. Pause/Play button (short press)
3. Previous track
4. Volume -
5. Micro USB
6. Next track
7. Volume +
8. Speaker
9. Microphone
10. LED indicator for speaker

CHARGING THE SPEAKER:

A full charge is approximately 3 hours and plays continuously 6-7 hours.
Connect the speaker to the USB charging cable to charge.
When the LED indicator is RED, the speaker is charging.
The LED indicator goes off when the device is fully charged.

MADE IN CHINA

HOW TO USE:

If you want to pair your mobile device with the speaker, please make sure the BT mode on your device is switched on. Switch the power on/off button on to pair the device. After doing so the speaker will be visible in the BT devices overview of your device. Please select "Home wireless speaker" to pair your mobile device with the speaker.

USING THE WIRELESS CHARGER:

- Make sure your phone is compatible for wireless charging.
- First plug the wireless charger using the included micro USB cable into the USB port of your wall adapter. Please note charging speeds depends on the input power into the wireless charger.
- Place your mobile phone on the charging pad. You can check the charging status on the screen of your phone.

FUNCTIONS:

Accept call - Press pause/play button.
Ending call - Press pause/play button.
Changing Volume: Press the + or - button shortly.
Changing track: Press >> or << button shortly.

SPECIFICATIONS:

Model: SL218
Item No.: 32269
Input: 5V/2A
Battery capacity: 2000 mAh
Output: 5W
Wireless charger output: 5V/0.8A
Frequency response : 90Hz-20KHz
S/N Ratio: ≥85db

FCC Statement:

- This device complies with Part 18 of the FCC Rules
- The interference potential of the device or system.
- Maintenance of the system.
- Simple measures that can be taken by the user to correct interference.

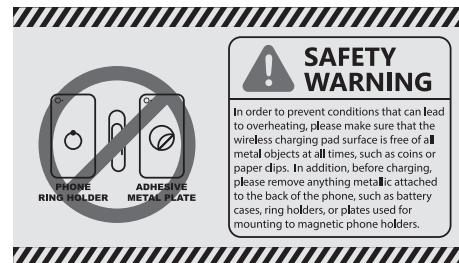

FCC ID : 2ABHA0049

How to Use Correctly?



FCC Statement

This device complies with Part 15 of the FCC Rules. Operation is subject to the following two conditions:

(1) This device may not cause harmful interference.

(2) This device must accept any interference received, including interference that may cause undesired operation.

2. Changes or modifications not expressly approved by the party responsible for compliance could void the user's authority to operate the equipment.

Note: This equipment has been tested and found to comply with the limits for a class B digital device, pursuant to Part 15 of the FCC Rules. These limits are designed to provide reasonable protection against harmful interference in a residential installation.

This equipment generates uses and can radiate radio frequency energy and, if not installed and used in accordance with the instructions, may cause harmful interference to radio communications. However, there is no guarantee that interference will not occur in a particular installation. If this equipment does cause harmful interference to radio or television reception, which can be determined by turning the equipment off and on, the user is encouraged to try to correct the interference by one or more of the following measures:

- Reorient or relocate the receiving antenna.
- Increase the separation between the equipment and receiver.
- Connect the equipment into an outlet on a circuit different from that to which the receiver is connected.
- Consult the dealer or an experienced radio/TV technician for help.

The device has been evaluated to meet general RF exposure requirements. The device can be used in portable exposure conditions without restriction.