

Power Off: Long press the multifunction button on the Primary earbud for 5 seconds. The indicator light will flash red once and you will hear a tone.

Calling: Only the Primary earbud can operate phone call functions.

Answer/End Call: Press the multifunction button once to answer an incoming call. Press the button once to end the call.

Redial: Double press the multifunction button to redial the last number you called on your phone.

Reject Call: Press the multifunction for 2 seconds to reject the incoming call.

Play/Pause: When listening to music, short press Primary earbuds multifunction button to pause/play music.

Next Song: When listening to music, short press the Secondary earbuds multifunction button to go to the next song.

Safety:

1. Do not modify, repair or dismantle the Earbuds. Doing so may result in fire, electric shocks or the Earbuds not working.
2. Do not use any diluents or volatile liquids to clean the Earbuds.
3. It is not recommended to use the Earbuds in any hazardous location.

FCC Statement

This device complies with Part 15 of the FCC Rules. Operation is subject to the following two conditions:
(1) This device may not cause harmful interference, and
(2) This device must accept any interference received, including interference that may cause undesired operation.

Warning:

Changes or modifications not expressly approved by the party responsible for compliance could void the user's authority to operate the equipment.

Note:This equipment has been tested and found to comply with the limits for a class B digital device, pursuant to Part 15 of the FCC Rules. These limits are designed to provide reasonable protection against harmful interference in a residential installation.

This equipment generates uses and can radiate radio frequency energy and, if not installed and used in accordance with the instructions, may cause harmful interference to radio communications. However, there is no guarantee that interference will not occur in a particular installation. If this equipment does cause harmful interference to radio or television reception, which can be determined by turning the equipment off and on, the user is encouraged to try to correct the interference by one or more of the following measures:

- Reorient or relocate the receiving antenna.
 - Increase the separation between the equipment and receiver.
 - Connect the equipment into an outlet on a circuit different from that to which the receiver is connected.
 - Consult the dealer or an experienced radio/TV technician for help.
- The device has been evaluated to meet general RF exposure requirement. The device can be used in portable exposure condition without restriction.

FCC ID : 2ABHA0026

MADE IN CHINA

SLO7I

RETRACTABLE TWS EARBUDS



USER MANUAL

1. Multifunction Button
2. Microphone
3. LED indicator
4. Ear Tips
5. Power Case
6. USB input
7. Power Case LED Indicator

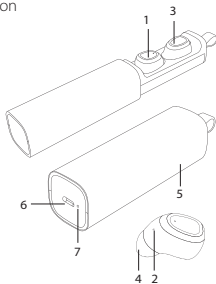

Specifications:

Earbuds
 Model : SL071
 Battery capacity : 40 mAh
 Working Voltage: 3.7V - 4.2V
 Mic Sensitivity: -42 ± 3dB
 Bluetooth Frequency: 2.4-2.48GHZ
 Bluetooth Range: 10M
 Audio Transmission
 Protocol: A2DP/HFP/HSP/AVRCP

Power Bank Station

Capacity: 240 mAh
 DC Charging Voltage: DC5V
 DC Charging Current (MAX): 0.24A

Charging

It is recommended to fully charge the earbuds and charging station prior to its first use.

Earbuds: The earbuds charge when placed in the charging station and the LED indicator will display a solid red light.

When the earbuds are fully charged, the indicator light will turn blue.

Power Bank Station: Use the USB cable included to connect the power bank station to a computer or adaptor.

Single Ear Bud Use

Power On: To power on, long press the multifunction button for 3 seconds. The indicator light will show flash red once and you will hear a tone.

Pairing: Once earbuds are turned on, using your mobile device, search for Bluetooth devices and select Bluetooth ID 'True Wireless headset'. It will pair automatically.

Power Off: Long press the multifunction button for 5 seconds. The indicator light will flash red once and you will hear a tone.

Answer/End Call: Press the multifunction button once to answer an incoming call. Press the button once again to end the call.

Redial: Double press the multifunction button to redial the last number you called on your phone.

Reject Call: Press the control button for 2 seconds to reject an incoming call.

Play/Pause: When listening to music, short press the multifunction button to pause/play music.

Both Earbuds:

Please note: Once both earbuds are paired, the Primary earbud will be the button to use for control, and the microphone used for calling. The other earbuds controls will be disabled for calling while being paired with the Primary Earbud.

Power On: Press and hold the multifunction buttons of both earbuds at the same time for 3 seconds, the indicator light will flash red and blue alternatively.

Pairing: Place the earbuds beside each other and double press the button of one earbuds that you want to be primary, they will automatically pair together. One earbud will flash blue slowly. The other earbud will flash red and blue, this is the Primary Earbud and will be what you use to control the functions when using two earbuds at once. You can now use your mobile device to search for Bluetooth devices. Select Bluetooth ID 'True Wireless headset'. It will pair automatically.

Note: If you attempt to pair before the earbuds have paired to each other, the earbuds will go into single earbud use not both. In this case, restart the process. Once they are paired successfully, the indicator will flash blue slowly.