

FURRION

5" and 7" Vision S Camera System Système de caméra Vision S de 5 et 7 po Sistema de cámara Vision S de 5" y 7"

*Instruction Manual
Manuel d'instructions
Manual de instrucciones*



Model: FCD48TASF

- * *The packing contents may be different based on the kit you purchased. Please take the actual product as standard.*
- * *Le contenu de l'emballage peut être différent en fonction de la trousse achetée. Veuillez prendre le produit réel en référence.*
- * *Es posible que los contenidos del embalaje sean diferentes según el kit que haya comprado. Tome el producto real como estándar.*

Models: FOS07TASK/FOS07TASR/FOS07TASE/FOS07TASF
FOS07TADS/FOS07TAED/FOS07TAPK/FOS07TAPT
FOS05TASK/FOS05TASR/FOS05TASE/FOS05TASF
FOS05TAEK/FOS05TAED/FOS05TAPK/FOS05TAPT

Welcome

Thank you for purchasing this Furrion® Vision S Camera System. Before operating your new product, please read these instructions carefully. This instruction manual contains information for safe use, installation and maintenance of the product.

Please keep this instruction manual in a safe place for future reference. This will ensure safe use and reduce the risk of injury. Be sure to pass on this manual to new owners of this product.

The manufacturer does not accept responsibility for any damages due to not observing these instructions.

If you have any further questions regarding our products, please contact us at **support@furrion.com**

Contents

- Welcome2**
- Contents3**
- Important Safety Instructions.....4**
 - FCC Statement 5
 - IC Statement 6
- Product Overview7**
 - Product Description 7
 - Monitor 7
 - Left/Right Camera 8
 - Front/Rear Camera 8
- Installation9**
 - What’s in the Box 9
 - Monitor Installation..... 9
 - Camera Installation 11
- Installation11**
 - Electrical Connections 16
- Getting Started18**
 - Activate the Monitor 18
 - Pairing the Camera and Monitor 18
- Change Settings.....20**
 - Camera Setting 20
 - Picture Setting 23
 - Software Version 23
- Operation24**
 - Operating the System..... 24
- Care and Cleaning.....26**
- Specifications27**
- Troubleshooting.....28**
- Warranty.....29**

Important Safety Instructions

READ THESE INSTRUCTIONS CAREFULLY BEFORE INSTALLING OR USING THE SYSTEM

This product is intended to assist in safe driving and to allow the driver to have a broader view while the vehicle is in reverse.

You, as the driver, are solely responsible for the safe operation of your vehicle and the safety of your passengers according to your local traffic regulations. Do not use any features of this system to the extent it distracts you from safe driving.

Your first priority while driving should always be the safe operation of your vehicle. Furrion cannot accept any responsibility for accidents resulting from failure to observe these precautions or safety instructions.

1. This product utilizes high voltage. Any unauthorized modifications or damage to the product may result in electrical shock. Handle all components with care. Inspect regularly for damage to components and cabling.
2. You are responsible for ensuring the installation of this product does not void or affect the vehicle manufacturer's warranty. Furrion is not liable in full or in part for improper installation resulting in loss or damage to your property, or for voiding all or part of the vehicle manufacturer's warranty.
3. Do not apply excessive force to any of the components contained within this kit. Excessive force used before, during or after installation that results in a damaged or nonfunctional part will void all warranties.
4. Please follow the procedures in this instruction manual. Improper installation or modification of this product will void all warranties.

Many jurisdictions have laws and regulations relating to the use of cameras and some do not allow for the obstruction of information contained on a license plate. Before using this product, it is the buyer's responsibility to

be aware of and comply with any applicable laws and regulations that apply to license plates or may prohibit or limit the use of cameras.

Electrical Safety

- A battery or 12V DC electrical system presents a risk of electrical shock or burn. Ensure all power sources are isolated before installation.
- Insulate unconnected wires with vinyl tape or similar.
- Use insulated tools when working with a power supply.

Caution

- There are no serviceable parts in the Furrion Wireless Observation Camera System. Do not disassemble or attempt any repairs.
- There are no fuses or disconnects in the Furrion Wireless Observation Camera System. Install external fuses/breakers as required.

Installation

- Installation and wiring of this product require specialist skills. To ensure proper and safe installation, please seek a specialist technician.
- Only use supplied or recommended parts.
- Use watertight connectors for the camera power supply cable to power source.
- Connect the camera to a 12-24V DC circuit using 18AWG or larger cables.
- Ensure correct polarity of DC power supply to the camera.
- To reduce the risk of fire, connect the camera only to a circuit provided with a maximum branch-circuit over current protection device.
- Do not route wiring in areas that may get hot.
- Take necessary precautions when working at elevated levels.

Important Safety Instructions

Use

- Electrical appliances and overhead power lines can affect the wireless signal.
- Do not place the monitor in a location where it might hinder field of vision while driving.
- Consideration should be given to any airbags when installing the monitor. Do not place the monitor where it might hinder the airbag or become hazardous if the airbag is deployed.

Care

- Do not wash the vehicle with an automatic car wash or high pressure water. This may damage the camera.
- Clean the LCD screen with a microfiber cloth. Do not use coarse or abrasive materials.
- Do not use alcohol or ammonia based products to clean the LCD screen. Only use specialist screen cleaning products.
- Use a wet cloth to clean the camera lens. A dry cloth may scratch the camera lens.

FCC Statement

The equipment complies with RF exposure limits. This module is limited to installation in mobile or fixed applications. The antenna used for this transmitter must not be co-located or operating in conjunction with any other antenna or transmitter.

This device complies with Part 15 of the FCC Rules. Operation is subject to the following two conditions:

- (1) This device may not cause harmful interference.
- (2) This device must accept any interference received, including interference that may cause undesired operation.

NOTE: The Grantee is not responsible for any changes or modifications not expressly approved by the party responsible for compliance. Such modifications could void the user's authority to operate the equipment.

NOTE: This equipment has been tested and found to comply with the limits for a Class B digital device, pursuant to part 15 of the FCC Rules. These limits are designed to provide reasonable protection against harmful interference in a residential installation.

This equipment generates, uses and can radiate radio frequency energy and, if not installed and used in accordance with the instructions, may cause harmful interference to radio communications. However, there is no guarantee that interference will not occur in a particular installation. If this equipment does cause harmful interference to radio or television reception, which can be determined by turning the equipment off and on, the user is encouraged to try to correct the interference by one or more of the following measures:

- Reorient or relocate the receiving antenna.
- Increase the separation between the equipment and receiver.
- Connect the equipment into an outlet on a circuit different from that to which the receiver is connected.
- Consult the dealer or an experienced radio/TV technician for help.

RF Exposure

The device has been evaluated to meet general RF exposure requirement.

To maintain compliance with FCC's RF exposure guidelines, this equipment should be installed and operated with a minimum distance of 20cm between the radiator and your body.

Important Safety Instructions

IC Statement

This device complies with Industry Canada licence-exempt RSS standard(s). Operation is subject to the following two conditions: (1) this device may not cause interference, and (2) this device must accept any interference, including interference that may cause undesired operation of the device.

RF Exposure

The device has been evaluated to meet general RF exposure requirement. To maintain compliance with RSS-102 — Radio Frequency (RF) Exposure guidelines, this equipment should be installed and operated with a minimum distance of 20cm between the radiator and your body.

Product Overview

Product Description

The Furrion Vision S Camera System is designed to assist the driver by providing a clear and wide image of the area behind the vehicle whenever the vehicle is shifted into reverse. Never rely solely on this product to ensure the area is clear of children and/or obstructions. Use your monitor and look both ways. This product is not intended to replace existing safety procedures, but rather to add an additional safety tool for your vehicle.

CAUTION: Do not back up your vehicle while watching the monitor screen. Always look in the direction the vehicle is traveling. Use the monitor as an aid to ensure there are no children or obstructions. The image on the monitor is not designed to show distance and may be misleading. The actual distance is less than appears in the monitor. The range of the image is limited. Be aware of blind spots.

Monitor

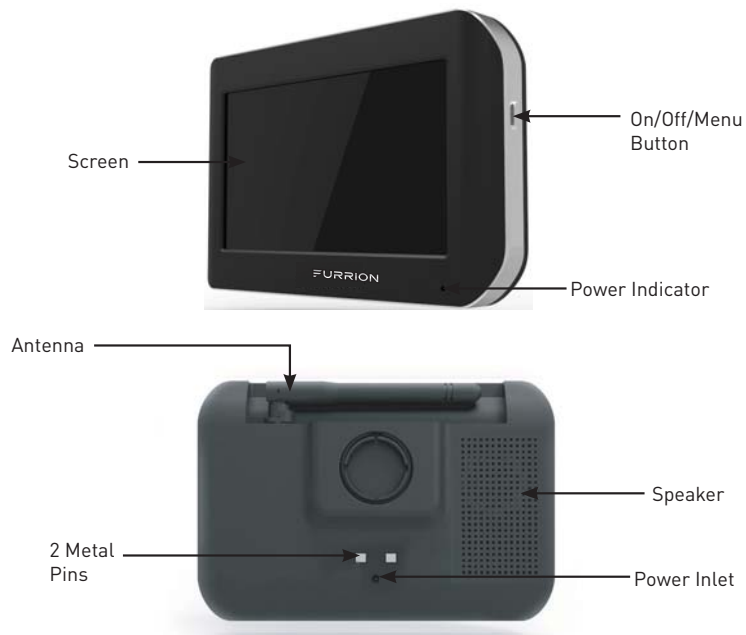

Product Overview

Left/Right Camera

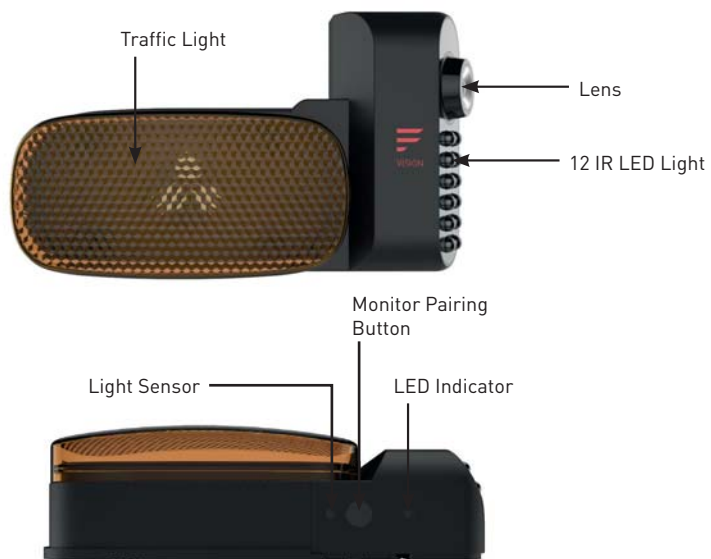

Front/Rear Camera

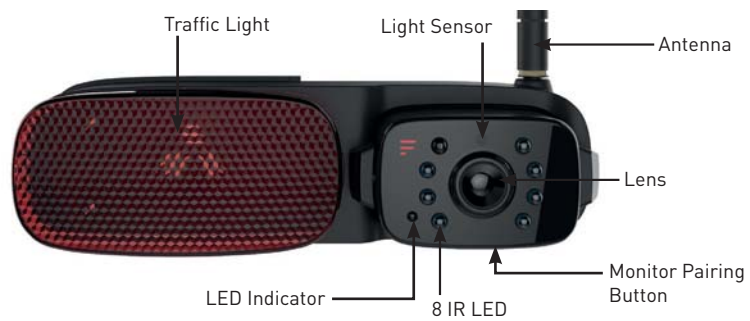

Installation

COMPLETELY READ THIS MANUAL BEFORE INSTALLATION

NOTE: We have included all of the items needed for most standard installations, but all vehicles are different. We recommend you review your vehicle completely before starting.

What's in the Box

Make sure you have all the following items included in the packaging. If any item is damaged or missing, contact your dealer.

- Monitor x 1
- Windshield Stand x 1
- Interior Table Stand x 1
- Monitor Power Cable x 1
- Camera (different by model)
- Warranty Card x 1
- Instruction Manual x 1

NOTE: The contents included may be different based on the kit you purchased. Please take the actual product as standard.

Monitor Installation

Choose a monitor location in your vehicle that does not block your view and complies with local laws for safe driving. Do not place in an area where it might interfere with driving.

WARNING: To prevent the risk of electric shock or fire, during installation, remove the key from the ignition and isolate the 12V or 24V power source.

Wall-mount Installation (sold separately)

CAUTION: Ensure there are no electrical cables, gas lines, pipes or other important parts behind the wall where the drill holes will be.

1. Select a suitable mounting position where you are going to locate your monitor.

2. Mark a basic outline on the wall using the provided mounting bracket. (Fig. 1)

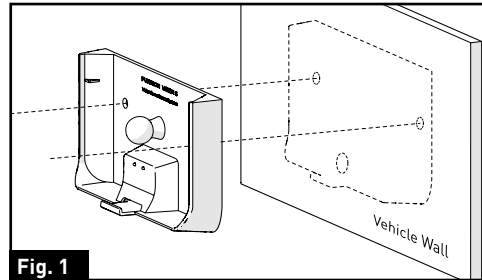

Fig. 1

3. Drill a $\frac{5}{8}$ " hole on the vehicle wall where the mounting bracket wire feeds in using a $\frac{5}{8}$ " hole saw. (Fig. 2)

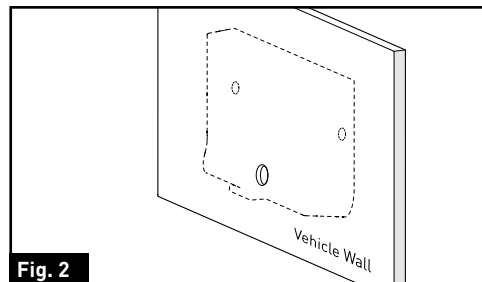

Fig. 2

4. Feed the bare end of the mounting bracket wire into the hole and connect to the supplied camera power cable. (Fig. 3)
NOTE: Connect black to black, white to white. Black is positive "+" and white negative "-".

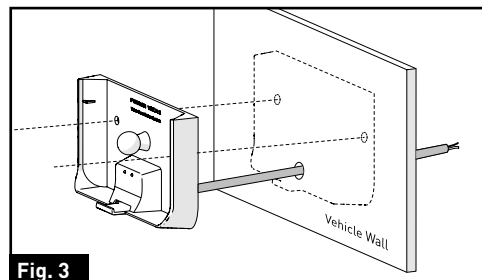

Fig. 3

Installation

5. Fix the mounting bracket onto the vehicle wall using 2 flat self-tapping screws provided. (Fig. 4)

NOTE: Make sure the "FURRION VISION S" is facing up while installing.

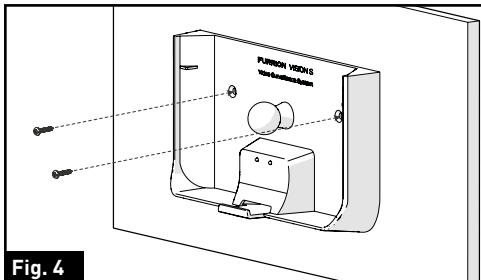

Fig. 4

6. Align the monitor into the installed bracket and push firmly until the dot bullet locks into the monitor. (Fig. 5)

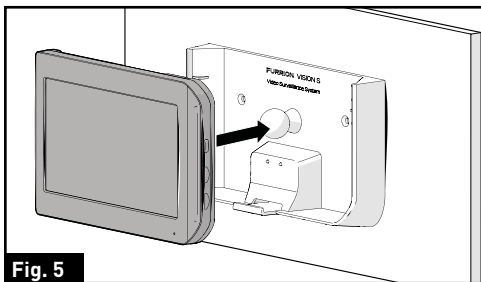

Fig. 5

Tabletop Installation

To prevent your monitor from fall damage during driving, the tabletop mounting bracket is designed with 4 non-slip pad attached under the bracket.

1. Select a suitable mounting position where you are going to secure your monitor.
2. Feed the supplied camera power cable through the hole on back of the tabletop bracket and insert into the monitor power port. (Fig. 6)

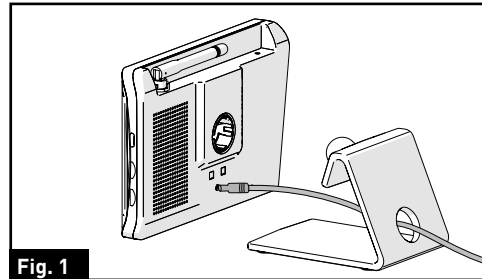

Fig. 1

3. Align the dot bullet of the tabletop bracket with the opening on back of the monitor and push firmly until locked into place. (Fig. 7)

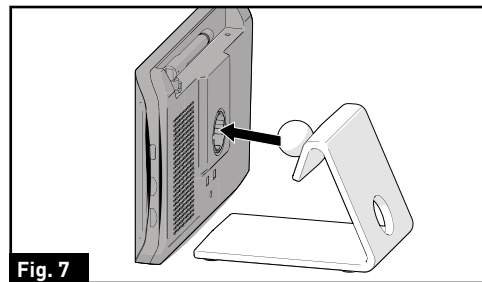

Fig. 7

4. Rotate the monitor to adjust the visual angle as needed.

Installing on Windshield

1. Clean the mounting area where you are going to install the monitor with a cleaner that does not leave a residue.
2. Remove the protective film from the bottom of the suction cup.
3. Carefully position the suction cup on the windshield and rotate the locking arm downwards to stick securely. (Fig. 8)

Installation

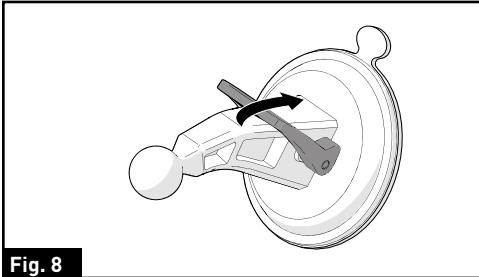

Fig. 8

4. Align the dot bullet of the suction cup with the opening on back of the monitor and push firmly until locked into place. (Fig. 9)

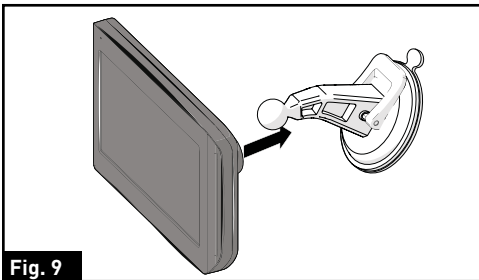

Fig. 9

5. Rotate the monitor to adjust the visual angle as needed.

Camera Installation

CAUTION: Ensure there are no electrical cables, gas lines, pipes or other important parts behind where the drill holes will be. To prevent the risk of electric shock or fire, during installation, remove the key from the ignition and isolate the 12V or 24V power source.

Suitable Installation Position

- For optimum performance, the camera should be mounted where there is minimal obstruction between the camera and monitor. Dense side-wall material and electrical appliances can reduce signal strength.

- Where practical, as high as possible at the rear of the vehicle.
- Horizontal-center of the vehicle or as close as is optimal.
- Mount camera at least 2 inches above or below running lights. Close proximity to lights may cause image blooming, blurring and reduced night vision performance.
- The area should be flat with enough surface area to accommodate the bracket.
- The surface area should be clean and dry for a watertight installation.
- Ensure that power can be fed to the installation area from within the vehicle.

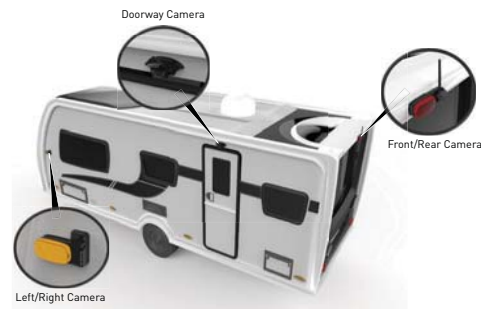

Camera Location

Testing

Prior to permanently mounting the camera, it is advisable to check if the intended mounting location will achieve adequate signal.

- Pair the camera and monitor (see **Pairing the Camera and Monitor** section).
- Temporarily secure the camera in the intended location or as close as possible.
- Check signal icon **Y** on the monitor. Ideally there should be 3-4 bars.
- If the signal is 0-1 bars, reposition the camera and or monitor. The signal can also be improved by decreasing the amount of obstructions between the camera and monitor.

Installation

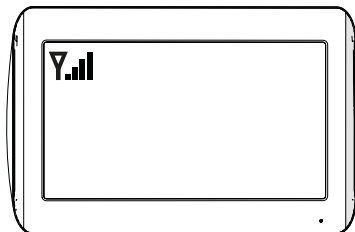

Good Signal

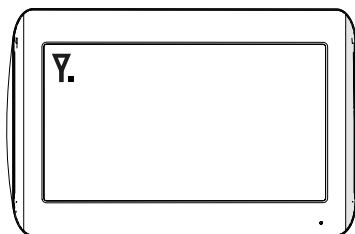

Poor Signal

Doorway Camera Installation (if purchased)

1. Select a suitable mounting position where you are going to install the doorway camera. Mark a basic outline using the provided bracket gasket. (Fig. 10)

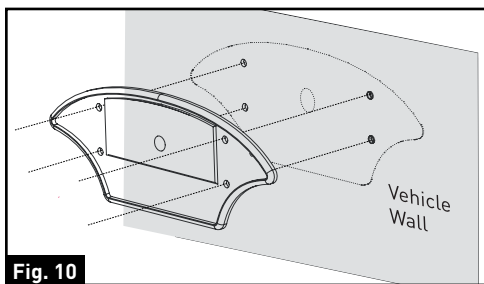

Fig. 10

2. Drill a $\frac{5}{8}$ " center hole on the vehicle wall using a $\frac{5}{8}$ " hole saw. (Fig. 11)

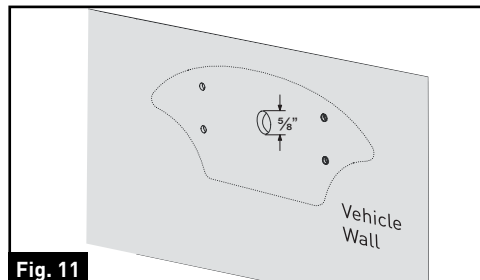

Fig. 11

3. Feed the supplied 6-foot camera power cable through the gasket. Ensure the bare end of the cable goes into the vehicle and the flat side faces inward. (Fig. 12)

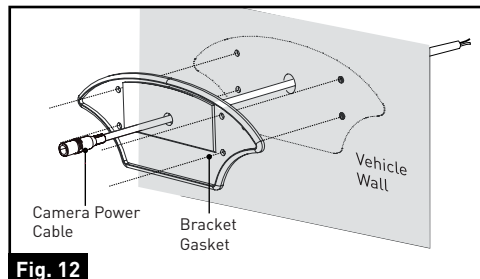

Fig. 12

4. Fix the gasket and bracket to the vehicle using four $\frac{3}{4}$ " flat self-tapping screws. Make sure the camera power cable is not wrapped or extruded. (Fig. 13)

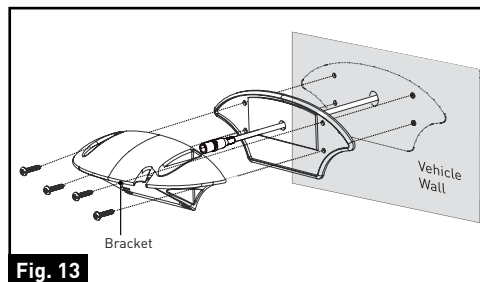

Fig. 13

5. Make sure the sealing lip around the edge of the gasket is seated over the edge of the bracket before fully tightening the screws.

Installation

6. If only installing the mounting bracket, secure the camera power cable inside the mounting and attach the cover. (Fig. 14)

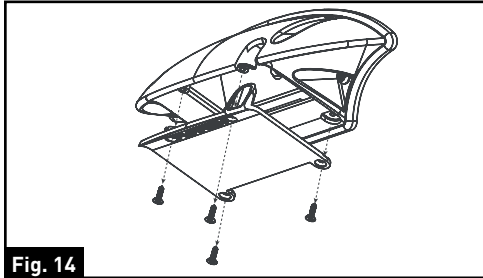

Fig. 14

7. If a doorway camera is to be installed, remove the Bracket Cover by unscrewing the four screws. (Fig. 15)

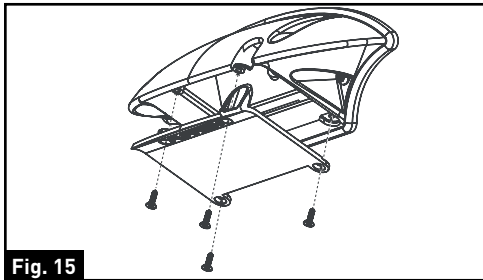

Fig. 15

8. Pull out the camera power cable, leaving approx 2 inches of slack. (Fig. 16)

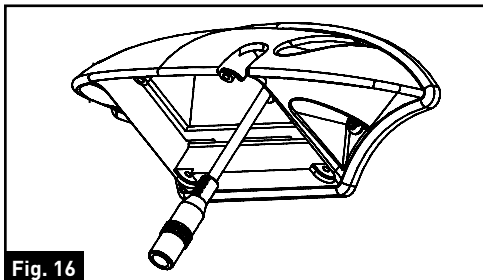

Fig. 16

9. Connect the camera power cable to the camera cable. (Fig. 17)

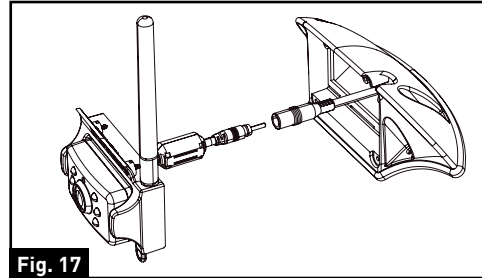

Fig. 17

10. Place the attached cables and connections into the bracket housing by first placing the cable to the right. (Fig. 18)

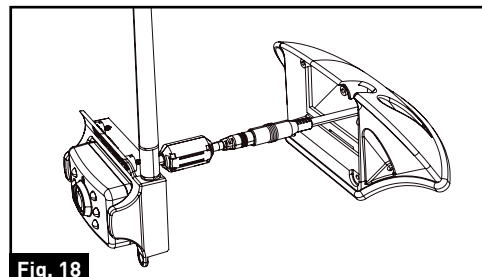

Fig. 18

11. Place the camera cable filter in the left of the bracket housing. (Fig. 19)

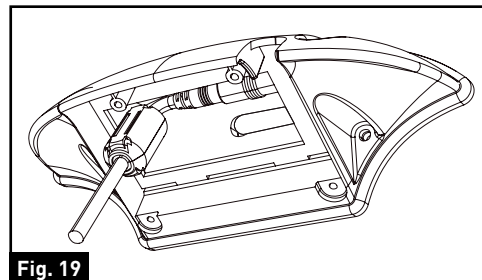

Fig. 19

Installation

12. Gently place the camera into the bracket and secure with 4 flat self-tapping screws. Make sure the connections and the camera antenna are secured tightly. (Fig. 20)

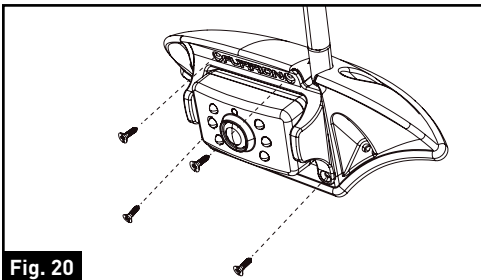

Fig. 20

Left and Right Camera Installation (if purchased)

A traffic light must be installed together with the camera. For best performance, we recommend a Furrion traffic light is selected.

1. Select a suitable position on the side of the vehicle wall where you would like to install the camera.
2. Remove the lens cover by scratching the slot on the side of the traffic light. (Fig. 21)

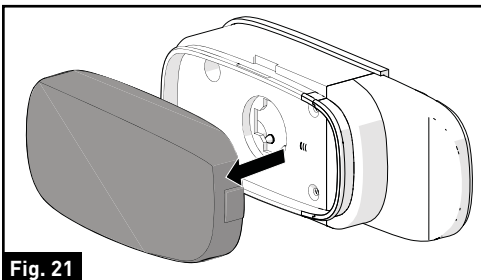

Fig. 21

3. Remove the two screws holding the decorative part using a Phillips-head screwdriver and set aside. (Fig. 22)

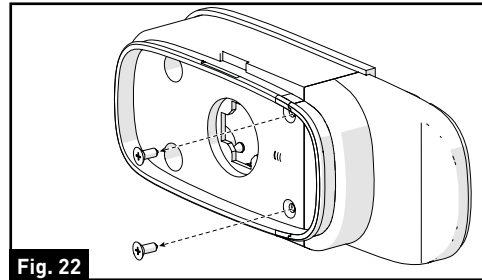

Fig. 22

4. Pull to remove the decorative part from traffic light and save in a safe place in case of future use. (Fig. 23)

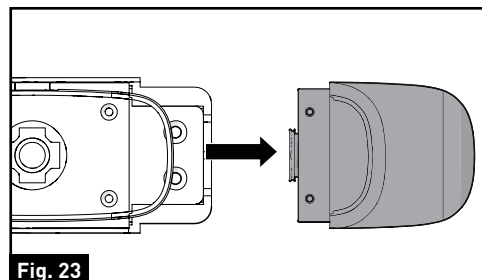

Fig. 23

5. Secure the traffic light base on the vehicle wall using the four flat self-tapping screws. (Fig. 24)

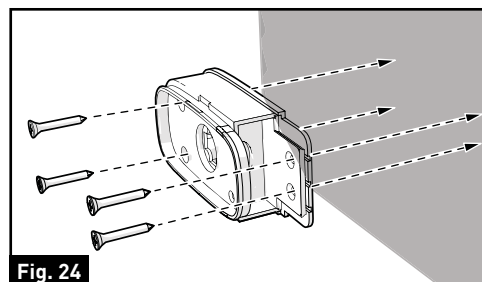

Fig. 24

Installation

6. Insert the right camera into the traffic light base and secure with the two flat self-tapping screws provided. (Fig. 25 and Fig. 26)

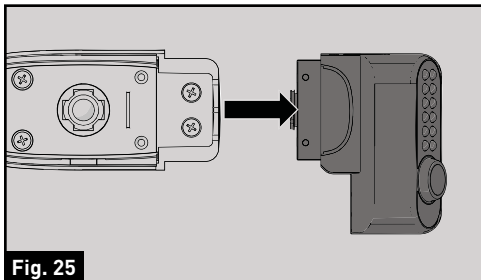

Fig. 25

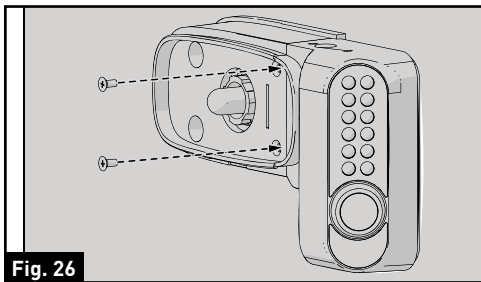

Fig. 26

7. Replace the lens cover over the traffic light base and press until a “click” is heard. The camera is now fully installed onto the vehicle. (Fig. 27 and Fig. 28)

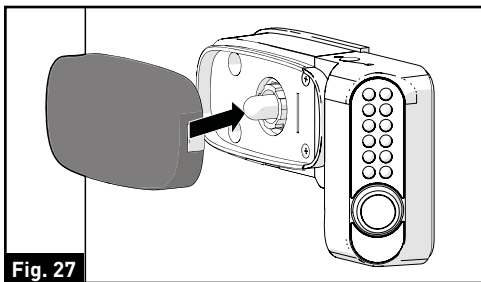

Fig. 27

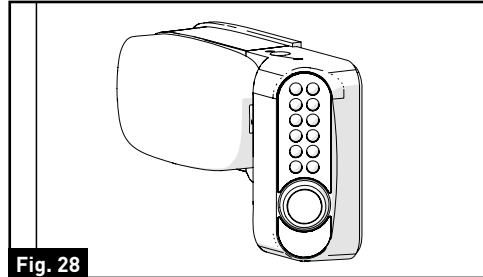

Fig. 28

8. Repeat steps 1 to 7 to install the other camera.

Front and Rear Camera Installation (if purchased)

A traffic light must be installed together with the camera. For best performance, we recommend a Furrion traffic light.

1. Select a suitable position on front or back of the vehicle wall that you would like to install the camera.
2. Remove the lens cover by scratching the slot on the side of the traffic light. (Fig. 29)

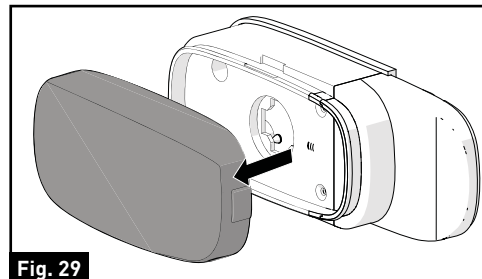

Fig. 29

Installation

3. Remove the two screws holding the decorative part using a Phillips screwdriver and set aside. (Fig. 30)

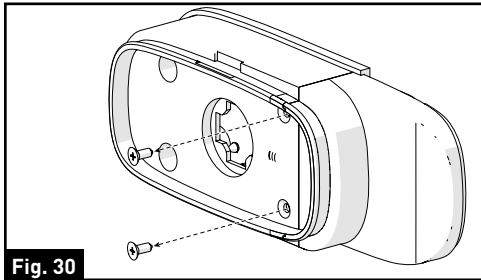

Fig. 30

4. Pull to remove the decorative part from traffic light and save in a safe place in case of future use. (Fig. 31)

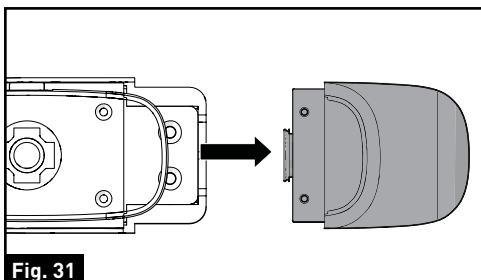

Fig. 31

5. Secure the traffic light base on the vehicle wall using four flat self-tapping screws. (Fig. 32)

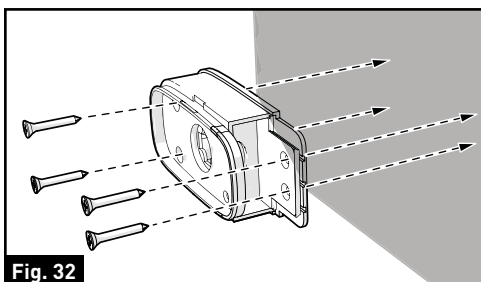

Fig. 32

6. Insert the front or rear camera into the traffic light base and secure with the two flat self-tapping screws provided. (Fig. 33 and Fig. 34)

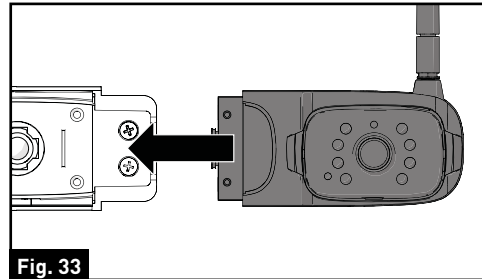

Fig. 33

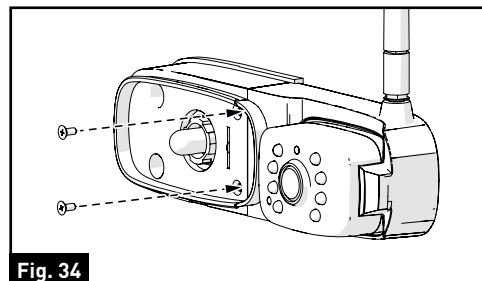

Fig. 34

7. Replace the lens cover over the traffic light base and press until you hear a "click". The camera is fully installed onto the vehicle. (Fig. 35 and Fig. 36)

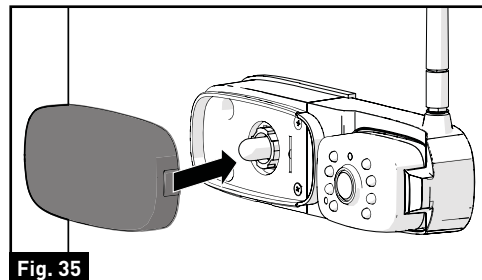

Fig. 35

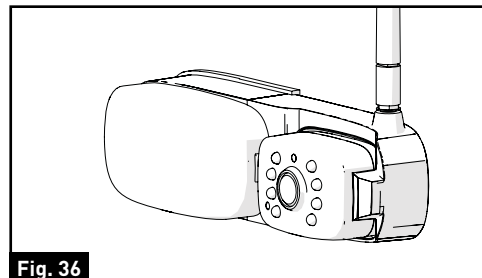

Fig. 36

Installation

- Repeat steps 1 to 7 to install the other camera.

Electrical Connections

Connecting the Monitor

- Route the power cable to the vehicle's cigarette lighter socket 12/24V power outlet. The cable must not interfere with the safe operation of the vehicle.
- Insert the small 12/24 Volt DC plug of the power cable into the right side of the monitor.
- Plug the 12/24 Volt cigarette lighter plug into the vehicle's cigarette lighter socket.

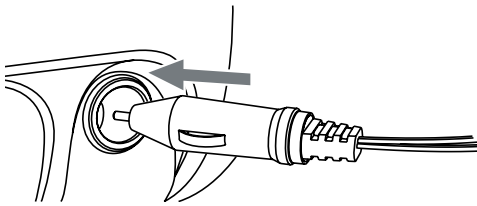

Connecting the Camera

⚠ WARNING

When connecting wires, ensure the circuit is isolated by disconnecting the negative terminal on the battery.

- Ensure correct polarity when wiring the cables. RED + BLACK -.
- Ensure correct polarity when wiring.
- Wire connections and terminals must be sealed and waterproof.

The Furrion Vision S Camera System can be connected to an electrical power source via a 7 Way Connector.

Wiring to running lights: the camera will activate when the running lights are switched on.

Wiring to reverse lights: the camera will activate when the vehicle engages reverse gear.

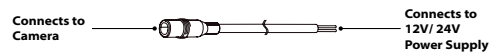

Consult the vehicle's service manual for specific wiring color code.

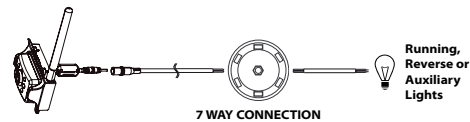

When wiring this camera directly to a 12V battery or converter in your RV, use an in-line switch on the power cable to power on or off your camera. This will enable this camera to be used when parked without a tow vehicle connected.

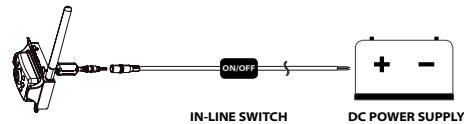

Connecting the Traffic Light

- Route the power cable to the vehicle's 12/24V running light. The cable must not interfere with the safe operation of the vehicle.

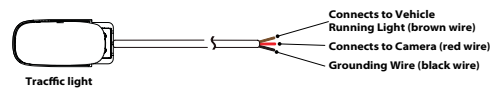

Getting Started

The camera and monitor need to be paired the first time you are using your Vision S Camera System.

NOTE: Ensure both the camera and monitor have power supplied during Pairing and setting processes. (*The vehicle may need to be running.*)

Activate the Monitor

In off mode, press the **Menu** button on the right of the monitor to turn on the monitor and enter the menu setting page. In on mode, press the **Menu** button to activate the menu setting page.

There are four options that allow you to set the wireless vehicle rear observation system before operating. Touch one of the four options to enter the setting page or press ↻ to return to previous page.



Pairing the Camera and Monitor

1. Touch **PAIRING** on screen. The **PAIRING** will be highlighted in red once selected and enter the submenu automatically.

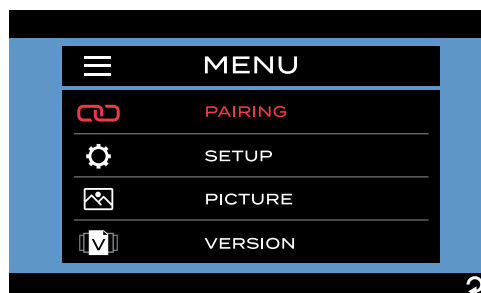

2. Select the desired camera you are going to pair. The monitor will search for current available device and pair automatically.

NOTE: The monitor can only pair to one camera for each channel and a total of four cameras are supported.

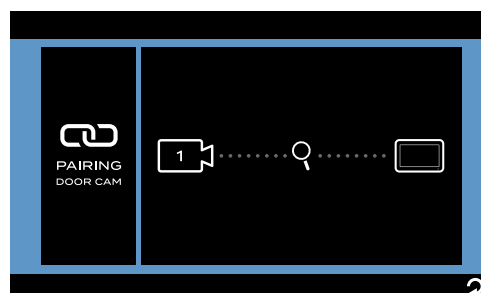
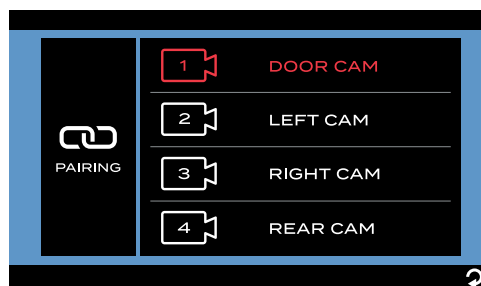

Getting Started

3. Once paired successfully, a red  icon will appear after the device list.

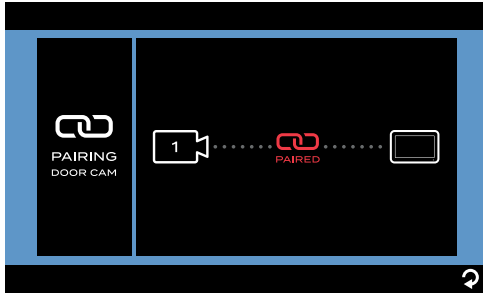

4. An  icon indicates pairing failed, repeat steps 2 and 3 to pair again.

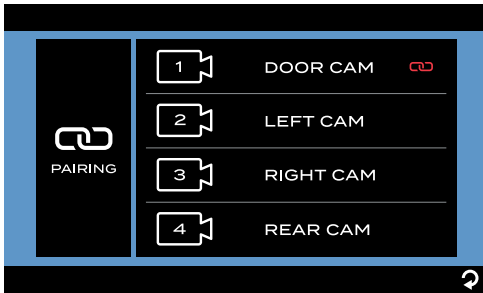

5. Repeat steps 1 to 4 to pair the other cameras.
6. Refer to "**General Setup**" section on detail settings of the camera.

Change Settings

Camera Setting

Touch **SETUP** on screen. The **SETUP** will be highlighted in red once selected and enter the submenu automatically.

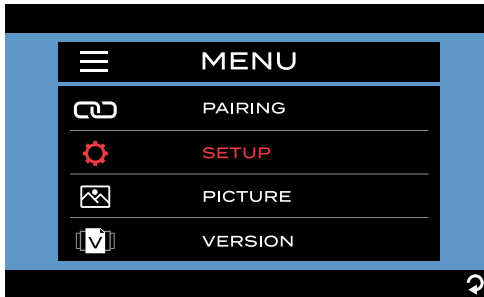

3. Press **DOOR**, **LEFT**, **RIGHT** or **REAR** to enable or disable one or more camera(s) as auto displaying camera(s) when using the wireless vehicle rear observation system.

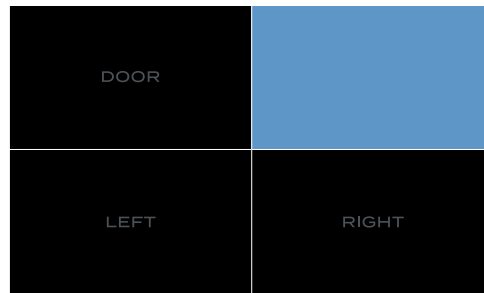

AUTO DISPLAY SETTING

1. Touch **AUTO DISPLAY** on screen to enter the submenu.

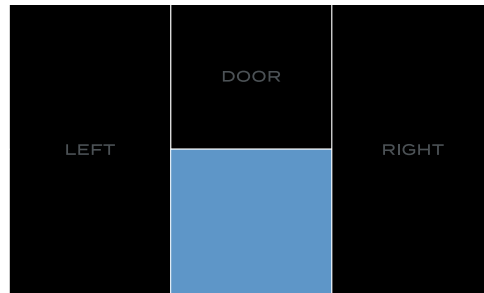
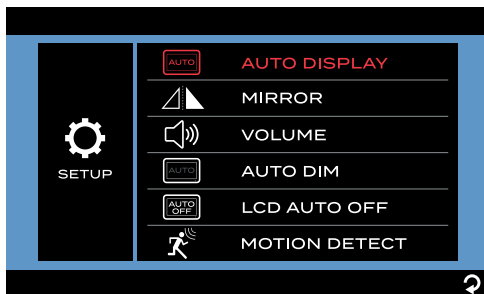

2. Touch to set the cameras layout as **QUAD SPLIT** or **H SPLIT**. The current selected setting will be highlighted in red.

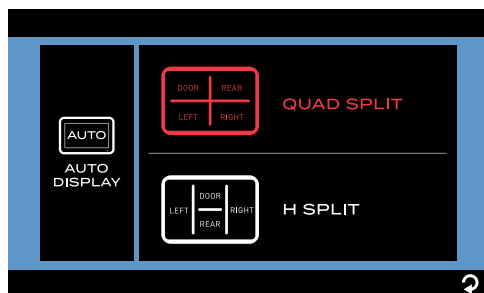

MIRROR SETTING

1. Touch **MIRROR** on screen to enter the submenu. The current selected setting will be highlighted in red.

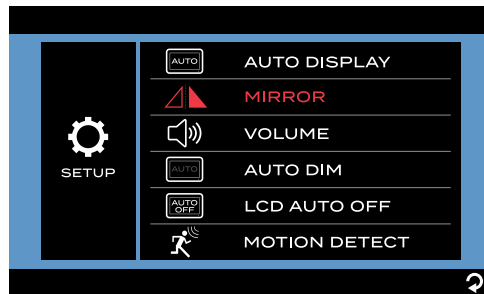

2. Select the desired camera you are going to set.

Change Settings

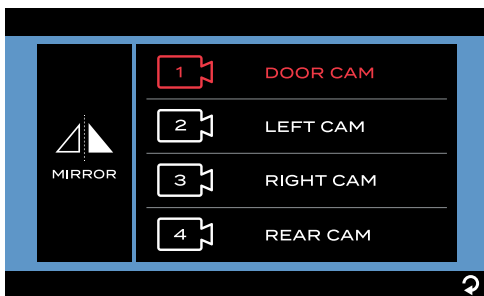

3. Touch to set the camera image rotation angle as **NORMAL** (0°), **ROTATE** (90°), **FLIP** (180°) or **FLIP and ROTATE** (270°).

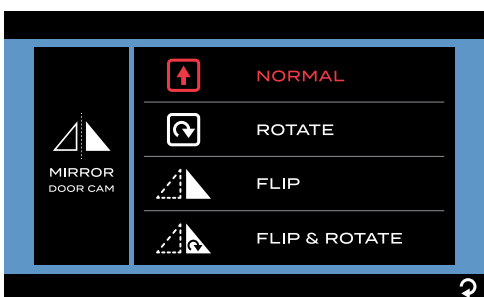

4. Repeat steps 2 and 3 to set the other camera.

VOLUME SETTING

1. Touch **VOLUME** on screen to enter the submenu.

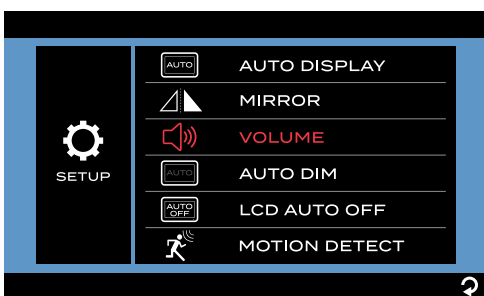

2. Press **X** or **+** to decrease or increase the volume or door and rear cameras.



AUTO DIM SETTING

1. Touch **AUTO DIM** on screen to enter the submenu.

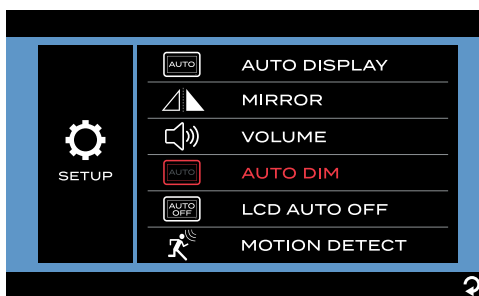

2. Press **✓** or **X** to enable or disable the screen brightness auto adjustment function.

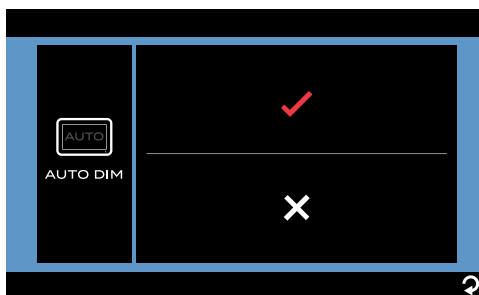

Change Settings

LCD AUTO OFF SETTING

1. Touch **LCD AUTO OFF** on screen to enter the submenu.

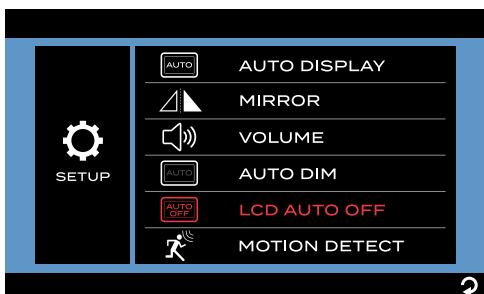

2. Press to set the LCD auto off time as **10 SEC, 20 SEC, 30 SEC** or **X** (off). Press Menu button on the right of the monitor to recover display when LCD display off.

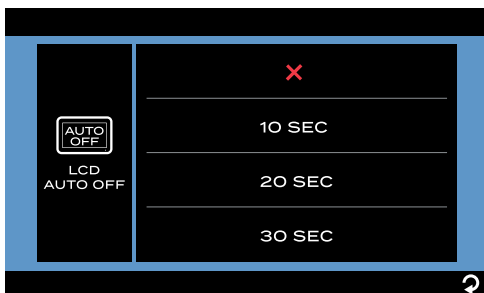

MOTION DETECT SETTING

The motion detect function is used to detect objects in motion and assist in safe driving while the vehicle is in reverse. When on, the monitor LCD will be illuminated automatically when motion is detected.

1. Touch **MOTION DETECT** on screen to enter the submenu.

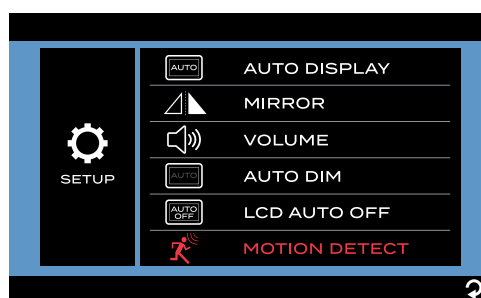

2. Press to set the camera detection sensitivity as **LOW, MEDIUM, HIGH** or **X** (off).

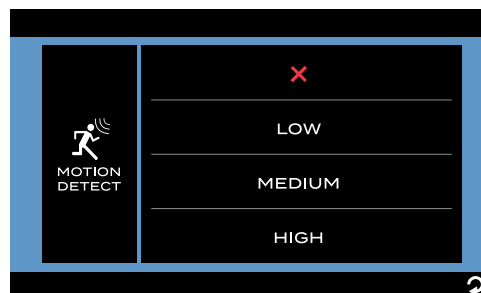

Change Settings

Picture Setting

1. Touch **PICTURE** on screen. The **PICTURE** will be highlighted in red once selected and enter the submenu automatically.

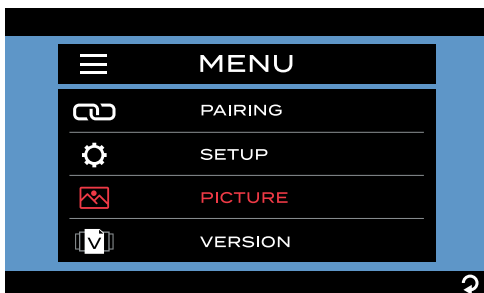

2. Select the desired camera you are going to set.

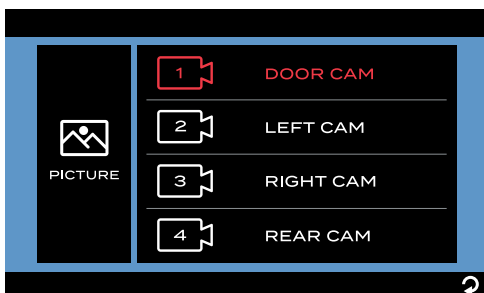

3. Touch to select BRIGHTNESS, CONTRAST or COLOR and enter the submenu.



4. Press **—** or **+** to change the settings.

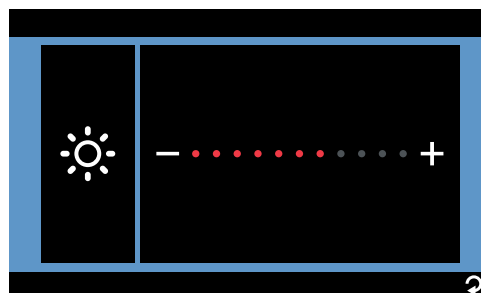

5. Repeat steps 2 to 4 to change the other camera(s) settings.

Software Version

Touch **VERSION** on screen to show the software version of the monitor and the current paired camera(s).

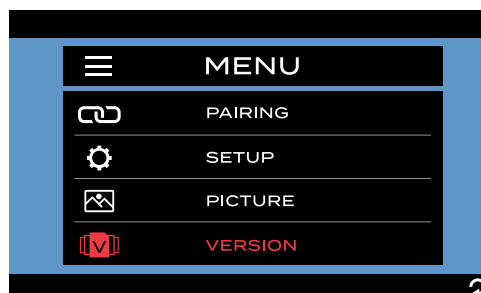



Operation

The Wireless Vehicle Rear Observation System operates when the vehicle is shifted into reverse. The Camera transmits a clear and wide image with Audio from the area behind the vehicle to the monitor inside the vehicle. During the vehicle in moving, the speaker is recommended to be mute. The monitor, when powered, remains in sleep mode until it receives a video signal on the 2.4GHz frequency. When the monitor receives a video signal, it automatically turns on and displays the image from the camera. The monitor automatically adjusts for color, brightness, and contrast, for either daytime viewing or nighttime viewing. At night the picture will appear Black and White. This is due to the low light level and is normal.

NOTE: Because this is a wireless system, the monitor is always watching for a video signal. It is possible to receive signals from other cameras. Systems such as security cameras, baby monitors, and even other back up camera systems can trigger the monitor to briefly turn on. This is normal for wireless products. If you find you have too much activation due to video signals in your area, use the included monitor power wire and run it to the rear of the vehicle. Attach it to the same power source as the camera, this will insure the monitor will only come on when you are in reverse and will eliminate any false signals.

Operating the System

When in quadrant mode:

1. Touch the center of the monitor screen to show the  icon.
2. Press  to switch between **QUAD SPLIT** and **H SPLIT**.

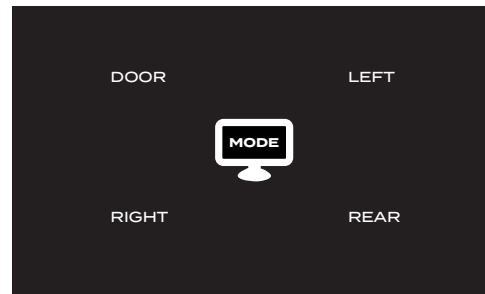
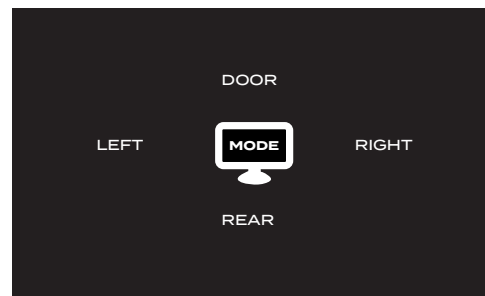

3. Press **DOOR**, **LEFT**, **RIGHT** or **REAR** to select one of the desired cameras and view the image from the area behind the vehicle.

Operation

When in single channel mode:

Press once on the monitor screen to enter the camera selection interface.

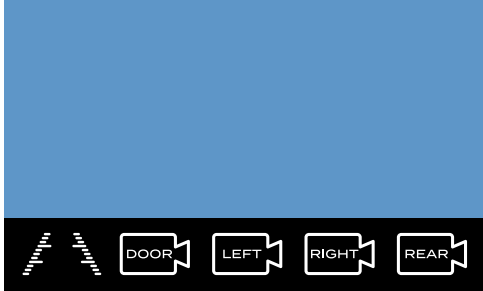

Icon	Description
	Press to turn On/Off the on-screen guideline.
	Press to select the door camera.
	Press to select the left camera.
	Press to select the right camera.
	Press to select the rear camera.

Press twice on the monitor screen to show the menu of control.

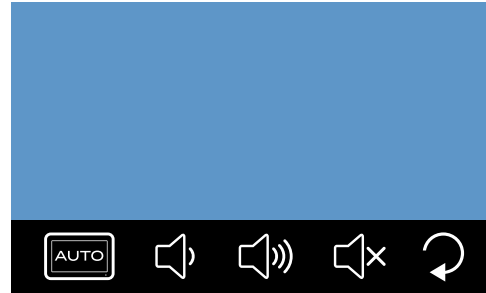

Icon	Description
	Press to return to the quadrant mode.
	Press to decrease the volume of the monitor.
	Press to increase the volume of the monitor.
	Press to mute the monitor.
	Press to return to the previous page.

NOTE: During the vehicle in moving, the speaker is recommended to be mute.

Care and Cleaning

Though your monitor requires little care, you will still need to maintain its condition and performance by following the guidelines below.

- Keep your system away from excessive moisture, extreme heat or cold.
- Keep liquids away from the display.
- Occasionally clean the surface of the monitor with a soft cloth moistened with water or glass cleaner.

Only clean the unit with a dry cloth. Do not clean the unit with strong chemical agents or abrasive cleaners. Never spill liquid of any kind on the product. Do not allow residue or liquids to enter any part of the appliance as this may cause risk of electrocution. Always disconnect from the mains before cleaning.

CAUTION: Never use solvents such as benzene, thinner or cleaners available commercially to clean the system.

Specifications

Specifications	
SUPPLY VOLTAGE	DC8 to 30V
WIRELESS FREQUENCY	2.4 GHz
WIRELESS RANGE	150m (open area)
TRANSMITTING SPEED	6 Mbps (single)
RECEIVING SENSITIVITY	-88 +/-3dBm
DECOMPRESSION FORM	H.264
DELAYING TIME	<250ms
CAMERA	
IMAGE DISTANCE	Rear: <5m / Side: <12m
CMOS SIZE	1/3"
OPTICAL LENS	Rear: F2.0 Side: F2.5
IR CUT FILTER	850nm automatic
VIEW ANGLE	Rear: 120° / Side: 65°
CURRENT (IR ON)	<500mA@12V
CURRENT (IR OFF)	<350mA@12V
CAMERA PIXEL	720x480
DISPLAY	
LCD POWER OFF	<30mA@12V
LCD BACKLIGHT ON	<500mA@12V
LCD BACKLIGHT OFF	<300mA@12V
LCD SIZE	7" / 5"
LCD RESOLUTION AT 1VIEW	720 x 480
LCD BRIGHTNESS	180cd/m ² (7" monitor); 300cd/m ² (5" monitor)
LCD CONTRAST	800:1 (7" monitor); 350:1 (5" monitor)
LCD VIEWING ANGLE	L/R80,U60,D70 (7" monitor); L/R65,U50,D60 (5" monitor)
LCD ASPECT RATIO	16:9

Troubleshooting

Problem	Solution
Monitor won't turn on (no blue LED)	Check the power cable is connected.
	Check the cigarette lighter has 12-24V DC Output.
	Check the fuse in the cigarette socket adapter.
Camera and Monitor won't pair	Check if the camera is receiving power.
	Make sure to hold the camera pairing button for 2 seconds.
Intermittent / Weak signal icon appears	Check if the camera antenna is fitted and secured correctly - it should be vertical.
	Distance between camera and monitor is too great. Reduce distance between Camera and Monitor.
	Large dense objects could be obscuring the signal. If possible, move the objects.
	Interference from electrical appliances may be affecting the wireless signal. Turn off the appliances when using the system.
	Interference from overhead power lines may be affecting the signal.
	Try unpairing and pairing.
Night vision is poor or does not function	The light sensor on the camera may be dirty or obstructed.
	Ensure the camera unit is installed at least 2 inches away from rear lights.
Monitors Blue LED no light with no picture	The camera has no power connected.
	Ensure the tow vehicle is running.
	Ensure the 7 way connector is connected.
	Ensure that the circuit the camera is connected to has power and is running.

Warranty

FURRION WARRANTS FOR A PERIOD OF 1 YEAR FROM DATE OF RETAIL PURCHASE BY THE ORIGINAL END-USE PURCHASER, THAT THIS PRODUCT, WHEN DELIVERED TO YOU IN NEW CONDITION, IN ORIGINAL PACKAGING, FROM A FURRION AUTHORIZED RESELLER AND USED IN NORMAL CONDITIONS, IS FREE FROM ANY DEFECTS IN MANUFACTURING, MATERIALS, AND WORKMANSHIP. IN CASE OF SUCH DEFECT, FURRION SHALL REPLACE OR REPAIR THE PRODUCT AT NO CHARGE TO YOU. THIS WARRANTY DOES NOT COVER: PRODUCTS WHERE THE ORIGINAL SERIAL NUMBERS HAVE BEEN REMOVED, ALTERED OR CANNOT READILY BE DETERMINED; DAMAGE OR LOSS CAUSED BY ACCIDENT, MISUSE, ABUSE, NEGLIGENCE, PRODUCT MODIFICATION, FAILURE TO FOLLOW INSTRUCTIONS IN INSTRUCTION MANUAL, COMMERCIAL OR INDUSTRIAL USE; DAMAGE OR LOSS CAUSED TO THE DECORATIVE SURFACE OF PRODUCT; TO ANY DATA, SOFTWARE OR INFORMATION; AND NORMAL WEAR AND TEAR. THIS WARRANTY ONLY PROTECTS THE ORIGINAL END-USER ("YOU") AND IS NOT TRANSFERABLE; ANY ATTEMPT TO TRANSFER THIS WARRANTY SHALL MAKE IT IMMEDIATELY VOID. THIS WARRANTY IS ONLY VALID IN THE COUNTRY OF PURCHASE.

THIS WARRANTY AND REMEDIES SET FORTH ABOVE ARE EXCLUSIVE AND IN LIEU OF ALL OTHER WARRANTIES, REMEDIES AND CONDITIONS, WHETHER ORAL OR WRITTEN, EXPRESS OR IMPLIED. FURRION SPECIFICALLY DISCLAIMS ANY AND ALL IMPLIED WARRANTIES, INCLUDING, WITHOUT LIMITATION, WARRANTIES OF MERCHANTABILITY AND FITNESS FOR A PARTICULAR PURPOSE. IF FURRION CANNOT LAWFULLY DISCLAIM IMPLIED WARRANTIES UNDER THIS LIMITED WARRANTY, ALL SUCH WARRANTIES, INCLUDING WARRANTIES OF MERCHANTABILITY AND FITNESS FOR A PARTICULAR PURPOSE ARE LIMITED IN DURATION TO THE DURATION OF THIS WARRANTY.

No Furrion reseller, agent, or employee is authorized to make any modification, extension, or addition to this warranty.

Warranty

FURRION IS NOT RESPONSIBLE FOR DIRECT, INDIRECT, SPECIAL, INCIDENTAL OR CONSEQUENTIAL DAMAGES RESULTING FROM ANY BREACH OF WARRANTY OR CONDITION, OR UNDER ANY OTHER LEGAL THEORY, INCLUDING BUT NOT LIMITED TO LOST PROFITS, DOWNTIME, GOODWILL, DAMAGE TO OR REPLACEMENT OF ANY EQUIPMENT OR PROPERTY, ANY COSTS OF RECOVERING, REPROGRAMMING, OR REPRODUCING ANY PROGRAM OR DATA STORED IN OR USED WITH FURRION PRODUCTS. FURRION'S TOTAL LIABILITY IS LIMITED TO THE REPAIR OR REPLACEMENT OF THIS PRODUCT PURSUANT TO THE TERMS OF THIS WARRANTY.

SOME STATES DO NOT ALLOW THE EXCLUSION OR LIMITATION OF INCIDENTAL OR CONSEQUENTIAL DAMAGES OR EXCLUSIONS OR LIMITATIONS ON THE DURATION OF IMPLIED WARRANTIES OR CONDITIONS, SO THE ABOVE LIMITATIONS OR EXCLUSIONS MAY NOT APPLY TO YOU. THIS WARRANTY GIVES YOU SPECIFIC LEGAL RIGHTS, AND YOU MAY ALSO HAVE OTHER RIGHTS THAT VARY BY STATE OR (WHERE APPLICABLE IN THE COUNTRIES WHERE FURRION HAS NON-US/CANADIAN AUTHORIZED DEALERS) COUNTRY. NO ACTION OR CLAIM TO ENFORCE THIS WARRANTY SHALL BE COMMENCED AFTER THE EXPIRATION OF THE WARRANTY PERIOD.

Keep your receipt, delivery slip, or other appropriate payment record to establish the warranty period. Service under this warranty must be obtained by contacting Furrion at

warranty@furrion.com

Product features or specifications as described or illustrated are subject to change without notice.

Bienvenue

Merci d'avoir acheté ce système de caméra Vision S de Furrion®. Avant utiliser votre nouvel appareil, veuillez lire ces consignes attentivement. Le présent guide d'utilisation contient des informations permettant l'utilisation, l'installation et l'entretien en toute sécurité de l'appareil.

Veuillez conserver le présent guide d'utilisation en lieu sûr pour vous y référer ultérieurement, afin d'assurer votre sécurité et de réduire les risques de blessure. Veuillez aussi remettre le présent manuel à tout nouveau propriétaire de cet appareil.

Le fabricant décline toute responsabilité en cas de dommages dus au non-respect des présentes consignes.

Si vous avez des questions sur nos produits, veuillez nous contacter : **support@furrion.com**

“Contains Transmitter Module FCC ID: 2ABH3-FCX48TA”

“Contains Transmitter Module IC: 23337-FCX48TA”

This device complies with part 15 of the FCC Rules. Operation is subject to the following two conditions: (1) This device may not cause harmful interference, and (2) this device must accept any interference received, including interference that may cause undesired operation.

Note: The Grantee is not responsible for any changes or modifications not expressly approved by the party responsible for compliance. Such modifications could void the user's authority to operate the equipment.

Note: This equipment has been tested and found to comply with the limits for a Class B digital device, pursuant to part 15 of the FCC Rules. These limits are designed to provide reasonable protection against harmful interference in a residential installation. This equipment generates, uses and can radiate radio frequency energy and, if not installed and used in accordance with the instructions, may cause harmful interference to radio communications. However, there is no guarantee that interference will not occur in a particular installation. If this equipment does cause harmful interference to radio or television reception, which can be determined by turning the equipment off and on, the user is encouraged to try to correct the interference by one or more of the following measures:

- Reorient or relocate the receiving antenna.
- Increase the separation between the equipment and receiver.
- Connect the equipment into an outlet on a circuit different from that to which the receiver is connected.
- Consult the dealer or an experienced radio/TV technician for help.

The device has been evaluated to meet general RF exposure requirement.

To maintain compliance with FCC's RF exposure guidelines, this equipment should be installed and operated with a minimum distance of 20cm between the radiator and your body.

This device complies with Industry Canada licence-exempt RSS standard(s). Operation is subject to the following two conditions: (1) this device may not cause interference, and (2) this device must accept any interference, including interference that may cause undesired operation of the device.

Le présent appareil est conforme aux CNR d'Industrie Canada applicables aux appareils radio exempts de licence. L'exploitation est autorisée aux deux conditions suivantes : (1) l'appareil ne doit pas produire de brouillage, et (2) l'utilisateur de l'appareil doit accepter tout brouillage radio électrique subi, même si le brouillage est susceptible d'en compromettre le fonctionnement.

The device has been evaluated to meet general RF exposure requirement. To maintain compliance with RSS-102 — Radio Frequency (RF) Exposure guidelines, this equipment should be installed and operated with a minimum distance of 20cm between the radiator and your body.

le dispositif de a été évalué à répondre généralement aux exigences de l'exposition aux ondes radioélectriques, pour maintenir la conformité avec les directives d'exposition du RSS-102-Radio Fréquence (RF). ce matériel doit être installé et exploité à une distance minimale de 20 cm entre le radiateur et votre corps.