

orbic[®] Buds

True Wireless Ear Headphones

User Manual



Contents

1. Product Overview-----	1
2. Basic operating functions-----	2
3. Bluetooth Pairing and Connection -----	4
4. Earbud LED Indicator -----	5
5. Remaining Power in the Charging Case LED Indicator-----	6
6. Charging LED Indicator-----	7
7. Charging-----	8
8. Product Specification-----	9
9. Cautions and Q & A -----	10

1. Product Overview

Device Layout: Orbic buds

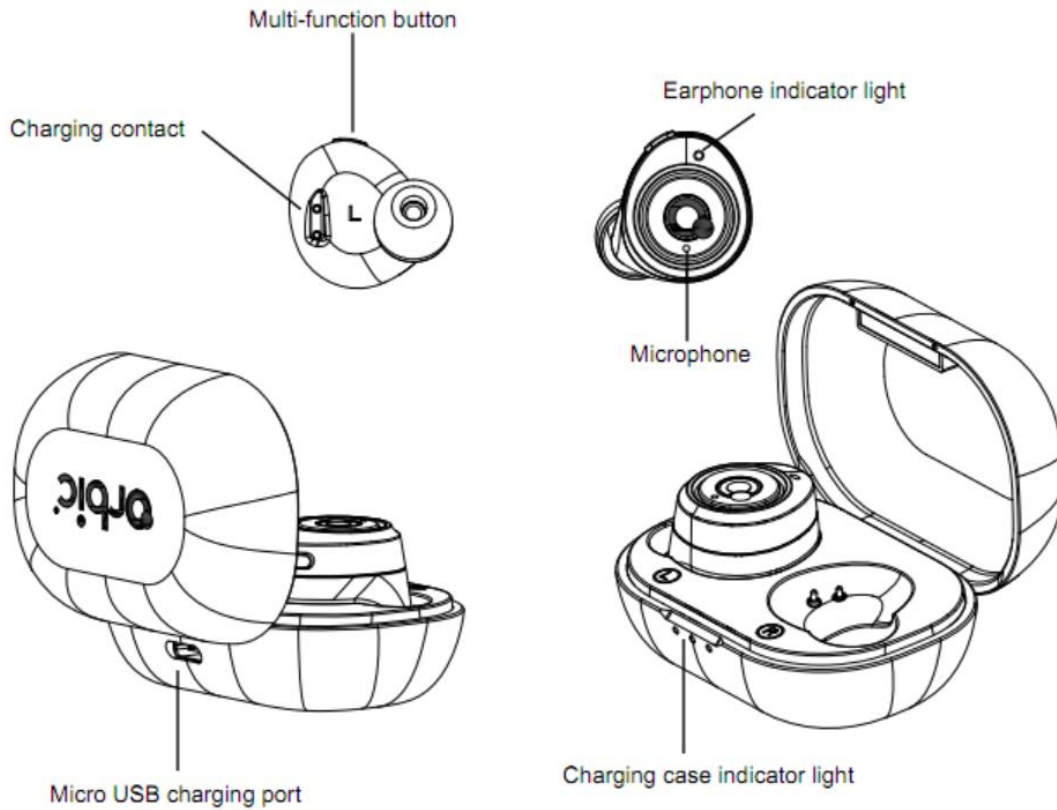

Package Contents :

- A) Orbic Buds (True Wireless Ear Headphones) 1 set
- B) User manual 1pcs

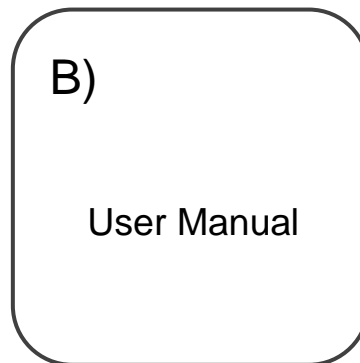
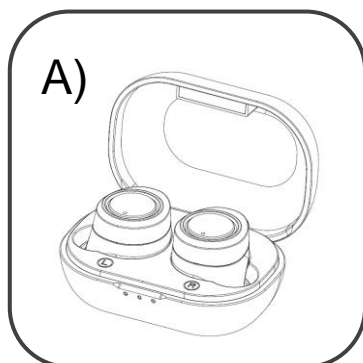

2.Basic operating functions

Button	Function	Operation instruction
Multi-function button	Power On	The headset can be turned on by opening the cover in the charging box (it will be automatically connected to the last connected device if there is pairing record).
	Power Off	1. Put the earphone into the charging case to turn it off. 2.10 minutes no connection or battery voltage lower than 3.0V. 3. When disconnected, click the multi-function key 3 times to clear the pairing shutdown.
	Left / Right pairing	The earbuds can be paired automatically by putting it into the charging case and opening the cover. The Left / Right pairing record is cleared by this.
	Low power alarm	When the battery level is low, "Battery Low" alarm sounds every three minutes.
	Automatic shutdown	If the pair is disconnected more than 10 minutes, or the battery voltage is lower than 3.0V, earbuds are automatically shut down
	Switching main and secondary	Put the main earbud into the charging box and turn it off while talking or listening to music, the secondary earbud will connect with the mobile phone and turn to the host. In TWS(True Wireless Stereo) mode, either of an earbud will be put into the charging box, the other earbud can keep working.
	Bluetooth pairing	When the left and right earbuds are paired successfully (or disconnected from the Bluetooth device), the main earbud automatically enters the Bluetooth pairing mode (blue LED blinks).
	Previous Song	Double click the "multi-function button" on the left earbud to playback the previous song.
	Play / Pause	Press the "multi-function button" to play/pause the music (for both of left and right earbuds).
	Next Song	Double click the "multi-function button" on the right earbud to switch to the next song.
	Volume Up	Hold down the multifunction button on the right earbud more than one second to increase the volume. When the volume reaches maximum level, buds generate beep.

	Volume Down	Hold down the "multi-function button" on the left earbuds more than one second to reduce the volume.
	Answer a call	Press the "multi-function button" to answer the incoming call (either of earbud).
	Hang up a call	Press the "multi-function button" to hang up the ongoing call (for both of earbuds).
	Reject a call	Long press the "multi-function button" for 1 second to reject the incoming call (for both of earbuds).
	Wake up voice assistant	In standby or music mode, tap the "multi-function button" on the right earbud to activate the voice assistant of the mobile phone (right ear operation) (*This requires mobile phone support).
	Clearing pairing records	<p>When the phone is unconnected to standby, press the "multi-function button" 3 times, indicate the red and blue lights flash 3 times at the same time, the earbuds can clear pairing records (including mobile phone pairing records and TWS pairing records).</p> <p>Notes: When clearing pairing records, need to click the "multi-function key" of two earbuds 3 times to turn off TWS. When two earbuds are put into the charging box at the same time, the TWS brothers will be paired automatically after activation; if a single earbud is put into the charging box and activated, the blue light will flash slowly waiting for the TWS brothers to pair up.</p>

3. Bluetooth Pairing and Connection

For the first connection, pick out the earbuds from the charging case, and the earbuds automatically enters the Bluetooth pairing (main earbud blue LED blinks; No LED for secondary earbud lights). In case there were connection record before, by turning on the earbuds, the pairing is restarted to connect back.

1) pairing

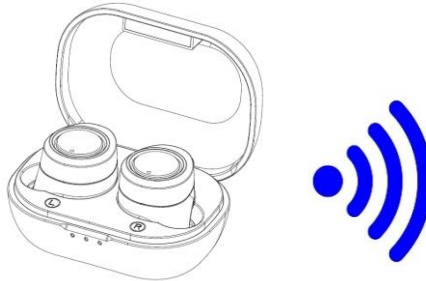

After powering on, main earbud's blue LED blinks and starts pairing

2) connection

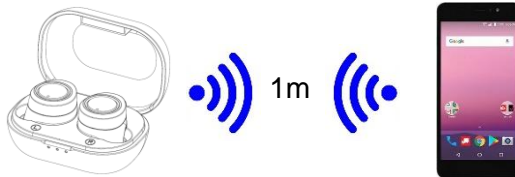

Turn on the Bluetooth device & Bluetooth, search and click "Orbic Buds" for pairing and connection

4. Earbud LED Indicator

Mode	LED Indicator
Power on	Blue LED flashes 1 second
Power off	Red LED flashes 1 time
Left / Right pairing	Blue LED blinks
Bluetooth pairing	Blue LED blinks
Connected standby	No LED indicator
Clearing pairing records	Red and blue LED blink 3 times simultaneously
Talking status	No LED indicator
Music playing status	No LED indicator
Charging	Red LED steadily turns on
Fully charged	Red LED turns off
Low power level	Red LED blinks every 4 seconds

5.Charging Case LED Indicator

Mode	LED Indicator of Charging Case
Remaining power: 0-5%	The first indicator blinks at 1Hz for 4sec, then turns off
Remaining power: 5%-33%	The first indicator lights for 4sec, then turns off
Remaining power: 33%-66%	The first and second indicator lights for 4sec and turns off
Remaining power: 66%-100%	The first, second and third indicator lights are on for 4sec, then turns off

6. Charging LED Indicator

Mode	LED Indicator
Charged 0%-33%	The first indicator blinks at 1Hz
Charged 33% - 66%	The first indicator is always on, the second indicator blinks at 1Hz
Charged 66% - 99%	The first and the second indicators are always on, the third indicator blinks at 1Hz
Fully charged	Three indicators are steadily on

7.Charging

When the Orbic Buds' battery remains low, red light blinks. Charge the earbuds immediately. It takes 2 hours around to be fully charged. When the red light turns off, the battery is fully charged.

A. Earbuds charging

Plug the earbuds into charger box, close the cover to charge the earbuds.

B. Charging case charging

Connect the USB connector of the micro-USB charging cable to the charging box to charge the charging box.

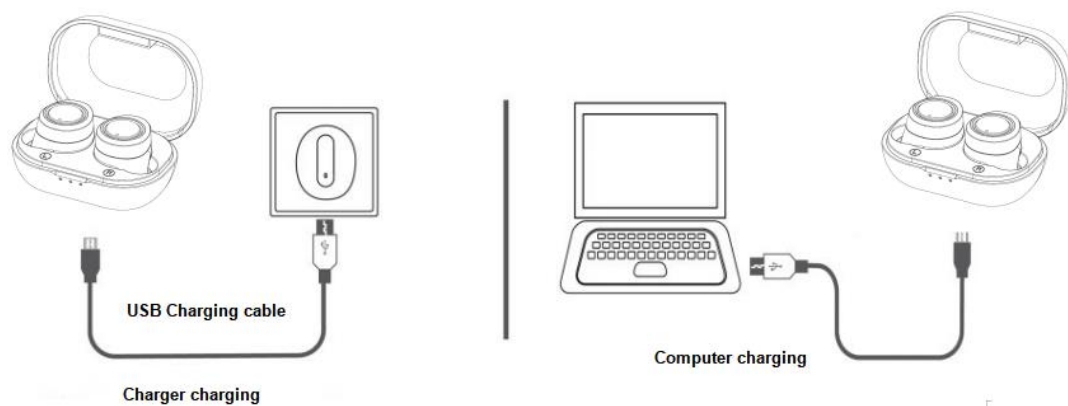

*Notice :

When Orbic Buds are not in use, please charge them at least once per 2 months.

8.Product Specification

Bluetooth Version	Bluetooth V5.2
Bluetooth Chipset	BT8926B
Communication Distance	10 meters
Operation Range	Up to 10 meters
Bluetooth Protocols	HFP, HSP, AVRCP, A2DP
CODEC Code	SBC,AAC
Talking Time	Earbuds : About 3.5 hrs @ 70% volume Use with charging case : About 10.5 hrs @70% volume
Call the noise reduction	Single microphone ENC call
Music Time	Earbuds : About 5 hrs @70% volume Use with charging case : About 15 hrs @70% volume
Stand-by Time	About 45 hrs
Battery Capacity	Earbuds : 3.7V 45mAh Charging case : 3.7V 350mAh
Working temperature	-10°C - 55°C
Net weight	Total : 40g (Earbuds : 5g*2 ; Charging case : 30g)

*Actual use time will differ from environment and music

9. Cautions and Q & A

A . How to connect back? What should I do if I can't connect back? How to reconnect after long-distance disconnection?

In case earbuds are connected to mobile phone successfully, it will automatically connect to the mobile phone every time turn it on. If the connection fails, re-pair the connection. It is required to be able to connect back within 10 minutes. After 10 minutes, it will automatically shut down. After a long-distance disconnection, it will only report once (Disconnected) and start pairing. It will report (Connected) when it returns to the connectable range within 10 minutes.

B. How to clear the pairing records?

When the phone is not connected to standing-by, triple press the "multi-function button" to indicate red and blue lights blinks 3 times at the same time, then the earbuds can clear pairing records (including mobile phone pairing records and TWS pairing records).

Notes: When clearing, need to click the "multi-function key" of two earbuds 3 times, to power off TWS. When the two earbuds are put into the charging box to activate, TWS will be paired automatically after activation. In case a single earbud is placed into the charging box, when activated, blue light flashes slowly waiting for brother TWS to pair up. If the pairing record is cleared, the connection cannot be traced back, need to pair the connection again.

C. What's the pairing password ?

Some connection devices require password for pairing. Please try 0000 or 8888 or 1111 or 1234.

D. What devices could charge for the earbuds?

Charging case charging: Charging Orbic Buds by putting the earbuds into the case and closing the cover.

E. What to do if there are some abnormalities such as unable to boot, abnormal connection, etc.?

Charging reset can be tried, the method is: close the charger box 3sec to reset (note that the problem caused by rapid opening and closing repeatedly, may fail to reset).

F. When earbuds will automatically be shut down?

Automatic shutdown without connection for more than 10 minutes, or battery voltage is less than 3.0V.

NOTE: This equipment has been tested and found to comply with the limits for a Class B digital device, pursuant to part 15 of the FCC Rules. These limits are designed to provide reasonable protection against harmful interference in a residential installation. This equipment generates uses and can radiate radio

frequency energy and, if not installed and used in accordance with the instructions, may cause harmful interference to radio communications. However, there is no guarantee that interference will not occur in a particular installation. If this equipment does cause harmful interference to radio or television reception, which can be determined by turning the equipment off and on, the user is encouraged to try to correct the interference by one or more of the following measures:

- Reorient or relocate the receiving antenna.
- Increase the separation between the equipment and receiver.
- Connect the equipment into an outlet on a circuit different from that to which the receiver is connected.
- Consult the dealer or an experienced radio/TV technician for help

Changes or modifications not expressly approved by the party responsible for compliance could void the user's authority to operate the equipment.

This device complies with Part 15 of the FCC Rules. Operation is subject to the following two conditions:

(1) this device may not cause harmful interference, and (2) this device must accept any interference received, including interference that may cause undesired operation.

This device contains licence-exempt transmitter(s)/receiver(s) that comply with Innovation, Science and Economic Development Canada's licence-exempt RSS(s). Operation is subject to the following two conditions:

(1) This device may not cause interference.

(2) This device must accept any interference, including interference that may cause undesired operation of the device.

L' émetteur/récepteur exempt de licence contenu dans le présent appareil est conforme aux CNR d' Innovation, Sciences et Développement économique Canada applicables aux appareils radio exempts de licence. L' exploitation est autorisée aux deux conditions suivantes :

(1) L' appareil ne doit pas produire de brouillage;

(2) L' appareil doit accepter tout brouillage radioélectrique subi, même si le brouillage est susceptible d' en compromettre le fonctionnement.

FCC ID: 2ABGH-ORBIC

- End of manual -