

# User Manual

## Bluetooth Speaker

**BS901**

**FCC ID:2ABFFBS901**

### Operation Instructions

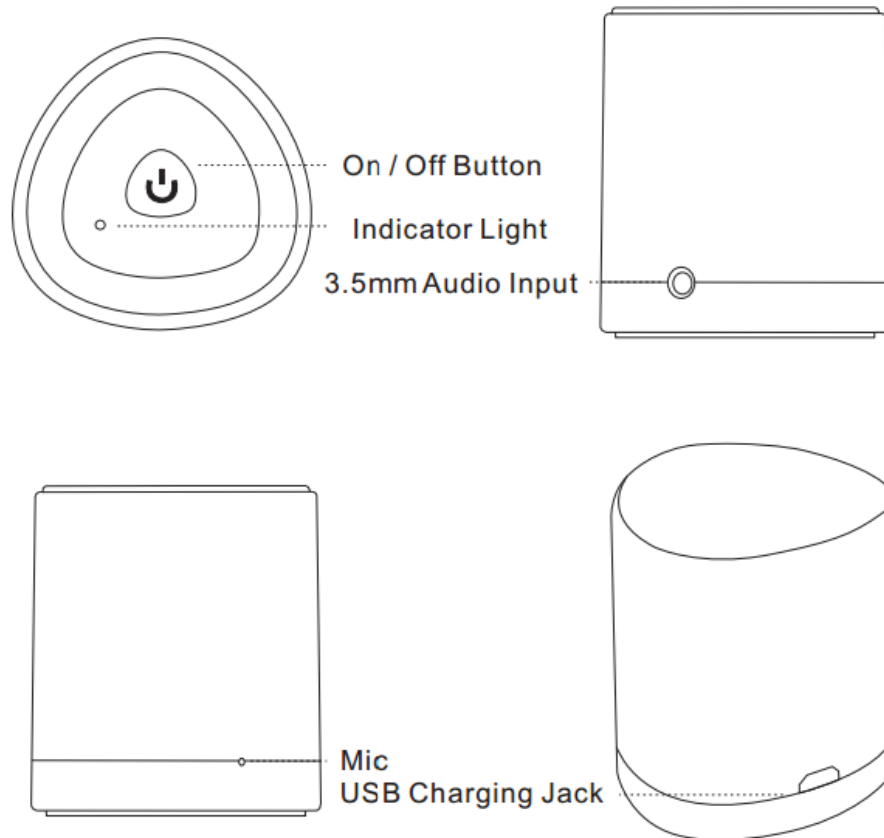

### Power on

When the speaker is off, press and hold the Multi-function Button (MFB) for 3 seconds, the LED indicator will flash in blue with one second. Meantime, you will hear warning tone from the speaker .

### Power off

When the speaker is on, press and hold the MFB for 5 seconds, the LED indicator will flash fast in red with three times. Meantime, you will hear warning tone from the speaker .

### Pairing mode

When the speaker is off, press and hold the MFB for 7seconds ,the LED indicator will flashes red

and blue in alternating and waiting for connection on automatically, you will hear warning tone from the speaker, which indicates the speaker is in pairing mode and can be connected with Bluetooth devices

## **Answering calls**

If a call comes in when listening to the music or speaker standby, press MFB to answer the incoming call, the music will be paused during that time, after finished your call, music will be playing on automatically.

## **End calls**

Press MFB button to terminate a phone call, music will restart automatically if you are listening to previously.

## **Reject calls**

If a call comes in when listening to the music or speaker standby, press and hold MFB for 2 seconds to reject the call.

## **Last number redial**

When listening to the music or speaker standby, double press MFB to redial the last number, the music will be paused during that time.

## **Transferring voice**

When calling on the cellphone, press and hold MFB for 3 seconds to transfer the voice between speaker and cellphone.

## **Pause and restart music**

When listening to the music, click MFB to pause the music, click MFB again to restart it.

## **Line in USB mode**

If speaker standby, insert use 3.5 line in USB on device to play music directly

## **Battery energy**

When connect with iPhone device, there will show battery energy of speaker.

## **Power off automatically**

If the speaker is on and not connected within 5 minutes, speaker will off automatically.

## Charging

Charging voltage:5V

Charging time:  $2\pm 0.5H$

Voltage after complete charging:4.10~4.20V

## Battery low

Red LED will flashes twice every one minute if the voltage between 3V and 3.3V ,and power off when it below 3V.

## Reconnect automatically

When speaker on,it will connect with previous cellphone automatically.

When the distance between speaker and cellphone over 10 meters,they will loss link.If back within 5 minuets,then will reconnect.

## LED Indicator Status

Power on	Blue LED lights 1 second
Power off	Red LED flashes 5 time with fast
Charging	Red LED lights
Charging complete	Blue LED lights
Power on (Standby)	Blue LED flash once every five seconds
Power on (Connect and standby)	BlueLED flashes twice every seven seconds
Power on (Talking)	Blue LED flash once every each second
Power on (Incoming call)	Blue LED flashes once each second
Power on (Playing music with Bluetooth)	Blue LED flashes once every two seconds
Battery low	Red LED flashes twice every minuter
Pairing mode	LED flashes in red and blue alternatively

This device complies with part 15 of the FCC rules. Operation is subject to the following two conditions:

- (1) this device may not cause harmful interference, and
- (2) this device must accept any interference received, including interference that may cause undesired operation.

Changes or modifications to this unit not expressly approved by the party responsible for compliance could void the user's authority to operate the equipment.