

Apolosign

PackGo Briefcase Smart Screen

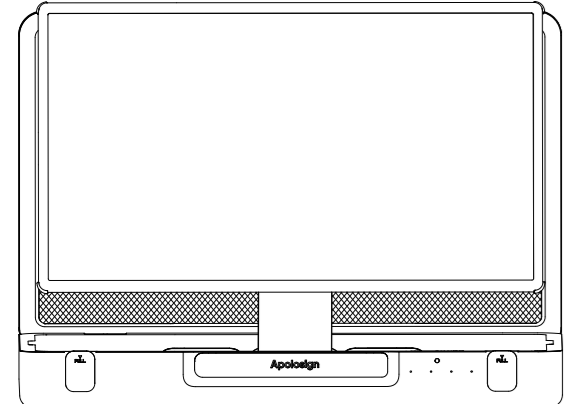

USER GUIDE

Please read the manual before using this product, and save it for future use.

Catalogue

- Preface.....2
- Warning.....2
- Packing List.....3
- Product Specifications.....4
- Product usage method.....5
- Port connection instructions.....6
- Key Description.....6
- Touch Function Description.....7
- Instructions for built-in battery.....7
- Projection.....8
- Download application software.....8
- Instructions for using the remote control.....9

Preface

Thank you for choosing a portable smart screen! Before starting up, please carefully read this user manual to understand the usage methods and precautions of this device.

Warning

- The device can only use the power AC cable accessories provided by the original factory.
- The gaps and openings on the machine are used for ventilation and heat dissipation. Do not block or cover up these gaps and openings.
- Do not use or store this machine in dusty, humid, or high-temperature environments. When the female machine malfunctions, please do not disassemble and repair it yourself. Please contact the original factory or dealer to resolve the issue.
- Avoid stepping on the AC power cord to avoid potential hazards such as electric leakage caused by line damage. If the wire of the power AC line is damaged, do not continue use, otherwise danger may occur.
- In thunderstorm weather or when not using this device for a long time, please unplug the power cord.
- When using, please do not place the machine on the edge of the table or in areas that are easily accessible to children to avoid machine damage or injury. Children.
- During transportation, please do not forcefully squeeze the display screen. Do not use sharp tools or hard objects to damage the display screen, as this may cause damage to the display screen.
- Please use a dry soft cloth or a soft cloth slightly dipped in a flexible cleaning agent to clean the machine. Do not use any type of solvent, such as alcohol or gasoline, otherwise it may damage the surface treatment layer.
- It is important to make children aware of the dangers of climbing this product, as falling or tipping it over can cause serious personal injury.
- Women should not place products in unstable or tilted positions.
- Be sure to tidy up the cables connected to the product in a timely manner to avoid tripping, pulling, or grabbing them.

Packing List

After opening the packaging, please confirm the packaging content below.



Display1



Power line1

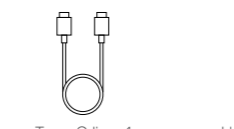

Type C line1



User Manual1



Bluetooth remote control1

Product Specifications

Different models have different configurations.

System	CPU	RK3588 Eight core
	RAM	8GB
	Memory	128GB
	Operation system	Android 12
Specifications	Panel Size	27"LCD
	Resolution	1920*1080
	Number of points	10-Point
	Aspect Ratio	16:9
Interface	Wi-Fi	802.11b/g/n/a/ac/ax (Wi-Fi 6), Bluetooth 5.2
	DP IN	Charging (output), DP IN(input)
	AC Power input	Input Voltage AC100V ~ 240V
	Rocker switch	Control the motherboard battery switch
	Type-c	[Output] Display+Data Transmission
	USB	USB Host*1
	HDMI IN	1920*1080@60HZ
Other	VESA	100x75mm
	Key	Power/Volume+/Volume-
	Gravily Sensor	Supports 90° rotation
	Hall switch	Close the top cover to sleep, open the top cover to automatically turn on/wake up the screen (The power switch of the entire machine is turned on)
	Speaker	Built in 4 microphones, supporting noise reduction and echo cancellation
	Microphone	4Ω/10W/4
	Battery pack capacity	14.4V / 6800mAh
Storage temperature	-20°C---60°C	
Operation temperature	-15°C---60°C 10-90%RH	

Product usage method

1. Place the product on a flat surface, facing upwards.



2. Connect the power cord for first use. AC power port Located inside the left cover on the back of the product.

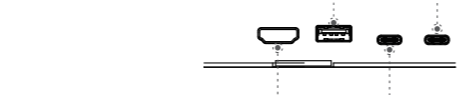

3. Unlock the front latch of the product and open the upper cover.



4. Please lift the display screen upwards, with the screen facing forward.



5. Please pull the display screen upwards as much as possible and then rotate it clockwise (Cannot rotate counterclockwise).

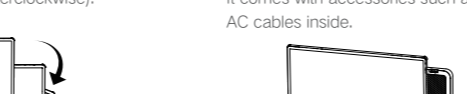

6. Please open the groove located at the bottom of the product with slight force. It comes with accessories such as power AC cables inside.

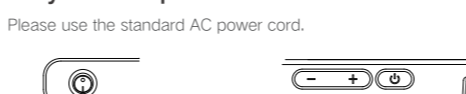

7. Open the port cover located on the left side of the product and check the battery switch button.



When the battery switch is in the off direction, it can prevent discharge.

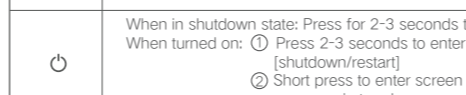

⚠ After inserting the power cord plug into the wall to supply power to the box, move the product as small as possible to avoid the risk of electric leakage caused by forceful pulling or damaging the power cord.

Port connection instructions

Rich Interfaces, supporting multiple external device connections

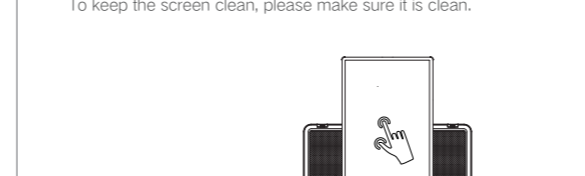

HDMI IN : Used to connect external high-definition video signal inputs.
USB : Can be used with USB storage device or for mouse and keyboard receiver.
DP IN : Multi functional interface 1. supports PD fast charging protocol, with adaptive four stage voltage output of 5V/9W/12V/15V Maximum 18W. 2. Supports DP screen mirroring and can connect mobile phones

TYPE-C : Connect Type-C docking station, which can be connected to USB drives, mice, etc.

Key Description

Please use the standard AC power cord.

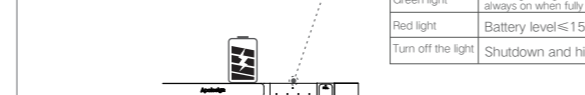

Button	Function
	When pressed in the direction: Power off status of the entire machine When pressed in the direction: Power on status of the entire machine
	When in shutdown state: Press for 2-3 seconds to turn on the device When turned on: Press 2-3 seconds to enter shutdown confirmation [shutdown/restart] Short press to enter screen rest mode, then short press again to release screen rest
	Adjust the system volume to increase
	Adjusting the system volume to decrease

⚠ After inserting the power cord plug into the wall to supply power to the box, move the product as small as possible to avoid the risk of electric leakage caused by forceful pulling or damaging the power cord.

Touch Function Description

Adopting IPS full HD ten point capacitive touch LCD display screen. To keep the screen clean, please make sure it is clean.

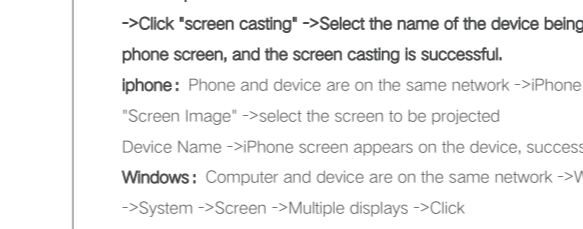

Instructions for built-in battery

This product box is equipped with a built-in power supply board and rechargeable battery, which can be used for a period of time without connecting to other power sources. After the battery runs out, connect the power AC cable to charge the device. When the power AC cable is connected, the power indicator light will turn red. As the battery level increases, the power indicator light will turn green until it is fully charged.

	Battery level ≥ 15%
	Flashing during AC charging, please do not touch the indicator light.
	Battery level < 15%
	Shutdown and hibernation

⚠ Pay attention to: As the product's service life increases, the battery life will decay to a certain extent, which is a normal phenomenon. To extend the battery life, it is recommended to charge the battery after using it for a period of time. After the battery is fully charged, unplug the power AC cable. Do not keep the battery fully charged and do not charge it in extreme environments. ⚠ The standard usage time in the manual is based on the laboratory test data of our company, and the actual time may vary depending on the usage conditions.

Projection

Wireless screen mirroring, supporting multiple protocols: Apple AirPlay, Miracast, Android DLNA.

Android phone: Phone and device are on the same network ->Phone enters the shortcut menu ->Click "screen casting" ->Select the name of the device being cast ->The device displays the phone screen, and the screen casting is successful.

iPhone : Phone and device are on the same network ->iPhone enters the shortcut menu ->click "Screen Image" ->select the screen to be projected
Device Name ->iPhone screen appears on the device, successful screen mirroring.

Windows : Computer and device are on the same network ->Windows enters: Settings ->System ->Screen ->Multiple displays ->Click "Connect to wireless display" ->Select the name of the device being projected ->The device appears on the screen, and the projection is successful.

Mac : Computer and device are on the same network ->Mac enters preference settings ->Display ->Add display ->Select the screen projection setting
Backup Name ->The device appears on the screen, and the screen mirroring is successful.

Audio and video push : The projection device and the device are on the same network ->The projection device enters the video APP ->Select the video ->Click on the video

Download application software

Overseas : Enter the "Google Play Store" on the device, log in to the Google account, select the downloaded application, and then install successfully.
Domestic : Enter the "App Store" on the device, select the downloaded application, and then install it successfully.

Instructions for using the remote control

- Click the Settings button in the upper right corner of the main page.
- Click on [Connected Devices]
- Click [+to pair with new device]
- Simultaneously press and hold the return and function buttons on the remote control, and release it after the indicator light on the remote control keeps flashing.
- Under [Available Devices], a new connected device Remote Controller appears, select Remote Controller Pairing devices.
- The interface will display a pairing inquiry. Click on pairing and the remote control will be set successfully.

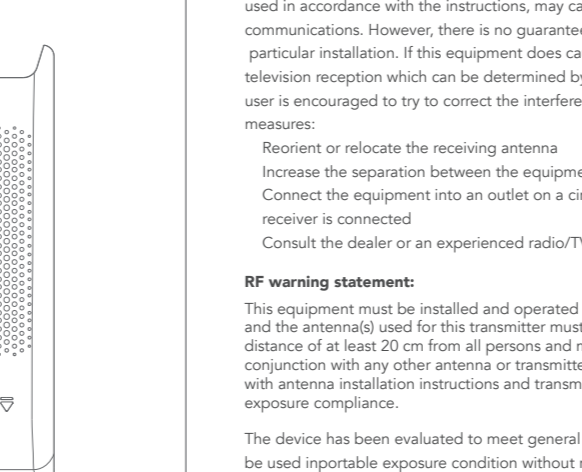

Attention: Due to safety regulations, the remote control is not equipped with batteries by default. Please purchase two No. 5 batteries yourself.

The remote control is only for auxiliary use and is currently only suitable for the following applications:
1. Tiktok and Kwai video brushing; press up and down on the remote control to switch between video brushing (you can't like or comment on the remote control)
2. Mango TV, Cool Meow Video, TV Home; Suitable for all situations.

FCC STATEMENT

This device complies with Part 15 of the FCC Rules. Operation is subject to the following two conditions:
1. This device may not cause harmful interference
2. This device must accept any interference received, including interference that may cause undesired operation.
Warning: Changes or modifications not expressly approved by the party responsible for compliance could void the user's authority to operate the equipment
NOTE: This equipment has been tested and found to comply with the limits for a Class B digital device, pursuant to Part 15 of the FCC Rules. These limits are designed to provide reasonable protection against harmful interference in a residential installation. This equipment generates uses and can radiate radio frequency energy if not installed and used in accordance with the instructions, may cause harmful interference to radio communications. However, there is no guarantee that interference will not occur in a particular installation. If this equipment does cause harmful interference to radio or television reception which can be determined by turning the equipment off and on, the user is encouraged to try to correct the interference by one or more of the following measures:

- Reorient or relocate the receiving antenna
- Increase the separation between the equipment and receiver.
- Connect the equipment into an outlet on a circuit different from that to which the receiver is connected
- Consult the dealer or an experienced radio/TV technician for help.

RF warning statement: This equipment must be installed and operated in accordance with provided instructions and the antenna(s) used for this transmitter must be installed to provide a separation distance of at least 20 cm from all persons and must not be co-located or operating in conjunction with any other antenna or transmitter. End-users and installers must be provided with antenna installation instructions and transmitter operating conditions for satisfying RF exposure compliance.
The device has been evaluated to meet general RF exposure requirement. The device can be used inportable exposure condition without restriction.

FC This device complies with parts of the FCC rules. Operation is subject to the following two conditions:
This device will not cause harmful interference.
This device must accept any interference received, including interference that may cause undesired operation.
CE This product complies with the essential requirements of European safety regulations and has passed the product safety conformity assessment procedure. It also has a manufacturer's declaration of conformity to ensure that every product delivered to the customer is safe.