



Bluetooth speaker

User Manual

MODEL: D8

ACCESSORIES

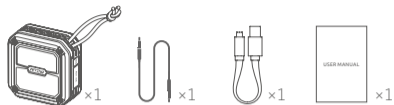

Wireless Speaker ×1
Audio cable ×1

USB Cord ×1
Instruction Book ×1

SPECIFICATION

Bluetooth Version	V2.1+EDR
Frequency Range	2 402-2 4835GHz
Bluetooth Mode	A2DP/AVRCP/HFP/HSP
Bluetooth Range	>10m
Battery Capacity	800mAH
Playing time	6~8hours
Waterproof level	IPX7
Size	L80×W80×H35 mm
Weight	182g

PRODUCT DIAGRAM

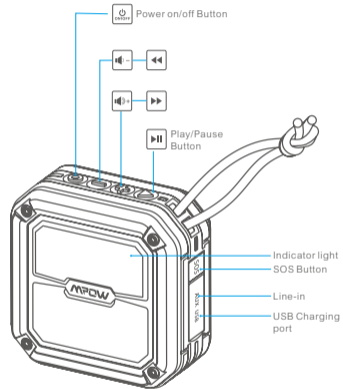

CHARGING THE SPEAKER

You must charge the speaker fully before using the speaker for the first time.

1. Connect the USB charging cable to the USB charge port of the speaker. The red indicator will turn on when charging and turn off when charging completed.
2. The full charge takes about 2~3hours.

LOW-VOLTAGE ALERT

When the battery low alert tone sounds about every 60 seconds Indicate that the battery has run out. Please change Mpow AquaPro as soon as possible.

POWER ON/OFF

POWER ON: Long press the "Ⓞ" for about 2 seconds until the blue indicator light turns on with indication tone.

POWER OFF: Long press the "Ⓞ" for about 3 seconds until the blue indicator light turns off with indication tone.

3

PAIR TO YOUR PHONE

- ① Long press the "Ⓞ" for about 2 seconds until the blue indicator light turns on with indication tone. Then long press "▷" for about 2seconds with indication tone.

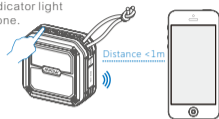

- ② Turn on the Bluetooth function of your phone, Search for the Bluetooth devices and select "Mpow AquaPro"with indication tone.

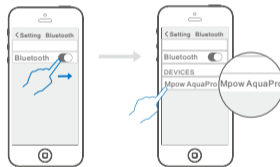

- ③ Enter the code "0000" if needed.

- ④ If pairing is successful, the blue indicator turns on.



4

AUTOMATIC CONNECT

It will connect to the last connected phone automatically when it turns on.(Please make sure the Bluetooth function of your phone is on before turn on the speaker.)

PLAYING MUSIC

Play/Pause: Short press "⏮"
Next song: Long press "⏮"
Previous song: Long press "⏭"
Volume up: Short press "⏮"
Volume down: short press "⏭"

ANSWERING/ENDING A CALL

press "⏮" to answer an incoming call and press again to end a call. Double press "⏮" to answer reject an incoming call.

SOS Button ▷

Long press "sos" 2second to activate "SOS function".

Long press "sos" 2second to shut off "SOS function".

FCC NOTE:

This device complies with Part 15 of the FCC Rules.

Operation is subject to the following two conditions: (1) this device may not cause harmful interference, and (2) this device must accept any interference received, including interference that may cause undesired operation.

THE MANUFACTURER IS NOT RESPONSIBLE FOR ANY RADIO OR TV INTERFERENCE CAUSED BY UNAUTHORIZED MODIFICATIONS OR CHANGE TO THIS EQUIPMENT. SUCH MODIFICATIONS OR CHANGE COULD VOID THE USER'S AUTHORITY TO OPERATE THE EQUIPMENT.

5

This equipment has been tested and found to comply with the limits for a Class B digital device, pursuant to part 15 of the FCC Rules. These limits are designed to provide reasonable protection against harmful interference in a residential installation. This equipment generates, uses and can radiate radio frequency energy and, if not installed and used in accordance with the instructions, may cause harmful interference to radio communications. However, there is no guarantee that interference will not occur in a particular installation. If this equipment does cause harmful interference to radio or television reception, which can be determined by turning the equipment off and on, the user is encouraged to try to correct the interference by one or more of the following measures:

- Reorient or relocate the receiving antenna.
- Increase the separation between the equipment and receiver.
- Connect the equipment into an outlet on a circuit different from that to which the receiver is connected.
- Consult the dealer or an experienced radio/TV technician for help.

Caution: Any changes or modifications not expressly approved by the party responsible for compliance could void the user's authority to operate this equipment.