

PowerPort Wireless 5 Charging Pad

DE:
JP:
FR:
IT:
ES:
CN:
AR:

1

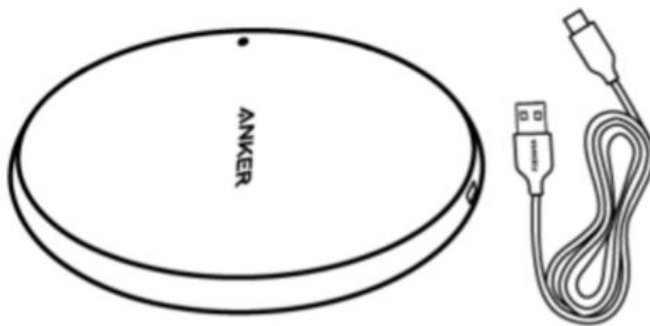

Safety Sheet + Quick Start Guide

2

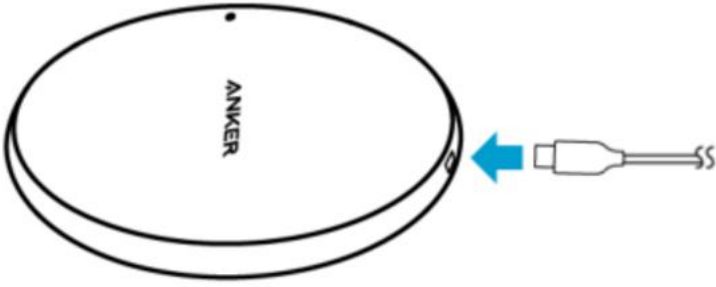

3

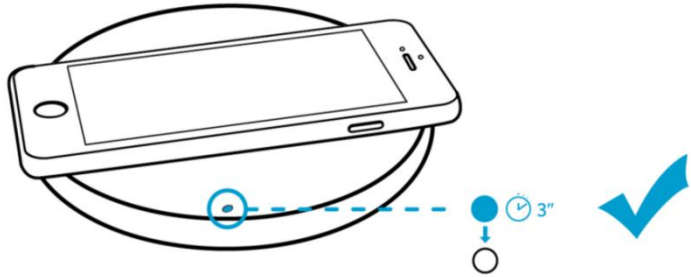
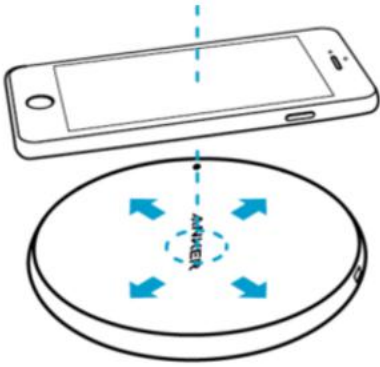

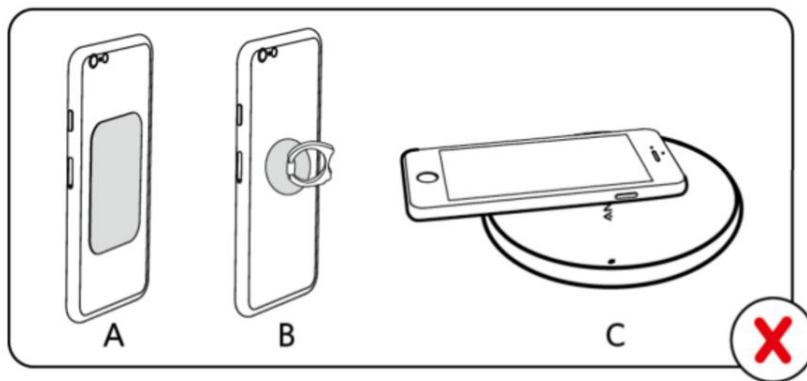
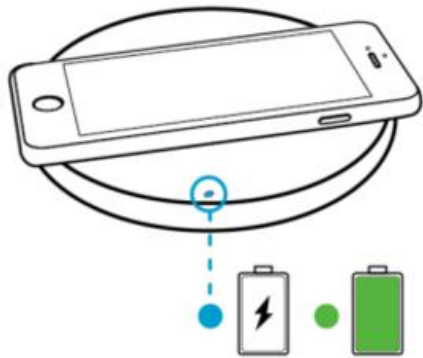

[Add Picture: Don't put the card on the wireless charger]

Compatible Devices:

Devices supporting wireless charging, including:

- iPhone 8, iPhone 7s Plus and iPhone 7s
- Samsung Galaxy S series such as S8+, S8, S7, S7 edge, S6 edge, S6 edge plus, S6 and so on
- Most other mobile phones compliant with the Qi wireless charging standard.

LED Indicator	Status
Solid blue for 3 seconds, then off	When connected to power
Solid blue	When charging your mobile phone
Solid green	When fully charged
Flashing blue	Metal detected between your mobile phone and your PowerPort / Abnormal temperature detected

Important Safety Instructions

- Avoid dropping.
- Do not disassemble.
- Do not expose to liquids.
- For the safest and fastest charge, use original or certified cables.
- The product is suitable for moderate climates only.
- The maximum ambient temperature during use of the product must not exceed 40°C.
- Naked flame sources, such as candles, must not be placed on the product.
- If you want to clean the product, use only with dry cloths or a brush.

FCC Statement

This device complies with Part 15 of the FCC Rules. Operation is subject to the following two conditions: (1) This device may not cause harmful interference, and (2) this device must accept any interference received, including interference that may cause undesired operation.

Warning: Changes or modifications not expressly approved by the party responsible for compliance could void the user's authority to operate the equipment.

Note: This equipment has been tested and found to comply with the limits for a Class B digital device, pursuant to Part 15 of the FCC Rules. These limits are designed to provide reasonable protection against harmful interference in a residential installation.

This equipment generates, uses and can radiate radio frequency energy and, if not installed and used in accordance with the instructions, may cause harmful interference to radio communications. However, there is no guarantee that interference will not occur in a particular installation. If this equipment does cause harmful interference to radio or television reception, which can be determined by turning the equipment off and on, the user is encouraged to try to correct the interference by one or more of the following measures: (1) Reorient or relocate the receiving antenna. (2) Increase the separation between the equipment and receiver. (3) Connect the equipment into an outlet on a circuit different from that to which the receiver is connected. (4) Consult the dealer or an experienced radio / TV technician for help.

Radiation Exposure Statement

This equipment complies with FCC radiation exposure limits set forth for an uncontrolled environment. This equipment should be installed and operated with minimum distance of 20cm between the radiator & your body.

Specifications

Input	5 V == 2 A
-------	------------

Output	5 V == 1 A
Size	100 x 100 x 9.5 mm / 3.9 x 3.9 x 0.4 in
Weight	Pending

4. Operating frequency: 110khz-205khz

5. Charging efficiency: 73% (MAX)

Product Number: A2518

Wireless Charger



Indoor use only



The product shall not be disposed together with the normal waste. It must be recycled.

EN: Customer Service

IT: Servizio Clienti

AR: خدمة العملاء

EN: 18-month Limited Warranty

IT: Garanzia valida 18 mesi

AR: ضمانة 18 شهراً محدودة

EN: Lifetime Technical Support

IT: Assistenza post-vendita a vita

AR: الدعم الفني مدى الحياة

Anker Technology Co., Limited

Room 1318-19, Hollywood Plaza, 610 Nathan Road, Mongkok, Kowloon, HongKong

Declaration of Conformity

Hereby, Anker Technology Co., Limited declares that the product type **A2518** is in compliance with Directive 2014/53/EU. The full text of the EU declaration of conformity is available at the following internet address:

<https://www.anker.com/products>

+1 (800) 988 7973 (US) Mon-Fri 9:00 - 17:00 (PT)

+44 (0) 1604 936200 (UK) Mon-Fri 6:00 - 11:00 (GMT)

+49 (0) 69 9579 7960 (DE) Mon-Fri 6:00 - 11:00

+81 03 4455 7823 (日本) 月-金 9:00 - 17:00

+86 400 0550 036 (中国) 周一至周五 9:00 - 17:30

For FAQs and more information, please visit

<https://www.anker.com/support>



@Anker
@Anker Japan
@Anker Deutschland



@AnkerOfficial
@Anker_JP



@Anker



- When connecting a charger (not supplied) to your PowerPort, do not use an uncertified one to avoid damage to the wireless charger.
- Using an ultra-thick protective phone case or a case with magnetic/iron plate is not recommended, as it may affect the wireless charging function.