

**Model:WM781**

# Instruction Manual

RF2.4GHz Optical Mouse

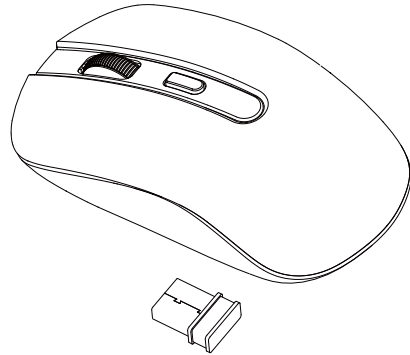

**CAUTION:**To use this device properly, please read the user's guide before installation

## Installing the Batteries

The RF2.4GHz optical mouse use one AA alkaline batteries.

Installing Batteries in the Mouse

Step1 open the upper cover

Step2. Insert the battery as shown inside the battery compartment.

Step 3. Replace upper cover

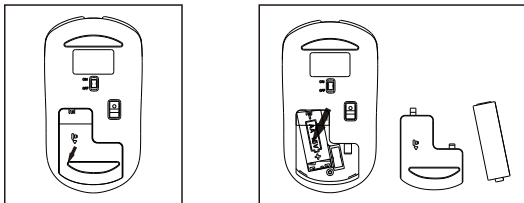

## Connecting the Receiver

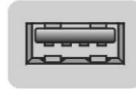

USB Port



Nano receiver

1. Connect the USB plug ONLY to USB port of the computer

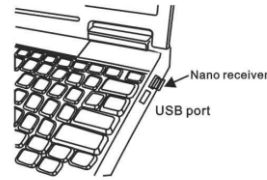

## Obtain the receiver on the cover

1:when you want use the mouse,you can take out the receiver to computer by the list ① step;

2:when you need stop the work or to travel, you can store the receiver on the mouse for the moving by the list ② step;

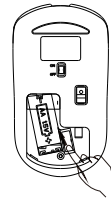

Take out the receiver



Store the receiver

## Power-Save function:

\*This mouse is equipped with Traveling-Power-Save function. When you are traveling with this mouse, the LED of the mouse will be switched off automatically for the purpose of power-save, but the pre-condition is that the receiver is disconnected with your notebook or PC.

\*when your mouse no any click or scroll or moving,the mouse will cme to sleep state for the economize after about 30 minutes, for the wake up,you can click any button for this

## Characteristics

Ergonomic design for good hand feeling

High precision optical engine

2.4G Hz RF transmission: up to 10m

Self-storing nano receiver,easy to take

Compatible with computers of various systems and brand

## FCC STATEMENT :

This device complies with Part 15 of the FCC Rules. Operation is subject to the following two conditions:

(1) This device may not cause harmful interference, and (2) This device must accept any interference received, including interference that may cause undesired operation.

Warning: Changes or modifications not expressly approved by the party responsible for compliance could void the user's authority to operate the equipment.

NOTE: This equipment has been tested and found to comply with the limits for a Class B digital device, pursuant to Part 15 of the FCC Rules. These limits

are designed to provide reasonable protection against harmful interference in a residential installation. This equipment generates uses and can radiate

radio frequency energy and, if not installed and used in accordance with the instructions, may cause harmful interference to radio communications.

However, there is no guarantee that interference will not occur in a particular installation. If this equipment does cause harmful interference to radio or

television reception, which can be determined by turning the equipment off and on, the user is encouraged to try to correct the interference by

one or more of the following measures:

Reorient or relocate the receiving antenna.

Increase the separation between the equipment and receiver.

Connect the equipment into an outlet on a circuit different from that to which the receiver is connected.

Consult the dealer or an experienced radio/TV technician for help.