

Owner's Guide

BT-572S Bluetooth Earphone

xcentz™

Device Layout

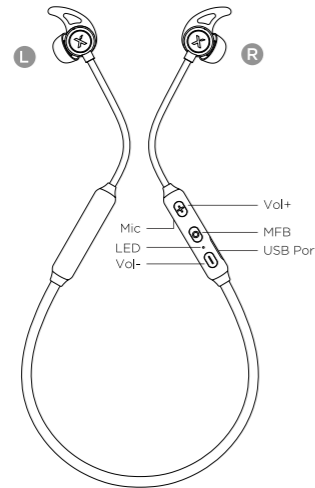

How to Connect

1. Power off the earphones and hold MFB for 2s to power on again and the earphones will auto enter pairing mode.
2. On cellphone, search for xcentz_xBuds_S2 and tap to connect.

Note: Earphones will auto enter pairing mode upon any disconnectivity with current device.

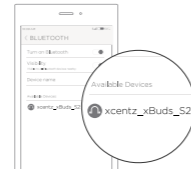

How to Charge

LED will be solid red when charging and turn to blue once topped up.

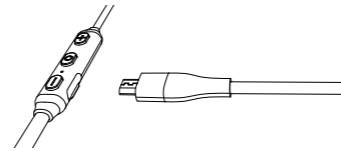

Functions

- Power On:** Hold MFB for 2s (LED blinks blue).
- Power Off:** Hold MFB for 3s (LED blinks red).
- Voice Assistant:** When standby, hold MFB for 1s to activate Voice Assistant (like Siri).
- Play/Pause:** Press MFB to play /pause the audio. Press once to pause and press again to play.
- Adjust Volume:** Press Vol +/- button on earphone to increase or decrease audio volume.
- Previous/Next:** When playing music, hold Vol +/- button for 2s to play the previous/next audio file.
- Answer Call:** Press MFB to answer incoming call.
- Ignore Call:** Hold MFB for 2s to ignore incoming call.
- End Call:** During a call, press the MFB to end the call.
- Last Number Redial:** When standby, double press MFB.
- Mute On:** During a call, double press MFB to switch mute on/off.
- Switch Audio Output:** During a call, hold MFB for 2s to switch audio output between cellphone and earphones.
- Three-way Calling & Switch:** Press MFB to answer incoming call from phone 1. If another call is coming from phone 2 in sync, press MFB to put the first call in hold while activate the second call. Double press MFB to switch between the held call and the active call.

Note:

- For some cellphones, when an incoming call is answered on cellphone, you might need to press Audio Button and select the earphone to switch talking from cellphone to earphone. If the call is answered by earphone, you can talk with earphone directly.
- The Last Number Redial feature is phone dependent.

xcentz™

Features

The earphones have double moving coil, you can get superb bass sound, as well as rich and crisp sound.

Bluetooth 5.0 has lower power consumption, longer connection range, and more stable connection.

Water & sweat resistant, durable, and suitable for almost any environment.

For the techies...

Model	xBuds_S2
Bluetooth Version	V5.0
Operation Range	10 m (with no obstacle)
Bluetooth Profiles	HFP / A2DP / AVRCP
Music Time	Approx. 6 hr
Standby Time	Approx. 150 hr
Charging Time	Less than 2 hr
Battery Capacity	100 mAh
Input	5 V \pm 100 mA
Weight	0.7 oz / 21 g

Multi-point Connection

Method 1:

1. Refer How to Connect to build connection with phone 1.
2. On phone 1, turn off Bluetooth and the earphones will auto enter pairing mode.
3. On phone 2, search for xcentz_xBuds_S2 and tap to connect.
4. On phone 1, search for xcentz_xBuds_S2 and tap to finish Multi-point Connection.

Method 2:

1. Refer How to Connect to build connection with phone 1.
2. Then hold both Vol+ and Vol- to enter pairing mode.
3. On phone 2, search for xcentz_xBuds_S2 and tap to connect.
4. On phone 1, search for xcentz_xBuds_S2 and tap to finish Multi-point Connection.

Safety Information

Here are some helpful tips for how to safely use your device.

Please read them. Ignoring these instructions could result in damage to your device :(

- To reduce the risk of injury, close supervision is necessary when the device is used near children.
- Do not open, crush, bend, or puncture the device.
- Do not use harsh chemicals or strong detergents to clean the device.
- Do not expose the device to rain or snow. Do not spill coffee on the device, drop it in beer, or get it wet with liquid of any kind.
- Do not use the device that is damaged or modified. Damaged or modified device may exhibit unpredictable behavior resulting in risk of injury.

- Do not disassemble the device. Take it to a qualified service person when service or repair is required.
- Do not expose the device to fire or excessive temperature.
- Use the chargers made by the qualified manufacturer.
- Have servicing performed by a qualified repair person using only identical replacement parts. This will ensure that the safety of the device is maintained.

FCC Notice and Cautions

This device and its accessories comply with Part 15 of FCC Rules. Operation is subject to the following conditions:

1. This device and its accessories may not cause harmful interference.
2. This device and its accessories must accept any interference received, including interference that may cause undesired operation.

Returns & Warranty

At Xcentz, it is our mission to make awesome products that last. This is why we let all of our customers try them out for 30 days. If you're not totally thrilled with your purchase, you can return it for a full refund.

If one of our products breaks down from normal wear and tear within your first 18 months of ownership, let us know and we'll send you a new one.

- 30-Day Full Refund
- 18-Month Limited Warranty
- Lifetime Technical Support

For easy returns and replacements, please visit our website at: xcentz.com

Customer Support

If you have any questions or need more help, give us a call or drop us an email. We'll get back to you within 24 business hours.

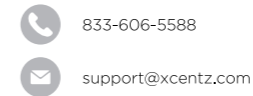

Follow us on social to see what we're working on and help us decide what to make next!

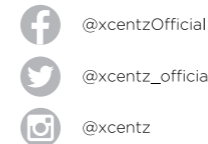

FCC STATEMENT :

This device complies with Part 15 of the FCC Rules. Operation is subject to the following two conditions:
(1) This device may not cause harmful interference, and
(2) This device must accept any interference received, including interference that may cause undesired operation.
Warning: Changes or modifications not expressly approved by the party responsible for compliance could void the user's authority to operate the equipment.

NOTE: This equipment has been tested and found to comply with the limits for a Class B digital device, pursuant to Part 15 of the FCC Rules. These limits are designed to provide reasonable protection against harmful interference in a residential installation. This equipment generates uses and can radiate radio frequency energy and, if not installed and used in accordance with the instructions, may cause harmful interference to radio communications. However, there is no guarantee that interference will not occur in a particular installation. If this equipment does cause harmful interference to radio or television reception, which can be determined by turning the equipment off and on, the user is encouraged to try to correct the interference by one or more of the following measures:
Reorient or relocate the receiving antenna.
Increase the separation between the equipment and receiver.
Connect the equipment into an outlet on a circuit different from that to which the receiver is connected.
Consult the dealer or an experienced radio/TV technician for help.

RF warning statement:
The device has been evaluated to meet general RF exposure requirement. The device can be used in portable exposure condition without restriction.