

# POWER ACOUSTIK

## PCD-42B

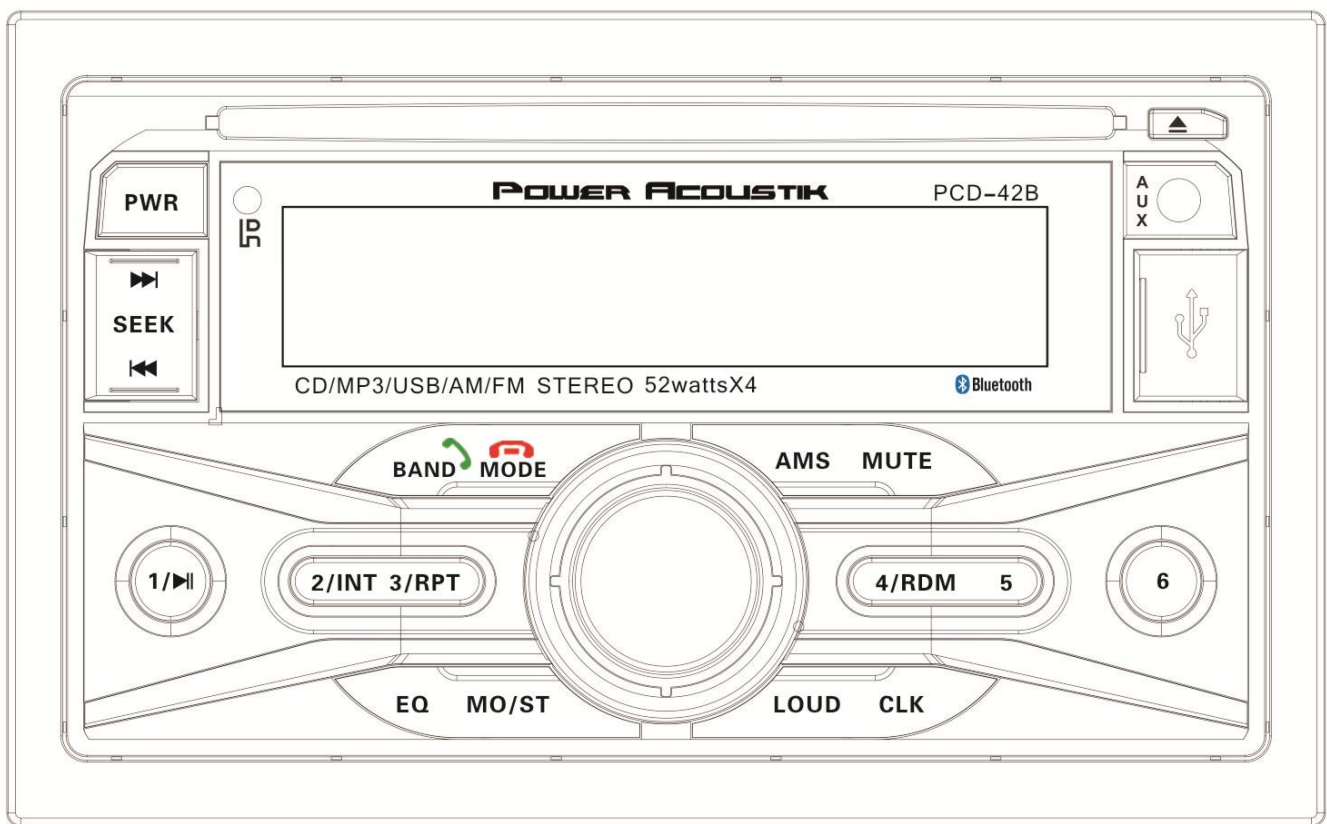



# Owner's Manual

Take the time to read through this owner's manual.

Familiarity with installation and operation procedures will help you obtain the best Performance from your new CD-receiver.

# CONTENTS

|  |    |
|--|----|
| CONTENTS   | 01 |
| PRECAUTION   | 02 |
| ACCESSORY  | 03 |
| INSTALLATION (UN-INSTALLATION)   | 04 |
| WIRING DIAGRAM   | 05 |
| CONTROL PANEL  | 06 |
| BASIC OPERATION  | 07 |
| POWER  | 07 |
| IR SENSOR  | 07 |
| DISC SLOT  | 07 |
| LCD DISPLAY  | 07 |
| T-DN/T-UP  | 07 |
| BAND  | 07 |
| MODE  | 07 |
| 1 \ PAUSE \ PLAY   | 07 |
| 2 \ INT  | 08 |
| 3 \ RPT  | 08 |
| 4 \ RDM  | 08 |
| 5  | 08 |
| 6  | 08 |
| EQ   | 08 |
| MO/ST  | 08 |
| SELECT   | 08 |
| VOLUME   | 08 |
| LOUD   | 08 |
| CLK  | 08 |
| AMS  | 08 |
| MUTE   | 09 |
| USB SOCKET   | 09 |
| AUX IN   | 09 |
| BLUETOOTH SECTION  | 10 |
| REMOTE CONTROL   | 11 |
| SPECIFICATION & FEATURE  | 12 |
| TROUBLESHOOTING  | 13 |

## **PRECAUTION**

This unit is designed and manufactured with consideration of user's safety, however any improper use or operation may result in a certain hazard or misuse. So it is highly recommended to read this manual thoroughly and adhere to the following precaution.

### **SAFETY PRECAUTION**

- ✧ To prevent an electrical shock, do not open the housing of the unit.
- ✧ In any case of malfunctioning, only have the unit serviced by an approved and qualified service centre.
- ✧ Do not expose to any water drop and put under the heavy moisture, high humidity environment or operate when your hands are wet. It may cause electrical shortage.
- ✧ For safety driving, keep the volume low in order to concentrate on traffic condition.
- ✧ Do not clean the unit with alcohol, only clean with a soft and dry cloth.
- ✧ If the unit has been kept in high temperature or high humidity area, cool down the car interior before turning on the unit.
- ✧ Do not use the unit for a long time without running vehicle's engine, it may drain the battery and the vehicle may not be able to start engine.
- ✧ Before final installation into indash hole, connect the wiring and make sure the unit is working properly.
- ✧ Use only the parts provided with the unit to ensure proper installation.
- ✧ Do not route wiring in places that get hot if the insulation of the wiring may be melted
- ✧ When replacing fuse, be sure to use only the same rating fuse prescribed on this unit

### **OPERATION PRECAUTION**

- ✧ Please dispose empty batteries used to Remote Controller according to the regulations in your country.
- ✧ If the unit is disconnected with the battery, the unit will lose memorized data.
- Design and specification may vary in the operation manual from the actual product.

# ACCESSORY

Package will include in the following accessories for installation and operation the unit.

## Installation Accessory

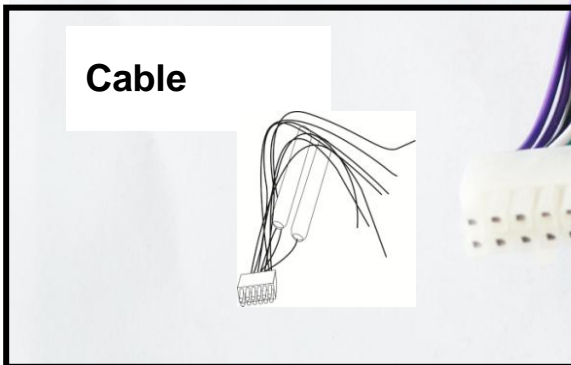
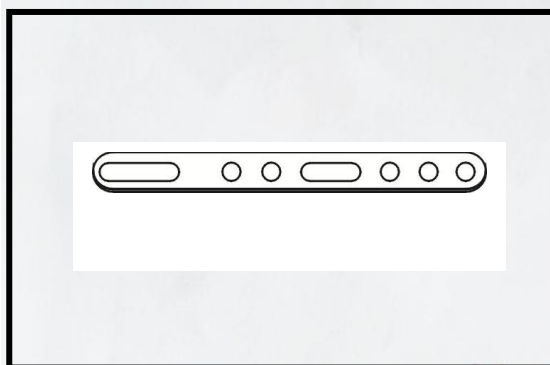
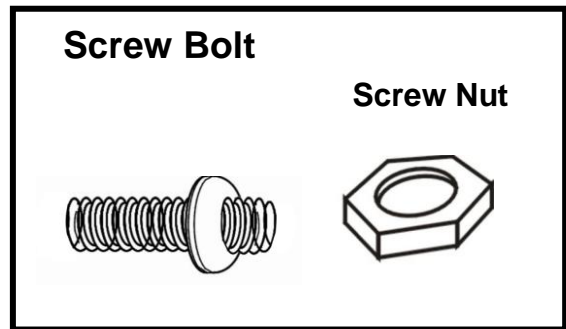
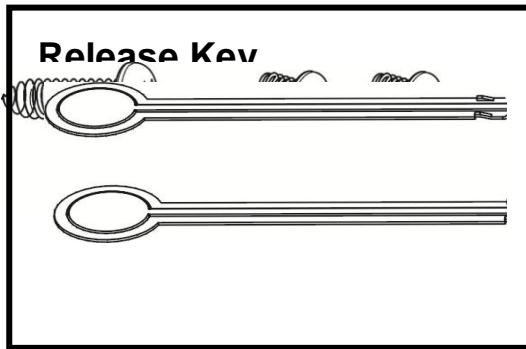

美灿电子科技有限公司

# Installation/Un-Installation

First complete the electrical connections, and then check them for correctness.

## Installation/Un-installation

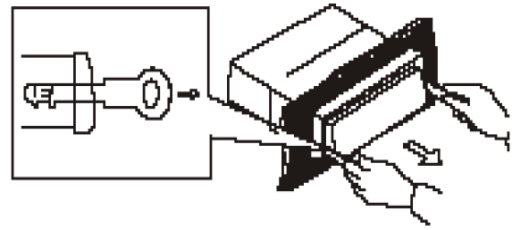

Mounting Method A

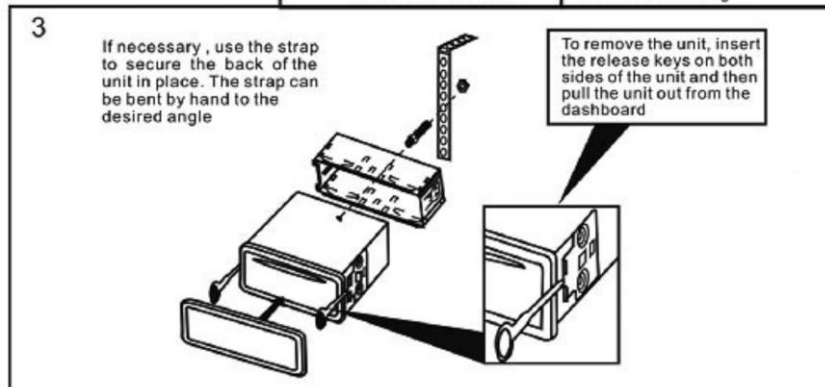
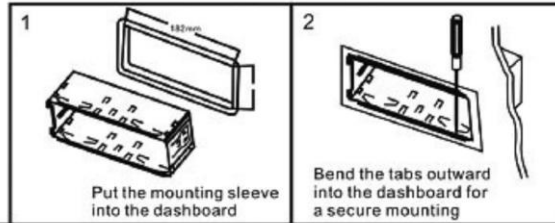

## WIRING DIAGRAM

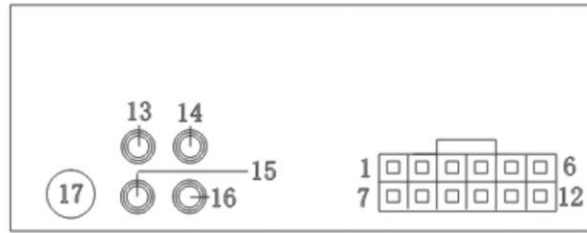

- 1、 Purple: Right Rear +
- 2、 Gray: Right Front +
- 3、 White: Left Front +
- 4、 Green: Left Rear +
- 5、 Blue: Auto Antenna (Fuse 0.5A)
- 6、 Yellow:ACC B+(Fuse 15A)
- 7、 Purple/Black:Right Rear -
- 8、 Gray/Black: Right Front -
- 9、 White/Black: Left Front -
- 10、 Green/Black: Left Rear -
- 11、 Red: Connect to Ignition Key switch 12V DC(Fuse 1A)
- 12、 Black:ACC B-
- 13、 Red RCA:Line out-Right Front
- 14、 Red RCA:Line out-Right Rear
- 15、 White RCA:Line out-Left Front
- 16、 White RCA:Line out-Left Rear
- 17、 Car Antenna INT

# CONTROL PANEL

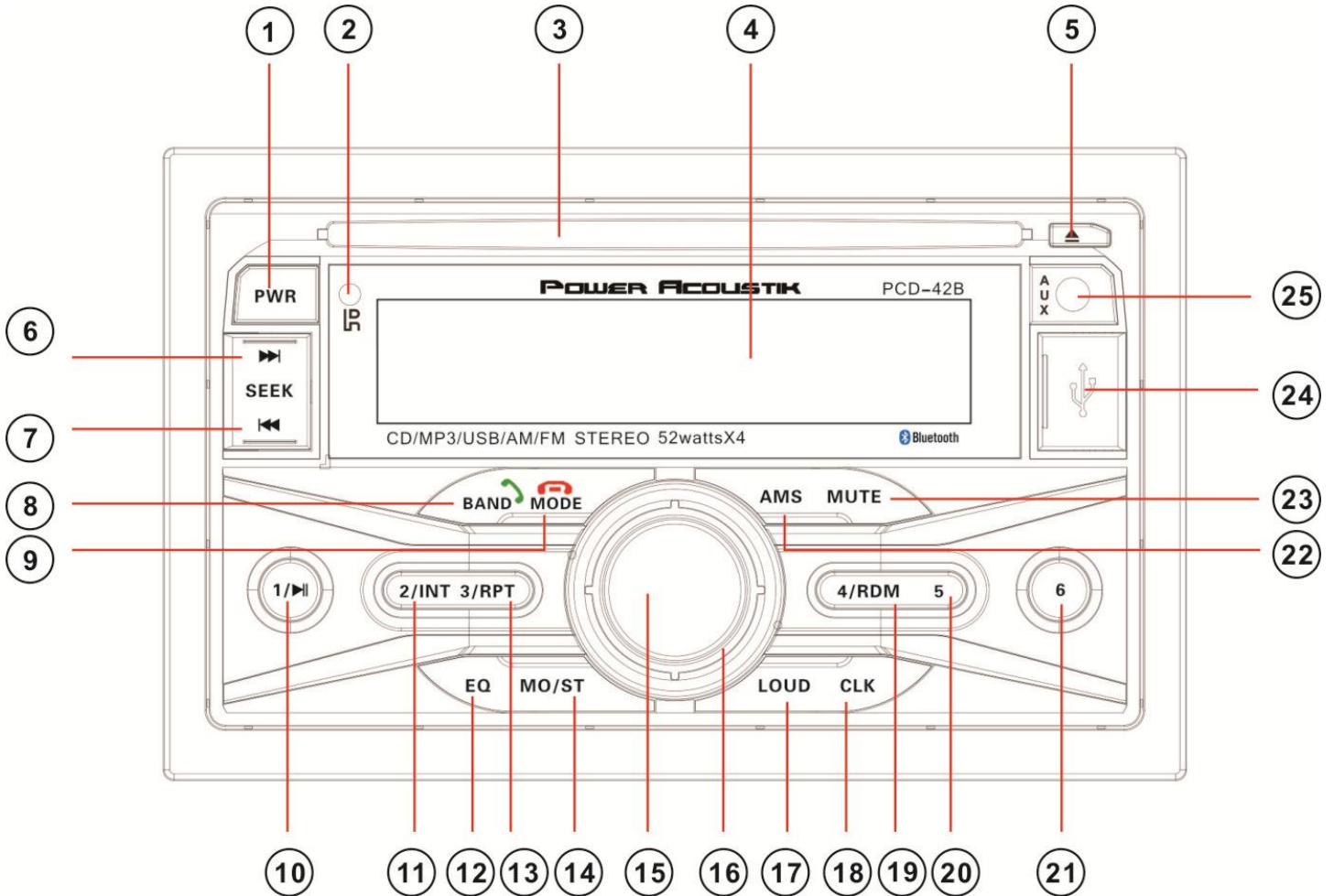

- |           |                   |             |               |
|-----------|-------------------|-------------|---------------|
| 1 POWER   | 2 IR SENSOR       | 3 DISC SLOT | 4 LCD DISPLAY |
| 5 EJECT   | 6 T-UP            | 7 T-DN      | 8 BAND        |
| 9 MODE    | 10 1/PAUSE \ PLAY | 11 2/INTCLK | 12 EQ         |
| 13 3/RPT  | 14 MO/ST          | 15 SELECT   | 16 VOL        |
| 17 LOUD   | 18 CLK            | 19 4/RDM    | 20 5          |
| 21 6      | 22 AMS            | 23 MUTE     | 24 USB SOCKET |
| 25 AUX IN |                   |             |               |

## BASIC OPERATION

### 1. POWER

Press [POWER] button to turn on the unit. Press again to turn off the unit.

### 2. IR SENSOR

### 3. DISC SLOT

Insert a disc with MP3 and/ or WMA files into the CD slot with label side up. The first file in the first folder will start to play.

### 4. LCD DISPLAY

Display screen

### 5. EJ ( DISC EJECT )

Press to eject Disc inside the CD slot. If disc is not removed after ejecting, disc re-loaded automatically without playing.

### 6./7. /

- Tune Up / Down in Radio Mode,

Manual Tuning Mode : Press more than 3 seconds to search a station in manually and press button to tune each frequency step upward or downward

Seek Tuning Mode : Press to search a next or previous station automatically

-Track Up (FF) / Down (REW) In SD, USB ,CD Mode,

**Track Up / down** : Press to move to next or previous Track

**Track FF / FR** : Press more than 3 seconds to activate fast forward (FF) or fast reverse (FR) search in a track

### **8.**

#### - BAND

In Radio Mode , Move to radio band in the sequence of

FM1 -> FM2 -> FM3->AM1-AM2

In Bluetooth mode, Press the answer the phone.

### 9. MODE

Short press to change mode in the sequence of TUNER -> (\* CD) -> (\* SD) -> (\*USB) -> AUX -> TUNER

In BLUETOOTH mode, press to reject a coming call or hang up while calling.



---

## 10\11\13\19\20\21 PRESET STATION No. 1 ~ 6 / Pause, INT, RPT, RDM, +10, -10 - Preset Button (In Radio mode)

Press [1-6] button to select the radio station memorized in each buttons. Press for more than 2 seconds to memorize the current station to teach preset buttons (Manual Station Store).

- In CD, USB, SD Slot mode, each button performs below function.

**[PAUSE]:** Repeat pause -> play.

**[INT]:** Play beginning of every track for about 10 seconds.

**[RPT]:** Press to play same track repeatedly, press again to cancel.

**[RDM]:** Play every track randomly

**[-10 / +10]:** Move to the previous or next 10 tracks.

## 12.EQ

Press it to choose Audio Effect: CLASSIC->POP ->ROCK -> EQ OFF

## 14.MO/ST

- **STEREO/ MONO:** Turn the knob to select STEREO -> MONO under FM mode only.

## 15.SELECT

Multimedia and confirm button, and the time to choose hours/minutes.

In the radio state,press it to enter the SOUND SETTING menu: BAS-> TRE -> BAL -> FAD -> LOUD -> EQ(CLASSIC->POP ->ROCK -> EQ OFF)->DX->STEREO->VOL-> BAS

In the CD/USB/SD state,press it to enter the SOUND SETTING menu: BAS-> TRE -> BAL -> FAD -> LOUD -> EQ(CLASSIC->POP ->ROCK -> EQ OFF) ->VOL-> BAS

## 16.VOLUME

Adjust knob, clockwise rotation for + / counterclockwise rotation for- ( including Volume/time/EQ)

## 17.LOUD

Turn on LOUD,Voice become louder.

## 18.CLK

Clock time display.Press button to show time, long press and rotate vol button to adjust clock time.

## 22. AMS

AS: In tuner mode, Press this button for longer than 2 seconds to store best reception radio station to preset buttons automatically

- PS: In tuner mode, Press this button to scan the preset memorized station, each preset scan for 5 seconds.

Press again to stop operation

- In CD, USB, SD Card mode, press to start Music File Search Menu.

Press the button again and menu is changed to the following sequence.

File Number Search -> File Name Search

-> Root Name Search -> EXIT Search

---

## **23.MUTE**

Short press to mute on, short press again to mute off.

## **24. USB SOCKET**

Insert a USB Flash Storage Device and music starts to play automatically. LCD display.

Support Music File Format: MP3, WMA Files

## **25. AUX IN**

AUX IN socket

## BLUETOOTH SECTION



**Warning:** Driving and having a Telephone conversation at the same time is dangerous, please park your car before having a telephone conversation. The supplier waves any and all liability when this warning is not followed.

1. Power on

2. Open the Bluetooth of mobile phone → Search for Bluetooth devices → Choose a name for the "POWER ACOUSTIK" Bluetooth devices → Connect the Bluetooth (The first time use when you need to enter the passcode "0000" to connect Bluetooth.)

3. After pairing is successful, the machine displays BT ON once, and then transferred to the current mode, when operating the phone call with music or a call comes in, the machine will automatically turn Bluetooth mode.

4. If you do not operate the phone or no call comes, it will automatically be reversed current mode, you can press MODE to Bluetooth mode.

5. Any time an incoming call, the machine will automatically switch to Bluetooth mode and display the caller's telephone number in the LCD display. You can press  to answer the incoming call, or press  to reject it.

6. During a call, you can switch on the phone to the handset, the machine does not support this

7. When playing music via A2DP, on the machine panel, enabling play / pause, previous track, next track operation.

8. When the phone away from the machine will automatically disconnect the Bluetooth, it will automatically connect to a Bluetooth when the phone close to the machine .

Note: The machine can only be paired with a Bluetooth phone connection. When the machine and the phone is paired, you can not pair with other phones.

# REMOTE CONTROL

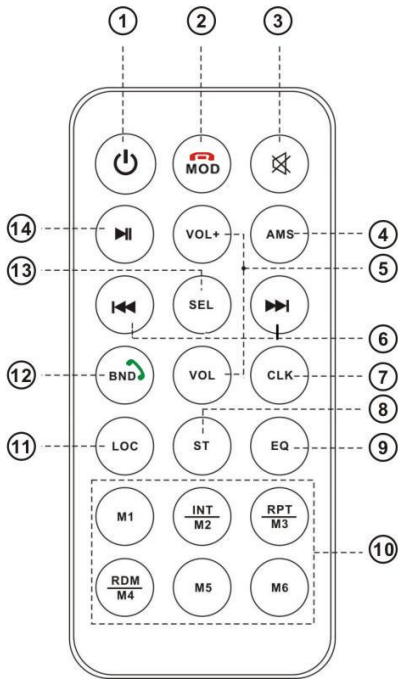

|   |  |
|---|--|
| 1 POWER   | 8 MO/ST  |
| 2  MOD | 9 EQ   |
| 3 MUTE  | 10 1,2/INT,3/RPT,4/RDM,5,6   |
| 4 AMS   | 11 LOC   |
| 5 VOL+/VOL-   | 12  BND |
| 6 T-DN/ T-UP  | 13 SEL   |
| 7 CLK   | 14 PAUSE \ PLAY  |

## (Place the Battery)

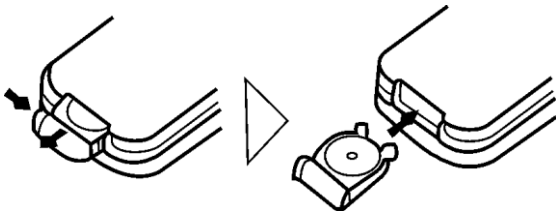

To install the battery, open the battery compartment, insert the CR2025 3V cell battery and observe that the correct “+” and “-” polarities on the battery are matching the marks inside the compartment.

## Usage of Remote Control

- ✧ Use the remote control within 7 meters (approx. 21 feet) from the IR window of the unit.
- ✧ Keep within -30 °and +30 °angle.

## Care of Remote Control

- ✧ Keep the battery out of reach of children. Children may swallow.
- ✧ Remove the battery if it is not used for a month or more.
- ✧ Do not short-circuit, disassemble or heat the battery.
- ✧ Do not dispose of battery into fire or flame.

## **SPECIFICATION**

### **FM TUNER**

Frequency Range ----- 87.5 ~ 107.9MHZ

Usable Sensitivity ----- 18 dBuV

Stereo Separation ----- 30 dB

### **AM (MW) TUNER**

Frequency Range ----- 530 ~ 1710KHz

Usable Sensitivity ----- 35 dBuV

### **ELECTRIC**

Power Supply ----- DC 11 ~ 15 Volt

Current Consumption ----- < 10 Amere

Load Impedance ----- 4 Ohm

Dimensions ----- 178mm (W) x 175mm (D) x 50mm (H)

Power Output ----- 4 x 52W (Max)

Line Output ----- 1.2 V

## **FEATURE**

### **PLAYBACK**

MP3, WMA, playback with ID3 Tag Display

File and Folder Search

USB Firmware Up gradable

### **TUNER**

AM/FM Radio Receiver with 30(FM18, AM12) station memory, auto/ manual station store, preset scan, auto/ manual tuning

### **AUDIO**

DSP Sound Effect (None, Classic, Pop, Rock)

4x52W (Max) Amplifier, 4CH Stereo Line out

# TROUBLESHOOTING

|                | Symptom   | Cause   | Remedy  |
|----------------|---|---|---|
| <b>General</b> | Power does not turn on.<br>(No sound is produced.)                    | Fuse is blown   | Replace with a fuse of the same rating amperage. If the fuse blows again, consult your local retailer.              |
|                |   | Incorrect wiring  | Consult your local retailer.  |
|                | No sound comes from the unit or its external amplifier                | Wiring for amplifier output is incorrect, or there is a short circuit among the output wiring.  | Refer to the unit wiring diagram to check proper connections, make sure the wiring is done correctly.               |
|                |   | The unit is in MUTE mode.   | Turn off the MUTE function.   |
|                |   | RCA output wiring is incorrect  | Check and properly connect the RCA output with the external amplifier.  |
|                |   | Wiring between external amplifier's REM terminal and the unit's antenna lead is incorrect, or antenna output lead of the unit is short circuit to ground. | Properly connect the REM terminal of the external amplifier and the unit's antenna output lead.                     |
|                | Nothing happens when buttons are pressed.<br>Display is not accurate. | The microprocessor has malfunctioned due to noise, etc.   | Turn off the power, Then press the [NO OPEN] button and remove the DCP. Press the reset button for about 2 seconds. |
|                |   | Panel or main unit connectors are dirty.  | Wipe the dirt off with a soft cloth moistened with cleaning alcohol.  |

## **FCC Caution.**

### **§ 15.19 Labelling requirements.**

This device complies with part 15 of the FCC Rules. Operation is subject to the following two conditions: (1) This device may not cause harmful interference, and (2) this device must accept any interference received, including interference that may cause undesired operation.

### **§ 15.21 Changes or modification warning**

Any Changes or modifications not expressly approved by the party responsible for compliance could void the user's authority to operate the equipment.

### **§ 15.105 Information to the user.**

**Note:** This equipment has been tested and found to comply with the limits for a Class B digital device, pursuant to part 15 of the FCC Rules. These limits are designed to provide reasonable protection against harmful interference in a residential installation. This equipment generates uses and can radiate radio frequency energy and, if not installed and used in accordance with the instructions, may cause harmful interference to radio communications. However, there is no guarantee that interference will not occur in a particular installation. If this equipment does cause harmful interference to radio or television reception, which can be determined by turning the equipment off and on, the user is encouraged to try to correct the interference by one or more of the following measures:

- Reorient or relocate the receiving antenna.
- Increase the separation between the equipment and receiver.
- Connect the equipment into an outlet on a circuit different from that to which the receiver is connected.
- Consult the dealer or an experienced radio/TV technician for help.

### **\* RF warning for Portable device:**

The device has been evaluated to meet general RF exposure requirement. The device can be used in portable exposure condition without restriction.