

SOUNDSTREAM

PCD-41B

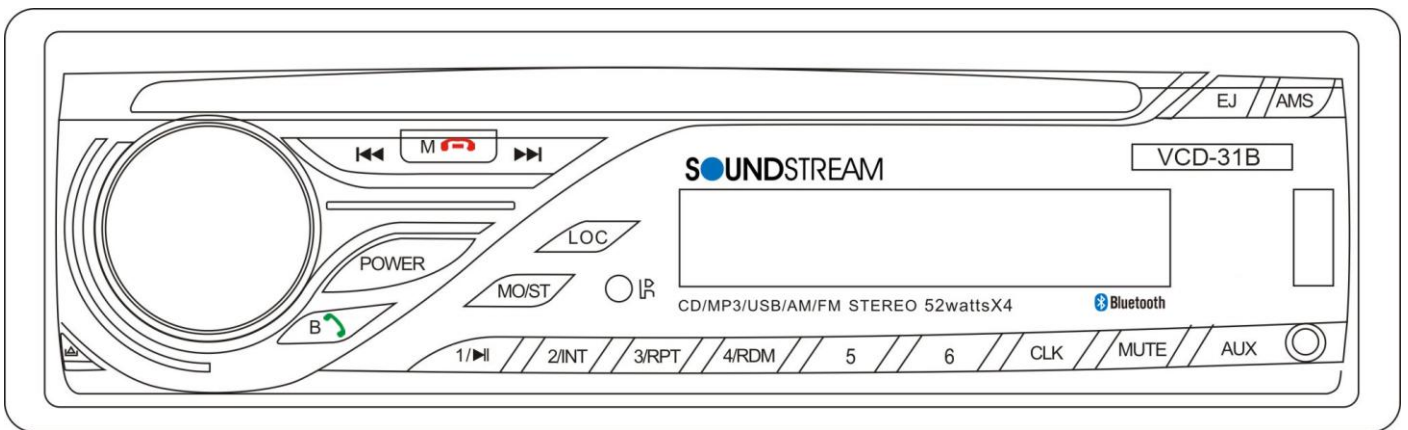



Owner's Manual

Take the time to read through this owner's manual.

Familiarity with installation and operation procedures will help you obtain the best Performance from your new CD-receiver.

CONTENTS

CONTENTS	01
PRECAUTION	02
ACCESSORY	03
INSTALLATION (UN-INSTALLATION)	04
WIRING DIAGRAM	05
CONTROL PANEL	06
INNER PANEL	06
BASIC OPERATION	07
POWER	07
M  (MODE)	07
T-DN \ T-UP	07
DISC SLOT	07
LCD DISPLAY	07
EJ	07
AMS	07
OPEN	08
SEL/VOLUME	08
B  (BAND)	08
MO/ST	08
LOC	08
IR SENSOR	08
1 \ PAUSE \ PLAY	08
2 \ INT	08
3 \ RPT	08
4 \ RDM	08
5	08
6	08
CLK	09
MUTE	09
AUX IN	09
USB SOCKET	09
SD \ MMC SLOT	09
BLUETOOTH SECTION	10
REMOTE CONTROL	11
SPECIFICATION & FEATURE	12
TROUBLESHOOTING	13

PRECAUTION

This unit is designed and manufactured with consideration of user's safety, however any improper use or operation may result in a certain hazard or misuse. So it is highly recommended to read this manual thoroughly and adhere to the following precaution.

SAFETY PRECAUTION

- ✧ To prevent an electrical shock, do not open the housing of the unit.
- ✧ In any case of malfunctioning, only have the unit serviced by an approved and qualified service centre.
- ✧ Do not expose to any water drop and put under the heavy moisture, high humidity environment or operate when your hands are wet. It may cause electrical shortage.
- ✧ For safety driving, keep the volume low in order to concentrate on traffic condition.
- ✧ Do not clean the unit with alcohol, only clean with a soft and dry cloth.
- ✧ If the unit has been kept in high temperature or high humidity area, cool down the car interior before turning on the unit.
- ✧ Do not use the unit for a long time without running vehicle's engine, it may drain the battery and the vehicle may not be able to start engine.
- ✧ Before final installation into indash hole, connect the wiring and make sure the unit is working properly.
- ✧ Use only the parts provided with the unit to ensure proper installation.
- ✧ Do not route wiring in places that get hot if the insulation of the wiring may be melted
- ✧ When replacing fuse, be sure to use only the same rating fuse prescribed on this unit

OPERATION PRECAUTION

- ✧ Please dispose empty batteries used to Remote Controller according to the regulations in your country.
- ✧ If the unit is disconnected with the battery, the unit will lose memorized data.
- Design and specification may vary in the operation manual from the actual product.

ACCESSORY

Package will include in the following accessories for installation and operation the unit.

Installation Accessory

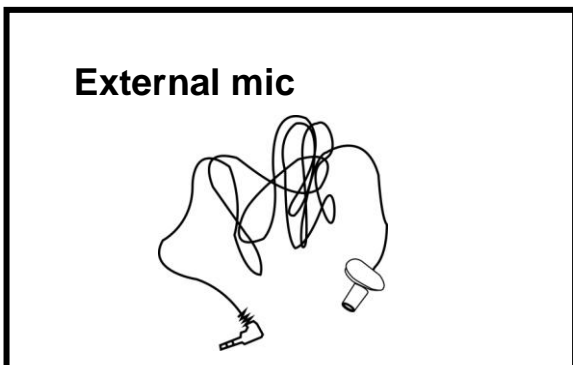
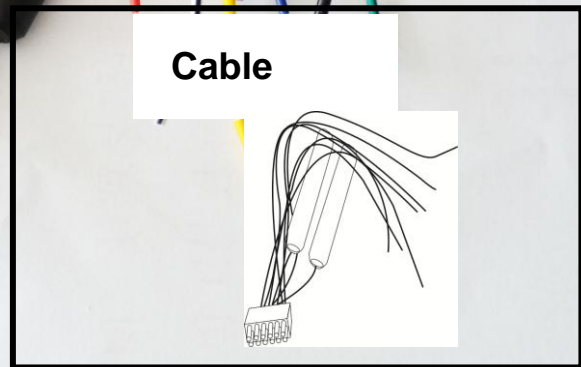
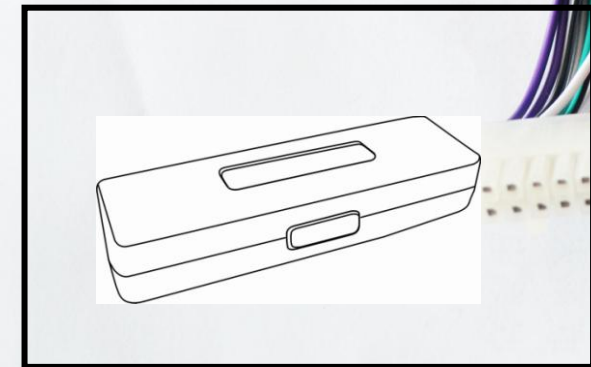
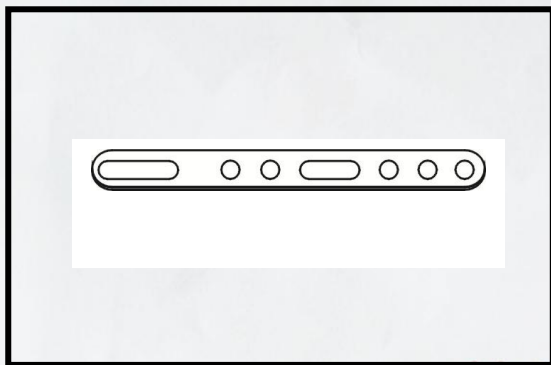
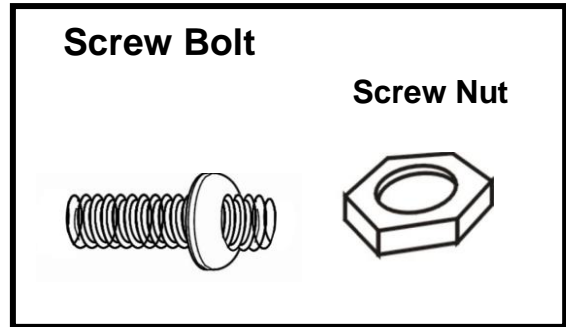
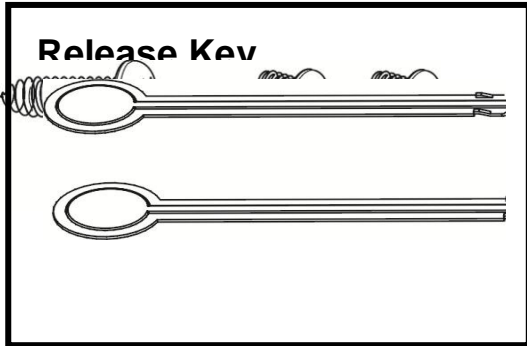

Installation/Un-Installation

First complete the electrical connections, and then check them for correctness.

Installation/Un-installation

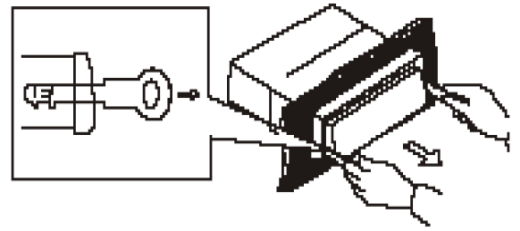

Mounting Method A

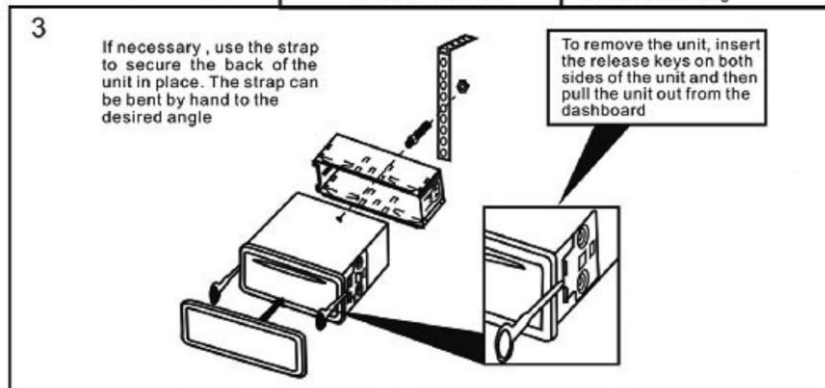
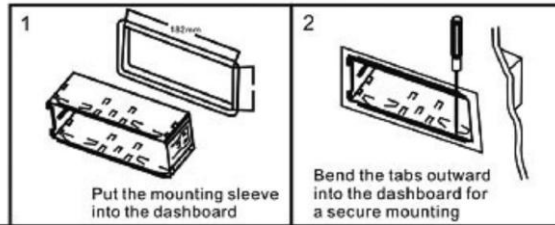

WIRING DIAGRAM

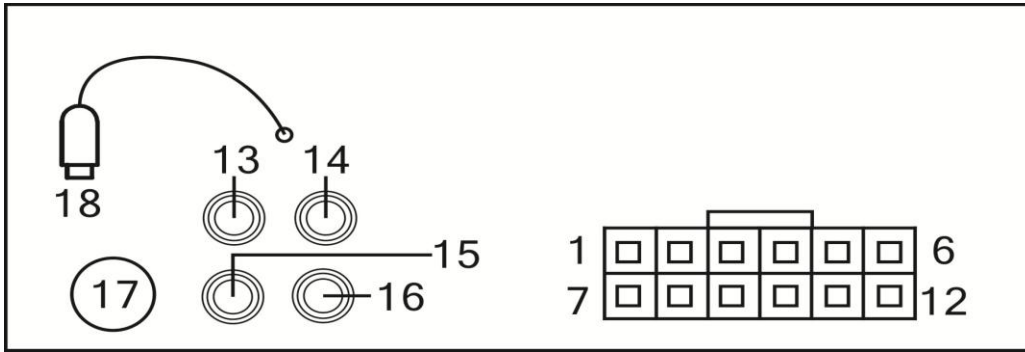

- 1、 Purple: Right Rear +
- 2、 Gray: Right Front +
- 3、 White: Left Front +
- 4、 Green: Left Rear +
- 5、 Blue: Auto Antenna
- 6、 Yellow:ACC B+(Fuse 15A)
- 7、 Purple/Black:Right Rear -
- 8、 Gray/Black: Right Front -
- 9、 White/Black: Left Front -
- 10、 Green/Black: Left Rear -
- 11、 Red: Connect to Ignition Key switch 12V DC(Fuse 1A)
- 12、 Black:ACC B-
- 13、 Red RCA:Line out-Right Front
- 14、 Red RCA:Line out-Right Rear
- 15、 White RCA:Line out-Left Front
- 16、 White RCA:Line out-Left Rear
- 17、 Car Antenna INT
- 18、 Connect to External mic

CONTROL PANEL

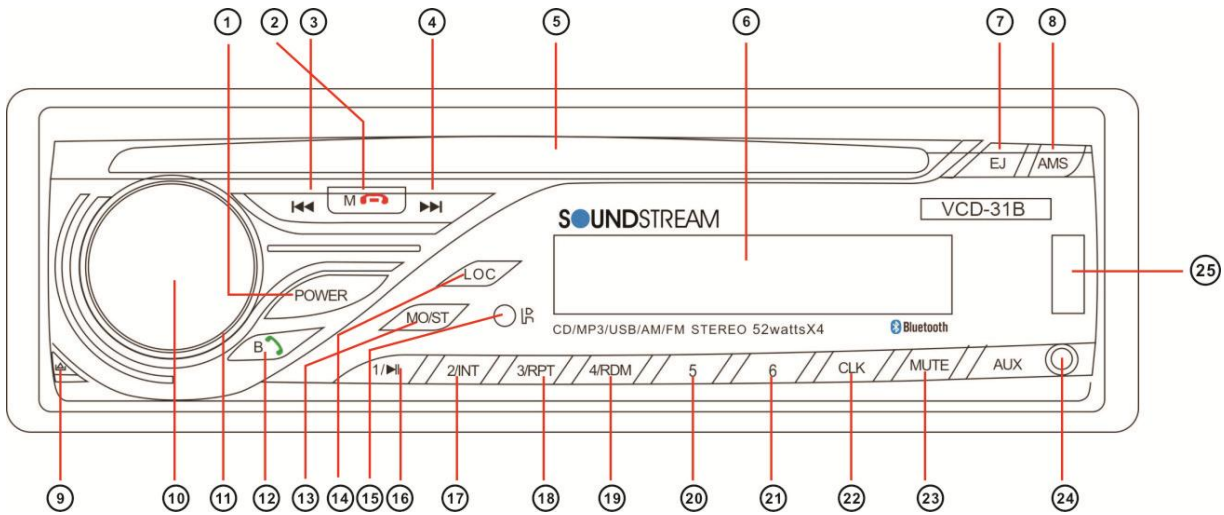

INNER PANEL

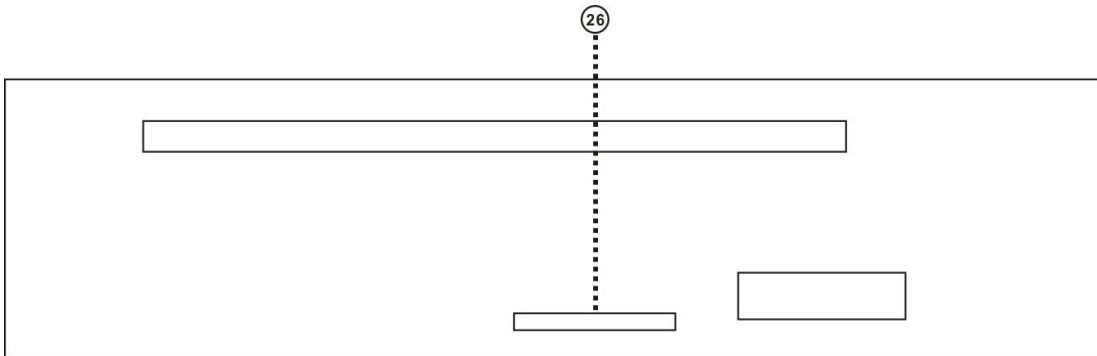

- | | | | |
|-------------|---------------|--------------|-----------------|
| 1 POWER | 2 M (MODE) | 3 T-DN | 4 T-UP |
| 5 DISC SLOT | 6 LCD DISPLAY | 7 EJECT | 8 AMS |
| 9 OPEN | 10 SEL | 11 VOL | 12 B (BAND) |
| 13 MO/ST | 14 LOC | 15 IR SENSOR | 16 1/PAUSE/PLAY |
| 17 2/INT | 18 3/RPT | 19 4/RDM | 20 5 |
| 21 6 | 22 CLK | 23 MUTE | 24 AUX |
| 25 USB SLOT | 26 SD SLOT | | |

BASIC OPERATION

1. POWER

Press [POWER] button to turn on the unit. Press again to turn off the unit.

2. MODE

Short press to change mode in the sequence of TUNER -> (* CD) -> (* SD) -> (*USB) -> AUX -> TUNER

In BLUETOOTH mode, press to reject a coming call or hang up while calling.

3./4. /

- Tune Up / Down in Radio Mode,

Manual Tuning Mode : Press more than 3 seconds to search a station in manually and press button to tune each frequency step upward or downward

Seek Tuning Mode : Press to search a next or previous station automatically

-Track Up (FF) / Down (REW) In SD, USB ,CD Mode,

Track Up / down : Press to move to next or previous Track

Track FF / FR : Press more than 3 seconds to activate fast forward (FF) or fast reverse (FR) search in a track

5. DISC SLOT

Insert a disc with MP3 and/ or WMA files into the CD slot with label side up. The first file in the first folder will start to play.

6. LCD DISPLAY

Display screen

7. EJ (DISC EJECT)

Press to eject Disc inside the CD slot. If disc is not removed after ejecting, disc re-loaded automatically without playing.

8. AMS

AS: In tuner mode, Press this button for longer than 2 seconds to store best reception radio station to preset buttons automatically

- PS: In tuner mode, Press this button to scan the preset memorized station, each preset scan for 5 seconds.

Press again to stop operation

- In CD, USB, SD Card mode, press to start Music File Search Menu.

Press the button again and menu is changed to the following sequence.

File Number Search -> File Name Search

-> Root Name Search -> EXIT Search

9.OPEN

Press open button to show the inner panel.

10.SEL

Multimedia and select button, and to choose hours/minutes.

In the radio state, press it to enter the SOUND SETTING menu: BAS-> TRE -> BAL -> FAD -> LOUD -> EQ(CLASSIC->POP ->ROCK -> EQ OFF)->DX->STEREO->VOL-> BAS

In the CD/USB/SD state, press it to enter the SOUND SETTING menu: BAS-> TRE -> BAL -> FAD -> LOUD -> EQ(CLASSIC->POP ->ROCK -> EQ OFF) ->VOL-> BAS

11.VOLUME

Adjust knob, clockwise rotation for + / counterclockwise rotation for- (including Volume/time/EQ)

In the EQ state, rotation it to choose Audio Effect: CLASSIC->POP ->ROCK -> EQ OFF

12.B BAND

- BAND

In Radio Mode , Move to radio band in the sequence of

FM1 -> FM2 -> FM3->AM1-AM2

In Bluetooth mode, Press the answer the phone.

13.MO/ST

- **STEREO/ MONO**: Turn the knob to select STEREO -> MONO under FM mode only.

14.LOC

Press LOC button to select strong or weak station reception. It is set to LOC mode when button is first pressed. "LOC" appears and only local station is available, It is switched to DX mode when LOC button is pressed again. Both Distance and local station can be received. (Only for FM mode)

15.IR SENSOR

16\17\18\19\20\21 PRESET STATION No.

1 ~ 6 / Pause, INT, RPT, RDM, +10, -10

- Preset Button (In Radio mode)

Press [1-6] button to select the radio station memorized in each buttons. Press for more than 2 seconds to memorize the current station to teach preset buttons (Manual Station Store).

- In CD, USB, SD Slot mode, each button performs below function.

[PAUSE]: Repeat pause -> play.

[INT]: Play beginning of every track for about 10 seconds.

[RPT]: Press to play same track repeatedly, press again to cancel.

[RDM]: Play every track randomly

[-10 / +10]: Move to the previous or next 10 tracks.

22.CLK

Clock time display.Press button to show time, long press and rotate vol button to adjust clock time.



23.MUTE

Short press to mute on, short press again to mute off.

24. AUX IN

AUX IN socket

25. USB SOCKET

Insert a USB Flash Storage Device and music starts to play automatically. LCD display.

Support Music File Format: MP3, WMA Files

26. SD CARD SOCKET

Insert a SD Card and music starts to play automatically.

Support Music File Format: MP3, WMA, Files

BLUETOOTH SECTION



Warning: Driving and having a Telephone conversation at the same time is dangerous, please park your car before having a telephone conversation. The supplier waves any and all liability when this warning is not followed.

1. Power on

2. Open the Bluetooth of mobile phone → Search for Bluetooth devices → Choose a name for the "SOUNDSTREAM" Bluetooth devices → Connect the Bluetooth (The first time use when you need to enter the passcode "0000" to connect Bluetooth.)

3. After pairing is successful, the machine displays BT ON once, and then transferred to the current mode, when operating the phone call with music or a call comes in, the machine will automatically turn Bluetooth mode.

4. If you do not operate the phone or no call comes, it will automatically be reversed current mode, you can press MODE to Bluetooth mode.

5. Any time an incoming call, the machine will automatically switch to Bluetooth mode and display the caller's telephone number in the LCD display. You can press **B**  to answer the incoming call or press **M**  to reject it.

6. During a call, you can switch on the phone to the handset, the machine does not support this

7. When playing music via A2DP, on the machine panel, enabling play / pause, previous track, next track operation.

8. When the phone away from the machine will automatically disconnect the Bluetooth, it will automatically connect to a Bluetooth when the phone close to the machine .

Note: The machine can only be paired with a Bluetooth phone connection. When the machine and the phone is paired, you can not pair with other phones.

SPECIFICATION

FM TUNER

Frequency Range ----- 87.5 ~ 107.9MHZ
Usable Sensitivity ----- 18 dBuV
Stereo Separation ----- 30 dB

AM (MW) TUNER

Frequency Range ----- 530 ~ 1710KHz
Usable Sensitivity ----- 35 dBuV

ELECTRIC

Power Supply ----- DC 11 ~ 15 Volt
Current Consumption ----- < 10 Amere
Load Impedance ----- 4 Ohm
Dimensions ----- 178mm (W) x 175mm (D) x 50mm (H)
Power Output ----- 4 x 52W (Max)
Line Output ----- 1.2 V

FEATURE

PLAYBACK

MP3, WMA, playback with ID3 Tag Display
File and Folder Search
USB Firmware Up gradable

TUNER

AM/FM Radio Receiver with 30(FM18, AM12) station memory, auto/ manual station store, preset scan, auto/ manual tuning

AUDIO

DSP Sound Effect (None, Classic, Pop, Rock)
4x52W (Max) Amplifier, 4CH Stereo Line out

TROUBLESHOOTING

	Symptom	Cause	Remedy
General	Power does not turn on. (No sound is produced.)	Fuse is blown	Replace with a fuse of the same rating amperage. If the fuse blows again, consult your local retailer.
		Incorrect wiring	Consult your local retailer.
	No sound comes from the unit or its external amplifier	Wiring for amplifier output is incorrect, or there is a short circuit among the output wiring.	Refer to the unit wiring diagram to check proper connections, make sure the wiring is done correctly.
		The unit is in MUTE mode.	Turn off the MUTE function.
		RCA output wiring is incorrect	Check and properly connect the RCA output with the external amplifier.
		Wiring between external amplifier's REM terminal and the unit's antenna lead is incorrect, or antenna output lead of the unit is short circuit to ground.	Properly connect the REM terminal of the external amplifier and the unit's antenna output lead.
	Nothing happens when buttons are pressed. Display is not accurate.	The microprocessor has malfunctioned due to noise, etc.	Turn off the power, Then press the [NO OPEN] button and remove the DCP. Press the reset button for about 2 seconds.
		Panel or main unit connectors are dirty.	Wipe the dirt off with a soft cloth moistened with cleaning alcohol.

FCC Caution.

§ 15.19 Labelling requirements.

This device complies with part 15 of the FCC Rules. Operation is subject to the following two conditions: (1) This device may not cause harmful interference, and (2) this device must accept any interference received, including interference that may cause undesired operation.

§ 15.21 Changes or modification warning

Any Changes or modifications not expressly approved by the party responsible for compliance could void the user's authority to operate the equipment.

§ 15.105 Information to the user.

Note: This equipment has been tested and found to comply with the limits for a Class B digital device, pursuant to part 15 of the FCC Rules. These limits are designed to provide reasonable protection against harmful interference in a residential installation. This equipment generates uses and can radiate radio frequency energy and, if not installed and used in accordance with the instructions, may cause harmful interference to radio communications. However, there is no guarantee that interference will not occur in a particular installation. If this equipment does cause harmful interference to radio or television reception, which can be determined by turning the equipment off and on, the user is encouraged to try to correct the interference by one or more of the following measures:

- Reorient or relocate the receiving antenna.
- Increase the separation between the equipment and receiver.
- Connect the equipment into an outlet on a circuit different from that to which the receiver is connected.
- Consult the dealer or an experienced radio/TV technician for help.

*** RF warning for Portable device:**

The device has been evaluated to meet general RF exposure requirement. The device can be used in portable exposure condition without restriction.