

# PROSCAN

MODEL NO.: PKR305

## BLUETOOTH SPEAKER WITH KARAOKE



### INSTRUCTION MANUAL

PLEASE READ BEFORE OPERATING THIS EQUIPMENT  
PROSCAN® IS A REGISTERED TRADEMARK OF TECHNOBOX USA, INC.  
AND IS USED UNDER LICENSE TO CURTIS INTERNATIONAL LTD.

#### Assembly

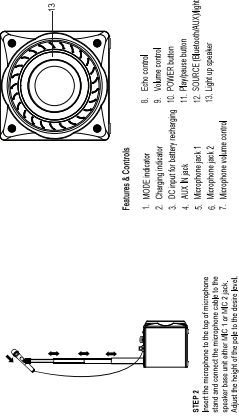

#### Features & Controls

1. MODE indicator
2. Charging indicator
3. DC input for battery recharging
4. AUX IN Jack
5. Microphone jack 1
6. Microphone jack 2
7. Microphones volume control
8. Echo control
9. Volume control
10. POWER button
11. Play/Pause button
12. Bluetooth/Microphone ON/OFF button
13. Light up speaker

#### Bluetooth operation

- External devices that have a built-in Bluetooth feature can connect wirelessly to this Bluetooth Speaker.
- GETTING CONNECTED**
1. Power on the unit by pressing the POWER button on top of the unit and the MODE button.
  2. Switch the Bluetooth function from external device to ON and begin searching for nearby Bluetooth devices.
  3. Once "Pro PMP305" appears on the paired device list of your external device, select it.
  4. If you are asked for a password, enter "0000".
  5. A Bluetooth connection message will be shown and MODE indicator light will flash.
  6. A new record below your Bluetooth connection should be visible to use.
  7. Press external SOURCE button from the top of the speaker CONTROL.
- PLAYING MUSIC FROM AN EXTERNAL BLUETOOTH DEVICE**
1. Follow the "SETTING CONNECTED" steps above per your external device.
  2. Tap on the music program you wish to play from the list of play, usually, you will see the music program name and the album name.
  3. Select "Music" through the connected Bluetooth Device. Once it has been through the speaker.
  4. Adjust the VOLUME to obtain the desired volume level.
  5. Press POWER button to turn off the unit.

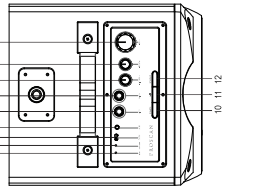

### SAFETY INSTRUCTIONS

**WARNING:** This equipment may generate or use radio frequency energy. Changes or modifications to this equipment may result in interference with radio communications. Changes or modifications are expressly prohibited without the approval of the manufacturer. The user could lose the authority to operate this equipment if an unauthorized change or modification is made.

**SURGE PROTECTION:** It is recommended to use a surge protector for AC connection, lightning and power surges ARE NOT covered under warranty for this product.

**RF RADIATION EXPOSURE STATEMENT CAUTION:** This transmitter must be installed to provide a separation distance of at least 20 cm from all persons.

**INFORMATION:** This equipment has been tested and found to comply with the limits for a Class B digital device, pursuant to part 15 of the FCC Rules. These limits are designed to provide reasonable protection against harmful interference in a residential installation. This equipment generates, uses, and can radiate radio frequency energy and, if not readied and used in accordance with the instructions, may cause harmful interference to radio communications. However, there is no guarantee that interference will not occur in a particular installation. If you experience any of the following conditions, you should take the steps to correct harmful interference to radio or television reception, which can be determined by turning the equipment off and on, the user is encouraged to try to correct the interference by one of the following steps:

- Reorient or relocate the receiving antenna.
- Increase the separation between the equipment and receiver.
- Connect the equipment to an outlet on a circuit that is not shared with other loads.
- Consult the dealer or an experienced technician for help.

### SAFETY INSTRUCTIONS

Before using this unit, be sure to read all operating instructions and warnings. This manual contains important information on how to use the unit. Please read these instructions carefully. These instructions are general precautions and are not specific to your unit. For more information on safety, please refer to the manufacturer's instructions for the device.

**1. POWER SOURCES:** This product is not to be connected to any power source other than the one specified in the instructions. Do not use this product in areas where there are flammable gases, vapors, or liquids. Do not use this product in areas where there is a risk of fire or explosion.

**2. SURGE PROTECTION:** It is recommended to use a surge protector for AC connection, lightning and power surges ARE NOT covered under warranty for this product.

**3. ATTACHMENTS:** Do not use attachments that are not recommended by the manufacturer.

**4. WIRING:** Do not use this product in areas where there is a risk of fire or explosion.

**5. CLEANING:** Do not use this product in areas where there is a risk of fire or explosion.

**6. MAINTENANCE:** Do not use this product in areas where there is a risk of fire or explosion.

**7. BATTERY:** Do not use this product in areas where there is a risk of fire or explosion.

**8. OVERHEATING:** Do not use this product in areas where there is a risk of fire or explosion.

**9. SAFETY:** Do not use this product in areas where there is a risk of fire or explosion.

**10. POWER SOURCES:** This product is not to be connected to any power source other than the one specified in the instructions. Do not use this product in areas where there are flammable gases, vapors, or liquids. Do not use this product in areas where there is a risk of fire or explosion.

**11. SURGE PROTECTION:** It is recommended to use a surge protector for AC connection, lightning and power surges ARE NOT covered under warranty for this product.

**12. ATTACHMENTS:** Do not use attachments that are not recommended by the manufacturer.

**13. WIRING:** Do not use this product in areas where there is a risk of fire or explosion.

**14. CLEANING:** Do not use this product in areas where there is a risk of fire or explosion.

**15. MAINTENANCE:** Do not use this product in areas where there is a risk of fire or explosion.

**16. BATTERY:** Do not use this product in areas where there is a risk of fire or explosion.

**17. OVERHEATING:** Do not use this product in areas where there is a risk of fire or explosion.

**18. SAFETY:** Do not use this product in areas where there is a risk of fire or explosion.

### SAFETY INSTRUCTIONS

Why open a door or panel that has a lock? It is a safety hazard. Locks are used to prevent unauthorized access to the product. Do not attempt to open a door or panel that has a lock. If you need to open a door or panel, contact the manufacturer for assistance.

**17. OUTDOOR ANTENNA DRAINING:** This product is not to be used in areas where there is a risk of fire or explosion. Do not use this product in areas where there are flammable gases, vapors, or liquids. Do not use this product in areas where there is a risk of fire or explosion.

**18. POWER SOURCES:** This product is not to be connected to any power source other than the one specified in the instructions. Do not use this product in areas where there are flammable gases, vapors, or liquids. Do not use this product in areas where there is a risk of fire or explosion.

**19. SURGE PROTECTION:** It is recommended to use a surge protector for AC connection, lightning and power surges ARE NOT covered under warranty for this product.

**20. ATTACHMENTS:** Do not use attachments that are not recommended by the manufacturer.

**21. WIRING:** Do not use this product in areas where there is a risk of fire or explosion.

**22. CLEANING:** Do not use this product in areas where there is a risk of fire or explosion.

**23. MAINTENANCE:** Do not use this product in areas where there is a risk of fire or explosion.

**24. BATTERY:** Do not use this product in areas where there is a risk of fire or explosion.

**25. OVERHEATING:** Do not use this product in areas where there is a risk of fire or explosion.

**26. SAFETY:** Do not use this product in areas where there is a risk of fire or explosion.

**27. SAFETY:** Do not use this product in areas where there is a risk of fire or explosion.

**28. SAFETY:** Do not use this product in areas where there is a risk of fire or explosion.

**29. SAFETY:** Do not use this product in areas where there is a risk of fire or explosion.

**30. SAFETY:** Do not use this product in areas where there is a risk of fire or explosion.

**31. SAFETY:** Do not use this product in areas where there is a risk of fire or explosion.

**32. SAFETY:** Do not use this product in areas where there is a risk of fire or explosion.

**33. SAFETY:** Do not use this product in areas where there is a risk of fire or explosion.

**34. SAFETY:** Do not use this product in areas where there is a risk of fire or explosion.

**35. SAFETY:** Do not use this product in areas where there is a risk of fire or explosion.

**36. SAFETY:** Do not use this product in areas where there is a risk of fire or explosion.

**37. SAFETY:** Do not use this product in areas where there is a risk of fire or explosion.

**38. SAFETY:** Do not use this product in areas where there is a risk of fire or explosion.

**39. SAFETY:** Do not use this product in areas where there is a risk of fire or explosion.

**40. SAFETY:** Do not use this product in areas where there is a risk of fire or explosion.

### Table of Contents

Your Bluetooth light up speaker Features	5
Charging instructions	5
Assembly	6
Features & Controls	6
Bluetooth operation	7
Playing music from an external Bluetooth device	8
Auxiliary operation	8
Specifications	8
Trouble Shooting	9
Warranty Card	10

### Your Bluetooth Speaker

- Features**
- Support Bluetooth v4.2
  - Support MP3/MP4
  - Support automatic stereo pairing
  - Support FM radio
  - Support LED indicator
  - Support external microphone stand
  - Support external speaker stand
  - Support external battery
  - Support external power source
  - Support external power source
  - Support external power source

### Charging Instructions

**Charging the battery for the first time**

1. Charge the lithium-ion battery for a minimum of 3 hours prior to use.
2. The CHARGER indicator will light up while charging and light off when the unit is fully charged. Unplug the USB cable from the power source once the battery is fully charged.

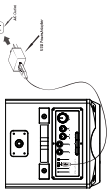

### For service assistance and product information,

Please call: 1-800-968-9853.

### For more assistance or information please call:

1-800-968-9853.

Curtis International Ltd.

7045 BECKETT DRIVE, UNIT 15,

MISSISSAUGA, ON, L5S 2A3

www.curtisintl.com

### Warranty

This product is warranted to be free from defects in material and workmanship for a period of ninety (90) days from the date of original purchase. During this period, your product will be repaired or replaced at no charge to you. If the product is found to be defective at any time during this period, you are responsible for any charges associated with returning the product to us. If the product or component is no longer available, we will provide you with a replacement of equal or greater value. The replacement being sent, the product must be returned inoperable or returned to us.

This warranty does not cover cases, illness, wear from normal use, use not in conformity with the printed directions, or damage to the product resulting from accident, alteration, abuse or misuse. This warranty extends only to the original consumer purchaser or gift recipient. It does not extend to anyone who purchases the product from a retailer, wholesaler, household use or subject to any voltage and wattage other than as on the specified packaging and label (e.g., 120V).

This warranty does not cover cases, illness, wear from normal use, use not in conformity with the printed directions, or damage to the product resulting from accident, alteration, abuse or misuse. This warranty extends only to the original consumer purchaser or gift recipient. It does not extend to anyone who purchases the product from a retailer, wholesaler, household use or subject to any voltage and wattage other than as on the specified packaging and label (e.g., 120V).

For faster service, locate the model, type, and serial numbers on your appliance. RETURN YOUR PROOF OF PURCHASE (PROOF OF PURCHASE IS REQUIRED TO OBTAIN WARRANTY SERVICE). Please have the following information available when you contact the Support Team:

- Home address and telephone number.
- Name, address and telephone number.
- A clear, detailed description of the problem.
- Proof of purchase including dealer or retailer name, address and date of purchase.

# PROSCAN

## HAUT-PARLEUR BLUETOOTH AVEC KARAOKE

MODÈLE NO.: PKAR305



### MANUEL DU PROPRIÉTAIRE

SEL VOS PLÂT TIRE AVANT D'UTILISER CET APPAREIL  
PROSCAN® EST UNE MARQUE DÉPOSÉE DE TECHNICAL OR USA INC. ET UTILISÉE SOUS LICENCE À CURTIS INTERNATIONAL LTD.

#### Assemblé

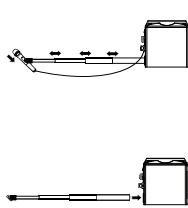

ÉTAPE 2  
Connecter le câble de connexion Bluetooth entre le haut-parleur et le téléphone.

#### Fonctionnalités des contrôles &

1. Indicateur de puissance

2. Régulateur de volume

3. Bouton de marche/arrêt

4. Bouton de source

5. Bouton de mode

6. Bouton de liste de lecture

7. Bouton de retour

8. Contrôle de volume

9. Contrôle de volume

10. Bouton de charge de la batterie

11. Bouton de mise en veille

12. Bouton de mise en veille

13. Bouton de mise en veille

#### Utilisation de Bluetooth

1. Appuyez sur le bouton de source

2. Appuyez sur le bouton de mode

3. Appuyez sur le bouton de liste de lecture

4. Appuyez sur le bouton de retour

5. Appuyez sur le bouton de retour

6. Appuyez sur le bouton de retour

7. Appuyez sur le bouton de retour

8. Appuyez sur le bouton de retour

9. Appuyez sur le bouton de retour

10. Appuyez sur le bouton de retour

11. Appuyez sur le bouton de retour

12. Appuyez sur le bouton de retour

13. Appuyez sur le bouton de retour

14. Appuyez sur le bouton de retour

15. Appuyez sur le bouton de retour

### DIRECTIVES RELATIVES À LA SÉCURITÉ

**AVERTISSEMENT FCC:**  
Ce dispositif est conforme aux exigences de la partie 15 de la réglementation FCC. Les modifications non autorisées peuvent entraîner des interférences radio et être soumises à annulation sans préavis de la part de Proscan.

**PROTECTION CONTRE LES SURTENSIONS:**  
Ce produit est protégé contre les surtensions de la ligne téléphonique. Les surtensions peuvent être causées par un éclaircissement de la ligne téléphonique. Les surtensions peuvent être causées par un éclaircissement de la ligne téléphonique.

FCC EMI Certification requise à l'installation. Cet appareil est fabriqué en Chine et est conforme aux exigences de la partie 15 de la réglementation FCC.

### DIRECTIVES RELATIVES À LA SÉCURITÉ (suite)

1. **NE PAS TOUCHER LES CONTACTS À L'INTÉRIEUR DE LA BOÎTE.** Les contacts à l'intérieur de la boîte peuvent être exposés à haute tension et peuvent causer des blessures graves.

2. **NE PAS TOUCHER LES CONTACTS À L'INTÉRIEUR DE LA BOÎTE.** Les contacts à l'intérieur de la boîte peuvent être exposés à haute tension et peuvent causer des blessures graves.

3. **NE PAS TOUCHER LES CONTACTS À L'INTÉRIEUR DE LA BOÎTE.** Les contacts à l'intérieur de la boîte peuvent être exposés à haute tension et peuvent causer des blessures graves.

### DIRECTIVES RELATIVES À LA SÉCURITÉ (suite)

11. **NE PAS TOUCHER LES CONTACTS À L'INTÉRIEUR DE LA BOÎTE.** Les contacts à l'intérieur de la boîte peuvent être exposés à haute tension et peuvent causer des blessures graves.

12. **NE PAS TOUCHER LES CONTACTS À L'INTÉRIEUR DE LA BOÎTE.** Les contacts à l'intérieur de la boîte peuvent être exposés à haute tension et peuvent causer des blessures graves.

13. **NE PAS TOUCHER LES CONTACTS À L'INTÉRIEUR DE LA BOÎTE.** Les contacts à l'intérieur de la boîte peuvent être exposés à haute tension et peuvent causer des blessures graves.

### Table des matières

Table des matières

- 1. Informations générales
- 2. Sécurité
- 3. Spécifications
- 4. Utilisation de Bluetooth
- 5. Fonctionnalités des contrôles &
- 6. Utilisation de Bluetooth
- 7. Fonctionnalités des contrôles &
- 8. Utilisation de Bluetooth
- 9. Fonctionnalités des contrôles &
- 10. Utilisation de Bluetooth

### Table des matières

Table des matières

- 1. Informations générales
- 2. Sécurité
- 3. Spécifications
- 4. Utilisation de Bluetooth
- 5. Fonctionnalités des contrôles &
- 6. Utilisation de Bluetooth
- 7. Fonctionnalités des contrôles &
- 8. Utilisation de Bluetooth
- 9. Fonctionnalités des contrôles &
- 10. Utilisation de Bluetooth

### Instructions de charge

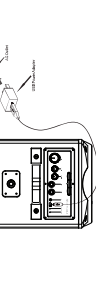

Chargez la batterie en utilisant le chargeur fourni avec le produit.

5

### Instructions de charge

Chargez la batterie en utilisant le chargeur fourni avec le produit.

### Instructions de charge

Chargez la batterie en utilisant le chargeur fourni avec le produit.

### Instructions de charge

Chargez la batterie en utilisant le chargeur fourni avec le produit.

### For service assistance and product information.

Please call: 1-800-968-9853.

### For service assistance and product information.

Please call: 1-800-968-9853.

### For service assistance and product information.

Please call: 1-800-968-9853.

### En cas de problème

1. Vérifiez que le produit est correctement branché.

### En cas de problème

1. Vérifiez que le produit est correctement branché.

### En cas de problème

1. Vérifiez que le produit est correctement branché.

### Opérations auxiliaires

1. Appuyez sur le bouton de source.

### Opérations auxiliaires

1. Appuyez sur le bouton de source.

### Opérations auxiliaires

1. Appuyez sur le bouton de source.

### Opérations auxiliaires

1. Appuyez sur le bouton de source.

### Opérations auxiliaires

1. Appuyez sur le bouton de source.

### Opérations auxiliaires

1. Appuyez sur le bouton de source.

### Opérations auxiliaires

1. Appuyez sur le bouton de source.

### Opérations auxiliaires

1. Appuyez sur le bouton de source.

### Opérations auxiliaires

1. Appuyez sur le bouton de source.

### Opérations auxiliaires

1. Appuyez sur le bouton de source.

### Opérations auxiliaires

1. Appuyez sur le bouton de source.

### Opérations auxiliaires

1. Appuyez sur le bouton de source.