

# User Guide

## Keychain Remote





---

### THANK YOU

We appreciate the trust and confidence you have placed in Defiant through the purchase of this security keychain remote. We strive to continually create quality products designed to enhance your home. Visit us online to see our full line of products available for your home improvement needs. Thank you for choosing Defiant!

# Safety Information

 **WARNING:** Keep batteries away from children at all times. This product contains a coin/button style cell battery and, if swallowed, can cause severe internal burns within 2 hours of ingesting and can lead to death. Keep away from infants and small children at all times. If battery is swallowed or comes in contact with the inside of the body, immediately seek emergency medical attention. If the battery is replaced by an incorrect size, there is a risk of the battery erupting and causing injury. Dispose of used battery promptly, when it has been removed.

 **CHOKING HAZARD:** keep batteries and any small parts away from infants and small children at all times.

This item is not a toy and should not be given to children.

 **IMPORTANT:** Do not expose to wet conditions. Periodically check the condition and security of the batteries.

 **CAUTION:** Correct disposal of batteries. In the US, each state has their own recycling regulations. To find out what your state provides and requires for battery disposal, both Earth911 and Call2Recycle offer online resources to help. Earth911 has an accurate Recycling Locator for all types of batteries; simply enter your ZIP code to find the nearest battery recycling center. Call2Recycle offers a network of local recycling centers and drop-off locations for rechargeable batteries, including local municipalities and national retailers such as The Home Depot.

# Package Contents

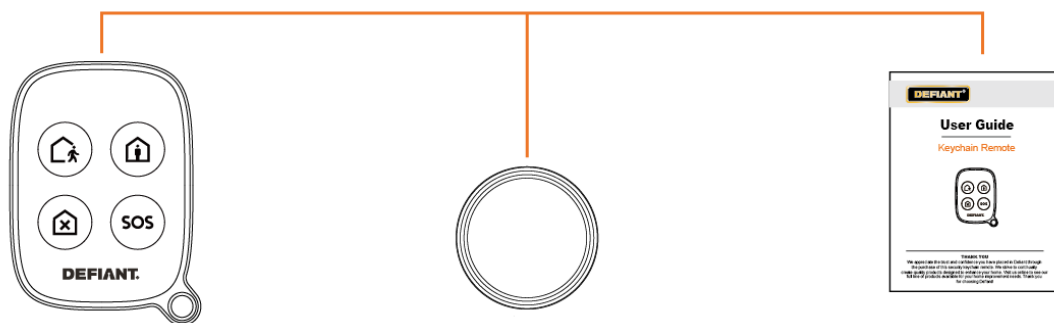

Keychain Remote

CR2032 Battery(pre-installed)

User Guide

## Product Introduction

You can easily control a home security system by using this portable four-button keychain remote.

### Components

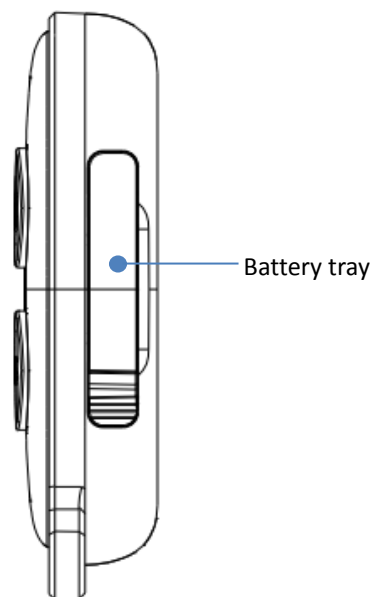
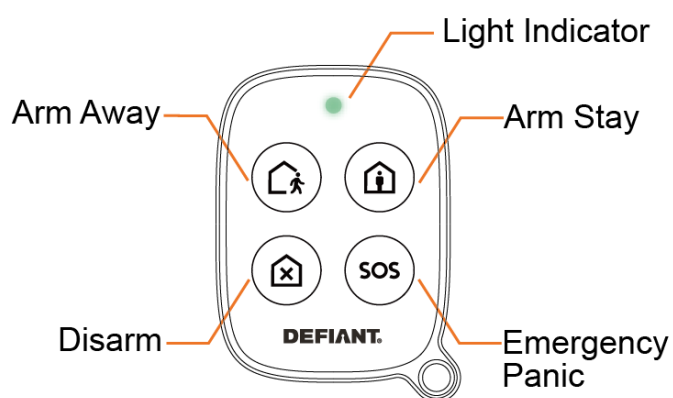

Signal	Status
Continuous flashing green	<ul style="list-style-type: none"> <li>● Pairing</li> <li>● Communicating with the hub</li> </ul>
Single green flash	Keys unlocked
Solid green	<ul style="list-style-type: none"> <li>● Paired successfully</li> <li>● Operation complete</li> </ul>
Solid red	<ul style="list-style-type: none"> <li>● Operation failed</li> <li>● Not connected to the hub</li> </ul>

## Quick Start Guide

**This keychain remote only works when paired together with a Defiant hub.**

### Download and Install the App

Please scan the QR code below to download and install the App.



iOS App



Android App

### Register and Login

Open the App and it will guide you through creating an account and logging in at the home screen. If you already have an account, please just sign in with it.

### Connecting the Keychain Remote to Your Hub

- Make sure you have already set up the defiant hub, and that it is working properly.
- Press “+” (plus) button to add a keychain remote, as shown in the illustration below.



- Choose the correct keychain remote item (icon) as shown in the illustration below. This will put the hub into pairing mode and allow you to add the new device. The LED light on the hub will flash once and you will hear a beep, when successful.

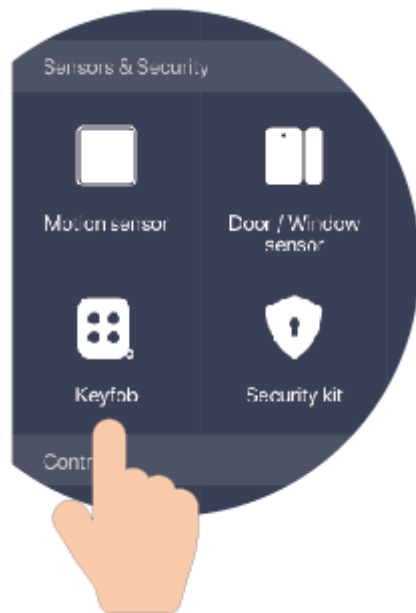

- Next, pull out the protective strip to engage the battery, and the keychain remote will automatically power on.

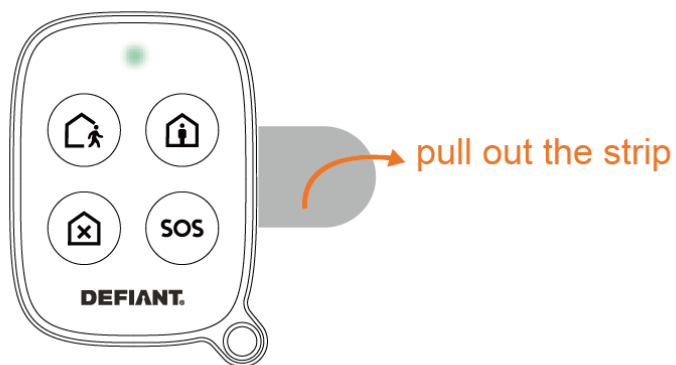

- The keychain remote indicator will flash when it is searching for the hub, and will turn solid green when the pairing is complete.

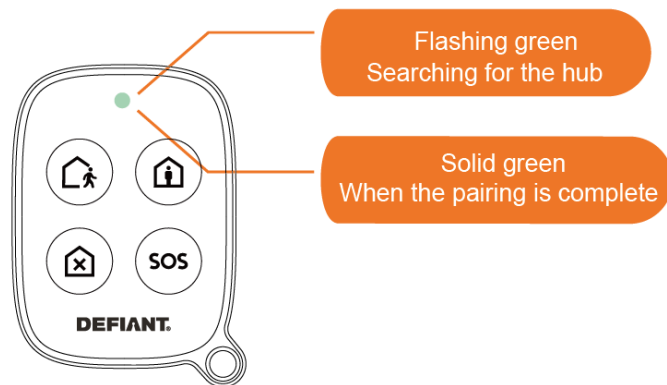

## Operation

After the installation, you can control the system by using the keychain remote.

- Arm stay/Arm away/Disarm the system by pressing the mode buttons.



### Disarm

No sensors are monitored.  
Move freely throughout the home.



### Arm away

All sensors are monitored.  
Secure all sensors in your home.



### Arm stay

Some sensors are monitored.  
Only door/window sensors are monitored so you are free to move around the inside of your home.

- Press the Emergency (SOS) button and hold for 3 seconds to send a panic signal.



### Emergency

The Siren will send a panic signal immediately, Ignoring the current mode.

Deactivate a panic alarm by pressing the disarm button.

**Reset or Manual Pairing:** If you need to manually pair the keychain remote with the hub or reset the keychain remote, just press the arm stay and disarm button at the same time and hold for 3 seconds.

**Key Lock Mode:** To prevent mistaken activations, you can access the “Software key lock” function in the App. This allows you to lock the keychain remote. To unlock the keychain remote, simply press the “Arm stay” and “Disarm” buttons simultaneously before using it. It will automatically relock itself after a few seconds.

**Firmware Upgrade:** When firmware upgrades for the device become available, you will receive a notification through the App. Upgrades are optional.

### Changing the Battery

When you receive a “low battery” alert through the App, follow the instructions below:



Disarm the System

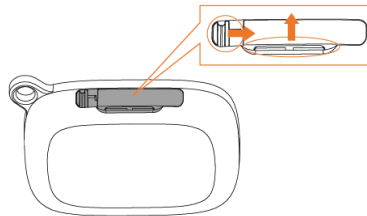

Pull Out the Battery Tray

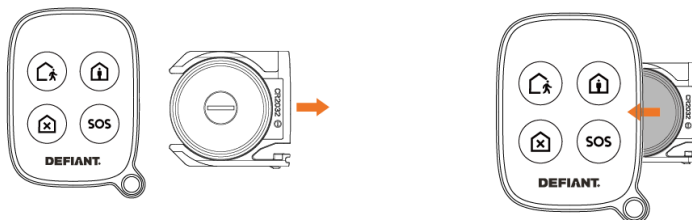

Insert a new CR2032 coin cell battery with the negative side facing up.

# Trouble Shooting

If the keychain remote is not working and the indicator is not lit, make sure the battery has power and it is installed with the negative side facing up. Replace the battery if needed.

If you have enabled the soft key lock function in the App, the controller won't operate unless it has been unlocked. Follow the unlock instructions on a previous page.

If there is still no response, reset the keychain remote by pressing the arm stay and disarm button simultaneously and hold for 3 seconds.

## Compliance Information

**FCC ID: 2AB2Q7ARCZEA0**

This device complies with Part 15 of the FCC Rules. Operation is subject to the following two conditions: (1) this device may not cause harmful interference, and (2) this device must accept any interference received, including interference that may cause undesired operation.

FCC Caution:

Changes or modifications not expressly approved by the part responsible for compliance could void the user's authority to operate the equipment.

FCC Statement:

"This equipment has been tested and found to comply with the limits for a Class B digital device, pursuant to part 15 of the FCC Rules. These limits are designed to provide reasonable protection against harmful interference in a residential installation. This equipment generates, uses and can radiate radio frequency energy and, if not installed and used in accordance with the instructions, may cause harmful interference to radio communications. However, there is no guarantee that interference will not occur in a particular installation. If this equipment does cause harmful interference to radio or television reception, which can be determined by turning the equipment off and on, the user is encouraged to try to correct the interference by one or more of the following measures:

- Reorient or relocate the receiving antenna.
- Increase the separation between the equipment and receiver.
- Connect the equipment into an outlet on a circuit different from that to which the receiver is connected.
- Consult the dealer or an experienced radio/TV technician for help."



# Warranty

## 1 YEAR LIMITED WARRANTY

This product is guaranteed to be free of defects in materials and workmanship for 1 year from the date of purchase.

Guarantee does not include normal wear and tear, bulbs or batteries. Contact the Customer Service Team or visit

[www.HOMEDEPOT.com](http://www.HOMEDEPOT.com).

### Wireless Protocol: ZigBee 3.0

This device is fully ZigBee 3.0 certified and will work with other open ZigBee 3.0 certified systems.



Questions, problems, missing parts? Before returning to the store,  
call Defiant Customer Service

M-F 9am-6pm PST

1-888-XXX-XXXX

HOMEDPOT.COM