

Federal Communication Commission Interference Statement

This device complies with Part 15 of the FCC Rules. Operation is subject to the following two conditions:

- (1) This device may not cause harmful interference, and
- (2) This device must accept any interference received, including interference that may cause undesired operation.

NOTE: This equipment has been tested and found to comply with the limits for a Class B digital device, pursuant to Part 15 of the FCC Rules. These limits are designed to provide reasonable protection against harmful interference in a residential installation. This equipment generates, uses and can radiate radio frequency energy and, if not installed and used in accordance with the instructions, may cause harmful interference to radio communications. However, there is no guarantee that interference will not occur in a particular installation. If this equipment does cause harmful interference to radio or television reception, which can be determined by turning the equipment off and on, the user is encouraged to try to correct the interference by one or more of the following measures:

- Reorient or relocate the receiving antenna.
- Increase the separation between the equipment and receiver.
- Connect the equipment into an outlet on a circuit different from that to which the receiver is connected.
- Consult the dealer or an experienced radio/TV technician for help.

FCC Caution: Any changes or modifications not expressly approved by the party responsible for compliance could void the user's authority to operate this equipment.

FCC Radiation Exposure Statement

This equipment complies with FCC radiation exposure limits set forth for an uncontrolled environment. End users must follow the specific operating instructions for satisfying RF exposure compliance. To maintain compliance with FCC RF exposure compliance requirements, please follow operation instructions as documented in this manual. This transmitter must not be co-located or operating in conjunction with any other antenna or transmitter. The availability of some specific channels and/or operational frequency bands are country dependent and are firmware programmed at the factory to match the intended destination. The firmware setting is not accessible by the end user.

FCC SDOC SUPPLIER'S DECLARATION OF CONFORMITY

Etekcitey Corporation hereby declares that this equipment is in compliance with the FCC rules. The declaration of conformity may be consulted in the support section of our website, accessible from www.etekcity.com



High Capacity 550 Pound Digital Body Weight Scale
Model Line: EBS-151

Quick Start Guide



To download the free VeSync app, scan the QR code or search "VeSync" in the Apple App Store® or Google Play Store.

- Note:**
- This scale does not use the VeSyncFit app.
 - Please make sure your firmware and software are up to date.
 - The VeSync app is continually being improved and may change over time. If there are any differences, follow the in-app instructions.



Open the VeSync app. **Log In** or **Sign Up**.

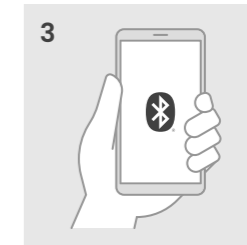

Make sure your phone has Bluetooth® turned on.



Tap **+** in the VeSync app.

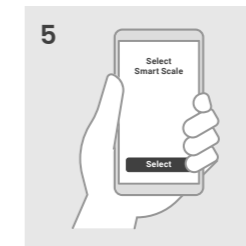

Select your smart scale from the device list.

Note: You can tap on the product categories to jump to different sections of the device list.

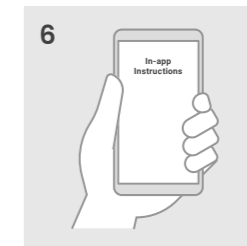

Follow the in-app instructions to complete setup.

- Note:**
- You can change the scale's in-app name and icon at any time in the smart weight scale settings.
 - When the scale display turns off, the scale's Bluetooth will disconnect and go into auto-off mode. However, when the scale display lights up and the app is opened to the device page, the scale will reconnect to Bluetooth.

Warranty

Scan Here to Receive Exclusive News

Your product comes with 2 years of warranty, starting from the date of purchase.

1. Scan the QR code or visit etekcity.com/warranty.
2. Enter your purchase info to receive exclusive news.
3. Learn about our quality customer support and gain easy access to warranty information.



Customer Support

Etekcitey Corporation
1202 N. Miller St., Suite A
Anaheim, CA 92806, USA

Email: support@etekcity.com
Toll-Free: (855) 686-3835

Support Hours
Monday – Friday
9:00 am – 5:00 pm PST/PDT

*Please have your invoice and order ID ready before contacting Customer Support.

Using Your Scale

Note: Before first use, remove the plastic insulator strip from the battery compartment.

- Place the scale on a hard, flat surface (not a carpet or mat).
Note: Placing on carpet may cause inaccurate measurements or tipping.
- Step on, then step off the scale and wait for the LCD display “0.0” to show before weighing.
- Stand on the scale until the digits on the display flash several times, showing your final measurement. If you’ve set up your smart scale in the VeSync app, your results (weight and BMI) will show in the app.

Tips

- To switch between pounds (lb), kilograms (kg), and stone(st), press the unit switching button on the underside of the scale.
 - You can also download the VeSync app and select the desired weight unit in the Device Settings menu.
- If the scale has been moved or flipped upside down, it needs to be cleared.
 - Step on the scale until digits appear on the display, then step off.
 - The scale will show “0.0” when cleared.
- If your scale won’t connect to the VeSync app:
 - Make sure your phone has Bluetooth® turned on and the scale is not currently connected to another Bluetooth® device. For Android users, make sure your Location is turned on as well.
 - Download and open the newest version of the VeSync app.
 - Make sure your phone’s operating system is iOS® 10.0+ or Android™ 5.0+.
- If you have other scale problems, try removing the batteries for 45 seconds, then replacing them. If the problem is not resolved, replace the batteries with new ones.

Display Messages

Lo	Low battery. Replace batteries.
{	Scale needs to be cleared. Please place the scale on a hard, flat surface and wait for it to be cleared before use.
Err	Weight exceeds 550 lb / 250 kg / 39 st. Use a scale with a higher weight capacity.

Specifications

Weight Capacity	550 lb / 250 kg / 39 st
Increments	0.1 lb / 0.05 kg (<200 kg) 0.2 lb / 0.1 kg (≥200 kg)
Weight Units	lb / kg / st
Platform	Tempered Glass
Battery	3 x 1.5V AAA Batteries
Auto-Off	30 seconds
Dimensions	14.4 x 12.4 x 1.2 in / 365 x 315 x 30.5 mm
Operating System	iOS® 10.0+ or Android™ 5.0+

READ AND SAVE THESE INSTRUCTIONS

Safety Information

Please read and follow all instructions and safety guidelines in this manual.

Medical

- This scale should not be used to diagnose or treat any medical condition.
- Scale data should not be used as a substitute for medical advice from a healthcare professional.

General Use

- Check the scale before using. **Do not** use the scale if it is damaged in any way.
- Do not** strike or hit the scale. **Do not** use the scale if the glass is cracked or broken. While tempered glass is stronger and fractures more safely than ordinary glass, it may shatter unexpectedly after developing a slight crack. If you see a crack, contact **Customer Support** immediately.
- The glass platform is slippery when wet. **Always** make sure the platform and your feet are dry before stepping on for measurement
- Place the scale on a hard, flat surface to avoid tipping.
- To weigh safely and accurately, stand with your feet shoulder-width apart while on the scale. **Do not** stand on the edge of the scale or jump on the scale.
- Avoid standing on the scale for a long period of time, or when you are not weighing yourself.
- Do not** overload the scale. Maximum weight capacity is 550 lb / 250 kg / 39 st.
- Keep the scale in a cool area with low humidity. Keep the scale away from heat sources, such as ovens or heaters. Avoid temperature fluctuations. Store the scale in a horizontal position, not vertical.
- Handle with care. Not for commercial use. Household use **only**.

Batteries

- Do not** mix new and old batteries.
- If the scale is not in use for a long period of time, remove the batteries to extend the lifetime of the scale.