

Caution: The user is cautioned that changes or modifications not expressly approved by the party responsible for compliance could void the user's authority to operate the equipment.

NOTE: This equipment has been tested and found to comply with the limits for a Class B digital device, pursuant to Part 15 of the FCC Rules. These limits are designed to provide reasonable protection against harmful interference in a residential installation.

This equipment generates, uses and can radiate radio frequency energy and, if not installed and used in accordance with the instructions, may cause harmful interference to radio communications. However, there is no guarantee that interference will not occur in a particular installation.

If this equipment does cause harmful interference to radio or television reception, which can be determined by turning the equipment off and on, the user is encouraged to try to correct the interference by one or more of the following measures:

- Reorient or relocate the receiving antenna.
- Increase the separation between the equipment and receiver.
- Connect the equipment into an outlet on a circuit different from that to which the receiver is connected.
- Consult the dealer or an experienced radio/TV technician for help.

规格如有变更，恕不另行通知。
实物可能与说明书上的图片有所不同。

Specifications are subject to change without notice.
Photos and illustrations may vary from actual product.

警告：
窒息危险-含有细小物件
不适合3岁以下的儿童使用

WARNING:
CHOKING HAZARD - small parts,
Not for children under 3 years.



中国制造 MADE IN CHINA

8+



遥控响尾蛇

RATTLESNAKE
radio-controlled rattlesnake

使用说明书
Assembly & Instruction

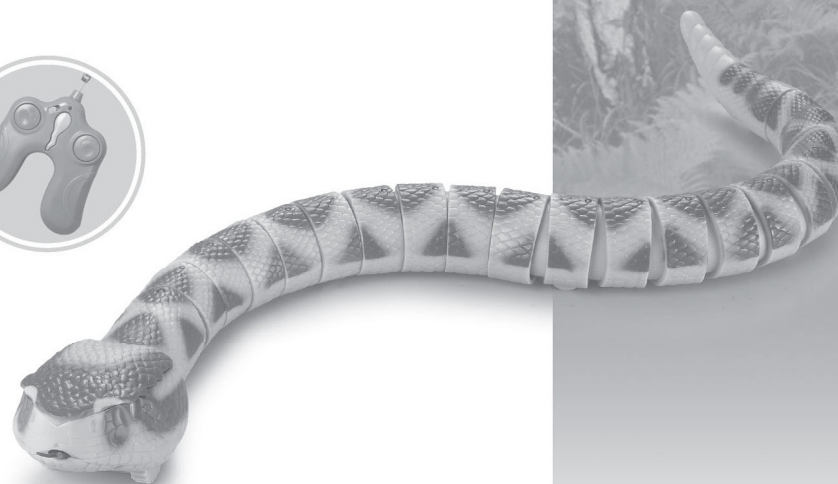

准备 Preparation:

1. 将头和身体连接起来，将电线穿过蛇的身体。确信那些小节能夹住小洞，如图.1所示。
2. 将蛇身体每部分连接起来，将小节结夹进洞里，如图.2 所示。
3. 蛇的每个节结有标注号码以便容易安装，如图.3 所示。

1. To attach the head onto the body, thread the wire through into the body of the snake.
Make sure the small nodules are clipped into the holes, (see illustr.1).
2. To attach the sections of the body together, clip the small nodules into the holes, (see illustr.2).
3. All the sections of the snake, are numbered to ensure easy assembly (see illustr.3).

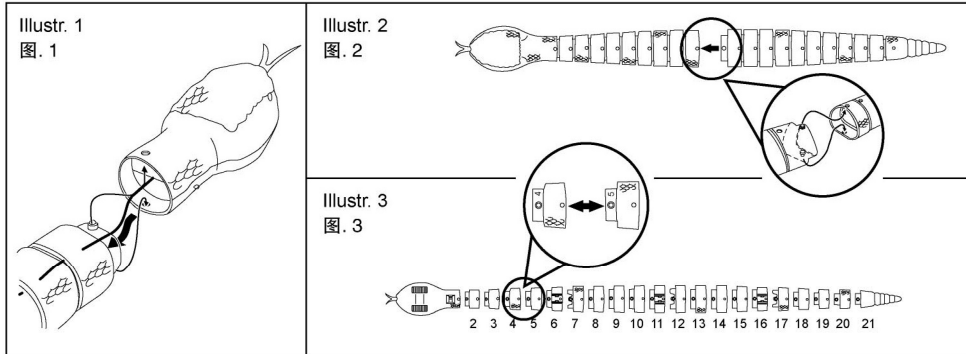

安装电池 Inserting the batteries:

1. 遥控器电池安装 Remote Control Battery Installation:

- (1). (如图.4)用十字螺丝刀按逆时针方向拧开遥控器后面电池盖上的螺丝，打开电池盖。
- (2). 根据里面的正负极标志，装入一个9V的电池(如图.5)，盖上后面板，用十字螺丝刀将螺丝旋紧。
- (3). 将遥控器开关移到ON的位置上(如图.6)。

- (1). (see illustr.4)To insert batteries into the controller, unscrew and remove the rear panel using a philips screwdriver.
- (2). Insert one 9V (6LR61) battery (see illustr.5), following the polarities indicated on the internal printed sticker. Re-screw the back panel removed in step one.
- (3). On the controller slide the switch to the ON position (see illustr.6).

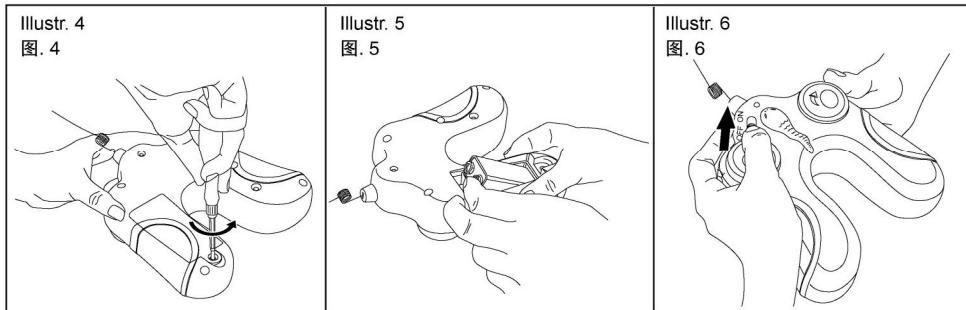

2. 蛇的电池安装 Snake battery installation:

- (1). 打开蛇的头部，露出头部下面的面板(如图.7)。
- (2). 用十字螺丝刀将电池盖打开，按里面的正负极标志装入4节1.5V “AAA” 电池(如图.8)。
- (3). 再用螺丝刀将电池盖合上，将响尾蛇翻转过来，把开关移到ON的位置(如图.9)。

- (1). To insert batteries into the snake, lift off the upper head section revealing the panel below (see illustr. 7).
- (2). Un-screw the battery cover using a philips head Screwdriver and remove. Insert 4x AAA batteries, into the head section, following the polarities indicated on the internal printed sticker (see illustr. 8).
- (3). Re-screw the battery cover and replace the head section. Turn the rattlesnake upside down and slide the switch to ON (see illustr. 9).

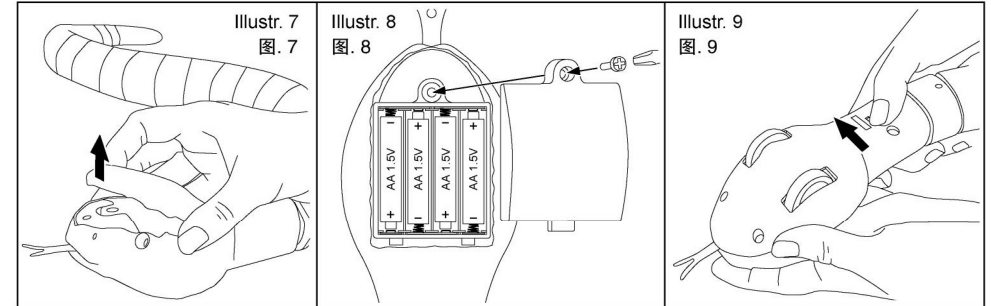

开动响尾蛇 Operating the rattlesnake:

