

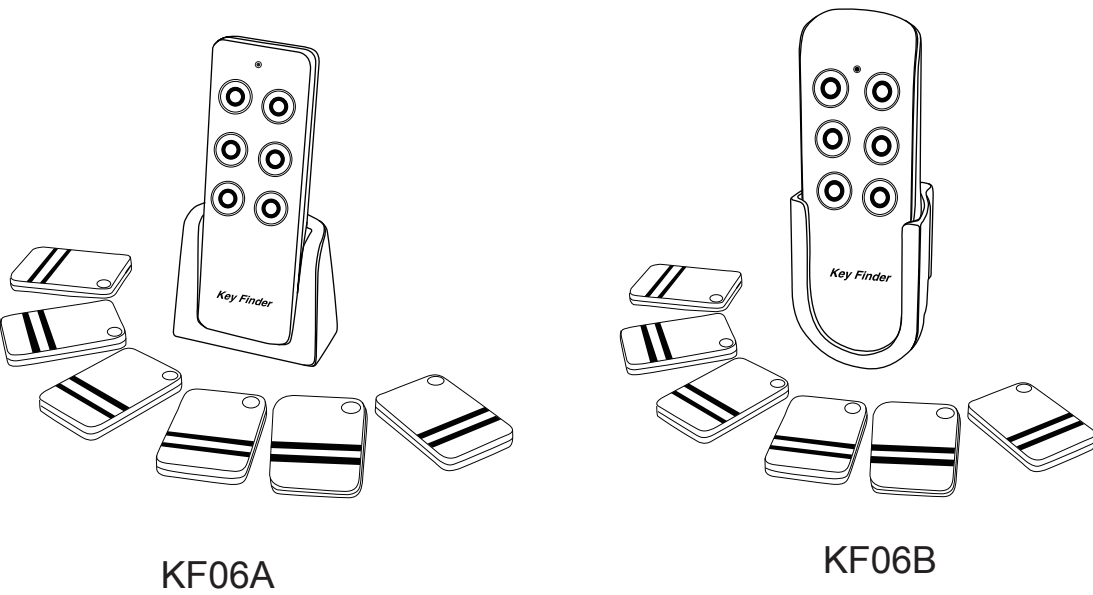

KEY FINDER

Instructions for Use

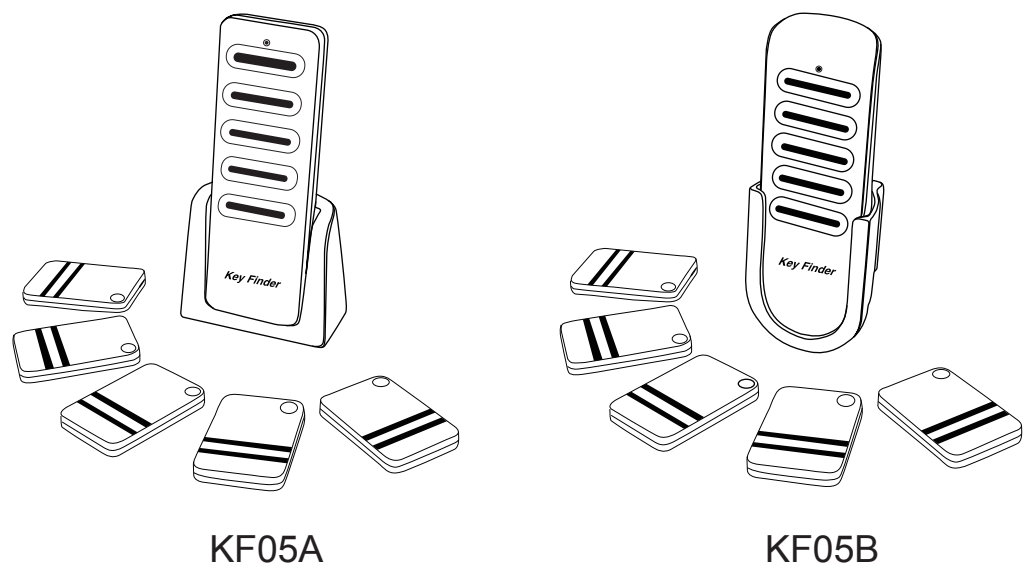

Introduction

This key finder can help you to find the lost keys, remotes, purse, eyeglass, cane, and other easily lost items quickly. With just one press on the color-coded button, the beep sound and flashes will lead you to find the lost items.

The key finder with base support is also a good display for your house. The transmitter is removable from base and can be carried with you to find lost items.

Product Diagrams

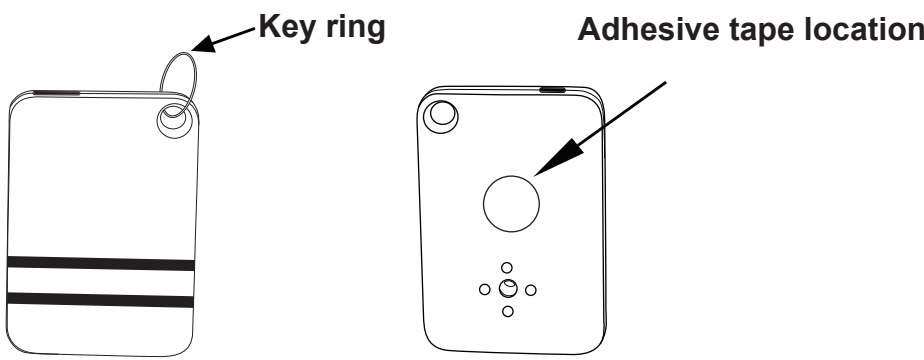
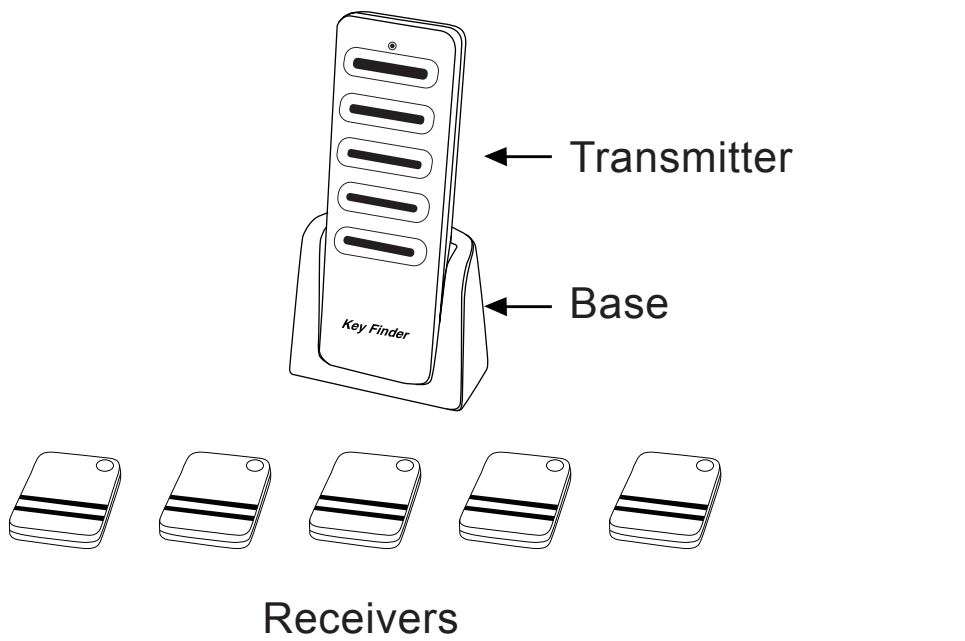

Batteries Installation

A. Transmitter

Follow the steps below to install batteries into the transmitter.

1. Remove the battery door located on the back of the transmitter.
2. Install the batteries according to the (+) and (-) marks inside the battery compartment.
3. Push the battery door back into place.

B. Receiver

1. Open the outer shell with the opening tool provided.
2. Replace CR2032 battery. Please mind the polarity of battery.
3. Close the outer shell.

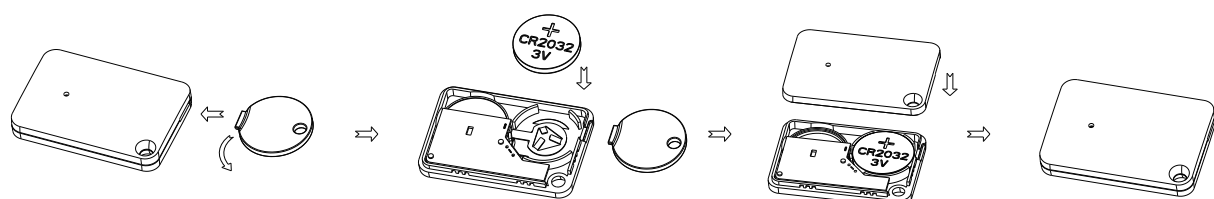

(Installing new batteries)

Warning:

- Do not mix old and new batteries.
- Do not mix Alkaline, standard (carbon-zinc) or rechargeable batteries.



Protect the environment and respect the law. Please handle the old battery properly. Never discard it by throwing into a garbage bin.

Operation

1. Attach the color-coded receivers to your frequently lost items with the key rings or double sided adhesive tape.
2. Press and release the corresponding color-coded button on the transmitter.
3. If the receiver is in range, it will beep and meanwhile the LED indicator will flash.
4. If no beep is heard, change your location or use new batteries and press the button again.

FCC Warning:

This equipment has been tested and found to comply with the limits for a Class B digital device, pursuant to part 15 of the FCC Rules. These limits are designed to provide reasonable protection against harmful interference in a residential installation. This equipment generates, uses and can radiate radio frequency energy and, if not installed and used in accordance with the instructions, may cause harmful interference to radio communications. However, there is no guarantee that interference will not occur in a particular installation. If this equipment does cause harmful interference to radio or television reception, which can be determined by turning the equipment off and on, the user is encouraged to try to correct the interference by one or more of the following measures:

- Reorient or relocate the receiving antenna.
- Increase the separation between the equipment and receiver.
- Connect the equipment into an outlet on a circuit different from that to which the receiver is connected.
- Consult the dealer or an experienced radio/TV technician for help.

Caution: Any changes or modifications to this device not explicitly approved by manufacturer could void your authority to operate this equipment.

This device complies with part 15 of the FCC Rules. Operation is subject to the following two conditions: (1) This device may not cause harmful interference, and (2) this device must accept any interference received, including interference that may cause undesired operation.

The device has been evaluated to meet general RF exposure requirement.