

Maintenance and safety precautions

- Do not use this Speaker near water.
- Clean with a dry or slightly moist cloth.
- Do not expose your Speaker to excessive heat, flames or fire.
- Always press all buttons carefully.
- Do not attempt to repair this Speaker yourself. Contact our support center if this Speaker is in need of service.

BATTERY WARNING:

- Do not connect improperly.
- Do not dispose of in fire or expose to excess heat.
- Do not crush, puncture, incinerate, or short circuit external contacts.

Please recycle or dispose of the battery properly. Contact local recycling facilities and/or the manufacturer of your battery for further information

SAKAR INTERNATIONAL INC.
195 CARTER DRIVE EDISON, NJ08817.
SUPPORT: 800 592 9541,
WWW.VIVITAR.COM
SAKAR/VIVITAR UK
2D SISKIN PARKWAY EAST CV3 4SU. UK
SUPPORT: 0800 917 4831

Regulatory Notices

This device complies with the part 15 of the FCC rules. Operation is subject to the following two conditions:(1) this device may not cause harmful interference , and (2) this device must accept any interference received, including interference that may cause undesired operation.
Caution: Changes or modifications not expressly approved by the party responsible for compliance could void the user's authority to operate the equipment.

NOTE: This equipment has been tested and found to comply with the limits for a Class B digital device, pursuant to Part 15 of the FCC Rules. These limits are designed to provide reasonable protection against harmful interference in a residential installation. This equipment may generate and radiate radio frequency energy, if not installed properly or used in accordance with instructions. May cause harmful interference to radio or television reception, which can be determined by turning the equipment off and on. The user is encouraged to try to correct the interference by one or more of the following measures:

- Reorient or relocate the receiving antenna.
- Increase the separation between the equipment and receiver.
- Connect the equipment into an outlet on a circuit different from that to which the receiver is connected.
- Consult the dealer or experienced technician for help.

<4>

Sakar Warranty Card

Sakar Warranty

This warranty covers the original consumer purchaser only and is not transferable. This warranty covers products that fail to function properly **UNDER NORMAL USAGE**, due to defects in material or workmanship. Your product will be repaired or replaced at no charge for parts or labor for a period of one year.

What Is Not Covered by Warranty

Damages or malfunctions not resulting from defects in material or workmanship and damages or malfunctions from other than normal use, including but limited to, repair by unauthorized parties, tampering, modification or accident.

What To Do When Service Is Required

When returning your defective product (postage pre-paid) for service, your package should include:

1. Copy of original bill of sale
2. A detailed written description of the problem.
3. Your return address and telephone number (Daytime)

MAIL TO ADDRESS BELOW:

In the U.S.
Sakar International
Attention: Service Department
195 Carter Drive
Edison, NJ 08817

In the U.K.
Sakar UK
2D Siskin Parkway East
CV3 4SU, UK

You may also visit sakar.com for further assistance if necessary or call our technical support department toll free at 1-877 397 8200 or 1 800 592 9541 in the US, or 0-800-917-4831 in the UK.

<5>

BLUETOOTH SPEAKER Instruction Manual



© 2018 SAKAR INTERNATIONAL, INC. ALL RIGHTS RESERVED.

Introduction

Thank you for purchasing this Bluetooth Speaker which can be used with iPad, iPhone, and most of smartphones with Android or ios system to listen to music wirelessly. Please read this manual first before use in order to get the best result.

Features

Wireless music via Bluetooth
Aux-in port
Built-in rechargeable battery

Specification

Bluetooth version: V2.1
Operation range: up to 10 meters
Play time: 4 hours approximately

Package Contents

Bluetooth speaker
USB charging cable
3.5mm audio cable
Instruction manual

Parts and Control

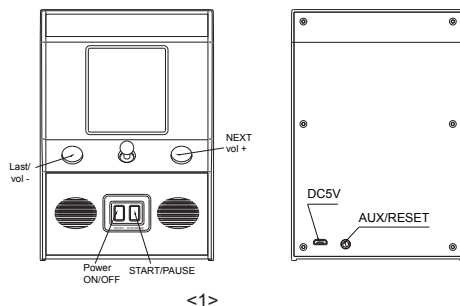

Operation Guide

1. Charge the Speaker

- Charge the Speaker by connecting the Speaker and a USB port of a computer or a charger (with out-put voltager of 4.75-5.25VDC) with the included USB charging cable.
- The red led lights up (near the DC5V USB charging port) during charging, and goes out when fully charged (about 5 hours).

Note: Please fully charge the Speaker before the first time use.

2. Turn on the Speaker

- Press the Power ON/OFF button for 1 second, and the LED light flashes (near the USB charging port).
- The voice prompt "Bluetooth Model" comes, reminding you to make Bluetooth pairing.

Note: If the Speaker was previously paired to your device (phone or computer with Bluetooth), the Speaker will automatically connect to your device and then the voice "The Bluetooth device is connected successfully" follows. Please ensure your device is in the Bluetooth operation range and the Bluetooth function is active.

3. Pair the Speaker to a Bluetooth device

- Power on your Bluetooth device and activate the Bluetooth function.
- After hearing the voice "Bluetooth Model" from the Speaker, click on the name of Speaker ("177GAM") on the list of "OTHER DEVICES" or "MY DEVICES" on the Bluetooth page of your device. Then the name "177GAM" moves to the list of "MY DEVICES" with its state "Connected" accompanied with the voice "The Bluetooth device is connected successfully".
- Now you can start playing the music of your device on this Bluetooth Speaker.

Note 1: For successful pairing, please make sure there is no other device connected to this Speaker in the operation range.

Note 2: In case that the Speaker is disconnected from your device, the voice "the bluetooth device is ready to pair" prompts you to pair the Speaker again.

Note 3: The LED light turns on after pairing successes and changes to flash during play music.

4. Controls on Music Play

- Play/ Pause Button: press it to change Play/ Pause state.
- Next/ Vol+ Button: Short press to select next music for play. Long press (for 1 second) to increase the volume.
- Previous/ Vol- Button: Short press to select previous music for play. Long press (for 1 second) to decrease the volume.

Note: When play audio through Aux-in jack, the device of the audio source can not be controlled by the "Next" and "Last" buttons on the speaker.

5. Aux-in

- Aux-in jack (3.5mm ear phone jack) is provided for connecting the audio source (e.g. MP3 player, mobile phone, computer,...) with the included audio cable.
- When the Aux-in jack is plugged, the voice "Line in" follows and the audio connected to the Aux-in jack dominates the Bluetooth Speaker. The audio from the Bluetooth connection stops till the Aux-in jack is unplugged.

Note: After power on, if you like to play audio through Aux-in Jack, please make sure the Aux-in jack is not plugged (otherwise please firstly unplug the Jack) and then connect the Aux-in jack and your audio source with the included audio cable.

6. Turn Off the Speaker

- Press the Power ON/OFF button for 1 second to turn off the Speaker while it's on.

Note1: If the Speaker is not connected to a device or pause for around 5 minutes, it will turn off automatically.

Note2: If the speaker gets out of control, please stick the Aux/Reset hole for 1 second with a small screw driver to reset it.