

ARMSTRONG

SMART DIGITAL CABINET LOCK

User Manual

SDWC-001W

SPECIFICATIONS

Operation Frequency:	125KHZ	Antenna Gain(Peak):	125KHZ	Temperature:	-2° C~40° C
Modulation Type:	Internal switch	Output Power:	DC4.5V	Humidity:	20%~80%

FUNCTIONS AND SETTINGS

- Auto-close mode: Press button“A” (“beep,beep”sound)
- Manual-close mode: Press button“A”(“beep”sound)
- Single card mode: Use an user card to touch open the lock
- BL-Card mode:Use an user card along with a service card to touch open within 8 seconds,It can not be used without the other card

SET UP A MANAGEMENT CARD

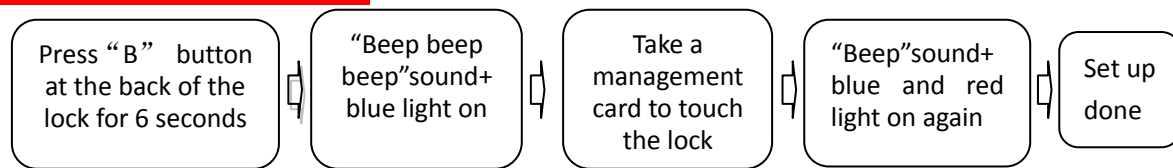

SET UP AN USER CARD

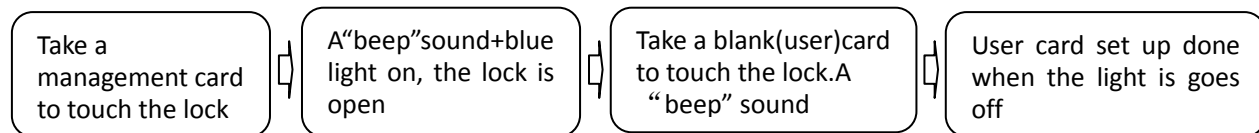

SET UP A SERVICE CARD

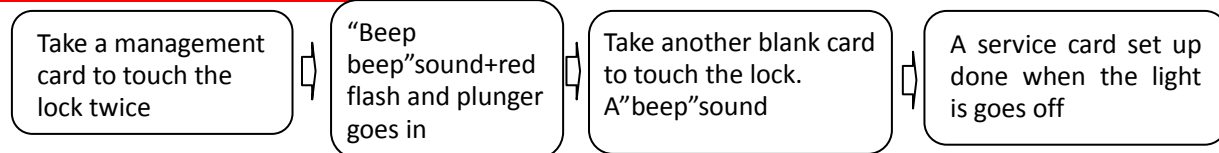

DELETE AN INDIVIDUAL USER CARD

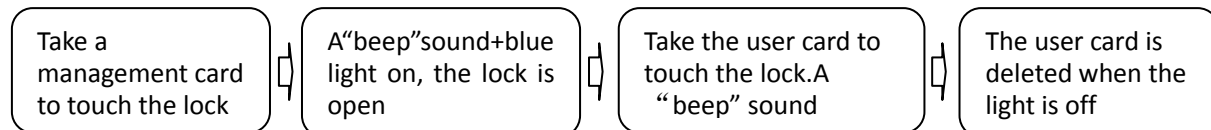

DELETE AN INDIVIDUAL SERVICE CARD

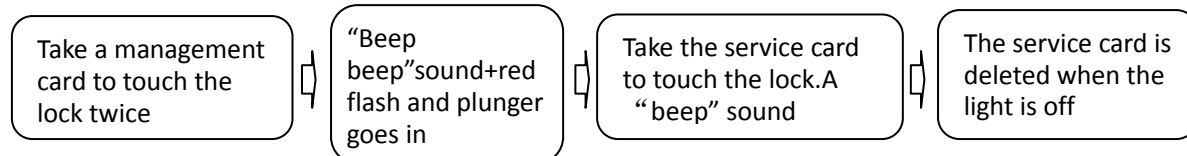

DELETE ALL SERVICE AND USER CARDS

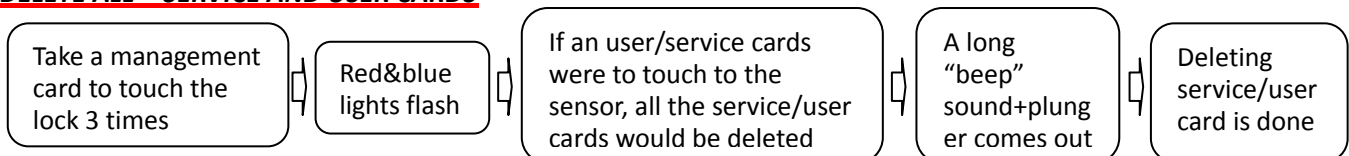

DELETE ALL SERVICE AND USER CARDS

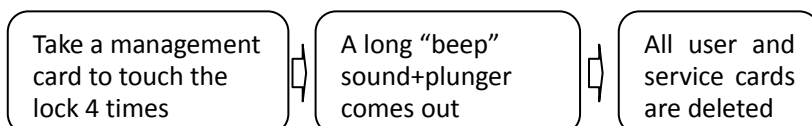

LOW VOLTAGE ALARM

--If there is a long “beep beep” sound with red light flash twice, it means the battery is low. Please change new batteries(3pcs 1.5V alkaline batteries)

! WARNING

--Input voltage can not be greater than 6V

--Risk of suffocation from small parts and packing materials!

Screws, small parts and packing materials can be deadly playthings for children.

> Do not leave the packing materials and the contents lying around carelessly, and keep away from children and babies.

> Keep children away from the installation site during installation.

--Risk of fatality due to failures or faults in electromagnetically sensitive devices!

The electromagnetic radiation of the product can cause faults in sensi-tive parts (e.g. in medical equipment). The functionality thereof will be adversely affected.

> Do not mount product close to electromagnetically sensitive devices.

> Pay attention to the safety instructions for the electromagnetically sensitive devices.

> If you have any doubts regarding compatibility, please contact the manufacturer.

INSTALLATION

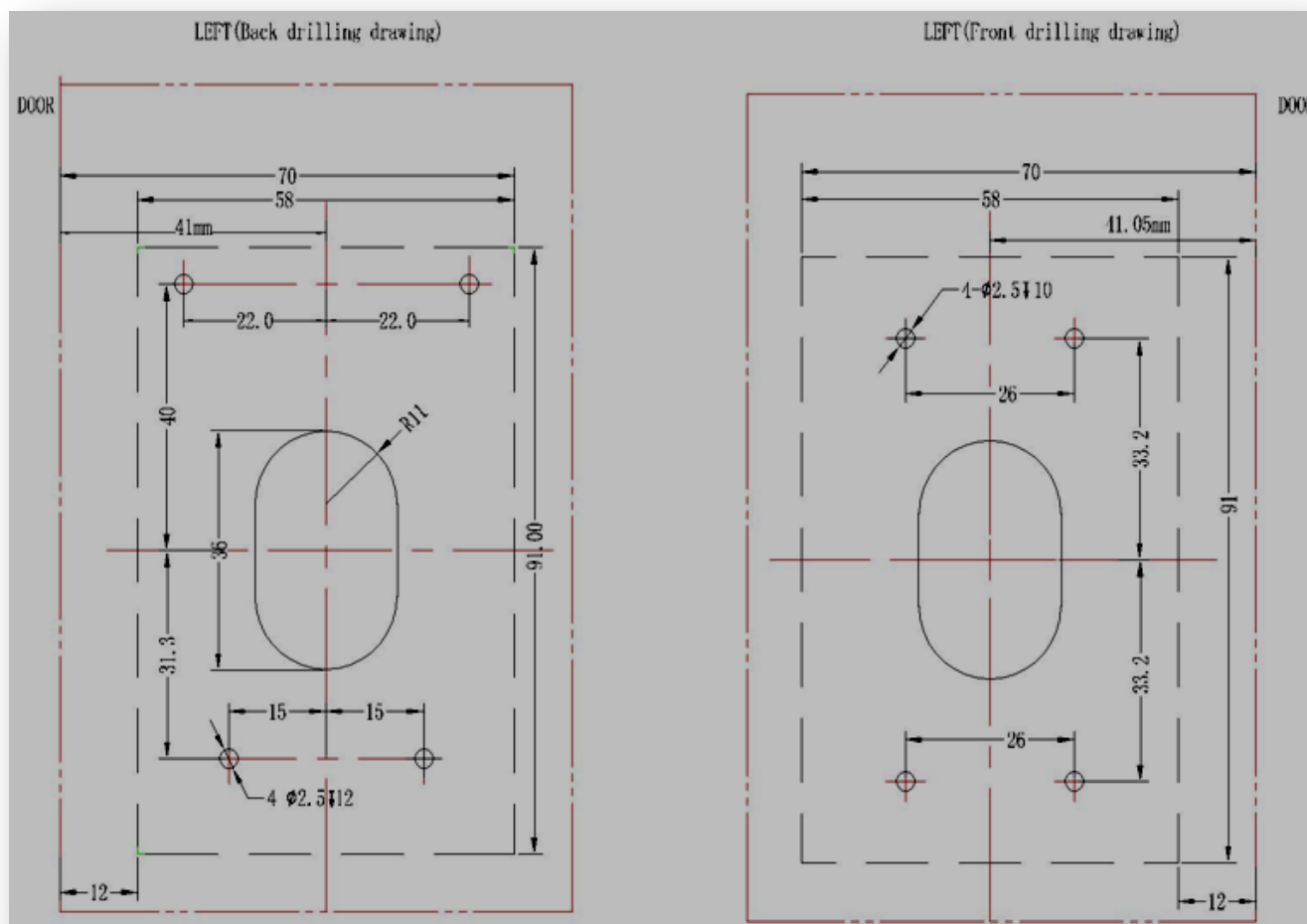

LEFT(Back drilling drawing)

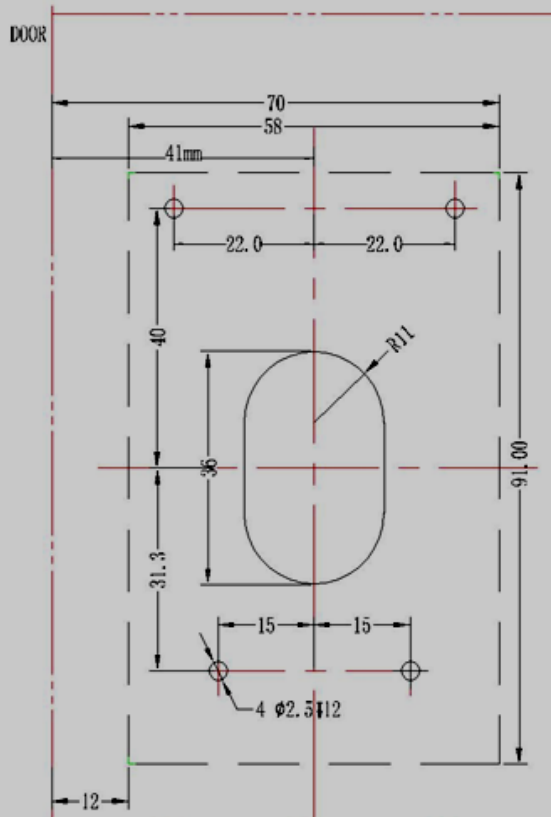

LEFT(Front drilling drawing)

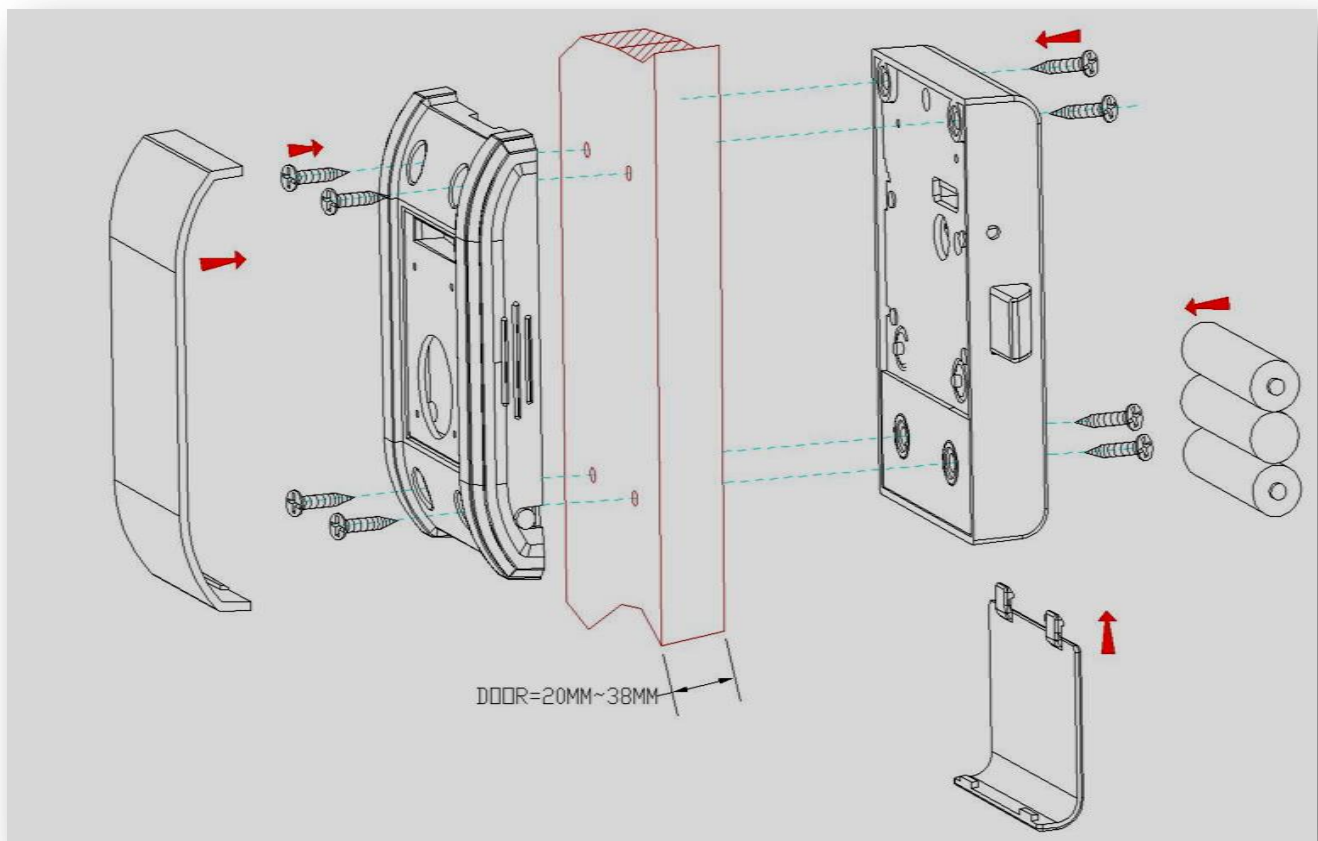
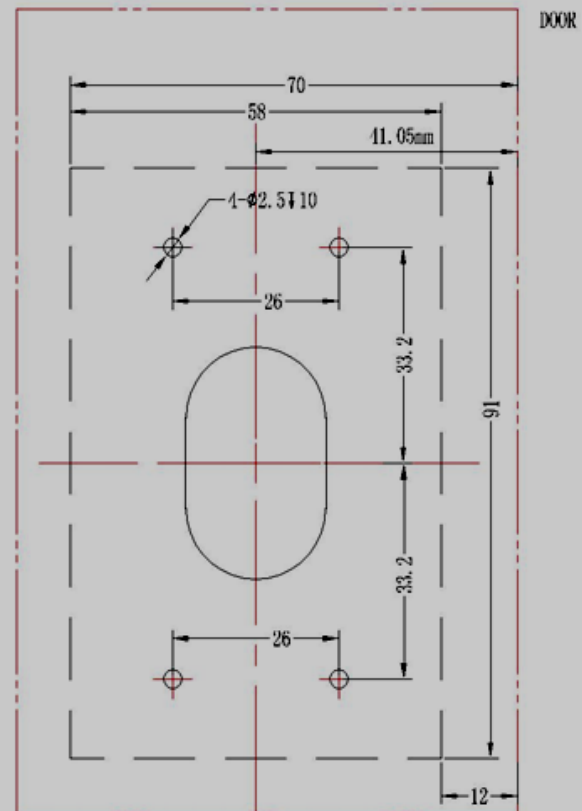

--- If parts are missing or damaged, contact the manufacturer.