

Front

Bluetooth headset BB896

FCC Information

This device complies with Part 15 of the FCC rules.

Operation is subject to the following two conditions: (1) this device may not cause harmful interference, and (2) this device must accept any interference received; including interference that may cause undesired operation.

Federal Communications Commission (FCC) Statement

This Equipment has been tested and found to comply with the limits for a Class B digital device, pursuant to Part 15 of the FCC rules. These limits are designed to provide reasonable protection against harmful interference in a residential installation. This equipment generates, uses and can radiate radio frequency energy and, if not installed and used in accordance with the instructions, may cause harmful interference to radio communications. However, there is no guarantee that interference will not occur in a particular installation. If this equipment does cause harmful interference to radio or television reception, which can be determined by turning the equipment off and on, the user is encouraged to try to correct the interference by one or more of the following measures:

- Reorient or relocate the receiving antenna.
- Increase the separation between the equipment and receiver.
- Connect the equipment into an outlet on a circuit different from that to which the receiver is connected.
- Consult the dealer or an experienced radio/TV technician for help.

Warning: Changes or modifications to this unit not expressly approved by the party responsible for compliance could void the user authority to operate the equipment.

Tested to comply with FCC standard, FOR HOME OR OFFICE USE.

Warning :

This equipment complies with FCC RF radiation exposure limits set forth for an uncontrolled environment. This device and its antenna(s) must not be co-located or conjunction with any other antenna or transmitter.

FCC ID: 2AAVAJP25D

Wireless Earbuds

Thank you for choosing a Billboard® Bluetooth™ earbuds. For best use of your new device we recommend carefully reading the user manual and keeping it for your records

Package contains

- Wireless earbuds
- Soft rubber ear tips
- USB charging cable
- Extra ear cushions
- Instruction manual

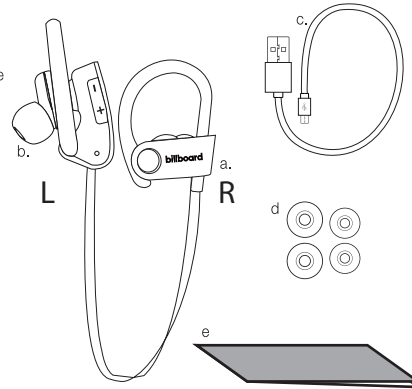

CONTROLS

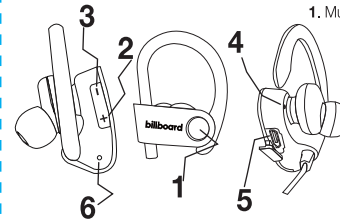

- Multifunction Button (MFB) Answer, end, reject call, Play, Pause, ON/OFF
- Next song/Volume up
- Previous song/Volume down
- Microphone
- USB Charging Port
- Indicator Light

Charging the battery

This device has an internal, rechargeable battery.

- Connect the charger cable to the charging port on the left side of the earbuds.
- Then connect the charger cable to a USB power source. The red indicator light will display during charging. If charging does not start, disconnect the charger, plug it in again, and retry. Charging the battery fully may take up to 2 hours.
- When the battery is fully charged, the red indicator light will turn off. Disconnect the charger from the USB power source and the earbuds. The fully charged battery has power for up to 5 hours of talk-time, 5 hours music time and up to 120 hours of standby time. However, the talk, music and standby times will vary from different devices, settings, and environments.

Pairing the Earbuds with a compatible phone

- Make sure your earbuds is turned off.
- Press and hold the MFB key until the indicator light blinks blue and red.
- Activate the Bluetooth® feature on the device, and set the device to search for Bluetooth® devices. The name of the Wireless earbuds is BB-BT-EP. See the user guide of your device for instructions.
- If the pairing is successful, the indicator light will flash blue.
- If pass code is requested enter (0000) Once the earbuds has paired with your device, no password will be needed to reconnect. If not paired, the earbuds will turn off automatically in a few minutes.

Power ON/OFF & Reconnecting

To switch on, press and hold the MFB key until the indicator light blinks blue and red.

To switch off, press and hold the MFB key until the indicator light turns off.

Adjust volume, Momentarily press the **+** to increase the volume and press the **-** to decrease the volume.

Next song, Press and hold **+**

Previous song, Press and hold **-**

Pause song, press the MFB key while music is playing.

Answer a Call

To answer and end a call, press the MFB key, or use the phone keys. (music will automatically pause during phone calls)

To reject a call, press and hold MFB key, or use the phone keys.

Redial the last number you called, press the Multifunction button twice quickly.