

Front

FCC Information

FCC ID: 2AVALP25

This device complies with Part 15 of the FCC rules.

Operation is subject to the following two conditions: (1) this device may not cause harmful interference, and (2) this device must accept any interference received, including interference that may cause undesired operation.

Federal Communications Commission (FCC) Statement

This Equipment has been tested and found to comply with the limits for a Class B digital device, pursuant to Part 15 of the FCC rules. These limits are designed to provide reasonable protection against harmful interference in a residential installation. This equipment generates, uses and can radiate radio frequency energy and, if not installed and used in accordance with the instructions, may cause harmful interference to radio communications. However, there is no guarantee that interference will not occur in a particular installation. If this equipment does cause harmful interference to radio or television reception, which can be determined by turning the equipment off and on, the user is encouraged to try to correct the interference by one or more of the following measures:

- Reorient or relocate the receiving antenna.
- Increase the separation between the equipment and receiver.
- Connect the equipment into an outlet on a circuit different from that to which the receiver is connected.
- Consult the dealer or an experienced radio/TV technician for help.

Warning: Changes or modifications to this unit not expressly approved by the party responsible for compliance could void the user authority to operate the equipment.
Tested to comply with FCC standard. FOR HOME OR OFFICE USE.

Warning :

This equipment complies with FCC RF radiation exposure limits set forth for an uncontrolled environment. This device and its antenna(s) must not be co-located or conjunction with any other antenna or transmitter.

Wireless Headset

Thank you for choosing a Billboard® Bluetooth™ headset. For best use of your new device we recommend carefully reading the user manual and keeping it for your records

Package contains

- Wireless headset
- Soft rubber ear tips
- USB charging cable
- Extra ear cushions
- Instruction manual

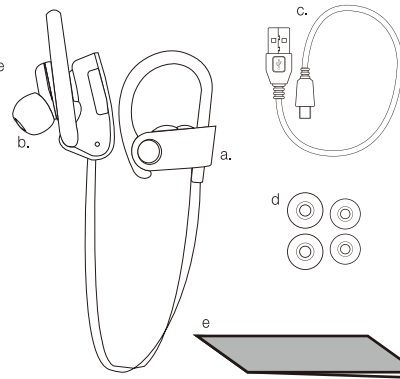

CONTROLS

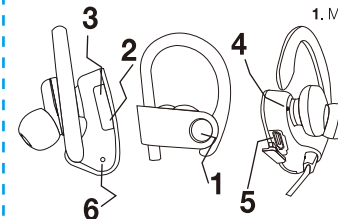

- Multifunction Button (MFB) Answer, end, reject call, Play, Pause, ON/OFF
- Next song/Volume up
- Previous song/Volume down
- Microphone
- USB Charging Port
- Indicator Light

Charging the battery

This device has an internal, rechargeable battery.

- Connect the charger cable to the charging port on the left side of the headset.
- Then connect the charger cable to a USB power source. The red indicator light will display during charging. If charging does not start, disconnect the charger, plug it in again, and retry. Charging the battery fully may take up to 3 hours.
- When the battery is fully charged, the indicator light will turn blue and then turn off after 5 minutes. Disconnect the charger from the USB power source and the headset. The fully charged battery has power for up to 5 hours of talk-time, or up to 3 hours music time and up to 120 hours of standby time. However, the talk, music and standby times will vary from different devices, settings, and environments.

Bluetooth earphone JP25

Pairing the headset with a compatible phone

- Make sure your headset is turned off.
- Push the MFB key for about 3-5 seconds until the light flashes blue and red alternately.
- Activate the Bluetooth® feature on the device, and set the device to search for Bluetooth® devices. The name of the Wireless Headset is BB896. See the user guide of your device for instructions.
- If the pairing is successful, the headset's blue light will flash every 6 seconds.
- If pass code is requested enter (0000) Once the headset has paired with your device, no password will be needed to reconnect

Power ON/OFF & Reconnecting

To switch on, press and hold the MFB key until the blue indicator light blinks on and off.

To switch off, press and hold the MFB key until the red indicator light blinks on and off.

Adjust volume, Press and hold the **+** to increase and the **-** to decrease volume.

Next song, Momentarily press the **+**

Previous song, Momentarily press the **-**

Pause song, press the MFB key while music is playing.

Answer a Call

To answer and end a call Press the MFB key, or use the phone keys.
(music will automatically pause during phone calls)

To reject a call Press and hold MFB key **for 2 seconds, once the call is rejected successfully, release the MFB key**, or use the phone keys.

Redial the last dialed out number, Press the Multifunction button twice quickly.