



WIRELESS OUTDOOR HUMIDITY AND TEMPERATURE MONITOR INSTRUCTION MANUAL Model No. TX7B/TX7C

Introduction

Congratulations on your purchase of the wireless outdoor humidity and temperature monitor. You will now be able to know the outdoor temperature and humidity while sitting inside.

The model number of the remote sensor for this unit is TX7B (USA & Canada Version), TX7C (European Version).

Additional sensors may be ordered directly from Amazon or ThermoPro by contacting our customer service listed below.

Components

2. One remote sensor (Transmitter)

* Although the remote sensor is designed to be rain-proof, it still must be always put in a dry place to avoid direct rainfall.

Outdoor Remote Sensor (Transmitter) Features

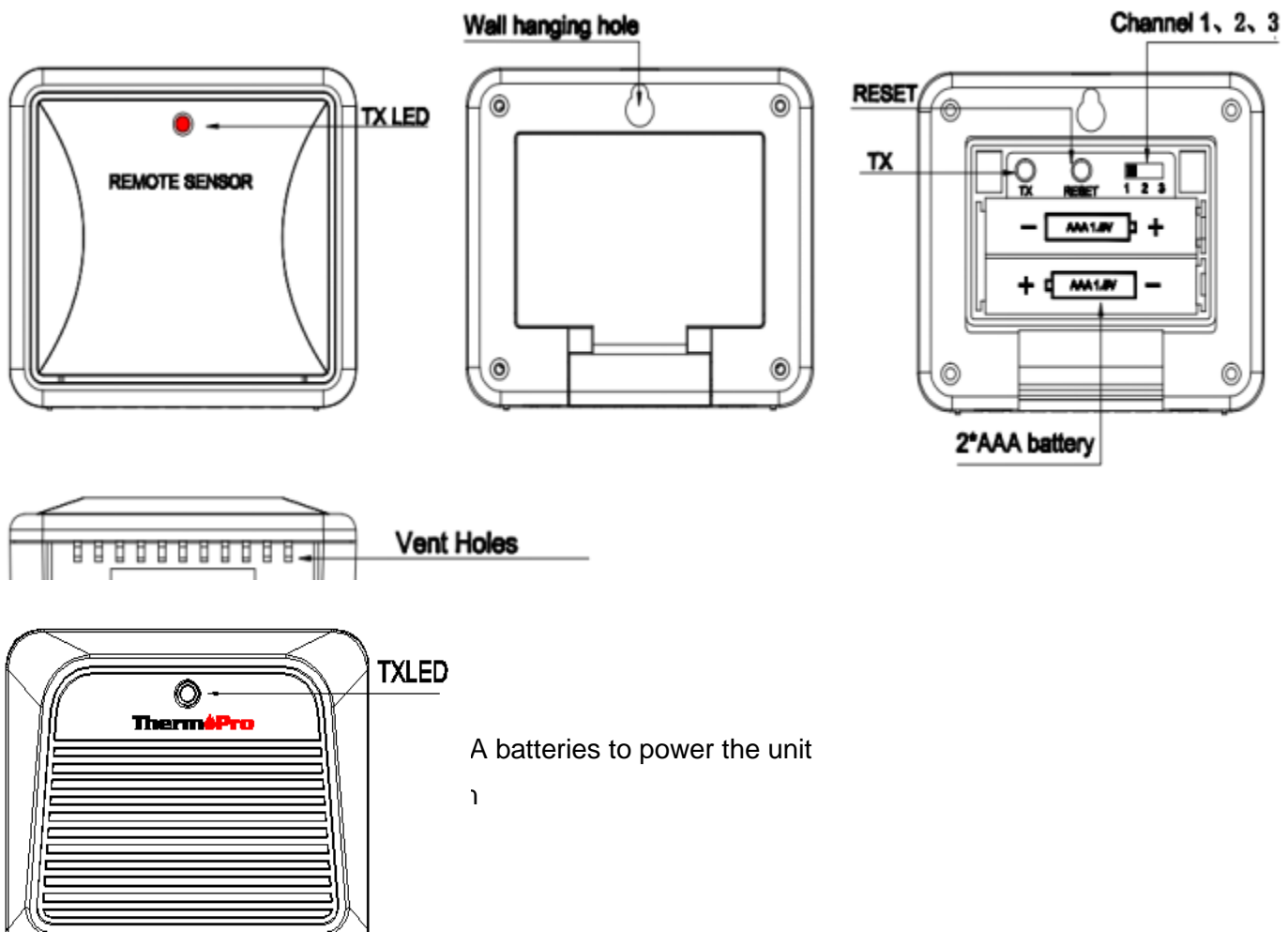

4. Outdoor Temperature range: -58°F ~ 158°F (-50 °C ~ 70 °C)
5. Humidity range: 10% ~ 99%

Buttons

CHANNEL Selector (1,2,3): Slide to set Channel 1,2 or 3.

RESET: Press once to reset the remote sensor.

TX: Press to send temperature/humidity data to the receiver manually.

Battery Installation and Setup

1. Open the battery compartment of the remote sensor as below Figure;

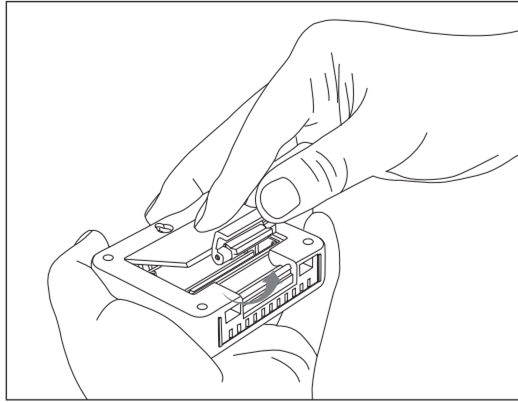
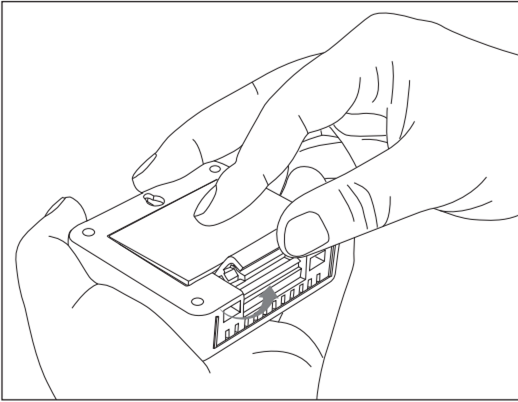

2. Slide the channel selector switch inside the battery compartment to your desired channel. For the first remote you may select any channel, for additional remotes select any unused channel;
3. Insert (2) AAA batteries according to the polarity markings. Replace the battery compartment cover;
4. Open the battery compartment at the back of the base station and insert (2) AAA batteries according to the polarity markings. Replace the compartment door;

Note:

Do not mix old and new batteries.

Do not mix alkaline, standard (carbon zinc), or rechargeable (nickel cadmium) batteries.



For maximum performance in normal conditions we recommend using good quality alkaline batteries.

If the battery power is low, there will be low battery icon showing on the base station display.

Synchronize Remote Sensors with The Base Station

Please note: each time the batteries (either base station or remote sensor) are replaced or base station/remote sensor lost connection, make sure to follow the below synchronization process to pair and re-connect the base station and remote sensor:

1. Position the remote sensor near the base station;

2. Once the batteries are installed in the base station, the RF signal icon  (located on the upper left of the base station display) will flash for 3 minutes, indicating that the base station is in synchronization mode: it is waiting for remote sensors to be registered.
3. If 3 minutes have passed after the batteries were installed in the base station and the RF signal Icon  is no longer flashing, press and hold the CHANNEL/SYNC button on the back of the base station for 3-4 seconds until the RF signal icon is flashing again to set it back in synchronization mode;
4. Install the batteries in the remote sensor and wait for a moment or just press either the TX or RESET button inside the remote sensor battery compartment, the remote sensor temperature/humidity will show on the base station display which indicates the synchronization is complete.
5. If you have additional remote sensors, repeat the above steps to register the remote sensors (up to 3 remote sensors can be registered with one base station);
6. If you have registered more than one sensor, press the CHANNEL/SYNC button on the base station to select the remote channel you want displayed permanently on the base station. Press CHANNEL/SYNC button until you observe a circular arrow on the base station LCD display under the channel number. The unit will then auto-scroll, changing from channel to channel every 5 seconds.

Place the Base Station and Remote Sensor

1. The indoor base station (receiver) should always be placed in a well ventilated indoor area and located away from vents, heating or cooling elements, direct sunlight, windows, doors, or any other openings.
2. The remote sensor (transmitter) can be placed on a flat surface indoor or outdoor. Make sure the sensor is within the transmission distance from the base station and with minimal obstructions.
3. **Although the remote sensor is designed to be rain-proof, the remote sensor must be always placed upwards so that rain won't get inside the sensor through the vent holes on the bottom of the sensor which functions to let the remote sensor detect the environmental temperature and humidity more precisely and quickly.**
4. The base station and remote sensor can both be wall mounted.

Synchronize Remote Sensors with The Base Station

ThermoPro TX7B/TX7C Universal Waterproof Transmitter Monitor Temperature and Humidity Outdoor Sensor , Compatible with TP260/TP280/TP360/TP394 Series Indoor Outdoor Thermometer

1. Place the remote sensor near the base station;
2. press and hold the "CH/ON/OFF" button for 3 seconds to turn on the outdoor sensor.
3. Press the ON/OFF/CHANNEL button (on the back of the remote sensor unit) to display 1 or 2 or 3. The unit is pre-set Channel 1 and you can always leave it unchanged unless you have purchased more than 1 remote sensor.
4. Press and hold the °C/°F button for 3 seconds to select the temperature unit.

5. Once the batteries are installed in the base station, the RF indicator  will flash for 3 minutes, indicating that the base station is in synchronization mode: it is waiting for remote sensors to be registered.

6. Press the ° C / ° F button on the back of the sensor once and the LED flashes once. Then wait for a while until the remote sensor on the base station indicating synchronization shows that the temperature is complete

7. If the synchronization is not successful after 3 minutes when the batteries are installed in the base station and the RF indicator  no longer flashes, press and hold the CHANNEL/SYNC button on the back of the base station for 3-4 seconds until the RF indicator flash again to set it back in synchronization mode;

8. If you have additional remote sensors, repeat the above steps to synchronize the additional remote sensors (up to 3 remote sensors can be registered with one base station). Please note the additional sensors should be set to a different channel.

9. If you have registered more than one sensor, press the CHANNEL/SYNC button on the base station to select the remote channel you want displayed permanently on the base station. Press CHANNEL/SYNC button until you observe a circular arrow on the base station LCD display under the channel number, then the unit will auto-scroll, changing from channel to channel every 5 seconds.

Place the Remote Sensor

1. The remote sensor (transmitter) can be placed on a flat surface indoor or outdoor. Make sure the sensor is within the wireless distance from the base station and with minimal obstructions. Although the remote sensor is designed to be rain-proof, it still must be always put in a dry place to avoid direct rainfall.

2. The base station and remote sensor can both be wall mounted.

Warnings

- Do not subject the unit to excessive force, shock, dust, temperature or humidity.
- Do not immerse the unit in water.
- Do not remove any screws.
- Do not dispose this unit in a fire. IT MAY EXPLODE.
- Keep unit away from children. The unit or parts of the unit might be a choking hazard.
- Dispose of the unit legally and recycle when possible.

FCC STATEMENT OF COMPLIANCE

This device complies with Part 15 of the FCC rules. Operation is subject to the following two conditions:

- 1) This device may not cause harmful interference.
- 2) This device must accept any interference received, including interference that may cause undesired operation.

Warning: Changes or modifications to this unit not expressly approved by the party responsible for compliance could void the user's authority to operate the equipment.

NOTE: This equipment has been tested and found to comply with the limits for a Class B digital device, pursuant to Part 15 of the FCC rules. These limits are designed to provide reasonable protection against harmful interference in a residential installation. This equipment generates uses and can radiate radio

frequency energy and, if not installed and used in accordance with the instructions, may cause harmful interference to radio communications.

However, there is no guarantee that interference will not occur in a particular installation. If this equipment does cause harmful interference to radio or television reception, which can be determined by turning the equipment off and on, the user is encouraged to try to correct the interference by one of more of the following measures:

Reorient or relocate the receiving antenna.

Increase the separation between the equipment and the receiver.

Connect the equipment into an outlet on a circuit different from that to which the receiver is connected. Consult the dealer or an experienced radio/TV technician for help.

The device has been evaluated to meet general RF exposure requirement. The device can be used in portable exposure condition without restriction.