



R-270

Expert 2.4GHz Wireless Presenter User's Guide



Welcome

Thanks for choosing this laser presenter. It gives you remote control of your onscreen presentations with a range of up to 35 feet which is a perfect idea for a large conference room. This presenter supports the most common presentation tools including Page Up, Page Down, Start & Exit slideshow, Screen black. It also has a laser pointer that helps you focus in on your key messages. Just plug and play, no software is required. It allows you to control your presentation with one touch easily in the palm of your hand, and enjoy freedom of movement as you present.

Be sure to carefully read this User's Guide first for the proper use of this product and keep it for future reference.

©2012 All rights reserved.

IMPORTANT SAFETY AND HEALTH INFORMATION

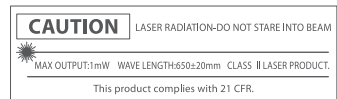

Package contents

- Wireless 2.4GHz Laser Presenter x 1
User's Manual x 1
Cable x 1
Warranty Card x 1

Minimum System Requirements

- Windows® 98SE / 2000 / ME / XP / Vista / 7 / 8 or Above, Mac OS X® v.10.4 (or later)
IBM or PC Compatible or Notebook with USB port

Product Features



Getting Started

STEP 1 Pull out the receiver



STEP 2 Connecting the Receiver

Connect the USB connector of the receiver into an available USB port of your computer.



STEP 3 Open the Powerpoint file and test the key functions

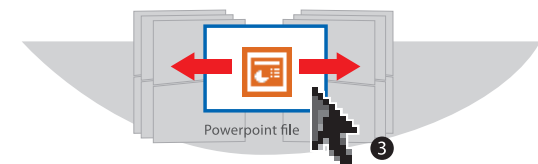

Trouble Shooting

Table with 3 columns: Question, Possible cause, How to resolve. Contains troubleshooting questions like 'Need to install software for first use of this product?' and 'Remote control malfunction'.

Note: When The receiver is plugged into the presenter, the power cutoff automatically.

P3

P4

P5

Switching Channels

Plug receiver to your PC USB port. Within the 20-second stand-by time, press ^ and v simultaneously 2 seconds until the red LED of Status indicating becomes blinking for 2 times, the ID link has been successfully done.

Resetted the receiver.



Care and Maintenance

- For cleaning, you are advised to use a soft, slightly moistened cloth.
Avoid using solvents or abrasive substances.
Do not open the presenter; for maintenance, consult qualified staff only.

Safety Notice

- This product complies with FCC and CE rules.
This product has no serviceable parts. Use of controls or adjustments of procedures other than the user guide may result in danger.

Specifications

Table with 2 columns: Specification (Frequency range, Remote range, Power, Output power, Size, Weight) and Value (2.4GHz, About 10 meters, Lithium Battery (300mAh), Under 5mW, 132 (L) x 32(w) x 28 (h) millimeters, 33g)

FCC Warning:

This equipment has been tested and found to comply with the limits for a Class B digital device, pursuant to part 15 of the FCC Rules. These limits are designed to provide reasonable protection against harmful interference in a residential installation.

- Reorient or relocate the receiving antenna.
Increase the separation between the equipment and receiver.
Connect the equipment into an outlet on a circuit different from that to which the receiver is connected.
Consult the dealer or an experienced radio/TV technician for help.

Caution: Any changes or modifications to this device not explicitly approved by manufacturer could void your authority to operate this equipment.

This device complies with part 15 of the FCC Rules. Operation is subject to the following two conditions:

- (1) This device may not cause harmful interference, and (2) this device must accept any interference received, including interference that may cause undesired operation.

The device has been evaluated to meet general RF exposure requirement. The device can be used in portable exposure condition without restriction.



E-SENSE Technology Co., Ltd.
8F., No. 10, Lane 366, Sec. 2, Zhongshan Rd., Zhonghe City
Taipei County 235, Taiwan
Tel: +886-2-22448868 ext. 55
Fax: +886-2-22448813
suctysai@e-sense.com.tw http://www.e-sensetech.com/