

Welcome

Thanks for choosing this Laser presenter. It gives you remote control of your onscreen presentations with a range of up to 35 feet which is a perfect idea for a large conference room. This presenter supports the most common presentation tools including Page Up, Page Down, Start & Exit slideshow, Screen black. It also has a laser pointer that helps you focus in on your key messages. Just plug and play, no software is required. It allows you to control your presentation with one touch easily in the palm of your hand, and enjoy freedom of movement as you present.

Be sure to carefully read this User's Guide first for the proper use of this product and keep it for future reference.

© 2012 All rights reserved.

IMPORTANT SAFETY AND HEALTH INFORMATION



Package contents

- Wireless 2.4GHz Laser Presenter x 1
- User's Manual x 1
- Cable x 1
- Warranty Card x 1

Minimum System Requirements

- Windows® 98SE / 2000 / ME / XP / Vista / 7 / 8 or Above, Mac OS X® v.10.4 (or later)
- IBM or PC Compatible or Notebook with USB port

Product Features



P 1-1

Getting Started

STEP 1 Pull out the receiver



STEP 2 Connecting the Receiver

Connect the USB connector of the receiver into an available USB port of your computer.



STEP 3 Open the Powerpoint file and test the key functions

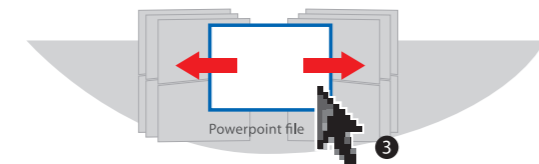

P 1-2

Switching Channels

Plug receiver to your PC USB port Within the 20-second stand-by time, press and simultaneously 2 seconds until the red LED of Status indicating becomes blinking for 2 times, the ID link has been successfully done.



Care and Maintenance

- For cleaning, you are advised to use a soft, slightly moistened cloth.
- Avoid using solvents or abrasive substances.
- Do not open the presenter; for maintenance, consult qualified staff only.

Safety Notice

1. This product complies with FCC and CE rules.
2. This product has no serviceable parts. Use of controls or adjustments of procedures other than the user guide may result in danger.

Specifications

Frequency range	2.4GHz
Remote range	About 30 meters
Power	AAA battery x 2
Output power	Under 5mW
Size	134 (L) x 34(w) x 27 (h) millimeters
Weight	40g

P 1-3

Hawk

R400

Wireless Presenter User's Guide



Hawk

E-SENSE Technology Co., Ltd.
8F., No. 10, Lane 366, Sec. 2 Zhongshan Rd., Zhonghe City
Taipei County 235, Taiwan
Tel: +886-2-22448868 ext. 55
Fax: +886-2-22448813
sucytsai@e-sense.com.tw <http://www.e-sensetech.com/>

FCC Statement

This device complies with part 15 of the FCC rules. Operation is subject to the following two conditions: (1) this device may not cause harmful interference, and (2) this device must accept any interference received, including interference that may cause undesired operation. Changes or modifications not expressly approved by the party responsible for compliance could void the user's authority to operate the equipment.

NOTE: This equipment has been tested and found to comply with the limits for a Class B digital device, pursuant to part 15 of the FCC Rules. These limits are designed to provide reasonable protection against harmful interference in a residential installation. This equipment generates uses and can radiate radio frequency energy and, if not installed and used in accordance with the instructions, may cause harmful interference to radio communications. However, there is no guarantee that interference will not occur in a particular installation. If this equipment does cause harmful interference to radio or television reception, which can be determined by turning the equipment off and on, the user is encouraged to try to correct the interference by one or more of the following measures:

- Reorient or relocate the receiving antenna.
- Reorient or relocate the receiving antenna.
- Reorient or relocate the receiving antenna.
- Consult the dealer or an experienced radio/TV technician for help important announcement