

LOGO

37" Wireless HD Sound Bar



User Guide

Location of Controls

- (Front of Speaker)**
- Auxiliary Input LED Indicator
 - Optical Input LED Indicator
 - Bluetooth LED Indicator
 - Infrared Receiver Panel
- (Side of Speaker)**
- [POWER] Button: (Quick Press) Power ON/OFF
 - [MODE] Button: (Quick Press) Change input mode
 - [◀] Button: (Quick Press) Skip to **previous** track (Long Press) **Decrease** volume
 - [⏸] Button: Play/pause media playback
 - [▶] Button: (Quick Press) Skip to **next** track (Long Press) **Increase** volume
 - Optical Input Port
 - 3.5mm Auxiliary Input Jack
 - DC=14V Power Jack

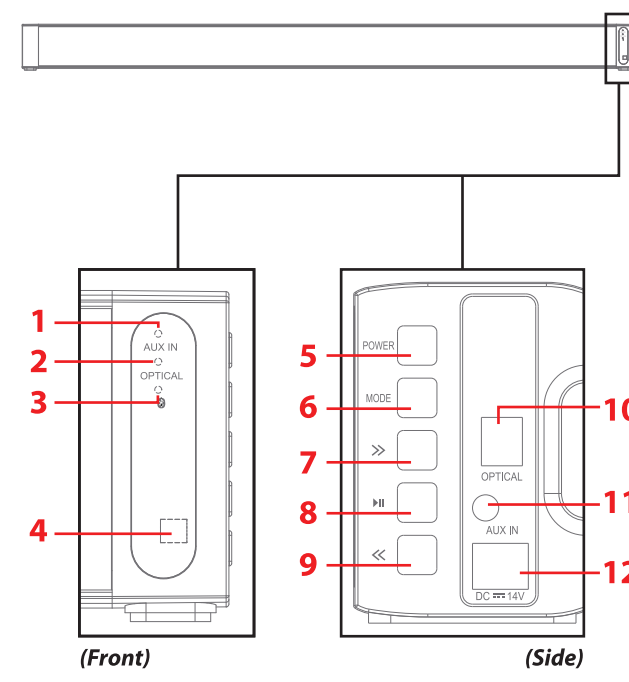

Setting Up the Speaker

In the Box

- SBT2017 Wireless Sound Bar
- DC=14V Power Adapter
- Remote Control
- 3.5mm Auxiliary Cable
- RCA - 3.5mm Auxiliary Cable
- Mounting Screw (x2)
- User Manual

Powering the Sound Bar

Attach the pin of the supplied power adapter to the DC=14V power jack on the sound bar. Plug the adapter into a wall outlet.

Mounting the Speaker

1. Measure a width of **25.1968** inches on the wall and mark the position of where the sound bar will catch the screws on the wall with a pencil.



2. Drill the mounting screws directly into the pencil-marked locations. Allow the screws to protrude approximately 0.3 inches from the wall so you can easily hook the sound bar onto them.
3. Place and slide the sound bar onto the mounting screws. Carefully make sure it is firm and stable.

Replacing the Remote Control Battery

To replace or install the battery, push and slide the battery door out from the remote control. Replace the battery with a new CR2025 battery with the positive (+) polarity facing up.

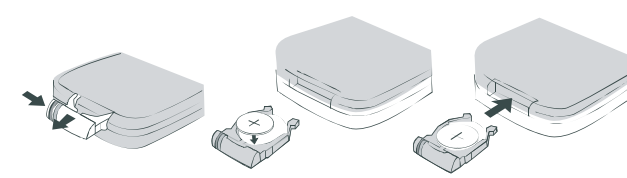

NOTE: When using for the first time, gently pull the protection tab extending out of the remote control's battery door.

Using the Speaker

Pairing the Speaker

1. Power the sound bar ON and quick press the [MODE] button to switch to Bluetooth input. The Bluetooth LED indicator will **quickly flash BLUE**.
2. Set your mobile device to search for Bluetooth devices. XXXXXX from the list of found devices.
3. After a successful pairing, a tone will be heard and the Bluetooth LED indicator will **slowly flash BLUE**.

i If a previously paired device is in range when the speaker is turned on, the speaker will connect to it automatically.

Powering ON/OFF

- Quick press the [POWER] button on the side of the sound bar to turn ON/OFF.
- Press the [⏻] button to put the sound bar in standby mode.

Adjusting Volume

- Long press the [◀] and [▶] buttons on the side of the sound bar to adjust volume or use the [–] and [+] buttons on the remote control.
- Press the [⏸] button on the remote control to mute/unmute volume.

Changing Modes

The sound bar can switch between auxiliary, optical, and Bluetooth inputs. Once the sound bar is paired and connected to a media-playing device, quick press the [MODE] button to switch between inputs.

Playing Music

To enjoy music wirelessly on your sound bar, make sure that the sound bar is properly paired to your mobile device. If you are pairing the device for the first time, please consult the **Pairing the Speaker** section of this user manual.

To use the LINE or Optical Inputs, please see the **Using the Inputs** section of this user manual.

Playing/Pausing Music

- Press the [⏸] button on the side of the sound bar or on the remote control to play/pause media playback.

Skipping Tracks

- Quick press the [▶] button on the speaker or the [▶] button on the remote control to skip to the next track.
- Quick press the [◀] button on the speaker or the [◀] button on the remote control to skip to the previous track.

Using the Remote Control

The remote control allows full control of music playback and volume adjustment.

- [⏻] Button: Enter/leave standby
- [MODE] Button: Change input mode
- [⏸] Button: Mute/unmute volume
- [◀] Button: Skip to previous track
- [⏸] Button: Play/pause music
- [▶] Button: Skip to next track
- [RESET] Button: Reset to factory settings
- [–] / [+] Buttons: Adjust volume

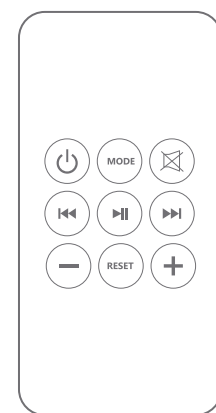

NOTE: If the speaker is not responding to the remote's button presses, the batteries may need to be changed. See the **Replacing the Remote Control Battery** section, earlier in this user manual.

Please consult the **Replacing the Remote Control Battery** section of this user manual for further info on setting up the remote control.

NOTE: When using the remote control, for best results point directly at the infrared receiver panel on the front corner of the sound bar.

Using the Inputs

3.5mm Auxiliary Input

To use the 3.5mm auxiliary input, insert the 3.5mm connector of either of the supplied audio cables (3.5mm auxiliary cable or the RCA - 3.5mm auxiliary cable) into the 3.5mm auxiliary input jack on the side of the sound bar.

Insert the other connector(s) of the audio cable into the Press the [MODE] button to switch to the auxiliary input. The auxiliary input LED indicator will turn **GREEN**.

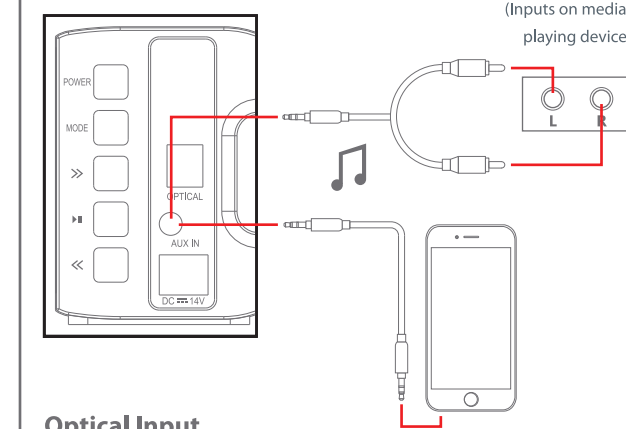

Optical Input

To use the optical input, plug one connector of an optical cable (not included) into the Optical Input Port, then plug the other connector into the Optical Port on your media-playing device.

The optical input LED indicator will turn **RED** while in use.

Legal Information

READ CAREFULLY AND KEEP THIS MANUAL

Note: This equipment has been tested and found to comply with the limits for a Class B digital device, pursuant to part 15 of the FCC Rules. These limits are designed to provide reasonable protection against harmful interference in a residential installation. This equipment generates, uses and can radiate radio frequency energy and, if not installed and used in accordance with the instructions, may cause harmful interference to radio communications. However, there is no guarantee that interference will not occur in a particular installation. If this equipment does cause harmful interference to radio or television reception, which can be determined by turning the equipment off and on, the user is encouraged to try to correct the interference by one or more of the following measures:

- Reorient or relocate the receiving antenna.
- Increase the separation between the equipment and receiver.
- Connect the equipment into an outlet on a circuit different from that to which the receiver is connected.
- Consult the dealer or an experienced radio/TV technician for help.

Caution: Any changes or modifications not expressly approved could void the user's authority to operate the equipment.

This device complies with Part 15 of the FCC Rules. Operation is subject to the following two conditions:

- (1) This device may not cause harmful interference, and
- (2) this device must accept any interference received, including interference that may cause undesired operation.

The device has been evaluated to meet general RF exposure requirement.

Rain/Moisture Warning

- Do not expose the unit to extreme temperatures (heat or cold), open flames, humid conditions, or wet conditions.
- Do not submerge in water.
- Do not open this product or attempt to repair the unit yourself should it not be working.

Limited Warranty

Warranty Service Not Provided

This warranty does not cover damage resulting from accident, misuse, abuse, improper installation or operation, lack of reasonable care, and unauthorized modification. This warranty is voided in the event any unauthorized person opens, alters or repairs this product. All products being returned to the authorized service center for repair must be suitably packaged.

Limitation of Warranty

THE WARRANTY STATED ABOVE IS THE ONLY WARRANTY APPLICABLE TO THIS PRODUCT. ALL OTHER WARRANTIES, EXPRESS OR IMPLIED (INCLUDING ALL IMPLIED WARRANTIES OF MERCHANTABILITY OR FITNESS FOR A PARTICULAR PURPOSE) ARE HEREBY DISCLAIMED. NO VERBAL OR WRITTEN INFORMATION GIVEN BY AIT, INC., ITS AGENTS, OR EMPLOYEES SHALL CREATE A WARRANTY OR IN ANY WAY INCREASE THE SCOPE OF THIS WARRANTY.

REPAIR OR REPLACEMENT AS PROVIDED UNDER THIS WARRANTY IS THE EXCLUSIVE REMEDY OF THE CONSUMER. AIT, INC. SHALL NOT BE LIABLE FOR INCIDENTAL OR CONSEQUENTIAL DAMAGES RESULTING FROM THE USE OF THIS PRODUCT OR ARISING OUT OF ANY BREACH OF ANY EXPRESS OR IMPLIED WARRANTY ON THIS PRODUCT. THIS DISCLAIMER OF WARRANTIES AND LIMITED WARRANTY ARE GOVERNED BY THE LAWS OF THE STATE OF NEW YORK. EXCEPT TO THE EXTENT PROHIBITED BY APPLICABLE LAW, ANY IMPLIED WARRANTY OF MERCHANTABILITY OR FITNESS FOR A PARTICULAR PURPOSE ON THIS PRODUCT IS LIMITED TO THE APPLICABLE WARRANTY PERIOD SET FORTH ABOVE.

Some states do not allow the exclusion nor limitation of incidental or consequential damages, or limitations on how long an implied warranty lasts so the above limitations on exclusions may not apply to you. This warranty gives you specific legal rights, and you also may have other rights that vary from state to state.