

PBT3011 User Manual

Polaroid Tower Speaker User Manual

Bluetooth

Questions? **1-877-788-6461** (Toll Free) Monday - Friday 8AM - 10PM (EST) www.southernatalecom.com Click on "Product Support"

Let's Get Started

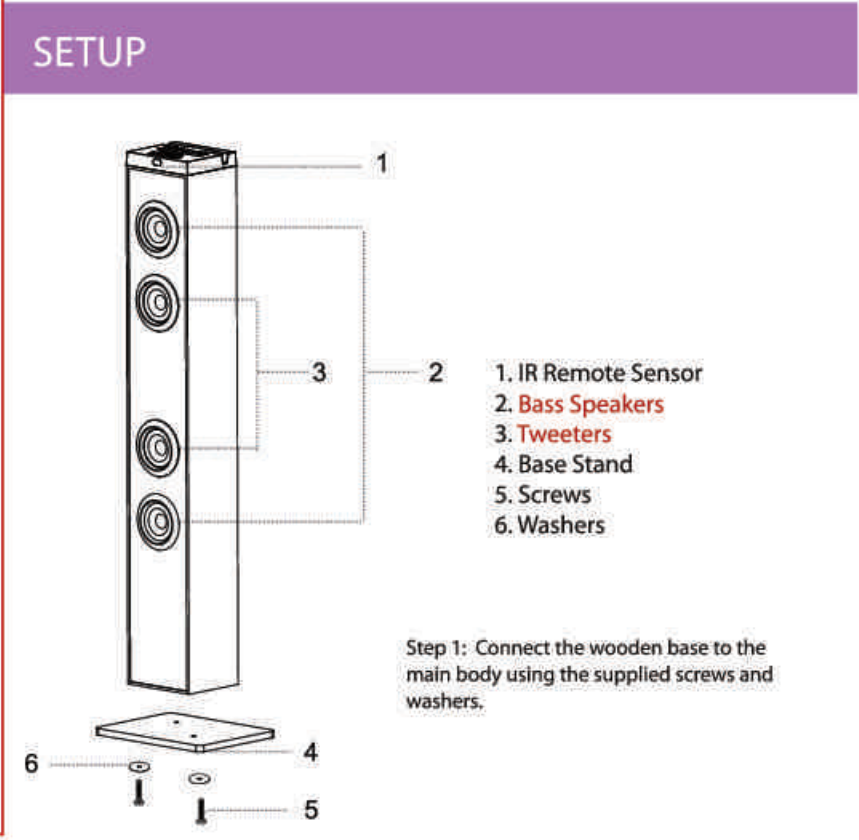
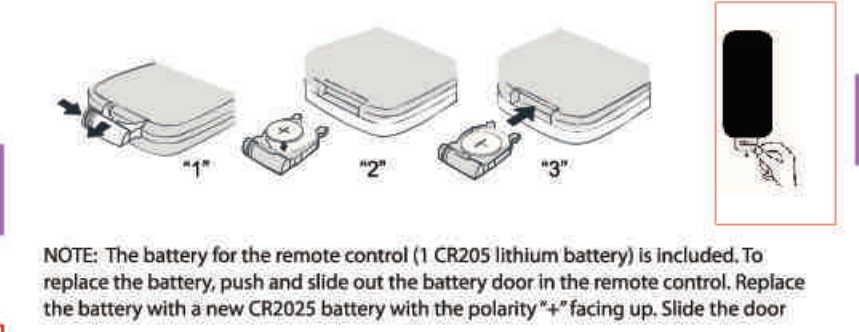
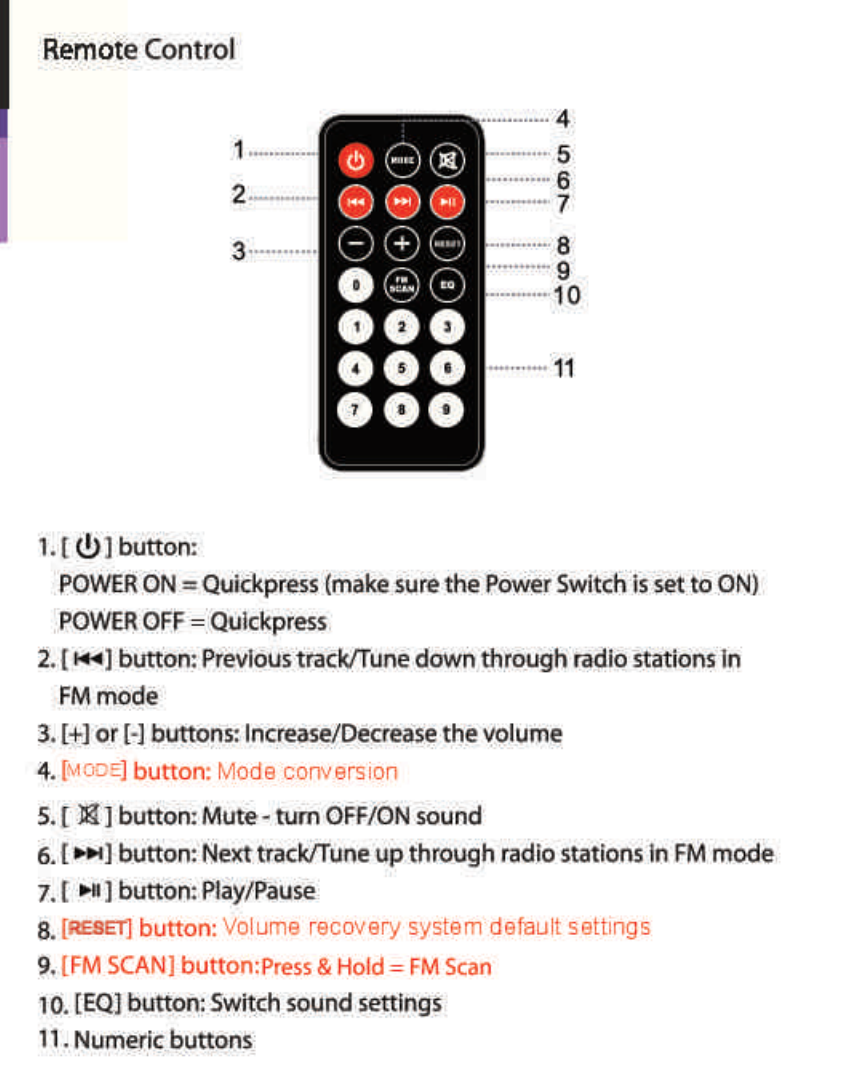
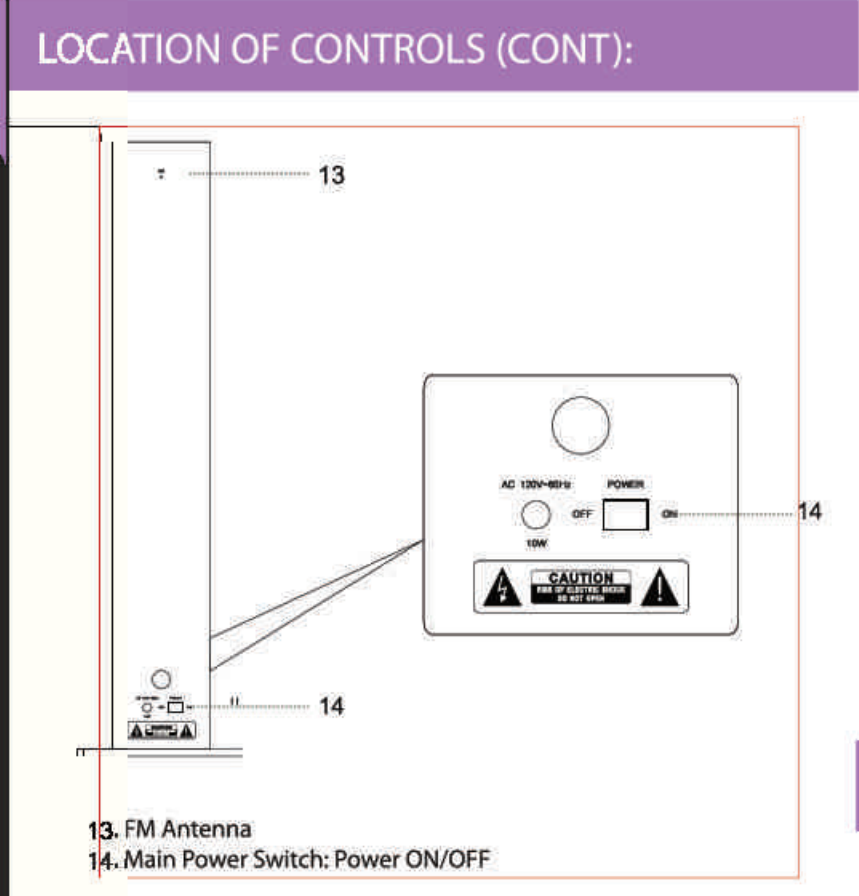
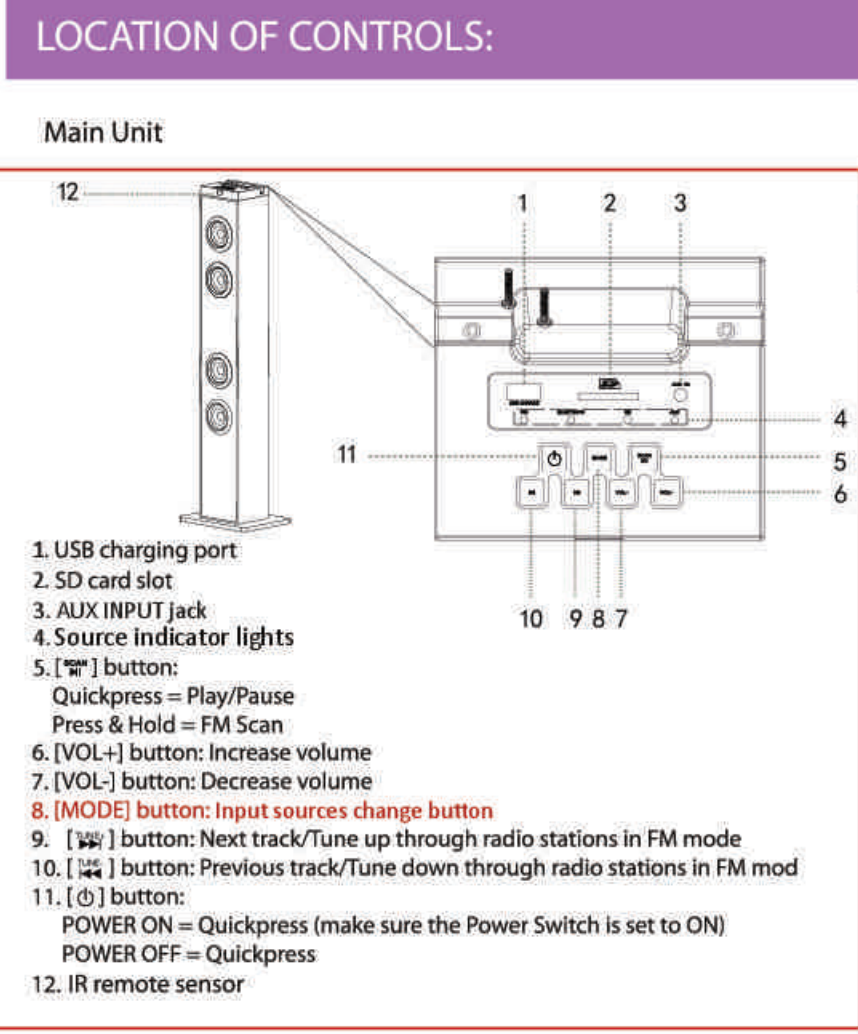
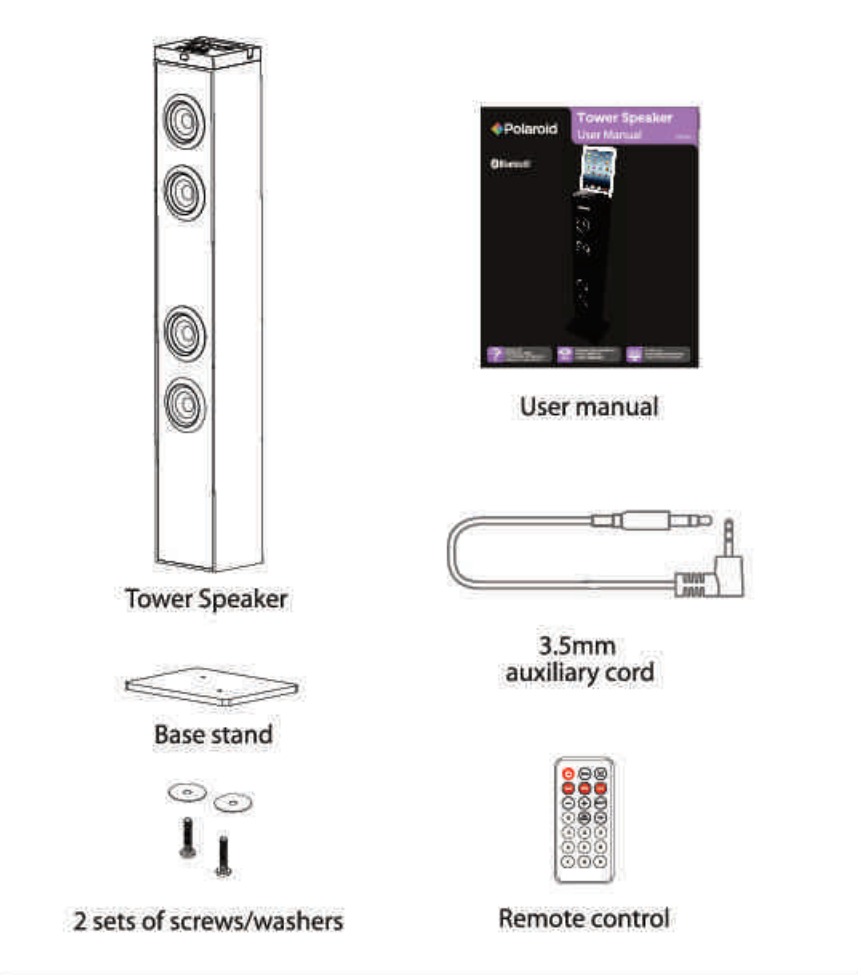

- ### BASIC OPERATION:
1. Flip Main Power Switch on the rear of the unit to the ON position.
 2. Press the [P] button to turn ON the unit. A source indicator will light up GREEN when the unit is ON; the light will go out when the unit is OFF.
 3. Press the [MODE] button on the speaker or the [MODE] button on the remote control repeatedly to switch the playback source. The Source indicator will light up GREEN accordingly.
 4. Press the [VOL+]/[VOL-] buttons on the speaker or the [+]/[-] buttons on the remote control to adjust volume level.
 5. Press the [EQ] button to set EQ mode as desired.
 6. Press the [X] button on the remote control to turn off the sound. Press it again to turn the sound back on.

- ### RADIO OPERATION:
1. Press the [P] button to turn ON the unit.
 2. Press the [MODE] button on the speaker or the remote control repeatedly until the FM indicator turns GREEN.
 3. Press the [FWD] or [REV] button on the speaker or the remote control to tune down/up through radio stations.
 4. To scan to the next available station, press and hold the [FWD] or [REV] button for one full second and release.
 5. Press the [FM SCAN] button on the remote control to search all available stations. Press it again to stop on a station.
 6. To store preset radio stations in FM Mode:
 - a. Tune to the station you want to save.
 - b. Press and hold a numeric button for 3 seconds on the remote control to store the station.
 - c. Numbers between 1 and 9 may be used. For example, if you press and hold "1" then you will have programmed "Station 1".

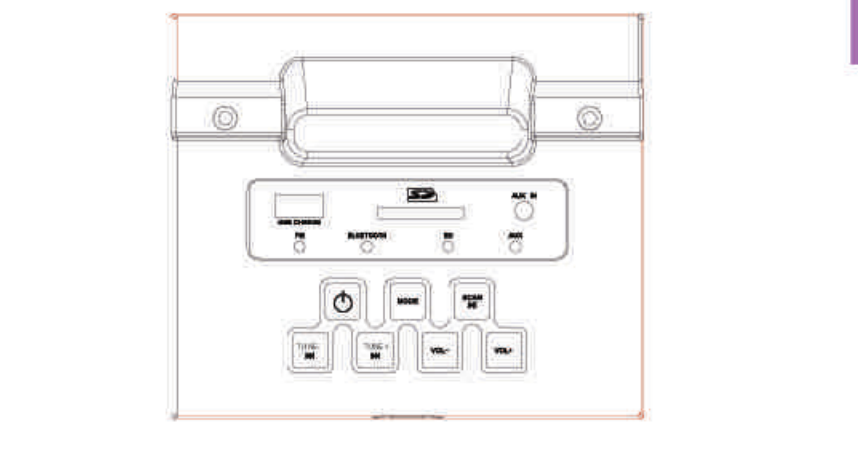

- ### AUXILIARY PLAYBACK:
1. Plug one end of the included 3.5 mm Auxiliary cord to the headphone jack on your device.
 2. Plug the other end of the 3.5 mm Auxiliary cord into the AUX jack on the top of the speaker.
 3. Press the [P] button to turn ON the unit.
 4. Press the [MODE] button on the speaker or the [MODE] button on the remote control repeatedly until the AUX indicator turns GREEN.
 5. Use your device's audio controls for music playback.
- NOTE: You cannot use the speaker controls for audio playback while the device is plugged into the AUX jack.

- ### USB Charging:
1. There is a USB charger on the top of the unit that can charge iPhones, iPods and iPads or any device that charges using a standard USB cord.
 2. USB cable is not included, use your device's charging cable.
 3. Make sure the speaker is powered ON to charge devices.

- ### USB / SD CARD PLAYBACK:
1. Insert an SD card (not included) into the SD card slot on the speaker to play MP3 music files.
 2. Press the [P] button to turn ON the unit. And you insert an SD card into the SD card slot, then press the [MODE] button on the speaker or the remote control repeatedly until the SD indicator light turns GREEN. IMPORTANT: Tracks will play in the order in which they are listed on the playlist on your SD card. Music placed in folders cannot be accessed. Therefore your music needs to be assembled in one complete list-not in folders.
 3. Press the [P] button to pause the music. Press the [P] button again to resume play.
 4. Press the [FWD] button to skip forward to the next track and the [REV] button to skip backward to the previous track.
 5. Use numeric buttons to select your desired track. For example, pressing "2" + "0" + "9" means track 209.

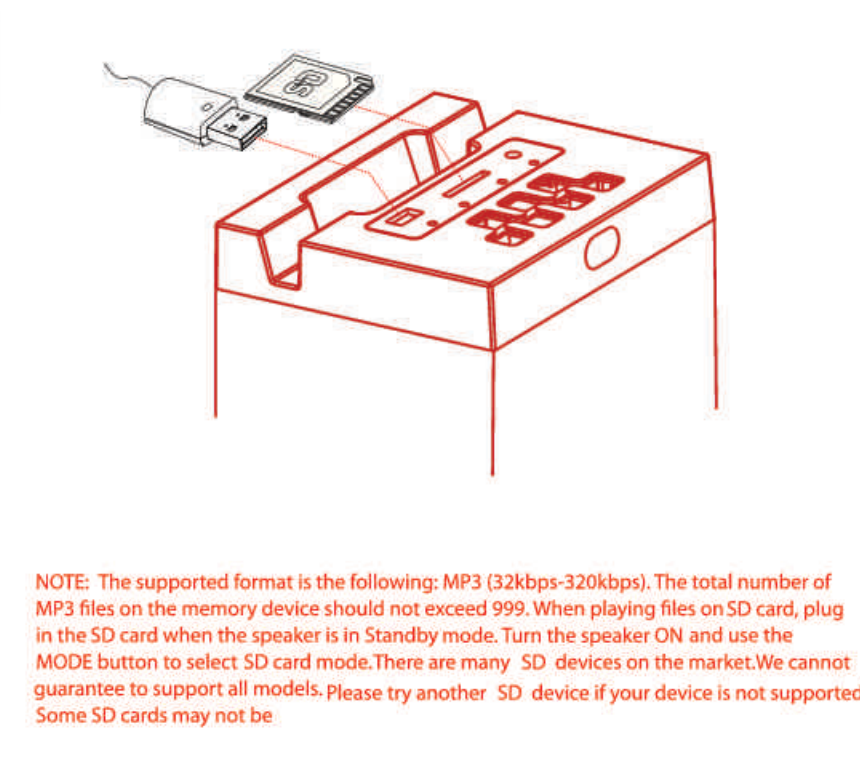

- ### BLUETOOTH PAIRING & LINKING OPERATION:
1. Keep your Tower Speaker and Bluetooth enabled device within 3 feet of each other during the pairing process.
 2. Press and hold the [P] button to turn ON the unit.
 3. Press the [MODE] button on the speaker or the [MODE] button on the remote control repeatedly until the Bluetooth indicator flashes GREEN. The Bluetooth indicator will remain GREEN when pairing is successful.
- NOTE: Flashing Green: Pairing Mode
Solid Green: You are connected to the Bluetooth device. If you would like to use a new Bluetooth device with the speaker, you must unpair the speaker from your device using your device's Bluetooth menu. If you power off the speaker when it is unpaired, the next time you turn the speaker on the Bluetooth indicator will flash Green which means it is in pairing mode.

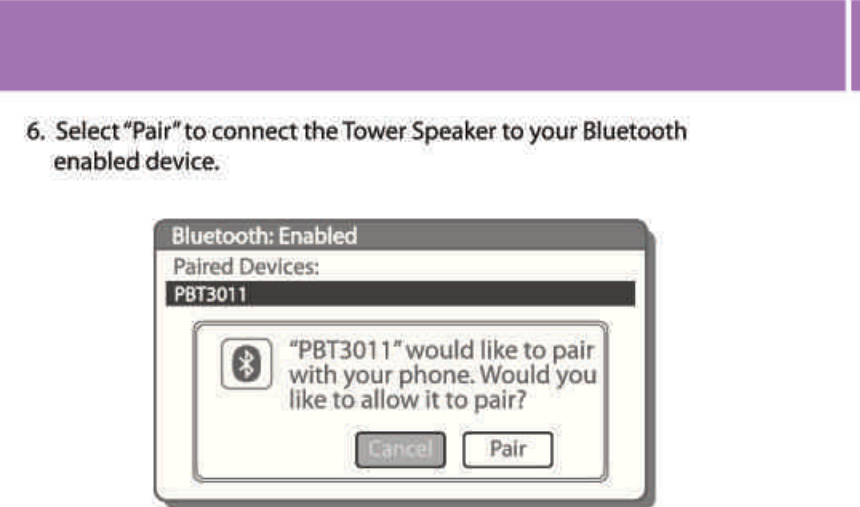
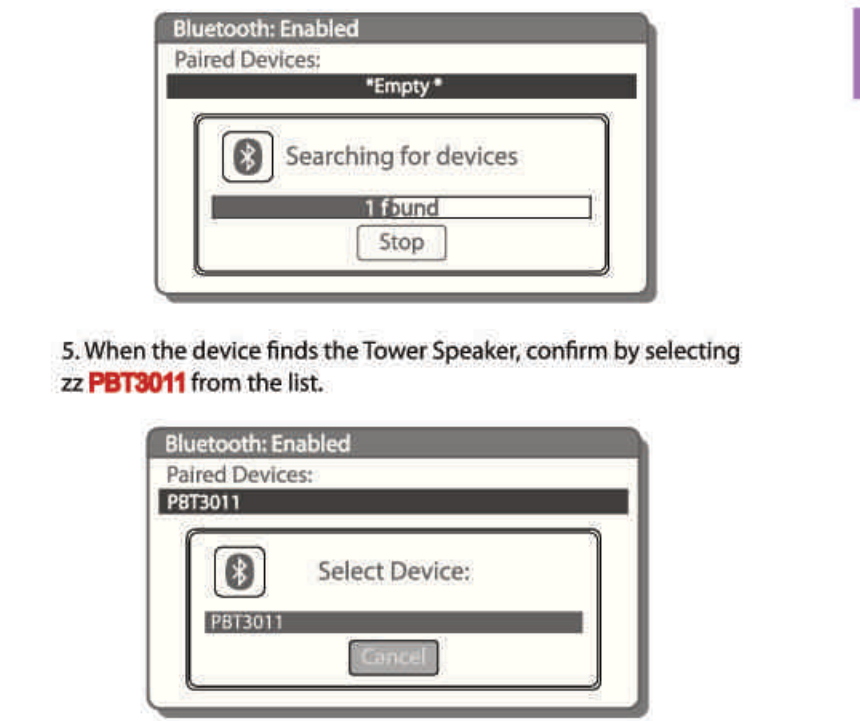
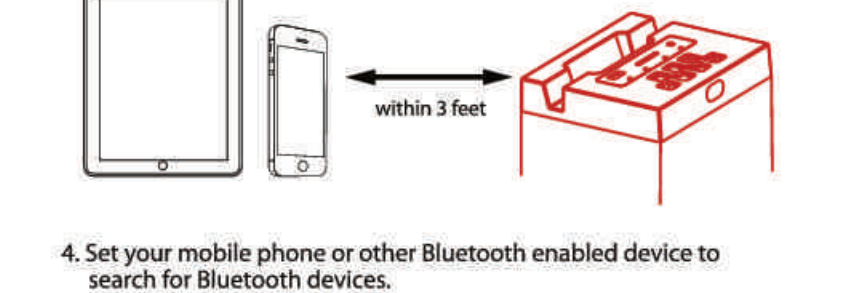

Depending on which device you are trying to connect the speaker to, it may be necessary to enter a passcode and the following message (or similar) may appear on your device's display:

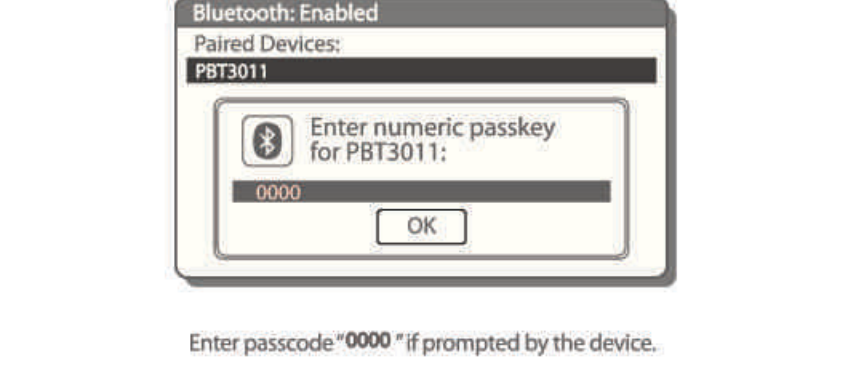

7. Your Bluetooth enabled device will confirm that the pairing was completed, and prompt you to accept the connection. Please respond YES to connect the Tower Speaker to your Bluetooth enabled device.

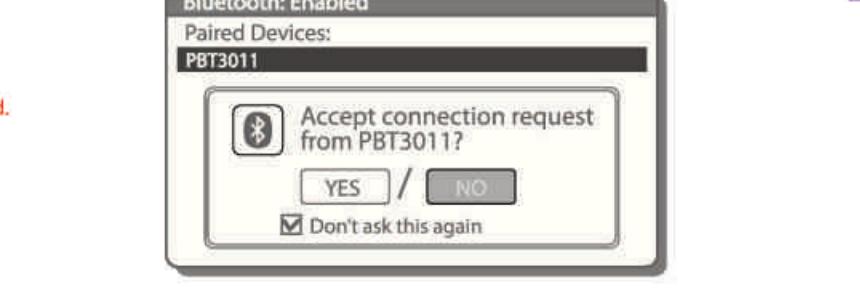

8. When attempting to reconnect the Tower Speaker to your Bluetooth enabled device, you may see the message below, and your Bluetooth device will prompt you to accept the connection request to the PBT3011 speaker, and an option not to ask this again. Please accept the connection, and if you select "Don't ask this again", your Bluetooth device will automatically accept future connection requests from your Tower Speaker.

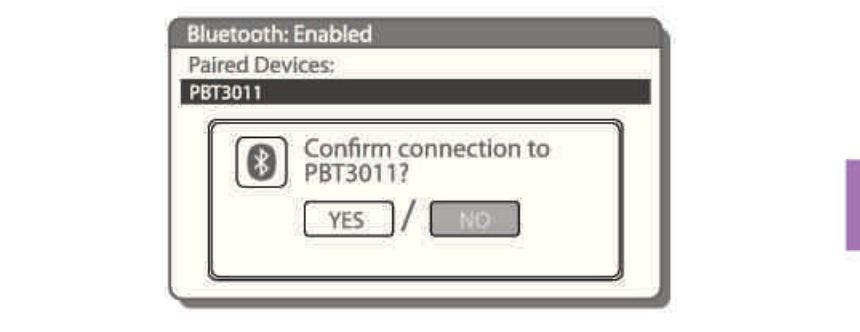

The screenshots above are typical of many Bluetooth enabled devices in the market today, and are used to assist in the explanation of the pairing process. Your Bluetooth enabled device's interface and interaction with the Tower Speaker may slightly differ from the illustrations above.

- ### PLAY MUSIC FROM BLUETOOTH DEVICES:
- Make sure the Bluetooth connection between the speaker and the Bluetooth enabled device is active. (see Bluetooth pairing & linking operation)
1. Press the [P] button to pause the music. Press the [P] button again to resume play.
 2. Press the [FWD] button to skip forward to the next track and the [REV] button to skip backward to the previous track.
 3. Press the [VOL+]/[VOL-] buttons on the speaker or the [+]/[-] buttons on the remote control to adjust volume level.
-
- within 3 feet

TROUBLESHOOTING:

No sound is coming from the Tower Speaker.

- The volume level may be too low. Try increasing the volume by pressing the [VOL+] button on the speaker or the [+] button on the remote control.
- The connected device might not be in playback mode. Play music from the connected Bluetooth device.
- The sound output of the connected device is weak. Increase the volume of the connected Bluetooth device.

The volume level for the Tower Speaker is too high.

- Try reducing the volume level by pressing the [VOL-] button on the speaker or the [-] button on the remote control.
- The sound output of the connected device might be too high. Try reducing the volume of the connected Bluetooth device.

The Bluetooth reception is not working.

- Make sure no other devices are connected to the Tower Speaker and try the connection again. If a device was connected to the speaker, unpair it before connecting your new device. Do this using your Bluetooth device's Bluetooth menu.

NOTE: Use of this unit near fluorescent lighting may cause interference regarding use of the remote. If the unit is displaying erratic behavior, move it away from any fluorescent lighting, as that may be the cause.

LEGAL INFORMATION

FCC Part 15: This device complies with Part 15 of the FCC Rules. Operation is subject to the following two conditions:
 (1) this device may not cause harmful interference, and
 (2) this device must accept any interference received, including interference that may cause undesired operation.

Warning: Changes or modifications to this equipment not expressly approved by the party responsible for compliance could void the user's authority to operate the equipment.

NOTE: This equipment has been tested and found to comply with the requirements for a Class B digital device under Part 15 of the Federal Communications Commission (FCC) rules. These requirements are intended to provide reasonable protection against harmful interference in a residential installation. This equipment generates, uses and can radiate radio frequency energy and, if not installed and used in accordance with the instructions, may cause harmful interference to radio communications.

However, there is no guarantee that interference will not occur in a particular installation. If this equipment does cause harmful interference to radio or television reception, which can be determined by turning the equipment off and on, the user is encouraged to try to correct the interference by one or more of the following measures:
 - Reorient or relocate the receiving antenna.
 - Increase the separation between the equipment and receiver.
 - Connect the equipment into an outlet on a circuit different from that to which the receiver is connected.
 - Consult the dealer or an experienced radio/TV technician for help.

Do not attempt to repair or modify this equipment.
 Shielded USB cables must be used with this unit to ensure compliance with the Class B FCC limits.
 If your electronic device has internal memory on which personal or other confidential data may be stored, you may want to perform a data sanitization process before you dispose of your device to assure another party cannot access your personal data. Data sanitization varies by the type of product and its software, and you may want to research the best sanitization process for your device before disposal. You may also check with your local recycling facility to determine their data sanitization procedures during the recycling process.

LIMITED WARRANTY

This product as supplied and distributed new by AIT, Inc. ("AIT") to the original consumer purchaser is warranted by AIT against defects in material and workmanship for a period of one year from your date of purchase ("Warranty"). In the unlikely event that this product is defective, or does not perform properly, you may within one year from your original date of purchase return it to the authorized service center for repair or exchange.

TO OBTAIN WARRANTY SERVICE:

- Provide proof of the date of purchase within the package (Dated bill of sale).
- Prepay all shipping costs to the authorized service center, and remember to insure your return.
- Include a return shipping address (no P.O. Boxes), a telephone contact number, and the defective unit within the package.
- Describe the defect or reason you are returning the product.

Your product will be repaired or replaced, at our option, for the same or similar model of equal value if examination by the service center determines this product is defective. Products received damaged as a result of shipping, will require you to file a claim with the carrier.

The shipping address of the authorized service center is:

AIT, Inc.
 ATTN: Customer Service (2nd Floor)
 14-C 33rd Street
 Brooklyn, NY 11232

IN NO EVENT WILL AIT, ITS MANUFACTURERS, DISTRIBUTORS OR PLR IP HOLDINGS, LLC BE LIABLE FOR ANY INCIDENTAL, DIRECT, INDIRECT, SPECIAL, PUNITIVE OR CONSEQUENTIAL DAMAGES (SUCH AS, BUT NOT LIMITED TO, DAMAGES FOR LOSS OF PROFITS, BUSINESS, SAVINGS, DATA OR RECORDS) RELATED TO THIS PRODUCT, EXCEPT AS STATED HEREIN. NO OTHER WARRANTIES SHALL APPLY.

Should you have any questions or problems concerning this product, please contact our customer service department at:

Customer Support:
 1-877-788-6461 (Toll Free)
 Monday - Friday 8AM - 10PM (EST)
www.southernatalecom.com
 Click on "Product Support"