

BUTTONS AND INDICATORS

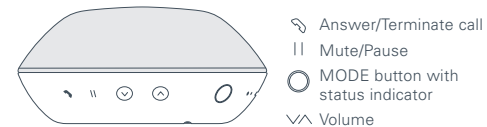

- Answer/Terminate call
- Mute/Pause
- MODE button with status indicator
- Volume

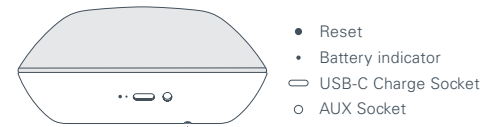

- Reset
- Battery indicator
- USB-C Charge Socket
- AUX Socket

Link button with integrated indicator

BATTERY CHARGE

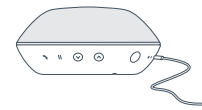

To charge, plug USB-C cable in USB power adapter or computer and connect to your speaker. Light indicator shows the charging progress.

- Above 80%
- Between 15 and 80%
- Between 5 and 15%
- Below 5%

*Please note that power adapter is not included with the product. When not charging and battery level is below 5%, the battery indicator will light up.

CONNECTING WITH *BLUETOOTH*

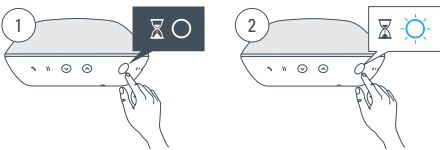

To turn Reykjavik on, press and hold the MODE button until status indicator turns solid WHITE.

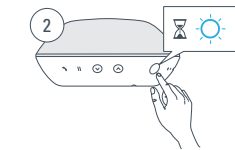

Press and hold the MODE button until status indicator flashes BLUE.

* To turn off, press and hold the MODE button until the status indicator flashes WHITE. Then release.

CONNECTING WITH *BLUETOOTH*

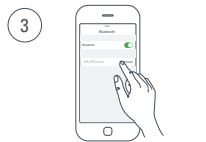

Enable *Bluetooth* pairing on your device and select VIFA_REYxxxxxx as your *Bluetooth* device.



The status indicator turns solid BLUE when a connection is established.

*During music streaming, press the Mute/Pause button to play/pause music.

WIRED CONNECTION

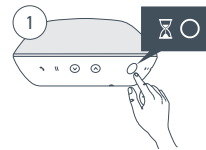

To turn Reykjavik on, press and hold the MODE button until status indicator turns solid WHITE.

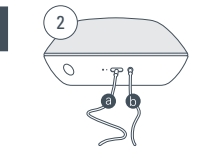

Connect the wire, (a) USB-C or (b) AUX) and start music playback from your device.

*During music streaming, press the Mute/Pause button to play/pause music.

WIRED CONNECTION



The status indicator turns solid GREEN when wired playback is enabled.

*During music streaming, press the Mute/Pause button to Mute/Unmute music.

SPEAKER PHONE

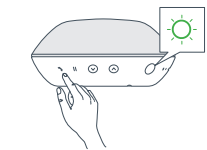

Receive incoming call
The status indicator flashes GREEN. Short press the Answer/Terminate call button.

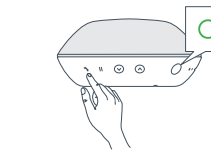

Terminate a call
Short press the Answer/Terminate call button again.

SPEAKER PHONE

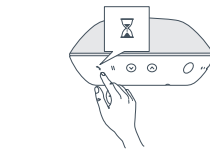

Reject incoming call
Long press the Answer/Terminate call button.

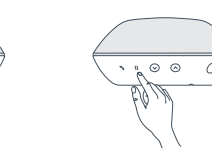

Mute a call
During a call, short press the Mute/Pause button to mute or unmute the microphone. The status indicator flashes WHITE when muted.

IN THE BOX



1x Reykjavik



USB-C cable
Safety instructions
and warranty
Quick guide

LINK TWO REYKJAVIK SPEAKERS

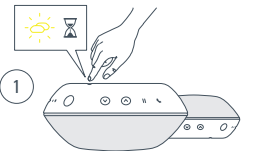

Make sure the two Reykjavik speakers are turned ON.

Press and hold Link button on one speaker (bottom) until Link indicator flashes YELLOW.

Repeat on the second speaker.

LINK TWO REYKJAVIK SPEAKERS



When both speakers are linked, their Link indicators become solid YELLOW, showing they are linked as stereo speakers.

REGISTER AND TRADEMARKS



The *Bluetooth*® word mark and logos are registered trademarks owned by Bluetooth SIG, Inc., and any use of such marks by Vifa Denmark A/S is under license.

SPECIFICATIONS

Description	Portable wireless loudspeaker
Technical features	Bluetooth® Wireless Technology AUX 3.5 mm mini jack USB playback Lithium Ion battery DSP crossover, optimized for low distortion and high precision 3 channel digital amplifier LINK two speakers Speaker phone (Incl noise/echo cancelling)
Inputs	<i>Bluetooth</i> AUX 3.5 mm mini-jack USB-C

SPECIFICATIONS

Tweeter	2 X 19 mm Vifa drive units with coated fabric dome and neodymium magnet
Woofer	70 mm Vifa drive unit with aluminum cone and neodymium magnet
Frequency response	62 Hz – 20 kHz @ +/- 3 dB
Input voltage	USB, 5V.
Sleep mode	After 3 minutes without signal
Automatic off	After 30 minutes without signal
Battery, internal	Lithium-Ion 19Wh
Height/Diameter	65mm/139 mm
Net weight	0.5 kg
Grilles	Custom made Kvadrat textile, anodized aluminum

SUPPORT



Support
If you experience issues that are not described in this quick-guide, please refer to vifa.dk/support for more information



Register your Reykjavik
We encourage you to register your speaker at vifa.dk/support

2017 03 Rev.1.8

vifa

REYKJAVIK

Quick guide

IMPORTANT SAFETY INSTRUCTIONS

Regulatory Safety Information

- 1: Read these instructions.
- 2: Keep these instructions.
- 3: Heed all warnings.
- 4: Follow all instructions.
- 5: Do not use this apparatus near water.
- 6: Clean only with dry cloth.
- 7: Do not block any ventilation openings. Install in accordance with the manufacturer's instructions.
- 8: Do not install near any heat sources such as radiators, heat registers, stoves, or other apparatus (including amplifiers) that produce heat.
- 9: Do not defeat the safety purpose of the polarized or grounding-type plug. A polarized plug has two blades

with one wider than the other. A grounding type plug has two blades and a third grounding prong. The wide blade or the third prong are provided for your safety. If the provided plug does not fit into your outlet consult an electrician for replacement of the obsolete outlet.

- 10: Protect the power cord from being wal-ked on or pinched particularly at plugs convenience receptacles and the point where they exit from the apparatus.
- 11: Only use attachments /accessories specified by the manufacturer.
- 12:  Use only with the cart, stand, tripod, bracket or table specified by the manufacturer or sold with the apparatus. When a cart is used, use caution when moving the cart/apparatus combination to avoid injury from tip-over.
- 13: Unplug this apparatus during lightning storms or when unused for long periods of time.

- 14: Refer all servicing to qualified service personnel. Servicing is required when the apparatus has been damaged in any way, such as power-supply cord or plug is damaged, liquid has been spilled or objects have fallen into the apparatus, the apparatus has been exposed to rain or moisture, does not operate normally or has been dropped.
- 15: To completely disconnect unit power from the AC mains, disconnect the unit's power cord from the mains socket.
- 16: Important! This equipment is not intended to be used on soft support (like beddings. Blankets etc.)
- 17: The socket-outlet shall be easily accessible.
- 18: Disposal of a battery into fire or a hot oven, or mechanically crushing or cutting of a battery can result in an explosion
- 19: High or low extreme temperatures that a battery can

be subjected to during use is 10°C - 45°C, storage -20°C - 40°C or transportation 10°C - 45°C; and low air pressure is 86-106Kpa at 2000m. high altitude

- 20: Leaving a battery in an extremely high temperature surrounding environment that can result in an explosion or the leakage of flammable liquid or gas.
- 21: Battery subjected to extremely low air pressure that may result in an explosion or the leakage of flammable liquid or gas.
- 22: Product label affixed to the bottom of the product.
- 23: **CAUTION:** Danger of explosion if battery is incorrectly replaced. Replace only with the same or equivalent type.
- 24: **WARNING:** The Battery(battery pack or batteries installed) shall not be exposed to excessive heat such as sunshine, fire or the like.

- 25: **WARNING:** The main plug shall remain readily operable

- 26: Keep minimum distances 1cm around the apparatus for sufficient ventilation

- 27: The ventilation should not be impeded by covering the ventilation openings with items, such as newspapers, table-cloths, curtains, etc.

- 28: Attention should be drawn to the environmental aspects of battery disposal.

- 29: The use of apparatus in tropical and/or moderate climates.

- 30: Risk of explosion if the battery is replaced by an incorrect type.

WARNING:

- To reduce the risk of fire and electric shock do not expose this apparatus to rain or moisture.
- Do not place objects filled with liquids such as vases on the apparatus.
- Do not open apparatus. There are no user-serviceable parts inside. Risk of electric shock inside.
- The apparatus shall not be exposed to dripping or splashing.
- No naked flame sources, such as lighted candles, such as lighted candles, should be placed on the apparatus



The lightning flash and arrow head within the triangle is a warning sign alerting you of dangerous voltage inside the product



The exclamation point within the triangle is a warning sign alerting you of important instructions accompanying the product.

vifa

IMPORTANT SAFETY INSTRUCTIONS

English



LIMITED WARRANTY

English

IMPORTANT SAFETY INSTRUCTIONS

VIFA LIMITED WARRANTY

This warranty applies for products (each a "Product") made by Vifa Denmark A/S ("Vifa"). Vifa warrants ("Limited Warranty") that the Product is free of defects in materials and workmanship at the time of its original purchase from an authorized reseller by the end-user (the "Customer" or "you").

WHAT IS COVERED BY THIS WARRANTY

All defects in material and workmanship. This Limited Warranty covers the functionality of the Product for its normal, intended use in an environment as specified in the Owner's Manual only and does not cover malfunctions that result from improper or unreasonable use or maintenance, e.g. accident, excess moisture, improper packing, lightning, power surges, or unauthorized tampering, alteration or modification not authorized by Vifa.

This Limited Warranty is limited to the repair or replacement of the Product at Vifa's decision, and neither costs for transportation, removal, nor installation of a Product is covered by this Limited Warranty.

FOR HOW LONG

Unless otherwise explicitly stated in documents provided in connection with the purchase, the guarantee period is 24 months / 2 year. The guarantee period starts when the product(s) is delivered to the customer, and ceases to be valid 24 months after this delivery date. However, the guarantee period ceased immediately if the product is repaired or moderated by persons/companies that are not authorized by Vifa, or if the serial number has for whatever reason been removed from the product.

WHAT VIFA WILL DO

If Vifa receives, during the applicable warranty period, a valid notice of a defect in any product which is covered by Vifa's warranty, Vifa will, at Vifa's option, within a reasonable time after being notified of the defect (a) repair the defect at no charge, using new or refurbished replacement parts, (b) replace the product or (c) refund the purchase price of the product. Response times may vary from country to country and is among other things subject to availability of parts and transport. All replaced faulty parts and components will become the property of Vifa. Vifa shall have no obligation to repair, replace or refund until the customer returns the defective product to the authorized

reseller. Any replacement product may be either new or like-new, provided that it has functionalities at least equal to that of the product being replaced. Repairs outside the Limited Warranty period or of damages not covered by this guarantee will take place only with your prior approval.

HOW TO OBTAIN SERVICE

In the event of a Product defect, you should take the following actions:

1. Refer to the Owner's Manual in order to identify and possibly correct the problem.
2. If the problem cannot be resolved by reference to the Owner's Manual, please contact the authorized reseller where the Product was originally purchased to discuss your concerns.
3. If necessary, the authorized reseller will arrange for repair or replacement of the Product provided that you present the original sales invoice to document the date and place of the original purchase. The terms and conditions for a repair or replacement are subject to terms of delivery agreed between you and the authorized reseller to the extent the terms are not explicitly covered by this Limited Warranty.

If you ship the Product, neither Vifa nor the authorized reseller is liable for damages to the Product caused during shipment. Thus, we always recommend that you use the original shipping cartons for packing the Product.

OTHER RIGHTS

This Limited Warranty does not affect your mandatory rights. This Limited Warranty provides you with specific rights subject to specified conditions. You may also have other mandatory legal rights depending on in which country the Product was originally purchased. This Limited Warranty does not affect such legal rights and does not preclude any legal remedy you may have under the law.

LIMITATIONS OF WARRANTY AND LIABILITY

The maximum liability of Vifa shall not exceed the purchase price originally paid by you for the product. Vifa shall be liable for no more than the direct damages for bodily injury, and/or real or personal property arising from the gross negligence of Vifa. Further, Vifa shall not be liable for special, incidental, consequential or indirect damages. And, the guarantee period ceased immediately if the product is repaired or moderated by persons/companies that are not authorized by Vifa, or if the serial number has for whatever reason been removed from the product or defaced.

www.vifa.dk/support

IMPORTANT STATEMENTS

This device complies with Part 15 of the FCC Rules. Its operation is subject to the following two conditions:

1. This device may not cause harmful interference, and
2. This device must accept any interference received, including interference that may cause undesired operation.

Cet appareil est conforme à la section 15 des réglementations de la FCC. Le fonctionnement de l'appareil est sujet aux deux conditions suivantes:

1. Cet appareil ne doit pas provoquer d'interférences néfastes, et 2. Cet appareil doit tolérer les interférences reçues, y compris celles qui risquent de provoquer un fonctionnement indésirable.

Note: This product has been tested and found to comply with the limits for a Class B digital device, pursuant to Part 15 of the FCC Rules. These limits are designed to provide reasonable protection against harmful interference in a residential installation. This product generates, uses, and can radiate radio frequency energy and, if not installed and used in accordance with the instructions, may cause harmful interference to radio communications. However, there is no guarantee that interference will not occur in a particular installation. If this

product does cause harmful interference to radio or television reception, which can be determined by turning the equipment off and on, the user is encouraged to try to correct the interference by one or more of the following measures:

- Reorient or relocate the receiving antenna.
- Increase the separation between the equipment and receiver.
- Connect the equipment into an outlet on a circuit different from that to which the receiver is connected.
- Consult the dealer or an experienced radio/TV technician for help.

Changes or modifications not expressly approved by the party responsible for compliance could void the user's authority to operate the equipment.

This device complies with Industry Canada licence-exempt RSS standard(s).

Operation is subject to the following two conditions:

1. This device may not cause interference, and
2. This device must accept any interference, including interference that may cause undesired operation of the device.

Le présent appareil est conforme aux CNR d'Industrie Canada applicables aux appareils radio exempts de licence. L'exploitation est autorisée aux deux conditions suivantes :

1. l'appareil ne doit pas produire de brouillage, et
2. l'utilisateur de l'appareil doit accepter tout brouillage radioélectrique subi, même si le brouillage est susceptible d'en compromettre le fonctionnement.

FCC/IC Radiation Exposure Statement
This equipment complies with FCC/IC RSS-102 radiation exposure limits set forth for an uncontrolled environment. This equipment should be installed and operated with minimum distance 20 cm between the radiator & your body.

Déclaration de la FCC et d'IC sur l'exposition aux radiations
Cet appareil est conforme à la norme RSS102 de la FCC/IC relative aux limites d'exposition aux radiations dans un environnement non contrôlé. Vous devez installer et utiliser cet appareil en respectant une distance minimale de 20 cm entre votre corps et l'élément rayonnant.

Vifa Denmark A/S
Mariendalsvej 2A
DK - 8800 Viborg
vifa.dk