

vifa

**HELSINKI**  
*owner's manual*

# IMPORTANT SAFETY INSTRUCTIONS

## Regulatory Safety Information

- 1 Read these instructions.
- 2 Keep these instructions.
- 3 Heed all warnings.
- 4 Follow all instructions.
- 5 Do not use this apparatus near water.
- 6 Clean only with dry cloth.
- 7 Do not block any ventilation openings. Install in accordance with the manufacturer's instructions.
- 8 Do not install near any heat sources such as radiators, heat registers, stoves, or other apparatus (including amplifiers) that produce heat.
- 9 Do not defeat the safety purpose of the polarized or grounding-type plug. A polarized plug has two blades with one wider than the other. A grounding type plug has two blades and a third grounding prong. The wide blade or the third prong are provided for your safety. If the provided plug does not fit into your outlet consult an electrician for replacement of the obsolete outlet.
- 10 Make sure the power cord is not stepped on or otherwise interfered with, particularly at the mains socket and where it exits the apparatus.
- 11 Only use attachments/accessories specified by the manufacturer.
- 12 Unplug this apparatus during lightning storms or when unused for long periods of time.
- 13 Refer all servicing to qualified service personnel. Servicing is required when the apparatus has been damaged in any way, such as damage to the power cord or plug, liquid has been spilled or objects have fallen into the apparatus, the apparatus has been exposed to rain or moisture, does not operate normally or has been dropped.
- 15 To completely disconnect unit power from the AC mains, disconnect the unit's power cord from the mains socket.

### WARNING:

- To reduce the risk of fire and electric shock do not expose this apparatus to rain or moisture.
- Do not place objects filled with liquids such as vases on the apparatus.
- Do not open the apparatus. There are no user-serviceable parts inside. Risk of electric shock inside.



The lightning flash and arrow head within the triangle is a warning sign alerting you of dangerous voltage inside the product.



The exclamation point within the triangle is a warning sign alerting you to important instructions accompanying the product.



Use only with the cart, stand, tripod, bracket or table specified by the manufacturer or sold with the apparatus. When a cart is used, use caution when moving the cart/apparatus combination to avoid injury from tip-over.

# IMPORTANT STATEMENTS:

This device complies with Part 15 of the FCC Rules. Its operation is subject to the following two conditions:

1. This device may not cause harmful interference, and
2. This device must accept any interference received, including interference that may cause undesired operation.

Cet appareil est conforme à la section 15 des réglementations de la FCC. Le fonctionnement de l'appareil est sujet aux deux conditions suivantes:

1. Cet appareil ne doit pas provoquer d'interférences néfastes, et
2. Cet appareil doit tolérer les interférences reçues, y compris celles qui risquent de provoquer un fonctionnement indésirable.

Note: This product has been tested and found to comply with the limits for a Class B digital device, pursuant to Part 15 of the FCC Rules. These limits are designed to provide reasonable protection against harmful interference in a residential installation. This product generates, uses, and can radiate radio frequency energy and, if not installed and used in accordance with the instructions, may cause harmful interference to radio communications.

However, there is no guarantee that interference will not occur in a particular installation. If this product does cause harmful interference to radio or television reception, which can be determined by turning the equipment off and on, the user is encouraged to try to correct the interference by one or more of the following measures:

- Reorient or relocate the receiving antenna.
- Increase the separation between the equipment and receiver.
- Connect the equipment into an outlet on a circuit different from that to which the receiver is connected.
- Consult the dealer or an experienced radio/TV technician for help.

Changes or modifications not expressly approved by the party responsible for compliance could void the user's authority to operate the equipment.

This device complies with Industry Canada licence-exempt RSS standard(s).

Operation is subject to the following two conditions:

1. This device may not cause interference, and
2. This device must accept any interference, including interference that may cause undesired operation of the device.

Le présent appareil est conforme aux CNR d'Industrie Canada applicables aux appareils radioexempts de licence. L'exploitation est autorisée aux deux conditions suivantes :

1. l'appareil ne doit pas produire de brouillage, et
2. l'utilisateur de l'appareil doit accepter tout brouillage radioélectrique subi, même si le brouillage est susceptible d'en compromettre le fonctionnement.



Vifa Denmark A/S  
Mariendalsvej 2A  
DK-8800 - Denmark  
[www.vifa.dk](http://www.vifa.dk)

## *You've chosen well*

The Vifa Helsinki. A loudspeaker for anyone who values exclusive Nordic design and authentic sound.

It's designed to be intuitive for you to use. This manual just spells out the details - for instance, how to connect wirelessly in a flash.

Enjoy!

Product care .....	6
--------------------	---

## **Connecting to Helsinki**

Connecting with <i>Bluetooth</i> .....	8
Connecting with <i>Bluetooth</i> - NFC .....	9
Wired connection .....	10

## **Product functions**

Buttons and indicators on Helsinki .....	12
Status indicator .....	13
Battery charge .....	14
Reset and set to factory default .....	15
Vifa app .....	16
Troubleshooting .....	17
Specifications .....	18
Register and Trademarks .....	19

For manuals in other languages, please visit: [www.vifa.dk/support](http://www.vifa.dk/support)

## PRODUCT CARE

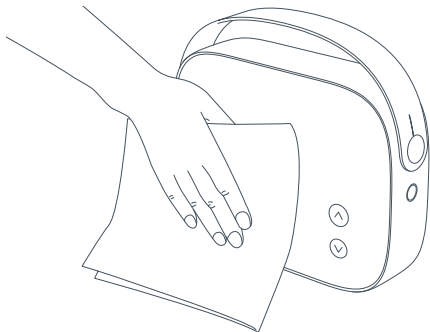

Helsinki is built for a long-lasting relationship. In order to ensure the quality music performance please ensure no exposure to rain, moisture, high humidity or sources of heat that may damage the product. The intended use is within a temperature range of 5 - 40 °C (40 - 105 °F).

### CLEANING

Your Vifa product is covered by beautiful highly durable textile from Kvadrat. Remove non-greasy stains by carefully dabbing with a cloth or use a lint roller to remove lint from the textile.



**Never use a vacuum cleaner, this can cause damage to the loudspeaker units behind the textile.**

CONNECTING  
TO  
HELSINKI

## CONNECTING WITH *BLUETOOTH*

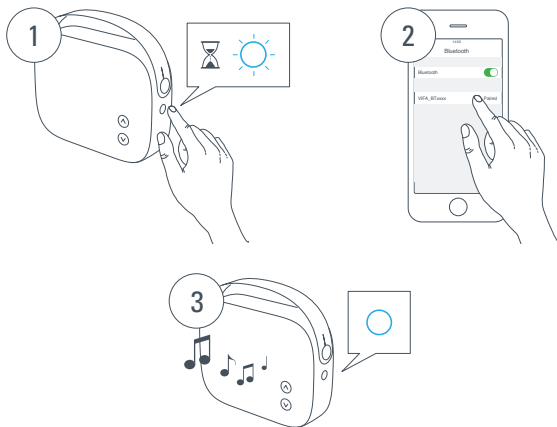

1. Press and hold POWER button until status indicator flashes blue.
2. Enable *Bluetooth* pairing on your device and select Vifa BTxxxxxx as your *Bluetooth* device.
3. Let the music play, the status indicator turns BLUE when Helsinki receives the music.



## CONNECTION WITH *BLUETOOTH* - NFC

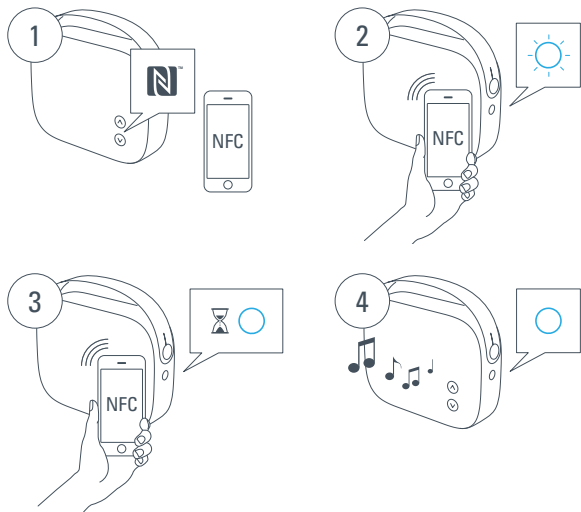

1. The NFC area of Helsinki is placed by the volume buttons.
2. Place NFC enabled device on NFC area. Pairing has started when status indicator flashes blue.
3. Hold and wait until the blue light becomes constant. Phone will perhaps provide sound feedback.
4. Status indicator will be blue when connection is made.

## WIRED CONNECTION

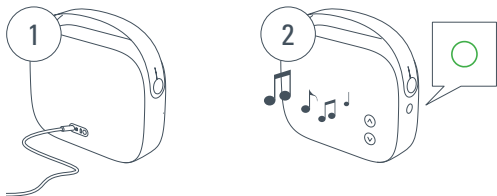

1. When Helsinki is ON connect the wire on the back side and start music playback from device.
2. The status indicator turns green when wired playback is enabled.

### **NB**

Helsinki prefers *Bluetooth* over AUX. But briefly pressing the mode button the connection will switch from *Bluetooth* to AUX. Pressing it again turns it back to the latest *Bluetooth* connected device.

# PRODUCT FUNCTIONS

## BUTTONS AND INDICATORS ON HELSINKI

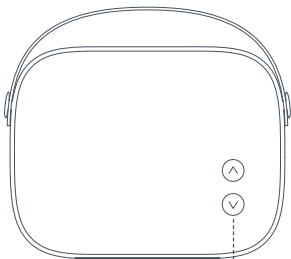

Volume up  
Volume down  
NFC area



Mode  
Status indicator

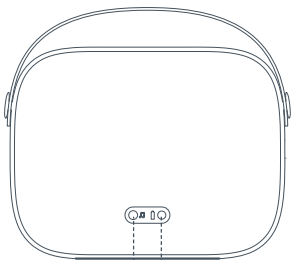

Power socket, battery  
Aux optical and analog input  
Micro USB and Reset hidden on bottom

*You can change the light intensity of the status indicator using the Vifa app.*

# STATUS INDICATOR

## **Helsinki is in SLEEP mode**





When Helsinki is asleep it breaths, meaning the status indicator will pulsate. It goes to sleep after 3 minutes with no use (no button press, no inputs).

To wake up Helsinki press the mode button briefly until the status indicator shows red signal.

## **Helsinki is OFF**

To wake up Helsinki press and hold the mode button until the status indicator lights up.

## **Helsinki is ON**

-  WHITE: No connections active
-  BLUE: *Bluetooth* connection
-  GREEN: AUX connection
-  RED: Fault indications
-  Yellow: Upgrade indications

To power down Helsinki press and hold the mode button until the status indicator flashes white. The device then turns OFF.

## BATTERY CHARGE



A full charge will take 3-4 hours. Please charge Helsinki for more than 4 hours the first time you charge it. Keep Helsinki plugged in when near power outlet. The intelligent power management will keep battery in perfect condition. When charging you can see the progress



Low:  
Battery level below 5% RED



Medium:  
Battery level between 5 and 80% YELLOW



Full:  
Battery level above 80% GREEN

# RESET AND SET TO FACTORY DEFAULT

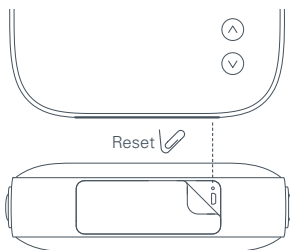

## RESET

- MAY BE USED IF HELSINKI FREEZES

To reset Helsinki, briefly press the reset button (hidden on the bottom) - no user settings will be lost.

## FACTORY DEFAULT

- RESETS HELSINKI'S SOFTWARE TO FACTORY SETTINGS

To factory default Helsinki: press and hold the mode button and the volume up and volume down buttons simultaneously until the status indicator turns red.

Release the buttons and Helsinki will go to factory default – after factory default ALL USER SETTINGS WILL BE LOST.

To firmware update Helsinki, please go to [www.Vifa.dk/support](http://www.Vifa.dk/support) for further information.

# TROUBLESHOOTING

For further support, if you experience issues that are not described in this manual please refer to:

**[www.vifa.dk/support](http://www.vifa.dk/support)**



# THE VIFA APP

An app will be available for your Vifa Helsinki.  
More info will be announced on:

**[www.vifa.dk/support](http://www.vifa.dk/support)**

# SPECIFICATIONS

Description	Portable wireless loudspeaker
Technical features	<i>Bluetooth</i> 4.0 aptX AUX 3.5 mm mini-jack NFC Lithium Ion battery Force Balanced Woofers DSP crossover, optimized for low distortion and high precision 4 channel digital PurePath amplifier
Drive units	
Full-range	2m X 50 mm Vifa driver unit with aluminum cone and neodymium magnet
Woofer	2 X 60 mm Vifa drive units with flat sandwich cone and neodymium magnet. Mounted mechanically back to back in a force balanced configuration supported by 2 passive radiators
Frequency response	58 Hz – 18 kHz @ +/- 3 dB
Input voltage, wall adaptor	100 Volt - 240 Volt 50/60 Hz 600mA Max
Input voltage, loudspeaker	12VDC, 1800mA
Standby power consumption	Less than 0.5 watt when battery is fully charged.
Inputs	<i>Bluetooth</i> aptX AUX 3.5 mm mini-jack.
Dimensions Height/Width/Depth	156 mm / 210 mm / 70 mm
Net weight	1.4 kg
Frame	One piece diecast aluminium
Enclosure	ABS reinforced
Grilles	Custom made Kvadrat textile

# REGISTER AND TRADEMARKS



We encourage you to register your product at:  
[www.vifa.dk/register](http://www.vifa.dk/register)

A Vifa product is in compliance with **CE** directives of relevance, including RoHS directive – see product label for more regional regulatory approvals.

---

Made for

 iPod  iPhone  iPad

Made for iPhone 5s, iPhone 5c, iPhone 5, iPhone 4s, iPhone 4, iPhone 3GS, iPhone 3, iPad AIR, iPad (3rd and 4th generation), iPad 2, iPad, iPad mini with Retina display, iPad mini, iPod touch (1st through 5th generation), iPod classic, and iPod nano (1st through 7th generation).

“Made for iPod”, “Made for iPhone” and “Made for iPad” mean that an electronic accessory has been designed to connect specifically to iPod, iPhone, or iPad, respectively, and has been certified by the developer to meet Apple performance standards. Apple is not responsible for the operation of this device or its compliance with safety and regulatory standards. Please note that the use of this accessory with iPod, iPhone, or iPad may affect wireless performance.



The NFC Forum has developed the “N-mark” trademark as a universal symbol for Near field communication.



The *Bluetooth* logo, the *Bluetooth* name and the combination are trademarks owned by *Bluetooth* SIG Inc.



© 2013 CSR pic and its group companies. The aptX® mark and the aptX logo are trade marks of CSR pic or one of its group companies and may be registered in one or more jurisdictions.

For more information please visit our website at  
[www.vifa.dk](http://www.vifa.dk)