

Size: 105.3 x 140.3mm, Insturciton manual will be 80g glossy coated art paper , with CMYK printing, 折页

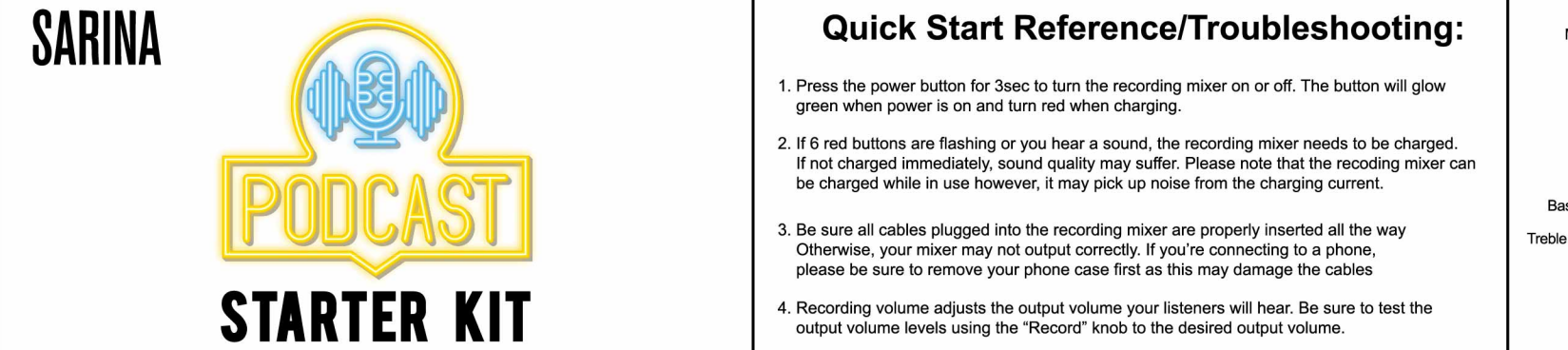

User Manual

Quick Start Reference/Troubleshooting:

- Press the power button for 3sec to turn the recording mixer on or off. The button will glow green when power is on and turn red when charging.
- If 6 red buttons are flashing or you hear a sound, the recording mixer needs to be charged. If not charged immediately, sound quality may suffer. Please note that the recording mixer can be charged while in use however, it may pick up noise from the charging current.
- Be sure all cables plugged into the recording mixer are properly inserted all the way. Otherwise, your mixer may not output correctly. If you're connecting to a phone, please be sure to remove your phone case first as this may damage the cables.
- Recording volume adjusts the output volume your listeners will hear. Be sure to test the output volume levels using the "Record" knob to the desired output volume.
- When using a single mobile phone to broadcast, music volume and external backtrack volume is adjusted using the phone volume. The recording mixer volume controls the microphone. When listening to the live broadcast, we recommended testing on a separate mobile phone/computer away from the microphone. A feedback loop may occur if the output and input are in the same area.
- When using a computer to record, test your microphone and sound mixer output before beginning to record. When connecting your sound mixer for the first time, your computer will download the correct device drivers automatically. Your computer may need a restart to complete the installation. If you hear small sounds from your microphone, increase the microphone output on your computer's volume control panel. We do not recommend using speakers while recording, as your microphone may pick up the sound. We recommend headphones or earphones for the best results.
- Before each broadcast. We recommend you test all the mixer features to ensure they are working. This way your recording can go on without issues.
- Connect the Bluetooth accompaniment: turn on the Bluetooth of the mobile phone, search the device to find "SA-PODC", and click the connection. After the connection is successful, the power button indicator light of the sound card will be blue, indicating that the Bluetooth is connected.
- The included LCD display shows your volume and echo effect on a scale of 1-15. When you turn the MIC, Microphone volumes will scale; When turn the Reverb, the echo effect scale.

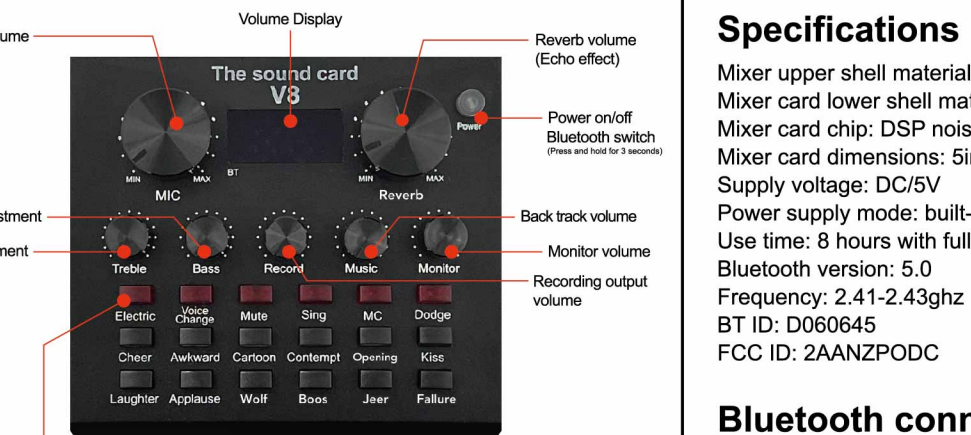

Red Button Functions:
 Electric: Electronic Music Key Changer: press to change the electronic tone to A#B B C#F D#F# G#F. Press and hold to exit.
 Voice Change: press to change to female voice, male voice, magic sound, baby sound, original sound.
 Mute: press to cut the vocal out of the song you are playing.
 Sing: tuned for the best Karaoke sound output.
 MC: tuned for MC performance.
 Dodge: automatically lower the background music when there is vocal input.

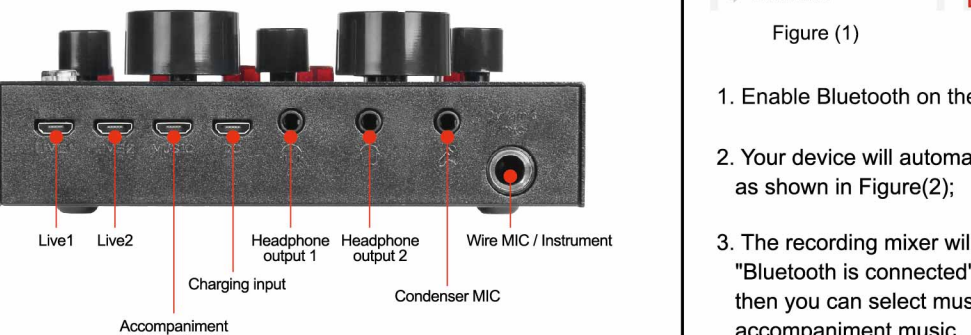

Specifications

Mixer upper shell material: Metal knob, metal frosted body
 Mixer card lower shell material: ABS plastic
 Mixer card chip: DSP noise reduction chip
 Mixer card dimensions: 5in x 4.1in x 1.06in (127x106x27mm)
 Supply voltage: DC/5V
 Power supply mode: built-in 18650/3.7V/1200MAH lithium battery
 Use time: 8 hours with full power
 Bluetooth version: 5.0
 Frequency: 2.41-2.43ghz
 BT ID: D060645
 FCC ID: 2AANZPODC

Bluetooth connection

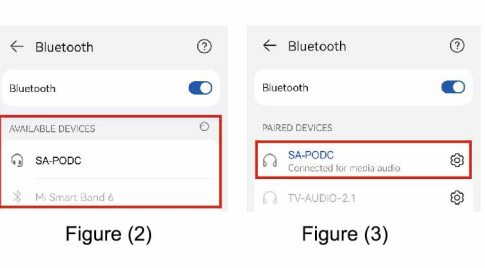

- Enable Bluetooth on the device of your choice, as shown in Figure(1);
- Your device will automatically detect the available equipment around, as shown in Figure(2);
- The recording mixer will appear as "SA-PODC" click to start pairing. "Bluetooth is connected" will play if the pairing is successful then you can select music sent to the sound card via Bluetooth as accompaniment music.

Setting up the Mixer:

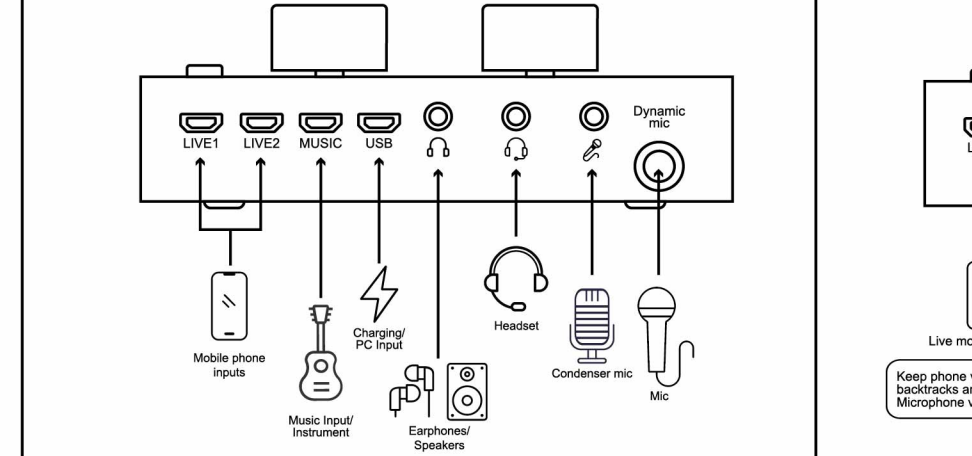

1. Dual mobile phone live connection:

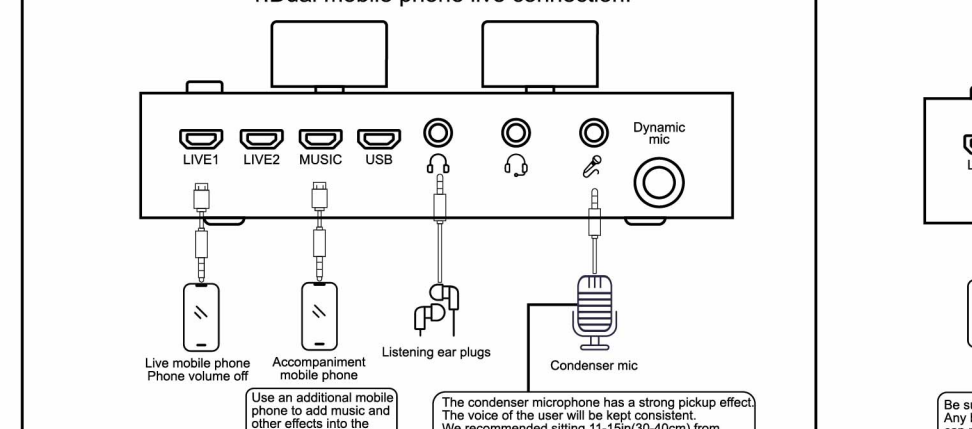

2. Single mobile phone live connection:

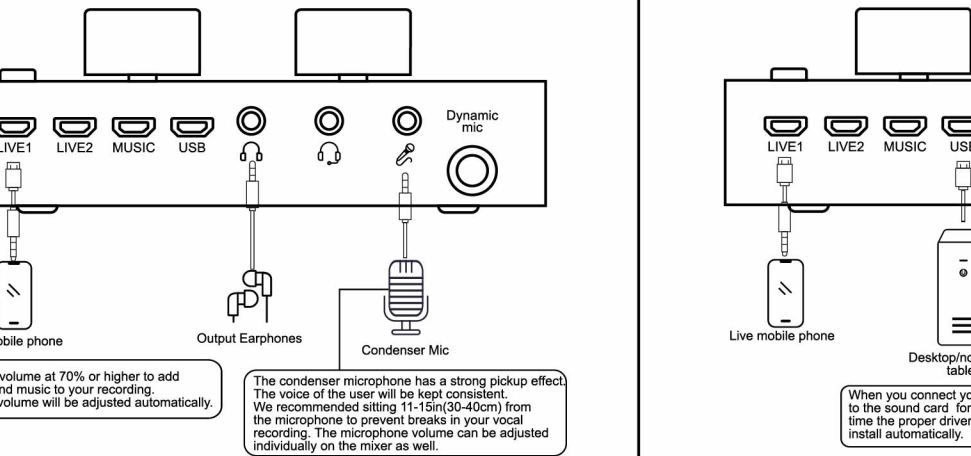

3. Three mobile phone connection method:

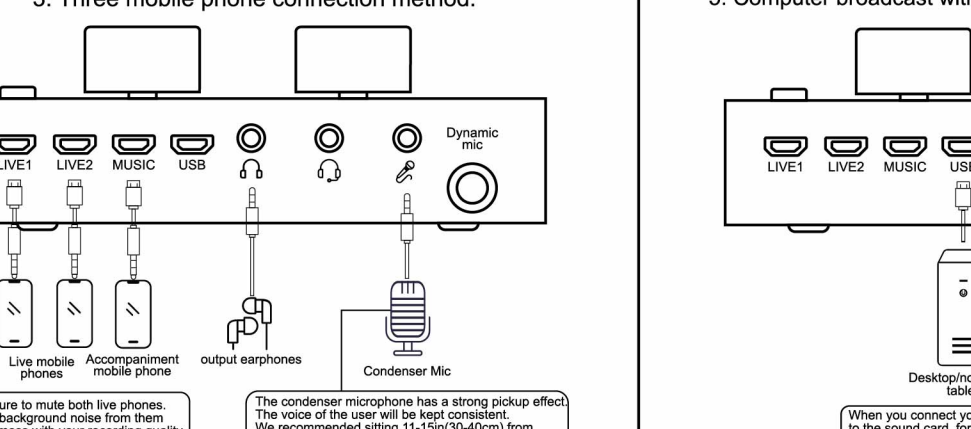

4. Mobile phone broadcast with computer accompaniment connection:

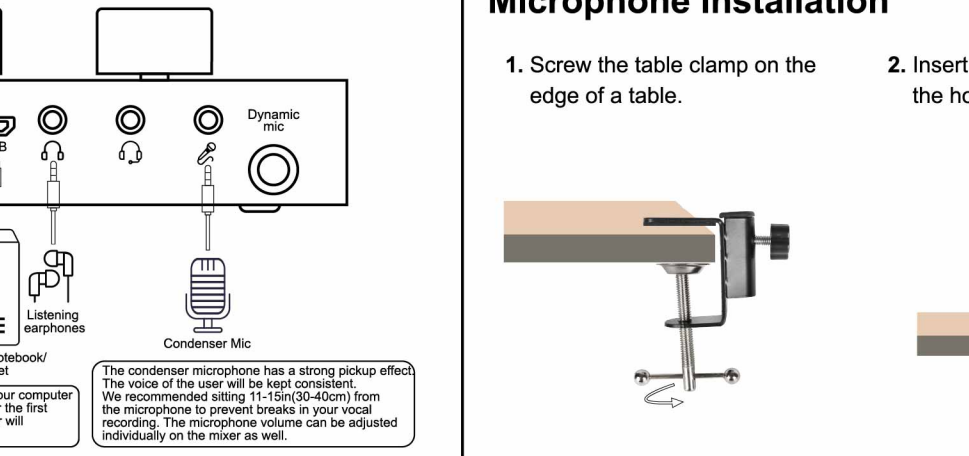

5. Computer broadcast with computer recording song connection:

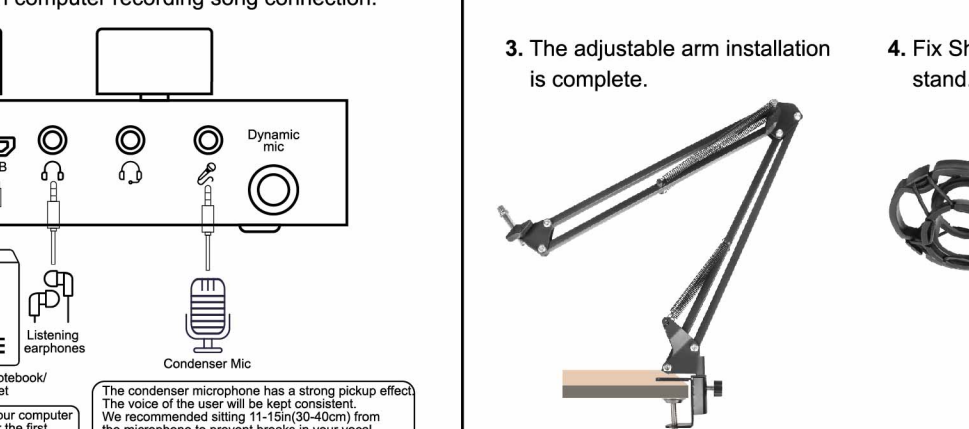

Microphone Installation

- Screw the table clamp on the edge of a table.
- Insert the adjustable arm into the hole.
- The adjustable arm installation is complete.
- Fix Shock mount with Microphone stand.
- Mount the microphone on the stand.
- Fix the pop filter net on the cantilever support.
- The installation is complete.

Warranty Information

The condition of this warranty and our responsibilities under this warranty are as follows:
 Supplier's warranty is non-transferable. And this warranty is limited to the original purchaser only.

- You must be able to prove the date of original purchase of the unit with a dated receipt.
- The warranty is not applicable if the product has been subject to physical abuse, improper installation, modification or repair by unauthorized third party.
- The responsibility of supplier's products shall be limited to the repair or replacement of the product as its sole discretion.
- Specifically exempt from any warranty are limited-life consumable components subject to normal wear and tear such as batteries, decodes and other accessories.
- A supplier will not take any responsibility if the failure of the unit has resulted from accident, abuse, misuse, or any unauthorized repair, modification or disassemble.
- Modification and repair of the unit should be done by authorized and qualified service personnel, Center or returned to the manufacturer.
- This warranty gives you specific legal rights, and you may also have other rights which vary under local laws.

The following conditions comprise the requirements and scope of our warranty conditions and do not affect our legal and contractual warranty obligations.

We offer a warranty on our products in accordance with the following conditions:
 1) Sarina products are covered by a 3 month warranty. We will resolve damages or defects on Sarina products free of charge within 3 months of the purchase date under the following warranty conditions. For any damage or defect determined later than 3 months after the purchase date, proof of a manufacturing fault must be submitted for repair under warranty.
 2) The warranty does not cover batteries and other parts, which are considered consumables, parts that break easily such as glass or plastic or defects based on normal wear and tear. There is no warranty obligation in the event of marginal differences compared to the target appearance and workmanship provided these have a negligible effect on the product's fitness for use, in the event of damage caused by chemical or electrochemical effects, by water or generally from abnormal conditions.
 3) The warranty will be performed in such a way that we shall decide whether to repair the defective parts or to replace them with working parts free of charge. Sarina reserves the right to exchange the product for a replacement product of equal value if the product sent in cannot be repaired within a reasonable time or at a reasonable cost. Requests cannot be made for repairs to be carried out on site. Parts that have been replaced or exchanged become our property.
 4) The warranty claim does not apply if repairs or other work is carried out by unauthorized persons or if our products are equipped with additional parts or accessories that are not approved for our product.
 5) Warranties that have been activated do not cause the warranty period to be extended, nor do they trigger a new warranty period. The warranty period for any replacement parts installed ends with the warranty period for the entire product.
 6) Any other further claims are excluded, especially those for replacement due to damage caused to the outside of the product, provided there is no obligatory legal liability.
 We therefore accept no liability for accidental, indirect or other consequential damage of any kind, which leads to usage restrictions, data loss, and loss of earnings or interruption to business.

Warranty Information (cont.)

Assessing a warranty claim:
 1) To make use of the warranty service for hardware issues, you must contact the Sarina Service Center by email at support@dglusa.com
 2) Sarina will try to diagnose and solve your problem. If it is determined that a warranty claim exists, you will be given an RMA number (Return Material Authorization) and will be asked to send the product to Sarina.

IMPORTANT: Sarina will only accept parcels that have an RMA number. Please observe the following when sending the product:
 1) Send the product suitably packaged with carriage and insurance paid. Do not enclose any accessories with the product (cables, chargers, manuals, etc.) unless the Sarina Service Center specifies otherwise.
 2) Mark the RMA number on the outside of the package in such a way that it is visible and clearly legible.
 3) You must enclose a copy of the sales slip as proof of purchase.
 4) Once Sarina has received the product, it will meet its warranty obligations in accordance with the warranty conditions and will return the product to the sender with carriage and insurance paid.

Service outside of warranty
 Sarina can refuse any service claim made that is not covered by the warranty.

If Sarina agrees to provide a service outside the warranty, the customer will be invoiced for all repair and transport costs. Sarina will not accept any packages that have not first been approved by Sarina by means of an RMA (Return Material Authorization).

FCC STATEMENT
 This device complies with part 15 of the FCC Rules. Operation is subject to the following two conditions: (1) This device may not cause harmful interference, and (2) this device must accept any interference received, including interference that may cause undesired operation.

WARNING: Changes or modifications not expressly approved by the party responsible for compliance could void the user's authority to operate the equipment.

FCC INSTRUCTIONS FOR A CLASS B DIGITAL DEVICE OR PERIPHERAL

Note: This equipment has been tested and found to comply with the limits for a Class B digital device, pursuant to part 15 of the FCC Rules. These limits are designed to provide reasonable protection against harmful interference in a residential installation. This equipment generates, uses and can radiate radio frequency energy and, if not installed and used in accordance with the instructions, may cause harmful interference to radio communications. However, there is no guarantee that interference will not occur in a particular installation. If this equipment does cause harmful interference to radio or television reception, which can be determined by turning the equipment off and on, the user is encouraged to try to correct the interference by one or more of the following measures:
 • Reorient or relocate the receiving antenna.

• Increase the separation between the equipment and receiver.
 • Connect the equipment into an outlet on a circuit different from that to which the receiver is connected.
 • Consult the dealer or an experienced radio/TV technician for help.

