

TABLE OF CONTENTS:  
SHEET 1: BOM, NOTES, REQUIREMENTS

SHEET 2: BOM, EXPLODED VIEWS OF ASSEMBLY  
FASTENER CALLOUTS

SHEET 3: VIEW OF IO BRIDGE LABEL PLACEMENT ON ASSEMBLY  
BOM

NOTES:  
1. TORQUE ALL METAL SCREWS TO 8-10 IN-LBS.

ITEM NO.	PART NUMBER	DESCRIPTION	QTY.
1	ND-9097	IBRIDGE PRODUCT SERIAL LABEL	1
2	5900.188	#4-40, 1/2" RHPS	1
3	KB-1191	DALI FRONT HOUSING	1
4	KB-1190	UPPER HOUSING, VENTING	1
5	ND-8389	MANUFACTURER DATE CODE ID	1
6	KB-2885	CLAMPING TEETH	3
7	KB-2915	BOARD COUPLING FOR IBRIDGE	1
7.1	KB-2913	PORT PCBA	1
7.1.1	LB-3112	BARE BOARD, PORTS PCB	1
7.2	KB-2914	PCBA, ANTENNA, LED, RADIO BOARD	1
7.2.1	LB-3113	BARE BOARD, RADIO BOARD	1
8	KB-1197	DALI BOTTOM HOUSING	1
8.1	KB-1189	DALI, MOUNTING PLATE	1
8.2	5900.182	MOLDED-IN THREADED INSERTS, BLIND THREADED - UNIFIED	1

REFERENCE BILL OF MATERIALS

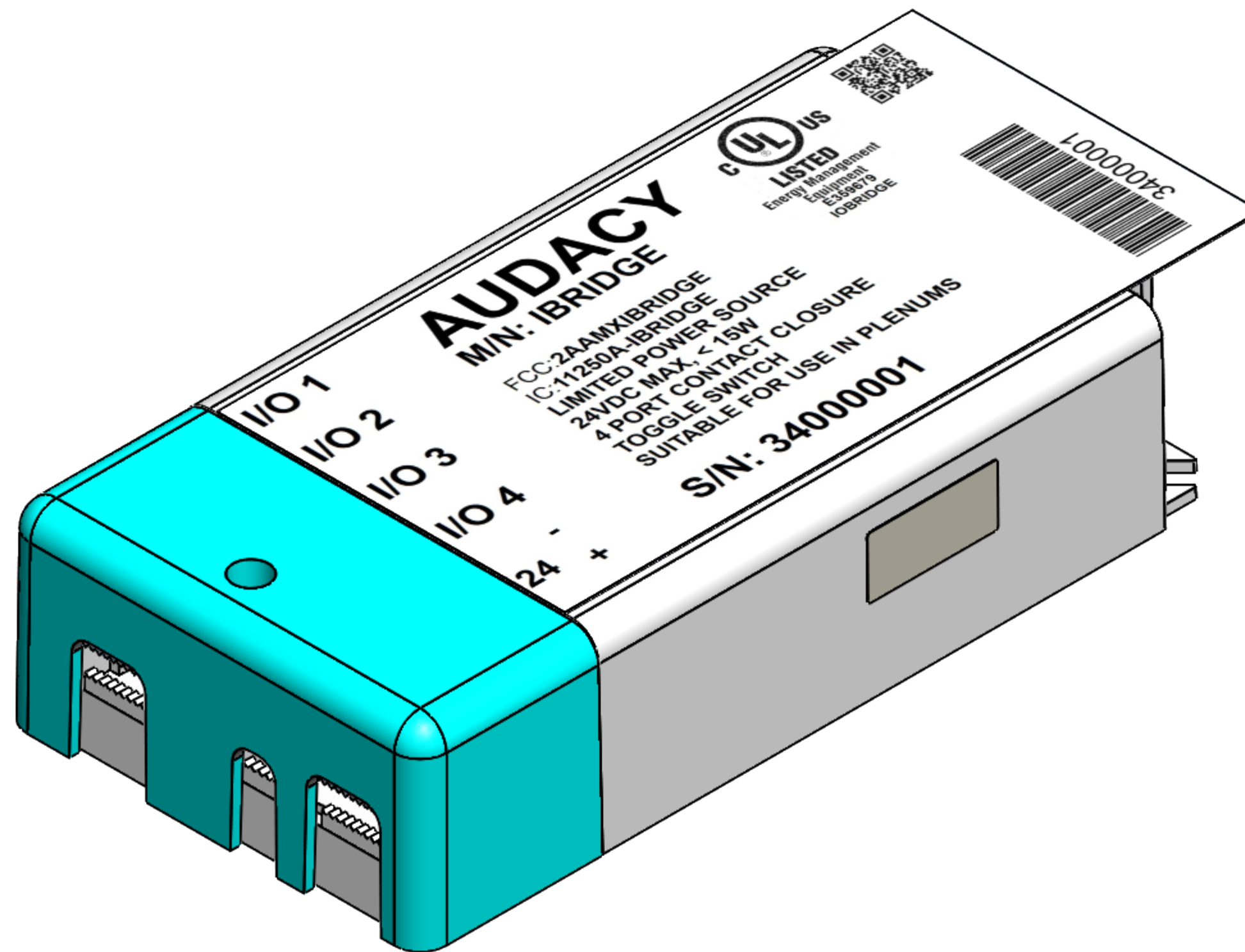

<p>-- PROPRIETARY DESIGN - "CONFIDENTIAL" -- ALL INFORMATION CONTAINED ON THIS DRAWING IS CONFIDENTIAL AND THE SOLE PROPERTY OF IDEAL INDUSTRIES, INC. UNAUTHORIZED COPYING OR DISTRIBUTION OF THIS DOCUMENT IS STRICTLY PROHIBITED.</p>						<p>TITLE: ASSEMBLY, I-BRIDGE COMPLETED</p>			
<p>-- UNLESS OTHERWISE SPECIFIED: THIS DRAWING BASED ON ANSI Y 14.5 SURFACE FINISH 12.5 ON MACHINED SURFACES DIMENSIONS SYMMETRICAL ABOUT CENTER LINE WHERE APPLICABLE ON PLATED PARTS ALL DIMENSIONAL LIMITS APPLY AFTER PLATING DIMENSIONS OF MOLDED PARTS ARE FOR FINISHED PART. NO ALLOWANCE HAS BEEN MADE FOR SHRINK.</p>						<p>59-GPIO1000</p>			
<p>-- HAZARDOUS SUBSTANCE CONTROL -- ANY PRODUCT OR PART THAT CONTAINS LEAD, HEXAVALENT CHROMIUM, MERCURY, CADMIUM, POLYBROMINATED BIPHENYLS, POLYBROMINATED DIPHENYL ETHERS, PENTABROMO-DIPHENYL ETHER, OR OCTABROMO-DIPHENYL ETHER MUST BE IN FULL COMPLIANCE WITH EUROPEAN UNION 2002/95/EC &amp; 2003/11/EC DIRECTIVES.</p>						<p>MATL: SEE COMPONENTS</p>			
<p>DO NOT SCALE DRAWING. TOLERANCES UNLESS OTHERWISE SPECIFIED          .00 ±.02 ANGLES ±0°30'          .000 ±.005</p>						<p>FINISH: SEE COMPONENTS</p>			
<p>DATE BY ENG ECN NO. SYM ISS</p>						<p>SCALE: 1:2 DRW BY: AP CKD BY: SNK APP BY:</p>			
<p>IDEAL INDUSTRIES, INC. SYCAMORE, ILLINOIS, U.S.A.</p>						<p>DATE: 1/30/2020 DRWG. NO. IA-6383</p>			

ITEM NO.	PART NUMBER	DESCRIPTION	QTY.
1	ND-9097	IBRIDGE PRODUCT SERIAL LABEL	1
2	5900.188	#4-40, 1/2" RHPS	1
3	KB-1191	DALI FRONT HOUSING	1
4	KB-1190	UPPER HOUSING, VENTING	1
5	ND-8389	MANUFACTURER DATE CODE ID	1
6	KB-2885	CLAMPING TEETH	3
7	KB-2915	BOARD COUPLING FOR IBRIDGE	1
8	KB-1197	DALI BOTTOM HOUSING	1

**NOTES:**

- 1. BOTTOM SCERWS NEED 8-10 IN-LBS**
- 2. LABEL (ITEM 1) - APPLY LABEL WITHOUT BACKING. REMOVE ALL BACKING PRIOR TO PLACEMENT.**

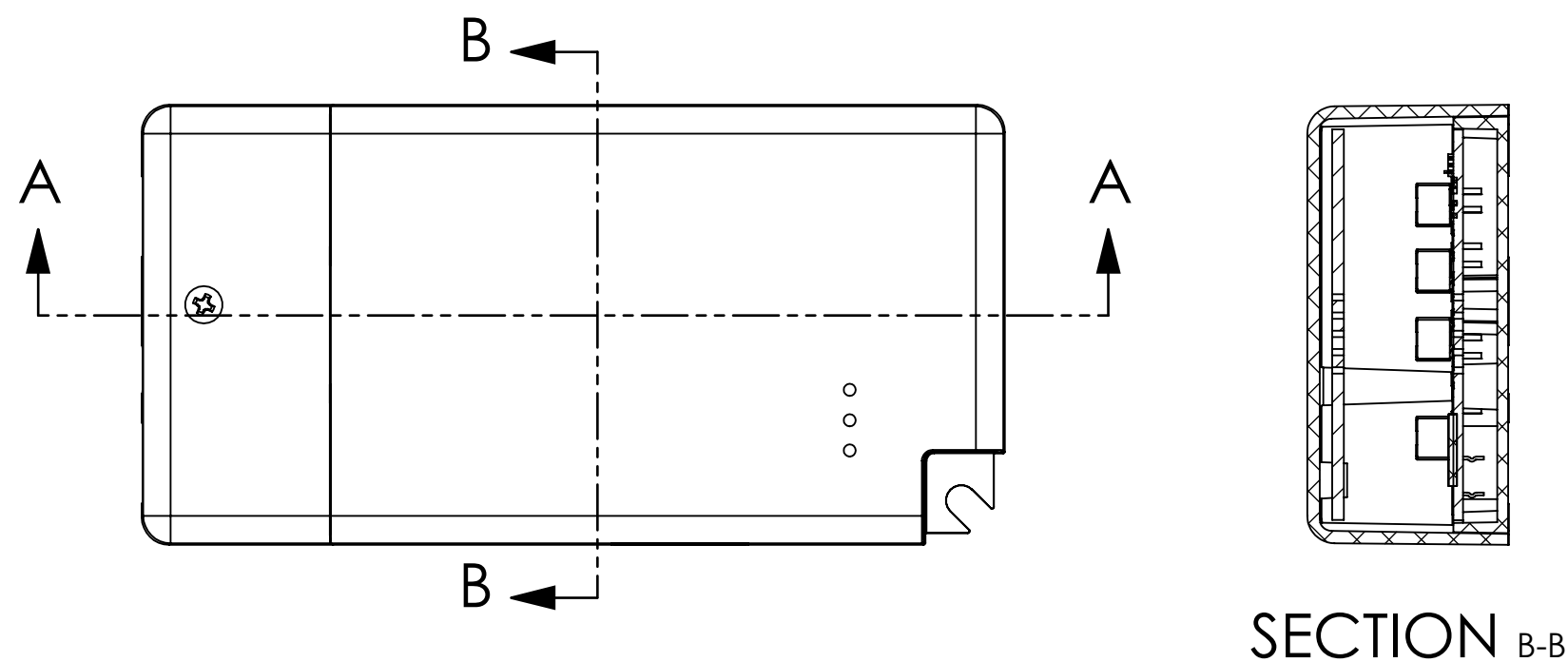
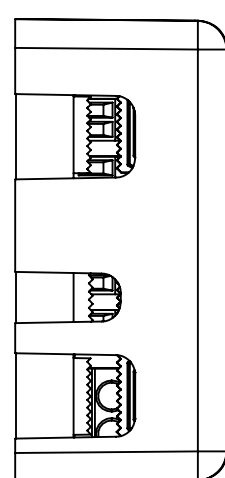
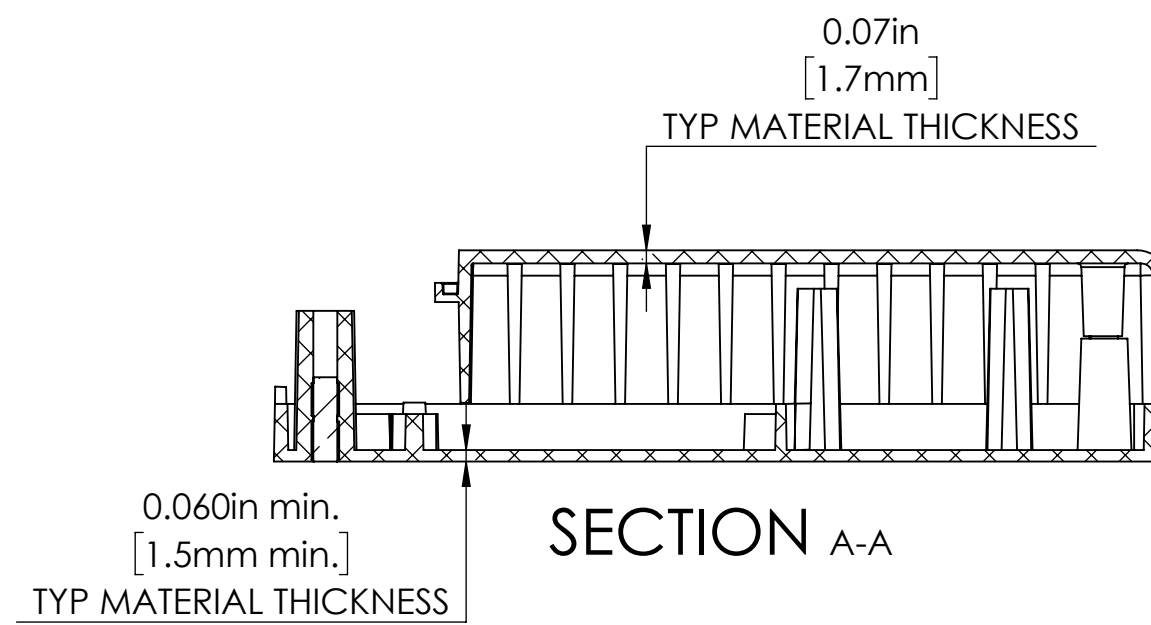
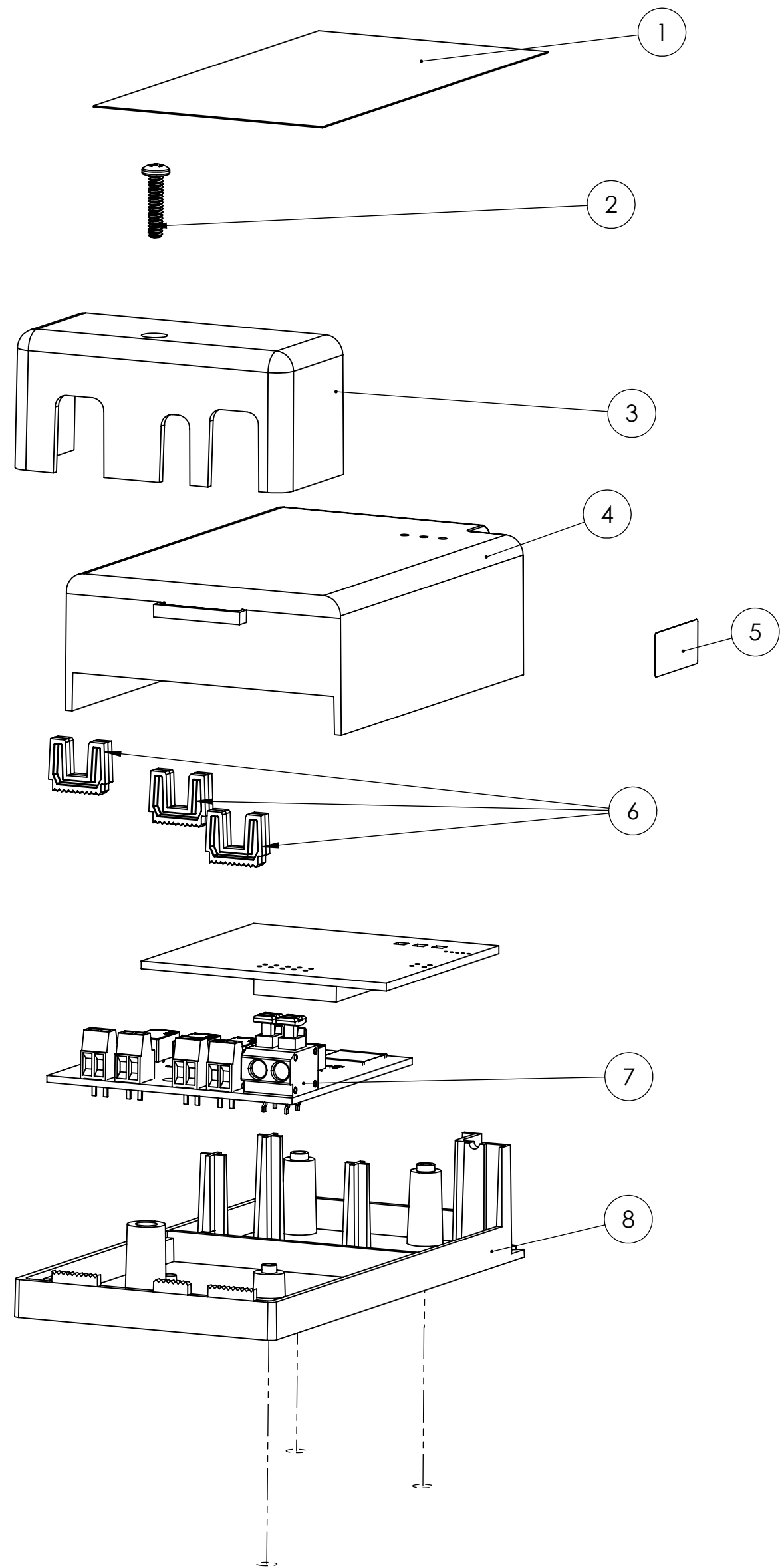

<p align="center"><b>-- PROPRIETARY DESIGN - "CONFIDENTIAL" --</b></p> <p align="center"><small>ALL INFORMATION CONTAINED ON THIS DRAWING IS CONFIDENTIAL AND THE SOLE PROPERTY OF IDEAL INDUSTRIES, INC. UNAUTHORIZED COPYING OR DISTRIBUTION OF THIS DOCUMENT IS STRICTLY PROHIBITED.</small></p> <p align="center"><b>-- UNLESS OTHERWISE SPECIFIED:</b></p> <p align="center"><small>THIS DRAWING BASED ON ANS Y 14.5 SURFACE FINISH 125. ON MACHINED SURFACES DIMENSIONS SYMMETRICAL ABOUT CENTER LINE WHERE APPLICABLE. ON PLATED PARTS ALL DIMENSIONAL LIMITS APPLY AFTER PLATING. DIMENSIONS OF MOLDED PARTS ARE FOR FINISHED PART. NO ALLOWANCE HAS BEEN MADE FOR SHRINK.</small></p> <p align="center"><b>-- HAZARDOUS SUBSTANCE CONTROL --</b></p> <p align="center"><small>ANY PRODUCT OR PART THAT CONTAINS LEAD, HEXAVALENT CHROMIUM, MERCURY, CADMIUM, POLYBROMINATED BIPHENYLS, POLYBROMINATED DIPHENYL ETHERS, PENTABROMO DIPHENYL ETHER, OR OCTABROMO DIPHENYL ETHER MUST BE IN FULL COMPLIANCE WITH EUROPEAN UNION 2002/95/EC &amp; 2003/11/EC DIRECTIVES.</small></p> <p>DO NOT SCALE DRAWING. TOLERANCES UNLESS OTHERWISE SPECIFIED PART VOLUME</p> <p><small>- ALL DIMENSIONS IN INCHES. 0.00 ± 0.02 ANGLES ± 0°30'</small> <b>CUBIC INCHES</b></p> <p><small>- REMOVE ALL BURRS. ± 0.05</small></p> <p><small>- BREAK ALL SHARP EDGES.</small></p>						TITLE: COMPLETE ASSEMBLY	
						59-GPIO1000	
MATERIAL: SEE COMPONENTS							
FINISH: SEE COMPONENTS							
SCALE: 1:1		DRW. BY: AP	CKD BY: SNK	APP. BY:			
DATE	BY	ENG	ECN NO.	SYM	ISS		
<b>IDEAL INDUSTRIES, INC.</b> SYCAMORE, ILLINOIS, U.S.A.			DATE				
			DRWG. NO. <b>IA-6383</b>				

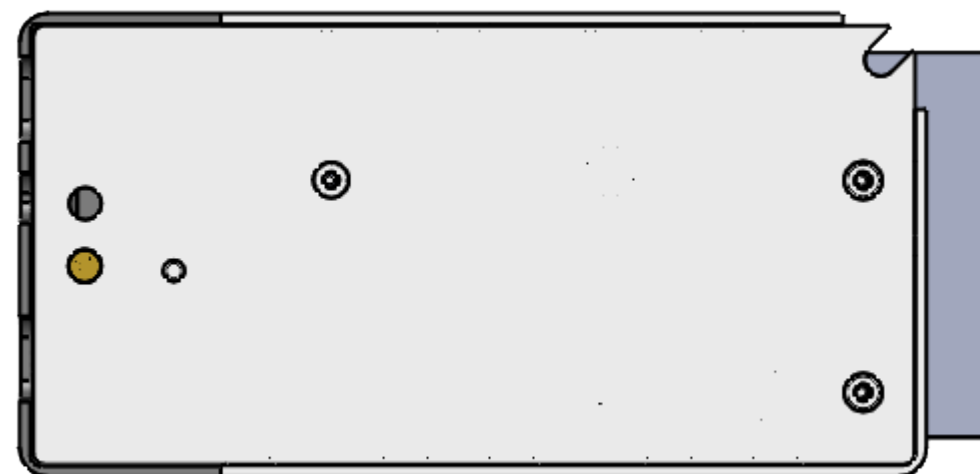
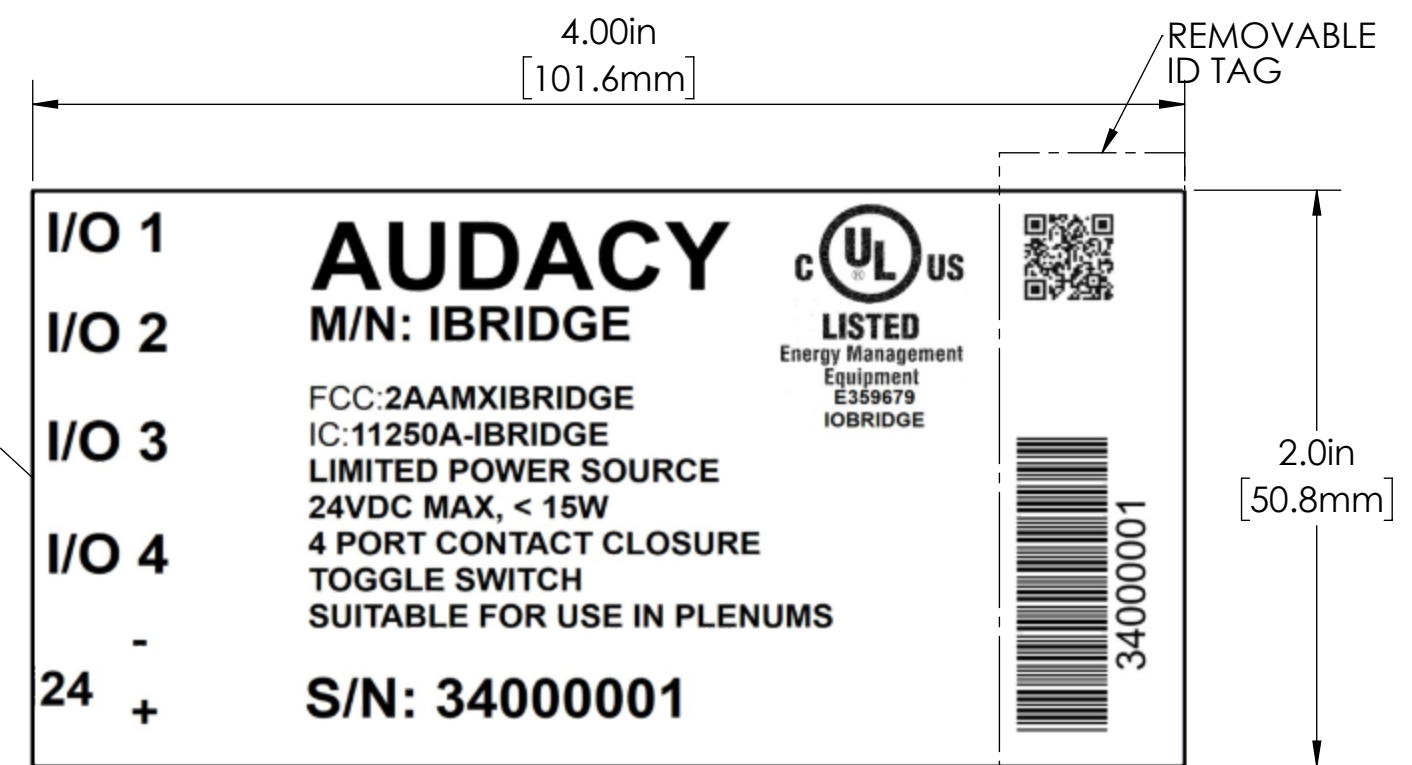
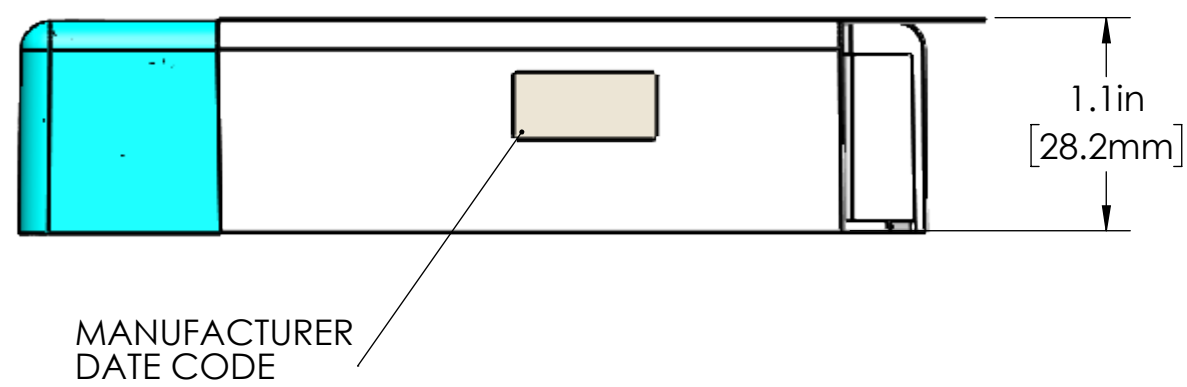
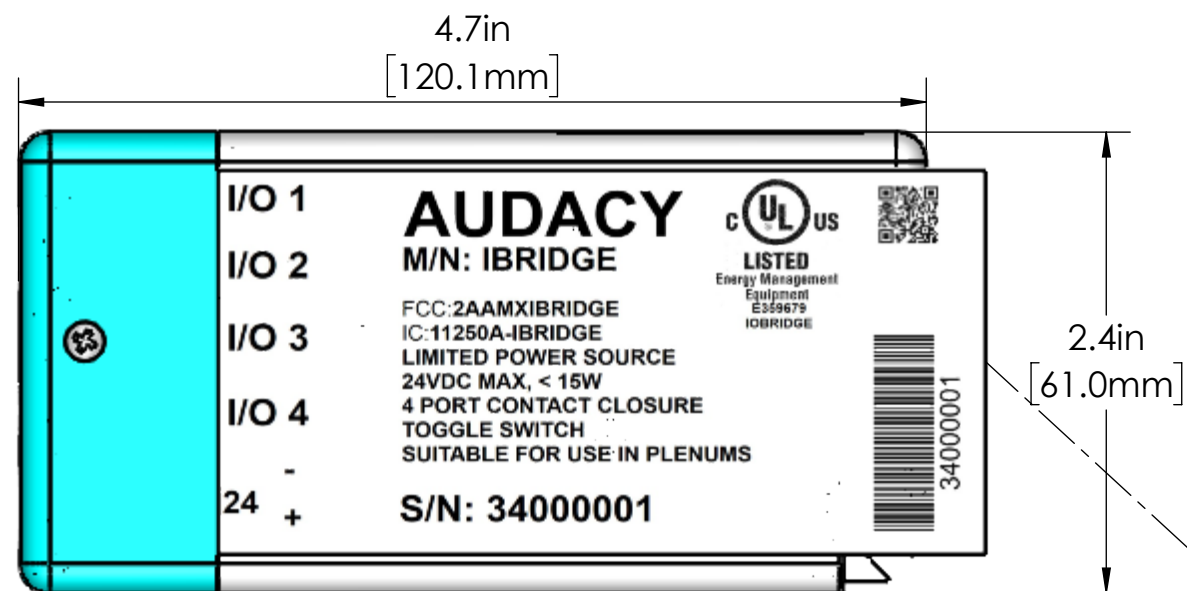

<p align="center"><b>-- PROPRIETARY DESIGN - "CONFIDENTIAL" --</b>  <small>ALL INFORMATION CONTAINED ON THIS DRAWING IS CONFIDENTIAL AND THE SOLE PROPERTY OF IDEAL INDUSTRIES, INC. UNAUTHORIZED COPYING OR DISTRIBUTION OF THIS DOCUMENT IS STRICTLY PROHIBITED.</small></p>						<p>TITLE: ASSEMBLY, I-BRIDGE COMPLETED</p>	
<p><b>-- UNLESS OTHERWISE SPECIFIED:</b>  <small>THIS DRAWING BASED ON ANS Y 14.5 SURFACE FINISH 125.7 ON MACHINED SURFACES DIMENSIONS SYMMETRICAL ABOUT CENTER LINE WHERE APPLICABLE ON PLATED PARTS ALL DIMENSIONAL LIMITS APPLY AFTER PLATING DIMENSIONS OF MOLDED PARTS ARE FOR FINISHED PART. NO ALLOWANCE HAS BEEN MADE FOR SHRINK.</small></p>						<p>59-GPIO1000</p>	
<p><b>-- HAZARDOUS SUBSTANCE CONTROL:</b>  <small>ANY PRODUCT OR PART THAT CONTAINS LEAD, HEXAVALENT CHROMIUM, MERCURY, CADMIUM, POLYBROMINATED BIPHENYLS, POLYBROMINATED DIPHENYL ETHERS, PENTABROMO-DIPHENYL ETHER, OR OCTABROMO-DIPHENYL ETHER MUST BE IN FULL COMPLIANCE WITH EUROPEAN UNION 2002/95/EC &amp; 2003/11/EC DIRECTIVES.</small></p>						<p>MATL: -</p>	
<p>DO NOT SCALE DRAWING. TOLERANCES UNLESS OTHERWISE SPECIFIED PART VOLUME</p>						<p>FINISH: -</p>	
<p>- ALL DIMENSIONS IN INCHES. TOLERANCES UNLESS OTHERWISE SPECIFIED PART VOLUME</p>						<p>SCALE: 1:1 DRW BY: AJT CKD BY: SNK APP BY:</p>	
<p>- REMOVE ALL BURRS. 00 ±.02 ANGLES ±0°30'</p>						<p>DATE: 2/17/2020 DRWG. NO. IA-6383</p>	
<p>- BREAK ALL SHARP EDGES. 000 ±.005</p>						<p>IDEAL INDUSTRIES, INC. SYCAMORE, ILLINOIS, U.S.A.</p>	
DATE	BY	ENG	ECN NO.	SYM	ISS		