

STEP 9

Open the latch clasp links, and open the strap adjustment door. Gently pull the strap out of the clasp a small amount. Lock the adjustment door back down.

**STEP 10**

Place the smartwatch on your wrist again and close the clasp.

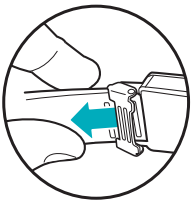
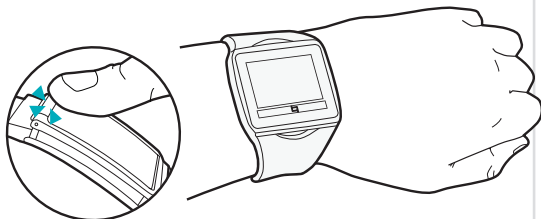

If further fitting is necessary, open the clasp again, remove smartwatch from wrist, open the strap adjustment door, and slide the strap in or out to fine tune the fit. Lock down the adjustment door and try on the smartwatch again. Repeat until you achieve a comfortable fit.

Additional Fitting

If the strap remains too loose around your wrist, you can repeat the fitting procedure described previously.

STEP 1

Use a paper clip to release the strap from the clasp, and depress the spring bar pinhead until it clears the inside surface of the hole on the side of the clasp strap slot.

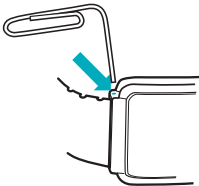
**STEP 2**

Rotate the strap out of the clasp and then lift the other side of the spring bar pin out of the hole at the other end of the clasp strap slot.

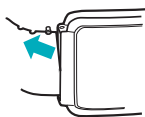
**STEP 3**

Remove the spring bar pin from the hole in the strap.

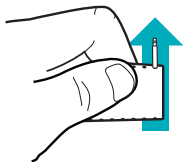
**STEP 4**

Repeat the strap fitting instructions in Sizing the Band to remove one or more additional sections of the strap.

Learn More

For more help, tips, and the full user manual for your Qualcomm Toq smartwatch, go to [Toq.Qualcomm.com/support](https://www.qualcomm.com/support).

QUALCOMM

© 2013 Qualcomm Connected Experiences, Inc. All rights reserved. Qualcomm is a trademark of Qualcomm Incorporated, registered in the United States and in other countries. Toq is a trademark of Qualcomm Incorporated. All Qualcomm Incorporated trademarks are used with permission. Other product and brand names may be trademarks or registered trademarks of their respective owners.

Qualcomm Toq smartwatch is a product of Qualcomm Connected Experiences, Inc.

80-HK154-1, 10/2013

Customize the Strap



Qualcomm® Toq™ smartwatch

Before adjusting the smartwatch strap, please review the **Get Started** and **Use Your Smartwatch** guides.

Note: You must not cut the strap that's attached to the clasp. Trim only the opposite strap with visible grooves as outlined in the instructions below.

This guide will walk you through customizing the strap on your Qualcomm Toq smartwatch.



Also check out the helpful setup videos at [Toq.Qualcomm.com/support](https://www.qualcomm.com/support).

Open/Close the Clasp

- Use your fingernail to open here:

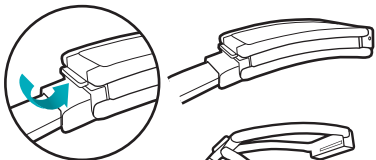

- Close the clasp and be sure to snap into place:

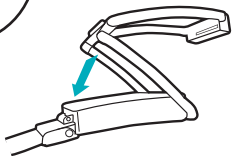

Size the Strap

STEP 1

Use your fingernail to open strap adjustment door, and gently push the strap into the clasp until it stops.

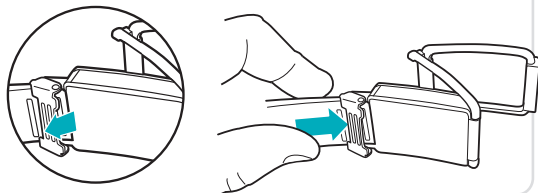

STEP 2

Close the strap adjustment door to lock the strap in place in fully inserted position. Close the latch clasp links.

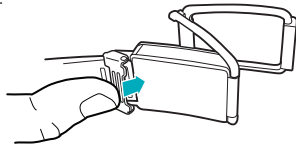

STEP 3

Place the smartwatch on your wrist with the clasp side closest to you.

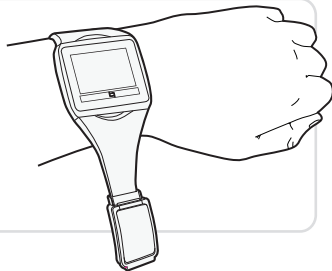

STEP 4

Wrap the clasp end of the strap around the underside of your wrist and hold it in place. Wrap the long end of the strap on top of the clasp end, and hold it in place so that the strap is comfortable around your wrist.

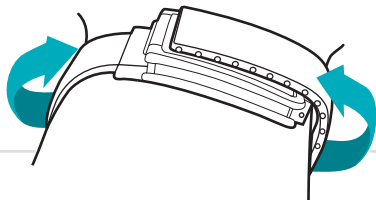

STEP 5

Make note of the strap hole that is in alignment with the holes at either end of the strap receptacle slot in the clasp.

Obtain a spring bar pin from the bag attached to the card included in the box. Insert the spring bar pin into the strap to mark the correct hole.

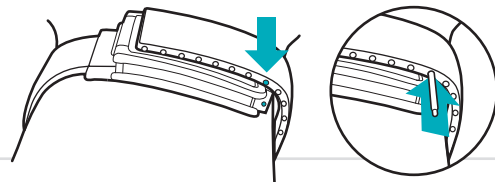

STEP 6

Insert the spring bar pin completely through the strap hole until it is protruding equally from both sides of the strap.

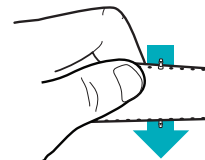

STEP 7

Using scissors, carefully cut the strap along the marked surface groove that is next to the spring bar pin on the free end side of the strap. Discard the piece that's been cut off.

Note: Use caution when cutting the strap to avoid making it too short to fit your wrist comfortably.

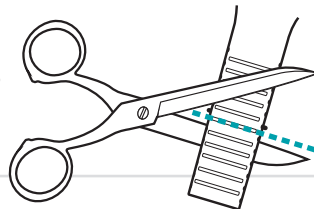

STEP 8

Attach the cut side of the strap to the clasp:

- Bend the cut side around and align with the strap receptacle slot in the clasp.

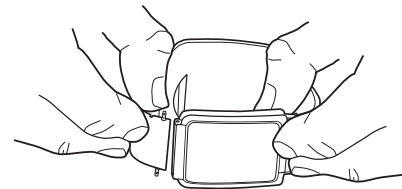

- Insert one end of the spring bar pin first into a pin hold in the clasp. Then rotate the other end of the pin to align with the other hold, depress the pin head, and slide it into the slot until it pops into place in the hole.

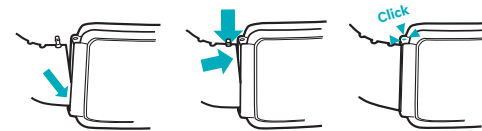

- Make sure the cut end of the strap is inserted fully and the spring bar pin heads are snapped into the holes in the clasp. Gently tug on the connection to check.

