

4 in 1 Multi-function Wireless Doorbell

User Manual (HD01)

This package includes:

- Wireless chime
- Wireless push button
- Hardware pack
- Battery for push button

Introduction

This world first 4 in 1 multi-function doorbell is a modern high-tech alternative to the single-function doorbell. It brings a whole new level of convenience to your daily life.

4 in 1 functions:

1. Wireless Doorbell
2. Security Burglar Alarm
3. Motion Sensor Light
4. Emergency Flashlight

Product Diagram

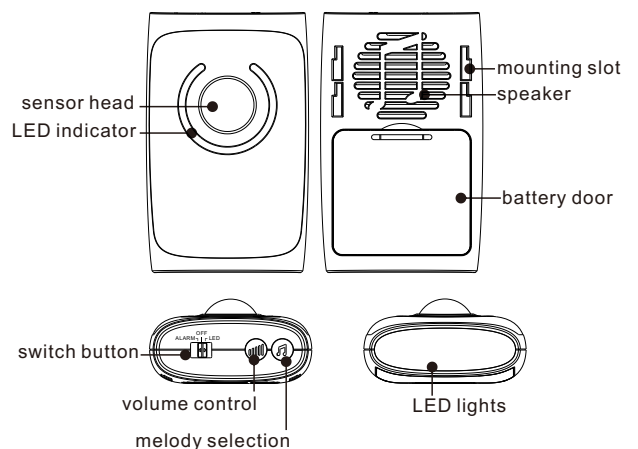

1

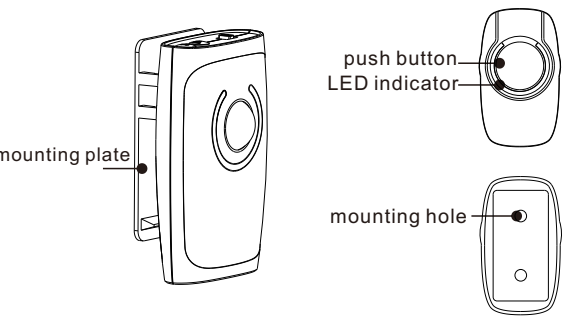

Battery Installation

A. Push button

1. Remove back of case by pushing in tab on bottom with a small screwdriver.
2. Install an alkaline type 23A 12V battery, make sure battery is oriented properly.
3. Push the back of case into place.

B. Chime

1. Remove the battery door on back of case.
2. Install 3 alkaline AA batteries, make sure battery is oriented properly.
3. Push the battery door into place.

2

Mounting

Before mounting push button and chime, temporarily position them where you want them mounted. Press push button to verify chime and push button work properly. If chime does not sound, see Troubleshooting on page 7.

A. Mount push button

- Use either screws or double sided tape to mount push button.
- To mount with screws, remove back of case by pushing tab on bottom with a small screwdriver.
- Attach back of case to door jamb or wall. Snap front of button on.
- When attaching push button using double sided tape, make sure the surface of the door jamb or wall is clean.

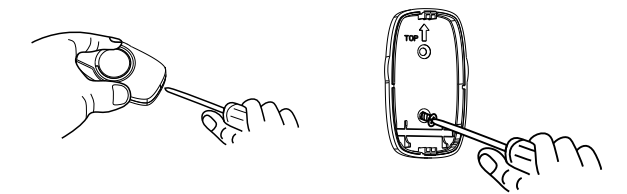

B. Mount chime

- Use either screws or double sided tape to mount the plate firstly.
- Push the chime onto the plate properly.
- When attaching chime using double sided tape, make sure the surface of the wall is clean.

3

How to Use?

1 Wireless Doorbell

1. Set the switch on OFF, only doorbell function works.
2. Press the volume button to control the volume of melody. There are 3 levels of adjustable volume: high, medium and low.
3. Press the melody selection button to select the melody you like. There are 36 different melodies with 16 chords.
4. Doorbell function also works when the switch is set on ALARM or LED position.

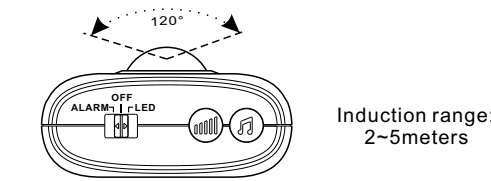

Induction range:
2~5meters

2 Security Burglar Alarm

1. Set the switch on ALARM.
2. LED indicator will be on for 15 seconds, indicating the alarm is ready in defense.
3. If someone steps into the induction range, it will alarm for 30 seconds and stop.
4. The alarm sound can also be stopped by setting the switch to OFF or pressing the push button.

4

3 Motion Sensor Light

1. Set the switch on LED.
2. If someone steps into the induction range, it will light up for 20 seconds and go out.
3. This function only works when no light is detected by the sensor head.

4 Emergency flashlight

1. Set the switch on LED.
2. Take the chime down from the mounting plate and hold it in hand, it will work as an emergency flashlight if no light is detected by the sensor head.

Code Learning

This doorbell comes with a code learning function, which allows you to expand your system with more push buttons or door chimes. Follow the instructions below for code learning.

1. Remove the battery door from back of door chime.
2. Press and hold the push button, using a small screwdriver or alternative tool to press the button located on the top left corner of battery compartment, then release both buttons. Press the push button again, if a melody is heard, then code learning is successful. If not, repeat the above step to learn the code again.

5

Technical Data

- Working voltage: 3.2V~5.5V
- Push button battery: 23A 12V (included)
- Chime batteries: 3 x AA 1.5V (not included)
- Volume: 90-120dB
- Range: up to 150m (open space)
- Number of melody: 36
- Frequency: 433MHZ

Warning

1. Please do not open and repair it without professional guide in order to avoid any breakdown of components.
2. Please use high quality alkaline batteries rather than carbon zinc batteries which are insecure and have shorter service life.
3. Please do not expose it to the sun and rain for a long time and keep it away from metallic object.
4. The range of the doorbell depends on location, temperature and battery condition.

6

Troubleshooting

Problems	Solutions
1. Chime does not sound?	<ul style="list-style-type: none"> • Check orientation of push button battery. • Check orientation of chime battery. • Check the battery, replace with new batteries if necessary. • Make sure the push button and the chime codes are the same. If not follow the code learning instruction to reset the code.
2. Batteries seem OK, but the chime does not work when installed?	<ul style="list-style-type: none"> • Do not mount the chime or doorbell button on metal or near metal studs. This reduces the transmitting range. • Don't mount the chime too close to ground level concrete slabs. This may also reduce the range. Mount the chime away from the floor. • Check the battery, replace with new batteries if necessary. • Try different locations for the chime closer to the doorbell button. Also try to orient the chime at a different angle to increase the range.

7

This device complies with part 15 of the FCC Rules.

Operation is subject to the following two conditions: (1) This device may not cause harmful interference, and (2) this device must accept any interference received, including interference that may cause undesired operation.

Note: This equipment has been tested and found to comply with the limits for a Class B digital device, pursuant to Part 15 of the FCC Rules.

These limits are designed to provide reasonable protection against harmful interference in a residential installation. This equipment generates uses and can radiate radio frequency energy and, if not installed and used in accordance with the instructions, may cause harmful interference to radio communications.

However, there is no guarantee that interference will not occur in a particular installation. If this equipment does cause harmful interference to radio or television reception, which can be determined by turning the equipment off and on, the user is encouraged to try to correct the interference by one or more of the following measures:

Reorient or relocate the receiving antenna.

Increase the separation between the equipment and receiver.

Connect the equipment into an outlet on a circuit different from that to which the receiver is connected.

Consult the dealer or an experienced radio/TV technician for help.

Warning: Changes or modifications to this unit not expressly approved by the part responsible for compliance could void the user's authority to operate the equipment.