

# USER MANUAL

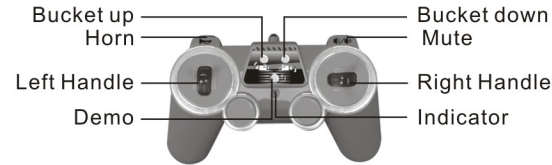

## 1 Main parameters

Item No.: E579-003  
Material: plastic and electronic components  
Batteries: Car battery: 3.7V rechargeable battery;  
Remote controller battery: 2 pcs of 1.5V AA batteries.



## 2 Battery Installation

1. Open the cover of battery case locates in the back of controller, inserts 1 pc of 3.7V batteries into the battery case, and then screw the cover (Fig 2A).
2. Please screw out the cover at the back of car by screwdriver, open the cover as the arrow showed, insert 2 pcs of 1.5 V AA batteries, then screw the cover (Fig 2B).

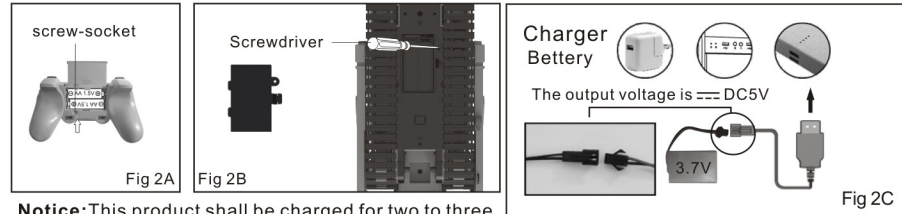

**Notice:** This product shall be charged for two to three hours. The supporting USB charger shall not be used for other devices other than this product. When the USB charger is connected to the power, the indicator light on. When the USB charger and battery are being charged, the indicator will be flashing, it will be off after full charged (Fig 2C).

## 3 2.4G Auto Coding

1. After installing the batteries of car and remote controller, open the switch of both. The indicator of remote controller and the fronts lights of car would be flashing slowly, and then at a state of auto-coding.
2. One remote controller only could code with one car. After the success of coding, there is non-interference of each car.
3. If the remote controller could not find out the 2.4G signal of the car in 1 minute, it would turn in a sleeping state (light off of the indicator). To press any key to activate.
4. To remake a pair with other cars or remote controllers after turning off the power of both.

## 4 Operating Instructions for the controller

1. Turn ON/OFF
  - Press the any key, there will be a start-up sound; Without receiving any remote controlled signals after starting, the car would auto off in 60 seconds. (Fig 3A)
2. Horn Key
  - To press the Horn Key on remote controller after starting the car, the car would emit a simulated sound.
3. Forward/Backward
  - To push the Left Handle forward/backward, the car would go forward/backward.

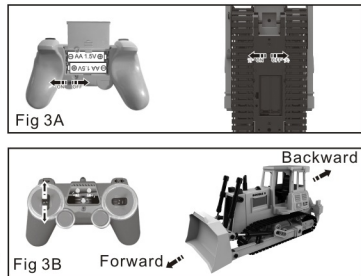

## 4. Turn Left/Right

- To push the Left Handle forward/backward, Right Handle turns left/right, the car would turn left/right. (Fig 3C).

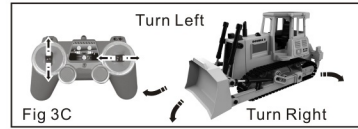

## 5. Bucket up/down

- Press the up button, bucket up, down button, bucket down, up /During the descending operation, the car lights are on (fig 3D).

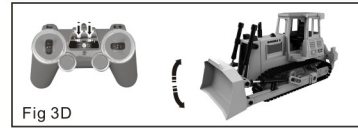

## 6. Manually loosen the harrow

- The soil scraper can be manually moved up and down (fig 3E).



## 5 Advanced Functions

### 1. Mute Switch

- After starting the fire truck, to press the Horn key for a long time, the car could change to a mute condition. To press the Horn key again, it could be switched to the sound station.

### 2. Programme Function

- To press the Programme Key when starting, after the indicator turns red, the car is in a state of Programme, you could do a series of motion as you like, and these motions would be saved. To press the Programme Key again, the fire truck would automatically operate the motions.

### 3. Auto OFF

- Without receiving any remote controlled signals after starting, the car would auto off in 50 seconds. When turn off, the car would with a DI sound, and all the functions are at a state of stand-by. It only could be operated after restarting.

### 4. Athletics Function

- There are three channels A/B/C in the remote controller and the fire truck, so more than two players could play together through choosing different channel.

## 6 Recharging

Notice: please turn off the power of the remote controller and car if the product would not be used a long time, make sure to take out batteries before storing. Please charge the battery for 2 to 3 hours.

## 7 Notice

1. Don't play the toy on the road, select a safe place for operating to avoid dangerous.
2. Plays the toy in water may cause short-circuit damage. Please use the dry cloth to clean the car.
3. If abnormal speed or reaction, it may be because of insufficient battery power, please charge the battery.
4. The batteries should be charged under adult supervision. Please use the batteries recommended.
5. Please install the battery in a correct polarity.
6. Do not mix new and old batteries together, may cause short-circuited.
7. Please charge the battery before initial use.
8. Please check the plug, case and other units of charger regularly to make sure that it is not broken. Don't use again if you find abnormality of the charger.
9. Please do not connect the product to different performance power.

Frequency bands: 2402MHz to 2480MHz

Maximum output power: -0.22dBm (for EU compliance)

Manufacturer: Doubleeagle Industry(China)Limited.

Address: Xingda Industrial Park , Chenghai District, Shantou City, Guangdong Province , China.

Importer: JAMARA e.K.

Address: Inh .Manu el Natterer

Am Lauerbuhl5-DE-88317 Aichstetten Germany

CHOKING HAZARD-small parts , not for children under 3 years.

## FCC Compliance

This device complies with Part 15 of the FCC Rules. Operation is subject to the following two conditions: (1) this device may not cause harmful interference, and (2) this device must accept any interference received, including interference that may cause undesired operation.

Note: This equipment has been tested and found to comply with the limits for a Class B digital device, pursuant to Part 15 of the FCC Rules. These limits are designed to provide reasonable protection against harmful interference in a residential installation. This equipment generates, uses and can radiate radio frequency energy and, if not installed and used in accordance with the instructions, may cause harmful interference to radio communications. However, there is no guarantee that interference will not occur in a particular installation.

If this equipment does cause harmful interference to radio or television reception, which can be determined by turning the equipment off and on, the user is encouraged to try to correct the interference by one or more of the following measures:

-- Reorient or relocate the receiving antenna.

-- Increase the separation between the equipment and receiver.

-- Connect the equipment into an outlet on a circuit different from that to which the receiver is connected.

-- Consult the dealer or an experienced radio/TV technician for help.

Caution: changes or modifications not expressly approved by the party responsible for compliance could void the user's authority to operate the equipment.