

i.safe MOBILE



**OPERATING MANUAL
AND SAFETY INSTRUCTION**

FCC ID:2AACZ-M360A01

IS360.2

MODEL M360A01

CONTENTS

English	3
---------------	---

This Operating Manual complies with these standards:

IEC 60079, IEC 82079, ANSI Z535.6

Diese Bedienungsanleitung erfüllt die Anforderungen der folgenden Normen:

IEC 60079, IEC 82079, ANSI Z535.6

Document No. 1057MM01REV00

Version: 2021-08-27

(c) 2021 i.safe MOBILE GmbH

i.safe MOBILE GmbH

i_Park Tauberfranken 10

97922 Lauda-Koenigshofen

Germany

Tel. +49 9343 60148-0

info@isafe-mobile.com

www.isafe-mobile.com

Template: TEMPMM01REV10

ENGLISH

EX MARKINGS

› ATEX:

- Ⓜ II 3G Ex ic IIC T4 Gc
- Ⓜ II 3D Ex ic IIIC T135°C Dc
- EU Type Examination Certificate:
EPS 21 ATEX 1 126 X
- CE-designation: CE

› IECEx:

- Ex ic IIC T4 Gc
- Ex ic IIIC T135°C Dc
- IECEx Certificate: IECEx EPS 21.0043X

› Temperature range:

- 10°C ... +60°C (EN/IEC 60079-0)
- 10°C ... +50°C (EN/IEC 62368-1)

› Manufactured by:

- i.safe MOBILE GmbH**
- i_Park Tauberfranken 10
- 97922 Lauda-Koenigshofen
- Germany

EX-RELEVANT SAFETY REGULATIONS

Use of this device assumes that the operator observes the conventional safety regulations and has read and understood Operating Manual, Safety Instructions and certificate.

When used in explosion hazardous areas, the following Safety Instructions must also be complied with:

- ›› Inside explosion hazardous areas the covers of all interfaces (USB) must be closed:
- ›› To ensure the IP-protection, it has to be ensured that the all gaskets are present and functional. There must be no large gap between the two halves of the housing and between the battery compartment cover and housing.
- ›› The device may only be charged outside explosion hazardous areas using the Type C USB Cable or other equipment approved by i.safe MOBILE GmbH.
- ›› The device may only be charged at temperatures between +5 °C to +35 °C.
- ›› Physical connections to IS360.2 are only allowed outside explosion hazardous areas using the Type C USB Cable or other equipment approved by i.safe MOBILE GmbH.
- ›› The device may not be exposed to any aggressive acids or alkalis.
- ›› The device may only be used in zones 2 or 22.

INFORMATION CONCERNING SAR CERTIFICATION (SPECIFIC ABSORPTION RATE)

The SAR limit of Europe is 2.0 W/kg for the head and body, 4.0 W/kg for the limbs. The device has been tested against this SAR limit. The highest SAR value reported under this standard during product certification for use at the ear is 0.816 W/kg and when correctly worn on the body is 0.774 W/kg, limbs is 1.453 W/kg.

This device was tested for typical body worn operations with the back of the handset kept 5 mm from the body. The device complies with RF specifications when used at 5 mm from the body. Belt clips, holsters and similar accessories used should not contain metallic components in the assembly. The use of accessories that do not satisfy these requirements may not comply with RF exposure requirements, and should be avoided.

› READ AND UNDERSTAND THE INSTRUCTIONS

⚠ PROTECT YOUR LIFE AND READ THE OPERATING MANUAL

This Operating Manual is part of the device **IS360.2 (model M360A01)**. This Operating Manual provides important information for safe use of the device.

- › Before using the device, read this Operating Manual carefully and pay particular attention to the "Safety" section and the warnings highlighted with the warning symbol. ⚠
- › Also read the **Safety Instructions** before using the device.
You can find these at **www.isafe-mobile.com/en/support/downloads**.
- › Make sure you have access to this Operating Manual when you need it. You can find the current Operating Manual at **www.isafe-mobile.com/en/support/downloads**.
- › Follow all instructions given on the device and on the packaging.
- › Follow local safety regulations.

› INTENDED USE

The **IS360.2** is an Internet-capable communication device for industrial use in explosion hazardous areas of Zone 2/22, in accordance with Directives 2014/34/EU, 2014/53/EU and the IECEx system, among others.

Only use the device as described in this Operating Manual. Any other use is considered improper and can lead to death, severe injuries and damage to the device.

The manufacturer **i.safe MOBILE GmbH** does not assume any liability for damage caused by improper use. The warranty expires in the event of improper use.

WARRANTY

You can find the warranty conditions at www.isafe-mobile.com/en/support/service.

For any damage caused by computer viruses that you download while using the Internet functions responsibility is at your hand.

There is no right of recourse against **i.safe MOBILE GmbH**.

EU DECLARATION OF CONFORMITY

You will find the EU declaration of conformity at the end of this Operating Manual or at www.isafe-mobile.com/en/support/downloads.

EX MARKINGS

› ATEX:

Ⓜ II 3G Ex ic IIC T4 Gc

Ⓜ II 3D Ex ic IIIC T135°C Dc

EU Type Examination Certificate:

EPS 21 ATEX 1 126 X

CE-designation: CE

› IECEx:

Ex ic IIC T4 Gc

Ex ic IIIC T135°C Dc

IECEx Certificate: IECEx EPS 21.0043X

› Temperature range:

-10°C ... +60°C (EN/IEC 60079-0)

-10°C ... +50°C (EN/IEC 62368-1)

› Manufactured by:

i.safe MOBILE GmbH

i_Park Tauberfranken 10

97922 Lauda-Koenigshofen

Germany

> DEVICE OVERVIEW/FUNCTIONS



- 1) **3.5 MM AUDIO JACK:** Connect to the 3.5mm headphone or the 3.5mm wired hand microphone.
- 2) **FUNCTION KEY:** Optional key used by different apps.
- 3) **LED INDICATOR:** Indicates charging and notification.
- 4) **POWER KEY:** A long press switches the device on/off. A short press to turn on/off the display.
- 5) **FUNCTION KEY:** Optional key used by different apps.
- 6) **LOUDNESS CONTROL:** Volume up/Volume down.
- 7) **CURRENT APPLICATION:** Shows all open applications.
- 8) **HOME KEY:** Switch to the main screen.
- 9) **BACK KEY:** Go to the previous screen.
- 10) **MICROPHONE:** Use for calling
- 11) **LOUDSPEAKER**
- 12) **USB INTERFACE:** Connection for the Type C USB Cable or for connection to other devices.
- 13) **REAR CAMERA.**
- 14) **MICROPHONE:** Noise reduction microphone for hands-free calls
- 15) **BELT CLIP**
- 16) **CHARGING CONTACTS**

SAFETY

Read the “Safety” section of this Operating Manual carefully before using the device. If you do not follow these instructions or do not understand them, this could lead to death, severe injuries and damage to the device.

USER

Only trained users who are qualified in the use of Ex devices in explosion hazardous areas and who have read and understood this Operating Manual may use this device.

USE IN EXPLOSION HAZARDOUS AREAS

DANGER

Improper use can result in death or severe injuries!

- » Only use the device in explosion hazardous areas of zones 2/22 or outside of explosion hazardous areas.
- » Before entering a explosion hazardous area with the device,
 - make sure that only approved accessories are connected to the device, see section “Connecting approved accessories”,
 - make sure that no gap can be seen between the two halves of the device,
 - make sure the device is not damaged,
 - make sure that all the labels on the device are readable,
 - make sure the battery is screwed tight.
- » If you use the device in a explosion hazardous area, read and follow the instructions in the “Possible User Errors” section.
- » Switch off the device immediately and leave the explosion hazardous area without delay if
 - malfunctions occur on the device,
 - you have damaged the housing of the device,
 - you have exposed the device to excessive loads,
 - the labels on the device are no longer readable.

USE OUTSIDE OF EXPLOSION HAZARDOUS AREAS

DANGER

Improper use can result in death or severe injuries!

- » Do not use the device in places where its use is prohibited.
- » Turn off the device in clinics or other medical facilities.
- » Always keep a safety distance of at least 15 cm between the device and a pacemaker or hearing aid. The device can affect the functioning of medical devices such as pacemakers and hearing aids.
- » Make sure the volume level is not set at an excessive level when connecting earphones and headphones to protect your hearing.
- » When using the device while driving a motor vehicle, be sure to comply with applicable national laws.
- » Make sure you prevent the user errors described in the section entitled “Possible User Errors”.
- » Only charge the device as described in the “Charging” section.



NOTICE

Incorrect use can damage the device.

- » Only use accessories approved by **i.safe MOBILE**, as described in the section on "Connecting approved accessories".
- » Protect the device and the Adapter from strong electrical magnetic fields as for example those emitted by induction cookers or microwave ovens, for example.
- » Do not touch the display with sharp objects.

» POSSIBLE USER ERRORS

DANGER

Improper use can result in death or severe injuries! Follow the instructions below:

- » Do not modify the device structurally.
- » Do not expose the device to high temperatures.
- » Do not expose the device to strong UV radiation.
- » Do not expose the device to processes with high electrical charges.
- » Do not expose the device to aggressive acids or bases.

When working in explosion hazardous areas, please note:

- » Do not loosen the screws on the device.
- » Do not connect any accessories to the device.
- » Do not open any interface cover.
- » Do not charge the device.
- » Do not open the device.
- » Do not damage the device.

» SCOPE OF DELIVERY

Your device packaging contains the following:

- » 1 x **IS360.2**
- » 1 x Battery
- » 1 x Quick Start Manual
- » 1 x Safety Instructions
- » 1 x Display Protection Foil
- » 1 x Type C USB Cable
- » 1 x Adapter universal (power supply and various country-specific power adapters)
- » 1 x Screwdriver
- » 1 x Display cleaning cloth

CELL BROADCAST

The device supports cell broadcast. Cell broadcast is a cellular service for sending messages to all recipients within a cell.

» INSTALLING THE BATTERY

⚠ DANGER

Installing the wrong battery in the device, poses a risk of explosion, which could result in death or serious injuries! Only fit the battery supplied or an approved replacement battery in the device outside of explosion hazardous areas. The approved replacement battery can be found on the website www.isafe-mobile.com/en/products.

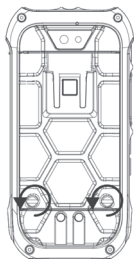

- » Loosen the screws on the battery compartment using the Screwdriver provided.
- » Remove the battery compartment cover.

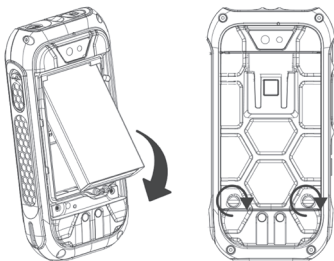

- » Place the battery in the battery compartment as shown.
- » Check that the battery is seated correctly and securely.
- » Reinstall the battery compartment cover and hand-tighten the screws using the Screwdriver provided.

» INSERT/REMOVE SIM CARD/MICROSD CARD

⚠ DANGER

An incorrect procedure in explosion hazardous areas poses a risk of death or severe injuries! Only open the device outside of explosion hazardous areas to insert or remove the SIM card.

NOTICE

Proceeding incorrectly when inserting/removing the SIM card/ SD card can damage the device and the SIM card/SD card. Switch off the device before inserting or removing a SIM card/ SD card. Do not charge the device while inserting or removing a SIM card.

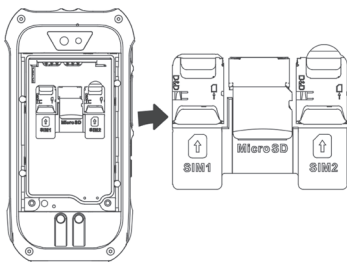

- » Loosen the screws on the battery compartment using the Screwdriver provided.
- » Remove the battery compartment cover.
- » Remove the battery from the battery compartment.
- » Insert the SIM card/SD card into the slot. The slot is marked „SIM“ and „Micro SD“.
- » Reinstall the battery. See section “Installing the battery”.

» CHARGING

⚠ DANGER

An incorrect procedure in explosion hazardous areas poses risk of death or severe injuries! Only charge the device outside of explosion hazardous areas. Do not charge the device in the vicinity of flammable substances.

NOTICE

Incorrect charging can cause damage to the device. Please note the following when charging:

- » Only charge the device using the Type C USB Cable supplied.
- » Only charge the device at ambient temperatures between +5 °C to +35 °C (+41 °F to +95 °F).
- » Charge the device under dry indoor conditions only.
- » Do not charge the device in environments dusty or humid.

Your device package contains a power supply, various country-specific power adapters and an Type C USB Cable.

- » Connect the power adapter suitable for your country to the power supply.
- » Connect the Type C USB Cable to the power supply.
- » Connect the Type C USB Cable to the USB interface of the device.

» SWITCHING ON/OFF

- » Press and hold the on/off key for about 3 seconds.
- » Enter the device or SIM PIN when the input dialog for the device or SIM PIN appears after switching on.
- » Select the <Switch off> menu item if the power off menu appears when switching off.

» USING THE DEVICE

- » When turning on the device for the first time, follow the instructions on the screen.

Further information on operating the device can be found at

www.isafe-mobile.com/en/support/service under the menu item "FAQ".

Detailed information on operating the Android operating system can be found at:

<https://support.google.com/android>.

» CONNECTING APPROVED ACCESSORIES

- » Only connect accessories approved by **i.safe MOBILE** to the device. Accessories approved by **i.safe MOBILE** can be found at **www.isafe-mobile.com/en/products**.

Approved accessories can be connected to the USB interface.

USB INTERFACE

DANGER

Improper use can result in death or severe injuries! Only use USB interface outside of explosion hazardous areas. Under no circumstances should you open the cover of the USB interface in explosion hazardous areas.

The USB interface is used for charging and data transfer.

- » Connect approved accessories or other devices to the USB interface only by using the Type C USB Cable.

› CHANGING THE BATTERY

⚠ WARNING

If you replace the battery with the wrong battery in the device, there is a risk of explosion, which could result in death or serious injuries! Only replace the battery with an approved replacement battery outside of explosion hazardous areas. An approved replacement battery can be found on the website www.isafe-mobile.com/en/products.

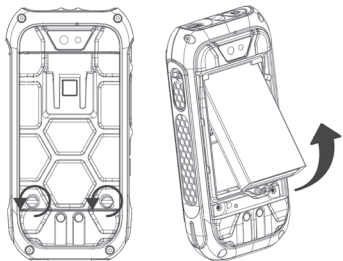

- ›› Loosen the screws on the battery compartment using the Screwdriver provided.
- ›› Remove the battery compartment cover.
- ›› Remove the battery from the battery compartment.

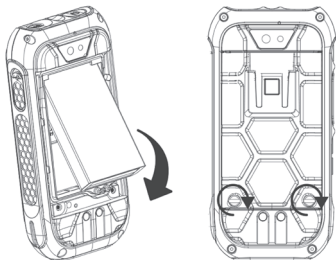

- ›› Place the approved replacement battery in the battery compartment.
- ›› Check that the battery is seated correctly and securely.
- ›› Reinstall the battery compartment cover and hand-tighten the screws using the Screwdriver provided.

› POSSIBLE DEVICE PROBLEMS

You can find information on possible device problems and how to rectify them at www.isafe-mobile.com/en/support/service under the menu item "FAQ".

If you have any further questions, please contact the **i.safe MOBILE** repair service at www.isafe-mobile.com/en/support/service.

› MAINTENANCE/REPAIR

The device itself has no serviceable parts.

⚠ WARNING

Incorrect repairs present a risk of explosion or fire, which can result in death or severe injuries! Do not open the device or carry out any repairs yourself.

› Contact the **i.safe MOBILE** repair service at www.isafe-mobile.com/en/support/service if the device is not working normally, if the device needs to be repaired or if a replacement part is required.

RETURN SHIPMENT

Contact the **i.safe MOBILE** repair service at www.isafe-mobile.com/en/support/service.

› DISTRIBUTION PARTNER

You can find the specialist distribution partner responsible for your country at www.isafe-mobile.com/en/contact.

› CLEANING

NOTICE

Incorrect cleaning can cause damage to the device. Please note the following when cleaning:

- › Turn off the device before cleaning.
- ›› Do not charge the device while cleaning.
- ›› Do not use chemical agents for cleaning.
- ›› Clean the device and the Adapter with a soft, moistened antistatic cloth.
- ›› Clean the display screen regularly with a soft, antistatic cloth.

› STORAGE

NOTICE

Incorrect storage can cause damage to the device. Store the device at ambient temperatures between +5 °C to +35 °C (41 °F to +95 °F) and a humidity between 10 % to 60 %.

› RECYCLING

NOTICE

Incorrect disposal of electronic products, batteries and packaging material puts the environment at risk. Please note the following when disposing of items:

- ›› DO NOT throw away batteries with household waste.

» Always dispose electronic products, batteries and packaging material at the appropriate collection points. This way, you prevent uncontrolled waste disposal and promote the recycling of material resources.

You can obtain further information from regional waste disposal companies, state authorities or the **i.safe MOBILE** service centre responsible for your country or region at www.isafe-mobile.com/en/support/service.

» TRADEMARKS

i.safe MOBILE and the **i.safe MOBILE** logo are registered trademarks of the **i.safe MOBILE GmbH**.

EEA Version: Comes with the Google™ app and Google Chrome™
Google and Google Play are trademarks of Google LLC.

All other trademarks and copyrights are the properties of their respective owners.

MAXIMUM OUTPUT POWER

Frequency bands	Maximum output power
GSM 850	32.00 dBm
GSM 900	32,72 dBm
GSM 1800	28,28 dBm
GSM 1900	29,66 dBm
W1	21,32 dBm
W2	21,43 dBm
W4	21,86 dBm
W5	22,38 dBm
W8	22,52 dBm
LTE band 1	21,51 dBm
LTE band 2	21,95 dBm
LTE band 3	22,48 dBm
LTE band 4	22,48 dBm
LTE band 5	22,69 dBm
LTE band 7	21,38 dBm 21.51 fcc
LTE band 8	22,69 dBm
LTE band 20	22,88 dBm
LTE band 28	23,21 dBm
LTE band 38	22,91 dBm
LTE band 40	22,92 dBm 22.95 fcc
LTE band 41	22,82 dBm 22.87 fcc
BT	5.83 (EIRP) dBm
WiFi	17.60 (EIRP) dBm
NFC (13.56 MHz)	54.44 (dB μ V/m)

Restrictions in the 5 GHz band:

According to Article 10 (10) of Directive 2014/53/EU, the packaging shows that this radio equipment will be subject to some restrictions when placed on the market in Belgium (BE),- Bulgaria (BG), the Czech Republic (CZ), Denmark (DK), Germany (DE), Estonia (EE), Ireland (IE), Greece (EL), Spain (ES), France (FR), Croatia (HR), Italy (IT), Cyprus (CY), Latvia (LV), Lithuania (LT), Luxembourg (LU), Hungary (HU), Malta (MT), Netherlands (NL), Austria (AT), Poland (PL), Portugal (PT), Romania (RO), Slovenia (SI), Slovakia (SK), Finland (FI), Sweden (SE), the United Kingdom (UK), Turkey (TR), Norway (NO), Switzerland (CH), Iceland (IS), and Liechtenstein (LI). The WLAN function for this device is restricted to indoor use only when operating in the 5150 to 5350 MHz frequency range.

	AT	BE	BG	CH	CY	CZ	DE
	DK	EE	EL	ES	FI	FR	HR
	HU	IE	IS	IT	LI	LT	LU
	LV	MT	NL	PL	PT	RO	SE
	SI	SK	TR	UK			

CONTACT/SERVICE CENTER

FOR FURTHER QUESTIONS PLEASE CONTACT OUR SERVICE CENTER:

- » **i.safe MOBILE GmbH**, i_Park Tauberfranken 10, 97922 Lauda-Koenigshofen, Germany
- » **support@isafe-mobile.com**
- » **<https://support.isafe-mobile.com>**

EU DECLARATION OF CONFORMITY

EU – Declaration of Conformity

EU – Konformitätserklärung

according to directive 2014/34/EU, 2014/53/EU, 2012/19/EU, 2011/65/EU (2015/863/EU)
nach Richtlinie 2014/34/EU, 2014/53/EU, 2012/19/EU, 2011/65/EU (2015/863/EU)

The company i.safe MOBILE GmbH declares under its sole responsibility that the product to which this declaration relates is in accordance with the provisions of the following data, directives and standards:

Die Firma i.safe MOBILE GmbH erklärt in alleiniger Verantwortung, dass Ihr Produkt auf welches sich diese Erklärung bezieht, den nachfolgenden Daten, Richtlinien und Normen entspricht:

Name & address of the manufacturer in the EU <i>Name & Anschrift des Herstellers innerhalb der europäischen Gemeinschaft</i>	i.safe MOBILE GmbH i_Park Tauberfranken 10 97922 Lauda – Koenigshofen, Germany
Description of the devices <i>Beschreibung der Geräte</i>	Smartphone type / Typ: IS360.2 model / Modell: M360A01 <i>Adapter model:</i> ICP12-050-2000B (Input: AC100-240V 50/60Hz 0.3 A, Output: DC 5V, 2A); Manufacturer: SHENZHEN SHI YINGYUAN POWER SUPPLY TECHNOLOGY CO., LTD.; <i>Battery Model:</i> MBP360A01, Capacity: 3000mAh/3.8V Manufacturer: ZHUHAI SUNDA TECHNOLOGY CO.,LTD.; <i>Software version:</i> RG360_Overseas_1.0.0.0.0_3_20200810USB <i>Cable:</i> Type-C, USB-1m
Ex – marking <i>Ex – Kennzeichnung</i>	Ⓜ II 3G Ex ic IIC T4 Gc Ⓜ II 3D Ex ic IIIC T135°C Dc
Type examination certificate 2014/34/EU issued by <i>Baumusterprüfbescheinigung 2014/34/EU ausgestellt durch</i>	EPS 21 ATEX 1 126 X Bureau Veritas Consumer Product Services Germany GmbH Businesspark A96 86842 Tuerkheim, Germany Notified Body Number / <i>Kenn-Nummer:</i> 2004
Applied harmonized standards <i>Angewandte harmonisierte Standards</i>	EN IEC 60079-0:2018; EN60079-11:2012

EU DECLARATION OF CONFORMITY

<p>Conformity statement 2014/53/EU; 2012/19/EU issued by <i>Konformitätsaussage 2014/53/EU; 2012/19/EU ausgestellt durch</i></p> <p>Applied harmonized standards <i>Angewandte harmonisierte Standards</i></p>	<p>Notified Body: PHOENIX TESTLAB GmbH Koenigswinkel 10 32825 Blomberg Germany identification number / <i>Kenn-Nummer</i>: 0700</p> <p>ETSI EN 301 489-1 V2.2.3; Draft ETSI EN 301 489-3 V2.1.2 ETSI EN 301 489-17 V3.2.4; Draft ETSI EN 301 489-19 V2.2.0; Draft ETSI EN 301 489-52 V1.1.2; ETSI EN 301 511 V12.5.1; ETSI EN 301 908-1 V13.1.1; ETSI EN 301 908-2 V13.1.1; ETSI EN 301 908-13 V13.1.1; ETSI EN 300 330 V2.1.1; ETSI EN 300 328 V2.2.2; ETSI EN 301 893 V2.1.1; ETSI EN 300 440 V2.2.1; ETSI EN 303 413 V1.1.1; EN 50360:2017; EN 50566:2017; EN 50663:2017 EN 62209-1 :2016; EN 62209-2:2010+AMD1:2019; EN IEC 62368-1:2020+A11:2020; EN 50332-2:2013;</p>
<p>Conformity statement 2015/863/EU amending 2011/65/EU issued by <i>Konformitätsaussage 2015/863/EU ergänzt 2011/65/EU ausgestellt durch</i></p> <p>Applied harmonized standards <i>Angewandte harmonisierte Standards</i></p>	<p>PHOENIX TESTLAB GmbH Koenigswinkel 10 32825 Blomberg Germany</p> <p>IEC 62321-2: 2013; IEC 62321-1: 2013; IEC 62321-3-1: 2013; IEC 62321-5: 2013; IEC 62321-4: 2013 + A1: 2017; IEC 62321-7-1: 2015; IEC 62321-7-2: 2017 & ISO 17075-1: 2017; IEC 62321-6: 2015; IEC 62321-8: 2017</p>
<p>CE Marking <i>CE-Kennzeichnung</i></p>	<p>CE</p>

IC Statement for i.safe MOBILE IS360.X (Model M360A01)

This device complies with Industry Canada licence-exempt RSS standard(s)

Operation is subject to the following two conditions:

- (1) This device may not cause interference, and
- (2) This device must accept any interference, including interference that may cause undesired operation of the device.

This equipment complies with IC radiation exposure limits set forth for an uncontrolled environment. End user must follow the specific operating instructions for satisfying RF exposure compliance. This transmitter must not be co-located or operating in conjunction with any other antenna or transmitter.

These requirements set a SAR limit of 1.6 W/kg averaged over one gram of tissue. The highest SAR value for this model phone when tested for use at the ear is 1.15 W/Kg and when worn on the body is 0.952 W/Kg. The maximum scaled SAR in hotspot mode is 0.952 W/Kg. This device was tested for typical body-worn operations. To comply with RF exposure requirements, a minimum separation distance of 15 mm must be maintained between the user's body and the handset, including the antenna. Third-party belt-clips, holsters, and similar accessories used by this device should not contain any metallic components. Body-worn accessories that do not meet these requirements may not comply with RF exposure requirements and should be avoided. Use only the supplied or an approved antenna.

Le présent appareil est conforme aux CNR d'Industrie Canada applicables aux appareils radio exempts de licence.

Ce dispositif est conforme aux normes autoriser-exemptes du Canada RSS d'industrie L'exploitation est autorisée aux deux conditions suivantes:

- (1) l'appareil ne doit pas produire de brouillage, et
- (2) l'utilisateur de l'appareil doit accepter tout brouillage radioélectrique subi, même si le brouillage est susceptible d'en compromettre le fonctionnement.

Cet équipement est conforme avec l'exposition aux radiations IC définies pour un environnement non contrôlé. L'utilisateur final doit respecter les instructions de fonctionnement spécifiques pour satisfaire la conformité aux expositions RF. Cet émetteur ne doit pas être co-localisées ou opérant en conjonction avec une autre antenne ou transmetteur.

Ces exigences définissent la valeur SAR limite à 1.6 W/kg en moyenne par gramme de tissu. La valeur SAR la plus élevée pour ce modèle de téléphone testé à l'oreille est 1.15 W/Kg et lorsque porté sur le corps est 0.952 W/Kg. l'échelle maximale sar en mode hotspot est de 0.952 W/kg Cet appareil a été testé pour des opérations portés sur le corps typiques. Pour se conformer aux exigences d'exposition aux radiofréquences, une distance minimale de 15 mm doit être maintenue entre le corps de l'utilisateur et le combiné, y compris l'antenne. Les pinces de ceinture, les étuis et autres accessoires similaires utilisés par cet appareil ne doivent pas contenir de composants métalliques. Les accessoires portatifs qui ne répondent pas à ces exigences peuvent ne pas se conformer aux exigences d'exposition RF et doit être évitée. Utilisez uniquement l'antenne fournie ou une antenne approuvée.



WWW.ISAFE-MOBILE.COM