

# R.35

## User Manual



## **Disclaimer**

Some content and services accessible through this mobile phone device belong to third parties and are protected by copyright, patent, trademark and or other intellectual laws.

Third Party services may be terminated or interrupted at any time. Revel Mobile does not bear any responsibility or authority for the warranty or usage of these applications.

Never attempt to disassemble your phone. You alone are responsible for how you use your phone and any consequences of its use.

## **Revel Mobile, LLC**

© February 2014 by Revel Mobile, LLC.  
All rights reserved.

---

## Table of Contents

<b>1</b>	<b>Safety</b>	<b>5</b>
1.1	Safety Precautions	5
1.2	Operational Warnings	5
<b>2</b>	<b>Getting Started</b>	<b>8</b>
2.1	Your Phone	8
2.2	Icons and Descriptions	8
2.3	Inserting & Removing the Battery	9
2.4	Charging the Battery	9
2.5	Inserting & Removing SIM Cards	10
2.6	Inserting & Removing SD Card Memory	10
<b>3</b>	<b>Using Your Phone</b>	<b>11</b>
3.1	Powering ON/OFF	11
3.2	Displaying the Main Menu	11
3.3	Making a Call	11
3.4	Answering a Call	11
3.5	Using the Notification Panel	11
3.6	Creating a New Home Screen	12
3.7	Customizing the Home Screen	12
3.8	Moving Icons on the Home Screen	12
3.9	Deleting Icons on the Home Screen	12
3.10	Changing Wallpaper	12
3.11	Installing APK through File Manager	13
3.12	Phone Applications	13
3.13	Wi-Fi	17
3.14	Typing	17
3.15	Cut, Copy, and Paste	17
<b>4</b>	<b>Taking Care of Your Phone</b>	<b>18</b>
<b>5</b>	<b>Safety, Regulatory &amp; Legal</b>	<b>19</b>
5.1	FCC Notice	19

## 5.2 SAR Notice

20

# 1 Safety

## 1.1 Safety Precautions



Please read these precautions carefully and follow them to prevent danger or the violation of laws.

### SAR Value

- Your mobile phone device complies with applicable safety requirements for exposure to radio waves. Radio wave exposure guidelines employ a unit called Specific Absorption Rate (SAR) measured in Watts per Kilogram averaged over a 6-minute period and taken over a volume containing a 1 gram mass of human tissue. The recommended SAR limit for a mobile handset is 1.6 W/Kg. The highest SAR value for the R.35 mobile phone model is 1.08 Watt/Kg.
- Use your phone when the signal strength is good. Keep your calls short or, instead, use a headset or send a text message. This advice applies especially to children, adolescents, and pregnant women.
- If you are using a Bluetooth headset device, please make sure it has a low power emitter.

## 1.2 Operational Warnings



### On The Road

Using a phone while driving may cause distraction and may be prohibited or restricted in certain areas. Please follow local laws and drive safely at all times.



### While Flying

Your phone can cause interference with aircraft equipment. If airline personnel instruct you to switch off your phone or disable its wireless functions, please comply.



## Near Sensitive Electronics

Don't use your phone near sensitive electronic equipment, particularly medical devices such as pacemakers or defibrillators, as it could cause them to malfunction. It can also interfere with the operation of fire detectors and other automatic-control equipment.

For more information about how your phone affects pacemakers or other electronic equipment, please contact the manufacturer or your healthcare provider.

Your phone may cause interference when used near TVs, radios, or automated office equipment.



## In a Hospital

Your phone may interfere with the normal operation of medical equipment. Follow all hospital regulations and turn it OFF when medical staff asks or when warnings are posted.



## At a Fueling Station

Don't use your phone at fueling stations. Switch off your phone whenever you're near fuels, chemicals, or explosives.



## Around Water

Keep your phone away from water (or any other liquid). This phone model is not waterproof.



## Making Repairs

Never take your phone apart. Please leave that to the professionals. Unauthorized repairs could void your warranty.



## Around Children

Keep your phone and accessories out of children's reach. These products are not toys, and failure to observe this precaution could result in injury.



## Original Accessories

Only use the original accessories supplied with your phone or those approved by the manufacturer. Using unapproved accessories may affect performance, void the warranty, or even cause injury.



## Near Explosives

Do not use or charge your phone in or near areas where explosive materials are used. Obey all signs and turn off your phone when requested.



## Emergency Calls

To make an emergency call, your phone must be turned ON and in an area with network coverage. You should not rely solely on your phone for emergency communications as it has limitation and may not work in your area.



## Working Temperature

Working temperatures for the phone are from 32° to 104° F (0° to 40° C). Please don't use the phone in temperatures exceeding 104° F (40° C) and below 32° F (0° C) as this could cause damage to the phone and shorten battery life.



## Safe Audio Volume

Prolonged listening to a phone at very high volume can damage your hearing. Use only compatible receivers or earphone accessories with your phone. Check the audio volume before inserting anything into your ear.

## 2 Getting Started

### 2.1 Your Phone



### 2.2 Icons and Descriptions

 NETWORK SIGNAL	 CALL
 SPEAKER ON	 BATTERY CAPACITY
 IN CALL	 UNREAD SMS
 VIBRATE	 USB STORAGE ON
 WI-FI ON	 AIRPLANE MODE
 MISSED CALLS	 ALARM CLOCK ON



## 2.3 Inserting & Removing the Battery

### Inserting the Battery

1. Open the battery cover on the back of your phone.
2. Align the battery's contact points with those of the phone and gently press the battery down into place.
3. Replace the battery cover and click it back into position.

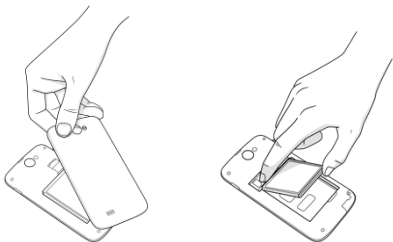

### Removing the Battery

1. Switch OFF your phone.
2. Gently lift the battery cover and open.
3. Lift the battery up and out of your phone.

## 2.4 Charging the Battery

The rechargeable Li-ion battery that comes with your phone is ready to be used, but is not fully charged. To charge your battery, follow these steps:

1. Connect the charger to your phone, and plug the charger into an electrical outlet. The battery indicator in the corner of the screen will scroll when charging.
2. When fully charged, the battery indicator will stop scrolling. Disconnect the charger from your phone, and unplug the charger.

## 2.5 Inserting & Removing SIM Cards

### Installing the SIM card

Your phone supports two SIM cards. SIM slot one is labeled **WCDMA/GSM**. If your SIM card supports data it must be placed in the WCDMA/GSM slot for it to be used.

- 1) Remove the battery if it is installed.
- 2) Locate the SIM card slot, and then insert the SIM card with its gold contacts facing down and its cut-off corner facing out from the card slot.
- 3) Slide the SIM card completely into the slot.

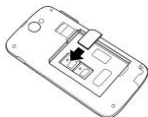

## 2.6 Inserting & Removing SD Card Memory

### Installing the SD Memory Card

To store images, videos, music, and files, you can purchase a memory card and install it into your phone.

- 1) Make sure that your phone is turned OFF, and then remove the back cover.
- 2) Remove the battery if it is installed.
- 3) Locate and insert the memory card into the slot according to the indication icon seen on the diagram.

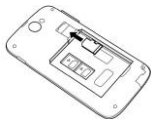

Note: make sure the phone's power is OFF before inserting or removing the SIM or memory card to avoid damages.

## 3 *Using Your Phone*

### 3.1 Powering ON/OFF

Press the **Power** key to power the phone ON or OFF.

When you turn your phone ON, it will automatically check the SIM and register your phone on the network. Follow the initial on-screen instructions to setup your phone.



### 3.2 Displaying the Main Menu

In Idle mode, press the **Menu** key to display the Main menu and press one of the Main menu options to select it:





**Wallpaper, Manage Apps, or System Settings.**

Press the **Back** key to return to the previous menu, and press the **Home** key to return to the Home screen.

### 3.3 Making a Call

Calling someone with your phone is quick and easy. Either enter the phone numbers with the keypad, or retrieve a saved contact from your phonebook. When the right number or contact number is displayed, press the **Call** icon (  ) to initiate the call. Press **End Call** (  ) when the call is finished.

### 3.4 Answering a Call

An incoming call will cause the call icon (  ) to display. To accept the call, drag the phone icon to the right (  ), or decline the call by dragging the phone icon to the left (  ). To send a text, drag the phone icon up (  ).

### 3.5 Using the Notification Panel

New notifications or alerts appear in the **Notification** bar. Slide the bar down to view the contents of a notification.

## 3.6 Creating a New Home Screen

The main Home screen extends to the left and right to provide more space for newly added shortcuts and tools.

Slide your finger horizontally on the main Home screen to move to the left or right. The dots above the **Apps** icon will indicate which screen you are viewing.

## 3.7 Customizing the Home Screen

To customize the Home screen and add icons or widgets, press and hold an app or widget icon within the

**Apps** or **Widgets** menu until it's enlarged and the phone vibrates. This copies the icon from the Apps or Widgets Menu to the Home screen you select.

## 3.8 Moving Icons on the Home Screen

1. Press and hold the icon on the Home screen until it's enlarged.
2. Drag the icon to the desired position and then release it.

## 3.9 Deleting Icons on the Home Screen

1. Press and hold the icon on the Home screen until it's enlarged.
2. Drag the icon to **Remove** to delete it.

## 3.10 Changing Wallpaper

1. Press and hold an empty spot on your Home screen to open the wallpaper menu.
2. Choose the wallpaper and press **Set wallpaper** to complete.

## 3.11 Installing APK through File Manager

APK is a supported file format for the Android mobile operating system.

1. Copy the downloaded APK file into the SD card
2. Insert the SD card into the phone.
3. In Idle mode, tap the **Apps** icon and then tap **File Manager** to display the directory of the SD card.
4. Select the APK file you wish to install, and follow the instructions displayed by the installation wizard.

## 3.12 Phone Applications

Tap the **Apps** icon (  ) to view a list of features available in your phone. Tap each icon to perform the function.

### Browser

To browse the Internet. Default search engine is Google.

### Calculator

To make calculations quickly.

### Calendar

To view the calendar and add events.

### Clock

To set a timer or the Alarm clock.

### Contact

To access your phonebook and see your list of contacts.

## Camera

To take pictures or videos and store them under the Gallery folder. To record videos: in Camera, choose Camcorder.

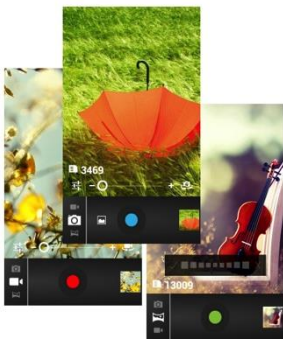

## Email

To set up your POP/IMAP/Exchange email accounts.

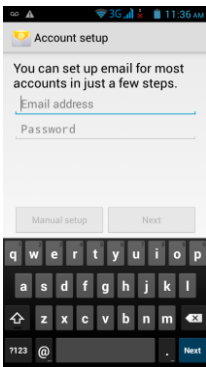

## File Manager

To install the files in APK format and view your files.

## Gallery

To save and view photos and videos.

## Play Store

To access thousands of applications available under the Google Market called **Play Store** by logging into your Gmail account (requires Internet connection).

## Messaging

To view messages sent and received.

## Music

To view the list of songs available in your phone. You can view the artists, albums, playlists and more.

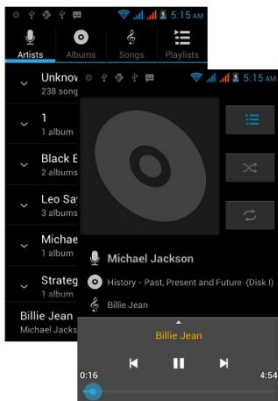

## Phone

To quickly make outgoing calls.

## Settings

To modify settings for any of the following:

- Wi-Fi
- Bluetooth
- Data Usage
- SIM Management
- Audio Profiles
- Display
- Storage
- Battery
- Apps
- Accounts
- Location Access
- Security
- Language & Input
- Backup & Reset
- Date & Time
- Accessibility

## Sound Recorder

To record your message.

## Video Player

To view your collection of videos.





## 3.13 Wi-Fi

Your phone supports Wi-Fi which allows you to connect with a wireless local area network.

### To Connect to WIFI

1. Enter the **Settings** interface (**Menu > System settings**).
2. Search and select the Wi-Fi or network to be connected.
3. Enter the username and password, if required.

## 3.14 Typing

Enter text by pressing letter symbols on the intelligent keyboard. Your phone automatically corrects and suggests words as you type on the intelligent keyboard.

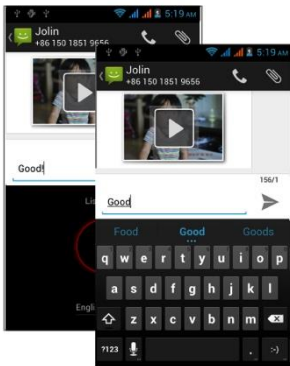

## 3.15 Cut, Copy, and Paste

It is very easy to copy text from web pages, email, or text messages. Touch and hold text content to bring up the selector arrows, and then slide your finger to highlight the text. You can choose to select all, cut, copy, or paste.

## 4 *Taking Care of Your Phone*

Your phone is a product of superior design and craftsmanship and should be handled with care. The following suggestions will help you protect your phone:

- Always keep the phone and small accessories away from children.
- Do not drop, knock, or shake the phone. Rough handling can break internal circuit boards and fine mechanics.
- Keep the phone dry. Precipitation, humidity, and all types of liquids or moisture can contain minerals that will rust electronic circuits. If your phone gets wet, remove the battery, and allow the phone to dry completely before replacing it.
- Use phone chargers indoors.
- Do not use or store the phone in dusty, dirty areas. Dust and dirt can damage moving parts and electronic components.
- Do not use harsh chemicals, cleaning solvents, or strong detergents to clean the phone. Only use a soft, clean, dry cloth to clean the surface of the phone.
- Do not store the phone in extreme heat or cold. Extreme temperatures can shorten the life of electronic devices and damage batteries.
- Do not attempt to open the phone other than as instructed in this manual.
- Do not paint the phone. Paint can clog moving parts and prevent proper operation.

## 5 *Safety, Regulatory & Legal*

### 5.1 **FCC Notice**

NOTE: This equipment has been tested and found to comply with the limits for a Class B digital device, pursuant to part 15 of the FCC Rules. These limits are designed to provide reasonable protection against harmful interference in a residential installation. This equipment generates, uses and can radiate radio frequency energy and, if not installed and used in accordance with the instructions, may cause harmful interference to radio communications. However, there is no guarantee that interference will not occur in a particular installation. If this equipment does cause harmful interference to radio or television reception, which can be determined by turning the equipment off and on, the user is encouraged to try to correct the interference by one or more of the following measures:

- Reorient or relocate the receiving antenna.
- Increase the separation between the equipment and receiver.
- Connect the equipment into an outlet on a circuit different from that to which the receiver is connected.
- Consult the dealer or an experienced radio/ TV technician for help.

This device complies with part 15 of the FCC Rules and Industry Canada license-exempt RSS standard(s). Operation is subject to the following two conditions: (1) This device may not cause harmful interference, and (2) this device must accept any interference received, including interference that may cause undesired operation.

Caution: Changes or modifications not expressly approved by the manufacturer could void the user's authority to operate the equipment.

## 5.2 SAR Notice

THIS CELLPHONE MEETS THE GOVERNMENT'S REQUIREMENTS FOR EXPOSURE TO RADIO WAVES.

Your mobile phone is a radio transmitter and receiver. It is designed and manufactured not to exceed the emission limits for exposure to radio-frequency (RF) energy.

These limits are part of comprehensive guidelines and establish permitted levels of RF energy for the general population. The guidelines are based on standards that were developed by independent scientific organizations through periodic and thorough evaluation of scientific studies. These guidelines include a substantial safety margin designed to ensure the safety of all persons, regardless of age and health.

The exposure standard for cellphones employs a unit of measurement known as the Specific Absorption Rate, or SAR. The SAR limit set by public authorities such as the Federal Communications Commission of the US Government (FCC), or by Industry Canada, is 1.6 W/kg averaged over 1 gram of body tissue. Tests for SAR are conducted using standard operating positions with the cellphone transmitting at its highest certified power level in all tested frequency bands.

Although the SAR is determined at the highest certified power level, the actual SAR level of the cellphone while operating can be well below the maximum value. This is because the cellphone is designed to operate at multiple power levels so as to use only the power required to reach the network. In general, the closer you are to a wireless base station antenna, the lower the power output of the cellphone.

Before a cellphone model is available for sale to the public, compliance with national regulations and standards must be shown.

The highest SAR value for this model cellphone when tested for use at the ear is 1.08W/Kg @ 1 gram and when properly worn on the body is 1.00 W/Kg @ 1 gram.

To meet RF exposure guidelines during body-worn operation, the device should be positioned at least 10 mm away from the body.

While there may be differences between the SAR levels of various cellphones and at various positions, they all meet the government requirement for RF exposure. For body-worn operation, the cellphone meets FCC RF exposure guidelines provided that it is used with a non-metallic accessory with the handset at least 10 mm from the body. Use of other accessories may not ensure compliance with FCC RF exposure guidelines.

If you are using another accessory ensure that whatever product is used is free of any metal and that it positions the cellphone at least 10 mm away from the body