

0901



Product environmental impact:
- according to customer standard
- VW91101 "Prohibited and declarable substances in materials and components"
and according to customer standard VW91102 Recycling of cars
- The part or assembly has to meet or exceed the standard of Scrapped Cars EU Directive 2000/53/EG and to be free of lead, mercury, chrome 6, and cadmium

0902



Flammability:
- Proof of the non-flammability is required at the time of the initial sample presentation
- Flammability of interior parts according to: according to customer standard TL1010
- The supplier must provide the test samples for testing

0903



Print smear is not permissible.

0904



Adhesion according to >PP T40< surface.
The label shall be self-adhesive and must not become accidentally detached after application.

0905



Printed information to be resistant against environmental impact

PRELIMINARY
14-03-10

Data Matrix Code contents:

FCC ID: 2AA98A
IC: 11505A-A

JCAE Product Reference
Version
Serial Number
Date
Software Version
Hardware Version
Format:
XXXXXXXX_XX_XXXXXXXX_YYDDD_SWXXXX_HWXXX

3

XXXXXXXX XX
SN XXXXXXXX
MADE IN SLOVAKIA
FCC ID: 2AA98A
IC: 11505A-A
Model: Kombiinstrument X
YYDDD SW XXXX HW XXX

JCI Product Reference & Version
Serial Number
Country Of Production
FCC ID 3
IC ID 3
Model: Kombiinstrument 3

Hardware Version
Software Version 2
Date (Example: 09001 to 09365)

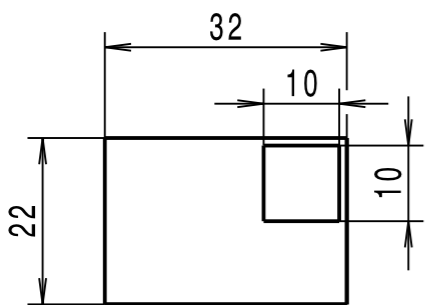

Front view
Scale: 1:1

Note:
Self adhesive label - size: 32x22 mm
Label for thermal transfer printing
Material: White Velin
Ref JCI 178058735

Text height 1.5 mm
XXXXXXXX XX
SN XXXXXXXX
FCC ID: 2AA98A 3
IC: 11505A-A
Model: Kombiinstrument 1 - for Basic
Model: Kombiinstrument 2 - for Medium
Model: Kombiinstrument 3 - for Color
YYDDD
SW XXXX
HW XXX
Gen. Tol.: ±0.2 mm

-	-	-	-	-	-	-	-
-	-	-	-	-	-	-	-
-	-	-	-	-	-	-	-
-	-	-	-	-	-	-	-
-	-	-	-	-	-	-	-
-	-	-	-	-	-	-	-
3	14-02-18	-	-	Info added: IC ID and FCC ID. Moved notes due to IC and FCC ID's	-	K.Hristov	-
2	12-07-18	5925357	5908491	Changed specification for software version	-	ID	-
1	12-02-13	5613536	5591017	Drawing creation	-	ID	-
Dwg Rev Lev	Date Datum (YY-MM-DD)	ECO-No ECO-Nr	ECR-No ECR-Nr	Revision Text Aenderungsbeschreibung Description de la Modification	Field Field Zone	Drawn Gez. Dessine par	
Record Obligation Dokumentationspflicht Archivage Obligatoire				Checked by Geprueft von Controle par	Name/Nom	Date/Datum	 Johnson Controls Automotive Electronics GmbH 40 Tsarigradsko Shouse Blvd Europark Building 1784 Sofia, Bulgaria Tel. +359 2 9306-421 Fax. +359 2 9306-462
A				Approved by Genehmigt von Approuve par	ZK/ER	14-02-18	
Scale / Massstab / Echelle 2:1				Released by Geprueft von Verifie par	HB	-	
Drawing Title / Zeichnungsbenennung / Designation plan					Drawing Number Zeichnungs Nummer Numero Plan	Revision Level Revisionsstand Revision Indice	
MQB JCI INTERNAL LABEL					2440615	3	
Part Title / Teile Benennungen / Designation piece					Part Number Teile Nummer Numero Piece	Revision Level Revisionsstand Revision Indice	
MQB JCI INTERNAL LABEL					2440615	3	
Volume/Volumen/Volume	Calculated weight/Berechnetes Gewicht/Poids calcule	Weight/Gewicht Poids mesure	Program Number / Programm Nummer Numero de programme				
- cm3	- g	-					
Finish treatment/Oberflaechen Behandlung/Traitement de surface					Effectivity Class/Entwicklungsstand Stade de Developpement		
-							
Surface finish/Oberflaechen Material/Rugosite					Development Entwicklung Developpement	Prototype Prototypen Prototype	Production Serie Serie
-					-	-	X
Material/Werkstoff/Matiere					Tolerances / Toleranz / Tolerances		
see note							
Except prior authorization given by JCAE, the reproduction, distribution and utilization of this document as well as the communication of its contents is strictly prohibited and offenders will be liable for payment of damages. All rights reserved in the event of grant of a patent, utility model or design. (Protective note of ISO 16016) Ohne die vorherige Ermächtigung durch JCAE, ist die Weitergabe sowie Vervielfältigung dieses Dokuments, Verwertung und Mitteilung seines Inhalts verboten. Zuwiderhandlungen verpflichten zu Schadenersatz. Alle Rechte fuer den Fall der Patent-, Gebrauchsmuster- oder Geschmacksmustereintragung sind vorbehalten. (Schutzvermerk aus ISO 16016) Documents proprieete de JCAE, toute reproduction ou divulgation est interdite et exposera son auteur au versement de dommages et interets. Tous droits reserves dans le cas de la delivrance d'un brevet, ou de la protection en matiere de dessins et modeles. (Propriete intellectuelle ISO 16016)					Projection / Projektion Projection		Sheet/Blatt Planche
					ISO 128-30		1/1
					CAD-System & Version Catia V5		Rev 11 January 12
© Copyright 2012 Johnson Controls, Inc. All rights reserved. Any unauthorized use or copying is strictly prohibited.							