

Remote control

General

The delivery specification includes two remote controls with integrated keys.

Each remote control contains a replaceable battery. Replacing the battery, see page 4.

The button functions can be assigned, depending on the equipment installed and the country specifications. For settings.

A driver profile with personalised settings can be assigned to a remote control.

The remote controls store servicing information. Service data in the remote control.

To prevent the remote control from being locked in, take it with you whenever you leave the vehicle.

Safety notes

WARNING

Persons remaining in the vehicle or pets left inside can lock the doors from the inside and lock themselves in. In this case, the vehicle cannot be opened from the outside. There is a danger of injury. Carry the remote control with you so that you can open the vehicle from the outside.

WARNING

For some country specifications, unlocking from the inside is only possible with special knowledge.

There is a risk of injury or danger to life if persons remain in the vehicle for extended periods and are exposed to extreme temperatures as a result. Do not lock the vehicle from the outside when there is someone inside it.

WARNING

Unsupervised children or animals in the vehicle can set the vehicle in motion and endanger themselves or other road users, for example by the following actions:

- ▷ Pressing the start/stop button.
- ▷ Releasing the parking brake.
- ▷ Opening and closing doors or windows.
- ▷ Engage selector lever position N.
- ▷ Operating vehicle equipment.

There is a risk of accidents or injury. Do not leave children or animals unsupervised in the vehicle. When leaving the vehicle, take the remote control with you and lock the vehicle.

Overview

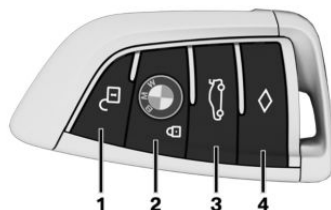

- 1 Unlocking
- 2 Locking
- 3 Opening/closing the tailgate
- 4 Function adjustable:
 - ▷ Headlight courtesy delay feature
 - ▷ Opening/closing the tailgate

Unlocking

General

The behaviour of the vehicle when unlocked with the remote control depends on the following settings for locking and unlocking:

- ▶ Whether only the driver's door and the fuel filler flap or all vehicle access points are unlocked when the button is first pressed.
- ▶ Whether the unlocking of the vehicle is acknowledged with a light signal or an acoustic signal.
- ▶ Whether the welcome light is switched on when the vehicle is unlocked.
- ▶ Whether the exterior mirrors are automatically folded out and in when the vehicle is unlocked and locked.
Exterior mirrors folded in using comfort closing must be folded out using comfort opening.

Unlocking the vehicle



Press the button on the remote control.

If only the driver's door and the fuel filler flap have been unlocked due to the settings, press the button on the remote control again to unlock the other vehicle access points.

The following functions are also carried out:

- ▶ If a driver profile has been assigned to the remote control, this driver profile is activated and the settings saved in it are configured.
- ▶ The interior light is switched on, unless it was switched off manually. Switching the interior light on/off manually.
- ▶ With anti-theft system: The anti-theft system is switched off.
- ▶ The alarm system is switched off.

The vehicle is operational after one of the front doors is opened.

The light functions might be dependent on the ambient brightness.

Comfort opening



Keep the button on the remote control pressed after unlocking.

The windows and the Glass Roof are opened for as long as the button on the remote control is pressed.

Exterior mirrors which were folded in via the comfort closing feature are folded out.

Locking

General

The behaviour of the vehicle in the case of remote control locking depends on the following settings:

- ▶ Whether the locking of the vehicle is acknowledged with a light signal or an acoustic signal.
- ▶ Whether the exterior mirrors are automatically folded in and out when the vehicle is locked/unlocked.
- ▶ Whether the headlight courtesy delay feature is activated when the vehicle is locked.

Locking the vehicle

1. Close the driver's door.
2.  Press the button on the remote control.



Following functions are carried out:

- ▶ All the doors, the tailgate and fuel filler flap are locked.
- ▶ With anti-theft system: The anti-theft system is switched on. This prevents the doors from being unlocked using the locking buttons or the door openers.
- ▶ The alarm system is switched on.

If the drive-ready state is still switched on when locking, the vehicle horn sounds twice. In this case, switch off the drive-ready state using start/stop button.

Comfort closing

Safety note

WARNING

Parts of the body can become trapped when the comfort closing feature is operating. There is a danger of injury. During comfort closing, make sure that the area of movement is kept clear.

Closing



Keep the button on the remote control pressed after locking.

The windows and the Glass Roof are closed for as long as the button on the remote control is pressed.

The exterior mirrors are folded in.

If the hazard warning lights are switched on, the exterior mirrors are not folded in.

Switching on the interior light and exterior lights



With the vehicle locked, press the button on the remote control.

The function is not available for the first 10 seconds after locking.

- ▶ The interior light is switched on, unless it was switched off manually. Switching the interior light on/off manually.
- ▶ Depending on the settings, the exterior lights are switched on.

The light functions might be dependent on the ambient brightness.

Tailgate

General

To prevent the remote control from being locked in, do not place the remote control in the boot.

The following settings are available for operating the tailgate with the remote control:

- ▶ Whether only the upper tailgate is opened or the upper and lower tailgates are opened together using the remote control.
- ▶ Whether the doors are locked when the tailgate is opened with the remote control.
- ▶  Whether it is possible to operate the tailgate using the remote control button.

Safety notes

WARNING

Operation of the tailgate can lead to parts of the body becoming trapped. There is a danger of injury. When opening and closing, make sure that the area of movement of the tailgate is kept clear.

WARNING

The tailgate swings outwards when opened. There is a danger of injury or damage to property. When opening and closing, make sure that the area of movement of the tailgate is kept clear.

NOTE

Sharp or angular objects can hit the windows and the heating conductors during the journey. There is a danger of damage to property. Cover the edges and make sure that sharp objects cannot strike the windows.

Opening



Press and hold the button on the remote control for approximately 1 second.

Or:



Press and hold the button on the remote control for approximately 1 second.

On some equipment versions, the doors are also unlocked each time.

Closing



Press and hold the button on the remote control.

Or:



Press and hold the button on the remote control.

Releasing the button stops the movement.

If the doors were not unlocked, the tailgate is locked again as soon as it is closed.

Switching on the headlight courtesy delay feature

Headlight courtesy delay feature must be set for remote control button. For settings.



Press the button on the remote control.

Setting the duration.

Replacing the battery

1. Remove the integrated key from the remote control.
2. Place integrated key under the battery compartment cover, arrow 1, and pry off the cover with a lever motion of the integrated key, arrow 2.

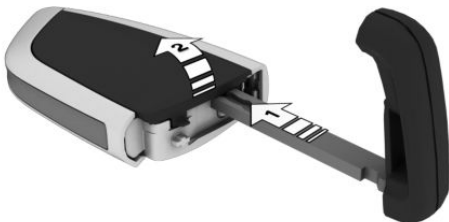

3. Use a pointed object to push the battery in the direction of the arrow and lift it out.

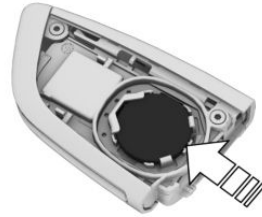

4. Insert a new type CR 2032 battery with the positive side facing upwards.
5. Press the cover back into position.



Dispose of old batteries at a Service Partner of the manufacturer or another qualified Service Partner or a specialist workshop or hand them into an authorised collecting point.

Additional remote controls

Additional remote controls are available from a Service Partner of the manufacturer or another qualified Service Partner or a specialist workshop.

Loss of remote controls

A lost remote control can be blocked and replaced by a Service Partner of the manufacturer or another qualified Service Partner or a specialist workshop.

If a driver profile has been assigned to the lost remote control, the connection to this remote control must be removed. A new remote control can then be assigned to the driver profile.

Malfunction

General

A Check Control message is shown.

It may be difficult for the vehicle to detect the remote control in some conditions, including the following:

- ▶ The battery of the remote control is discharged. Replacing the battery, see page 4.
- ▶ Disruption of the radio link by transmission masts or other equipment transmitting powerful signals.
- ▶ Shielding of the remote control by metallic objects.
Do not transport the remote control together with metallic objects.
- ▶ Disruption of the radio link by mobile telephones or other electronic devices in the immediate vicinity of the remote control.
Do not transport the remote control together with electronic devices.
- ▶ Interference with the radio transmission caused by the charging of mobile devices, for example a mobile phone.
- ▶ The remote control is located in the immediate vicinity of the wireless charging dock.
Place the remote control somewhere else.

If there is a malfunction, the vehicle can be unlocked and locked from the outside with the integrated key.

Switching on the drive-ready state via the remote control special ID feature

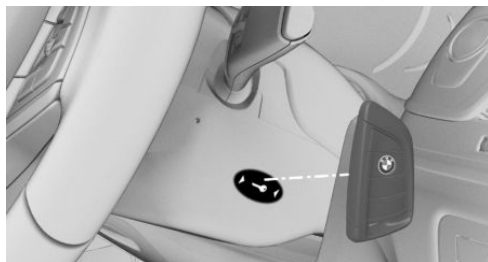

The drive-ready state cannot be switched on if the remote control has not been detected.

If this happens, proceed as follows:

1. Hold the back of the remote control against the mark on the steering column. Pay attention to the display in the instrument cluster.
2. If the remote control is detected:
Switch on drive-ready state within 10 seconds.

If the remote control is not detected, change the position of the remote control slightly and repeat the procedure.