

Comfort Access

Concept

The vehicle can be accessed without activating the remote control.

All you need to do is to have the remote control with you, such as in your pants pocket.

The vehicle automatically detects the remote control when it is in close proximity or in the car's interior.

General information

Comfort Access supports the following functions:

- ▶ Unlocking and locking the vehicle from the door handle.
- ▶ Convenient closing.
- ▶ Touchless unlocking and locking of the vehicle.
- ▶ Unlocking and locking the vehicle using the BMW Digital Key.
- ▶ Open the tailgate.
- ▶ Open and close the tailgate with no-touch activation.

Functional requirements

- ▶ To lock the vehicle, the remote control must be located outside of the vehicle near the doors.
- ▶ The next unlocking and locking cycle is not possible until after approx. 2 seconds.

Unlocking

General information

The behavior of the vehicle during unlocking via the Comfort Access depends on the following settings:

- ▶ If the unlocking of vehicle is confirmed with a light signal or a sound signal.

- ▶ If the welcome light is switched on when the vehicle is being unlocked.
- ▶ If the exterior mirrors are automatically folded out and in when the vehicle is unlocked and locked.

Unlocking the vehicle

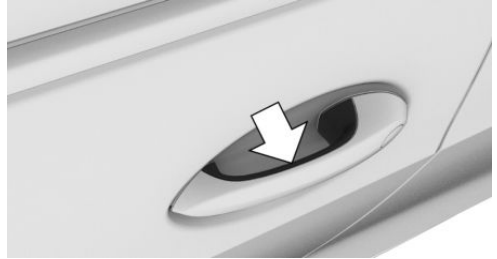

Grasp the handle of a vehicle door completely.

This corresponds with pressing the button  on the remote control.

Locking

General information

The behavior of the vehicle during locking via the Comfort Access depends on the following settings:

- ▶ If the locking of the vehicle is confirmed with a light signal or a sound signal.
- ▶ If the exterior mirrors are automatically folded out and in when the vehicle is unlocked and locked.
- ▶ If the headlight courtesy delay feature is activated during locking.

Locking the vehicle

Close the driver's door.

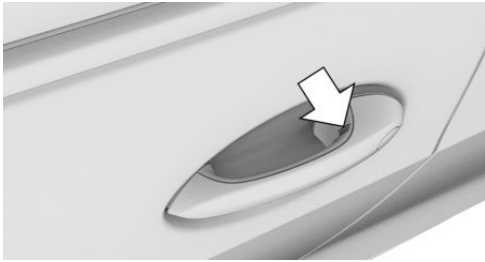

Touch the grooved surface on the handle of a closed vehicle door with your finger for approx. 1 second without grasping the door handle.

This corresponds with pressing the button  on the remote control.

Convenient closing

Safety information

WARNING

With convenient closing, body parts can be jammed. There is a risk of injury. Make sure that the area of movement of the doors is clear during convenient closing.

Closing

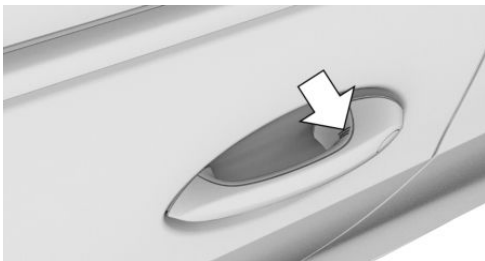

Touch the grooved surface on the handle of a closed vehicle door with your finger and hold it there without grasping the door handle.

This corresponds to pressing and holding the button  on the remote control.

In addition to locking, the windows and glass sunroof will be closed.

In addition to locking, the windows and glass sunroof will be closed.

Opening the tailgate

General information

If the tailgate is opened via Comfort Access, locked doors are not unlocked.

To avoid locking it in the vehicle, do not place the remote control in the cargo area.

Safety information

WARNING

Body parts can be jammed when operating the tailgate. There is a risk of injury. Make sure that the area of movement of the tailgate is clear during opening and closing.

WARNING

The tailgate pivots out when it opens. There is a risk of injury or risk of damage to property. Make sure that the area of movement of the tailgate is clear during opening and closing.

NOTICE

Sharp-edged or pointed objects can hit the windows and heat conductors while driving. There is a risk of damage to property. Cover the edges and ensure that pointed objects do not hit the windows.

Opening

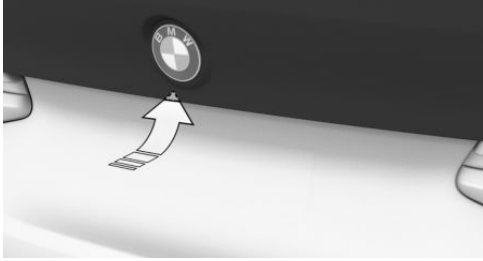

Press the button on tailgate's exterior.

Touchless opening and closing of the tailgate Without trailer hitch: touchless opening and closing of the tailgate

Concept

The tailgate can be opened and closed with no-touch activation using the remote control you are carrying. Two sensors detect a forward-directed foot motion in the central rear area and the tailgate is opened and closed.

General information

For Australia: touchless opening and closing of the tailgate is not possible with trailer hitch.

To avoid locking it in the vehicle, do not place the remote control in the cargo area.

If the remote control is in the sensor area, the tailgate can be opened or closed inadvertently by an unconscious or alleged recognized foot movement.

The sensor has an approximate range of 5 ft/1.50 m extending from the rear of the vehicle.

If the tailgate is opened with no-touch activation, locked doors are not unlocked.

You can configure if only the upper tailgate will open or if the upper and lower tailgate opens. Settings. When closing, the upper and lower tailgate will always be closed.

Safety information

⚠ WARNING

During no-touch activation, vehicle parts may be touched, such as the hot exhaust gas system. There is a risk of injury. When moving your foot, make sure you have a firm stance and do not touch the vehicle.

⚠ WARNING

Body parts can be jammed when operating the tailgate. There is a risk of injury. Make sure that the area of movement of the tailgate is clear during opening and closing.

⚠ WARNING

The tailgate pivots out when it opens. There is a risk of injury or risk of damage to property. Make sure that the area of movement of the tailgate is clear during opening and closing.

⚠ NOTICE

Sharp-edged or pointed objects can hit the windows and heat conductors while driving. There is a risk of damage to property. Cover the edges and ensure that pointed objects do not hit the windows.

Performing the foot movement

1. Stand in the middle behind the vehicle at approx. one arm's length away from the rear of the vehicle.
2. Wave a foot under the vehicle in the direction of travel and immediately pull it back. With

this movement, the leg must pass through the ranges of both sensors.

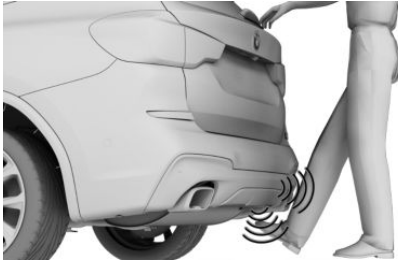

Opening

Perform the foot movement described earlier.

Perform the foot movement, refer to page 3.

Before the tailgate opens, the hazard warning system flashes.

Moving your foot again will stop the opening motion, and moving it one more time after that will close the tailgate.

Closing

Perform the foot movement described earlier.

Perform the foot movement, refer to page 3.

Before closing, the hazard warning system flashes and an acoustic signal sounds.

Moving your foot again will stop the closing motion, and moving it one more time after that will re-open the tailgate.

Touchless unlocking and locking of the vehicle

Concept

The vehicle will be unlocked automatically when the driver approaches the vehicle with the remote control.

When the driver walks away from the vehicle with the remote control, the vehicle will be locked automatically.

General information

The behavior of the vehicle during touchless unlocking and locking depends on the following settings:

- ▷ If the automatic unlocking is active.
- ▷ If the automatic locking is active.
- ▷ If only the driver's door and the fuel filler flap or all access to the vehicle will be unlocked.

Only driver's door and fuel filler flap: the driver's door and fuel filler flap will only be unlocked when the driver approaches the vehicle on the driver's side.

All vehicle entry points: the vehicle will be unlocked depending on the side on which the driver approaches the vehicle.

- ▷ If the unlocking and locking of the vehicle is confirmed with a light signal or a sound signal.
- ▷ If the welcome light is switched on when the vehicle is being unlocked.
- ▷ If the headlight courtesy delay feature is activated during locking.
- ▷ If the exterior mirrors are automatically folded out and in when the vehicle is unlocked and locked.

If the vehicle is unlocked and opened with the remote control without starting the engine, it cannot be locked touchless later.

If there is a second remote control in the car's interior during locking, it will be ignored and the vehicle is locked.

If the remote control is located in the unlocking zone for an extended period of time without movement, the vehicle will be locked automatically.

Functional requirements

- ▷ Touchless unlocking of the vehicle is possible within a radius of approximately 3 ft/1 m around the door handles.
- ▷ For touchless locking of the vehicle, the drive-ready state must be switched off.

- ▶ For touchless locking of the vehicle, all of the doors of the vehicle must be closed.
- ▶ For touchless locking of the vehicle, the seat occupancy detection must not detect a passenger on the front passenger seat and the safety belt of the front passenger must not be buckled in the safety belt buckle.
- ▶ For touchless locking of the vehicle, no second remote control can be located in the locking zone.
- ▶ Touchless locking and the anti-theft warning system will not activate until the radius of approximately 7 ft/2 m around the door handles is exited with the remote control.

BMW Digital Key

Concept

BMW Digital Key allows the vehicle to be unlocked and locked, as well as started, with a compatible smartphone.

General information

BMW Digital Key varies by country and may be unavailable.

To unlock and start a vehicle with a compatible smartphone, a digital key must be installed on this smartphone. Digital keys are installed, managed and forwarded via the BMW Connected app.

To unlock and start a vehicle with a compatible smartphone, a digital key must be installed on this smartphone. Digital keys are installed, managed and forwarded via the BMW Connected app.

A driver profile with individual settings can be assigned to a digital key.

When using a digital key, always carry a remote control with you too, so the vehicle can still be accessed even if your smartphone is not working. It is also useful to carry the remote control with you if the vehicle has to be handed over to another person or a Service Center. You can

then hand over the remote control, instead of your smartphone.

Connection to the vehicle

The communication between the vehicle and the smartphone uses near-field communication, NFC.

The vehicle is unlocked with the outside door handle of the vehicle. The smartphone must be placed into the smartphone tray to pair a digital key and to start the engine.

The vehicle also detects a digital key when the smartphone is switched off.

Functional requirements

- ▶ The BMW Connected app is installed on a compatible smartphone.
- ▶ The rechargeable battery of the smartphone has a sufficient charge. The necessary minimum charge of the rechargeable battery depends on the smartphone.
- ▶ A digital key for the vehicle is installed on the smartphone.
- ▶ BMW Digital Key is activated for the vehicle.

Activate BMW Digital Key

The vehicle owner must present proof of authorization for his vehicle at the service center to be able to use BMW Digital Key.

The vehicle owner configures a digital key code at the service center to be able to enable additional digital keys at a later time.

Purchasing digital keys

An initial digital key is provided in the BMW Connected app when the vehicle is purchased.

Additional digital keys can be purchased via the BMW ConnectedDrive Store. The purchase of digital keys can cause costs.

The period of validity of a digital key is limited. The expiration date of the validity can be checked in the BMW Connected app and in the vehicle.

If a digital key has expired, it can only still be used to unlock and lock the vehicle for a limited period of time. The corresponding information is shown on the Control Display.

Transferring digital keys

The vehicle owner can transfer a digital key for his vehicle to another person via the BMW Connected app.

When a digital key is transferred, a transaction number TAN will be generated. Another person can pair the digital key in the vehicle with this TAN and the Digital Key Code. This makes it possible to allow another person to use the vehicle without having to be at the vehicle.

The TAN and the Digital Key Code should only be disclosed in person or by phone.

The transferred digital key can be removed in the vehicle or via the BMW Connected app at any time.

If a digital key has been removed via the BMW Connected app, it can only still be used to unlock and lock the vehicle for a limited period of time. The corresponding information is shown on the Control Display.

As soon as the vehicle is used with another digital key or with a remote control, the removed digital key can no longer be used.

Pairing digital keys in the vehicle

To pair a digital key, a remote control must be located in the vehicle or an active digital key of the vehicle owner must be in the smartphone tray.

If the digital key was transferred by the vehicle owner, it may not be possible to meet this requirement. In this case, it is necessary to enter the Digital Key Code and the TAN. The vehicle can already be unlocked with the transferred digital key before it is paired.

Place the smartphone with the digital key to be paired into the smartphone tray.

Via iDrive:

1. "My Vehicle"
2. "Settings"
3. "Doors"
4. "BMW Digital Key"
5. "Add new digital key"
6. If necessary, enter the Digital Key Code and the TAN.

After the digital key has been paired, its name will be displayed in the list of digital keys.

Activating/deactivating digital keys in the vehicle

A digital key can be deactivated temporarily.

To activate or deactivate a digital key, a remote control must be located in the vehicle or an active digital key of the vehicle owner must be in the smartphone tray.

Via iDrive:

1. "My Vehicle"
2. "Settings"
3. "Doors"
4. "BMW Digital Key"
5. Select the desired digital key.
6. "Digital key active"

A deactivated digital key remains in the list of paired digital keys.

Removing digital keys in the vehicle

To remove a digital key, a remote control must be located in the vehicle or another active digital key of the vehicle owner must be in the smartphone tray. To remove all digital keys, a remote control must be located in the vehicle.

Via iDrive:

1. "My Vehicle"
2. "Settings"
3. "Doors"
4. "BMW Digital Key"

5. If necessary, select the digital key.
6. > "Remove digital key"
The digital key will be removed from the list of paired digital keys.
- > "Remove all digital keys"

Resetting BMW Digital Key

To reset BMW Digital Key, an authorized remote control must be located in the vehicle.

After the reset, the vehicle can no longer be unlocked, locked or started with a digital key.

The vehicle owner must present proof of authorization for his vehicle again at the service center to be able to use BMW Digital Key again.

Via iDrive:

1. "My Vehicle"
2. "Settings"
3. "Doors"
4. "BMW Digital Key"
5. "Reset BMW Digital Key"

Unlocking and locking the vehicle

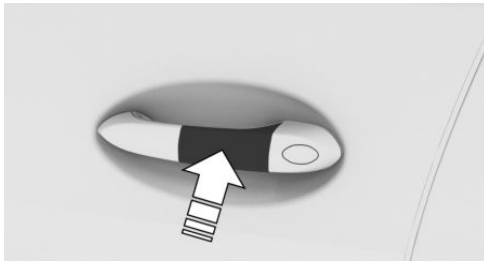

Hold the smartphone directly on the outside door handle of the driver's door.

Starting the engine

Smartphone tray without thermo-cup holder:

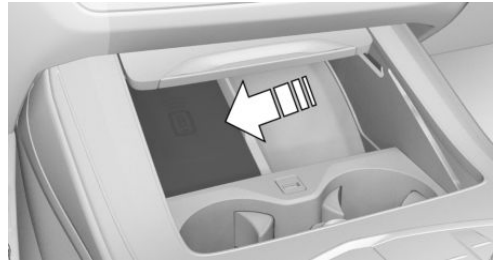

Smartphone tray with thermo-cup holder:



1. Open the cover of the smartphone tray.
2. Place the smartphone into the center of the smartphone tray in front of the cup holders.
3. After the digital key has been detected as authorized, the engine can be started.

Sale of the smartphone/vehicle

When a smartphone with a digital key will be sold, all digital keys should be deleted from this smartphone.

When a vehicle is sold, BMW Digital Key should be reset in this vehicle. The new vehicle owner should make sure that BMW Digital Key has been reset. This ensures that the previous vehicle owner no longer has access to the vehicle.

Malfunction

Remote control detection by the vehicle may malfunction under the following circumstances:

- > The battery of the remote control is discharged. Replacing the battery.
- > Interference of the radio connection from transmission towers or other equipment with high transmitting power.

- ▶ Shielding of the remote control due to metal objects.

Do not transport the remote control together with metal objects.

- ▶ Interference of the radio connection from mobile phones or other electronic devices in direct proximity to the remote control.

Do not transport the remote control together with electronic devices.

Wet or snowy conditions may disrupt the locking request recognition function on the door handles.

In the case of a malfunction, unlock and lock the vehicle using the buttons of the remote control or using the integrated key.