

Professional TTL Flash Trigger KODY TTL

Product Manual



Test:

1. Check if the power is on.
2. Check the Channel and Group of both Transmitter and Receiver.



Product function setup:

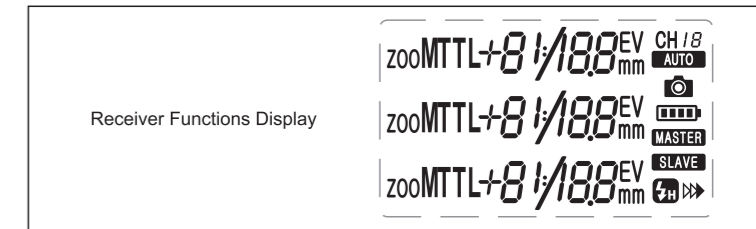

A/B/C group setup:

Press [A/B/C setup button] to switch the function; TTL 00EV M 1/32

0 FF Cycle Switch.

Press [S] on your right to change the group function setup, you can freely choose the function you need when A/B/C group flashing one by one. (it will auto switch to group B when you finished the setup of group A)

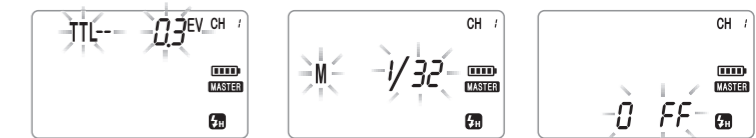

When you choose TTL mode, [+] and [-] are available for you to adjust the EV from -3.0EV to +3.0EV with altogether 19 levels.

When you choose M mode, [S] button and A/B/C buttons for the cycle switch to OFF will not allow you to have any set up.

When you choose M mode, [S] button and A/B/C buttons for the cycle switch to OFF will not allow you to have any set up.

Before use, you must read through and fully understand the use of the manual as well as the camera and flash to ensure that you are familiar with the operation and proper use of this item.

Product name of Each part

Transmitter

[A/B/C Setup Switch] Press this key under standby mode. Quick access the switch for TTL, M, OFF mode for A/B/C group.

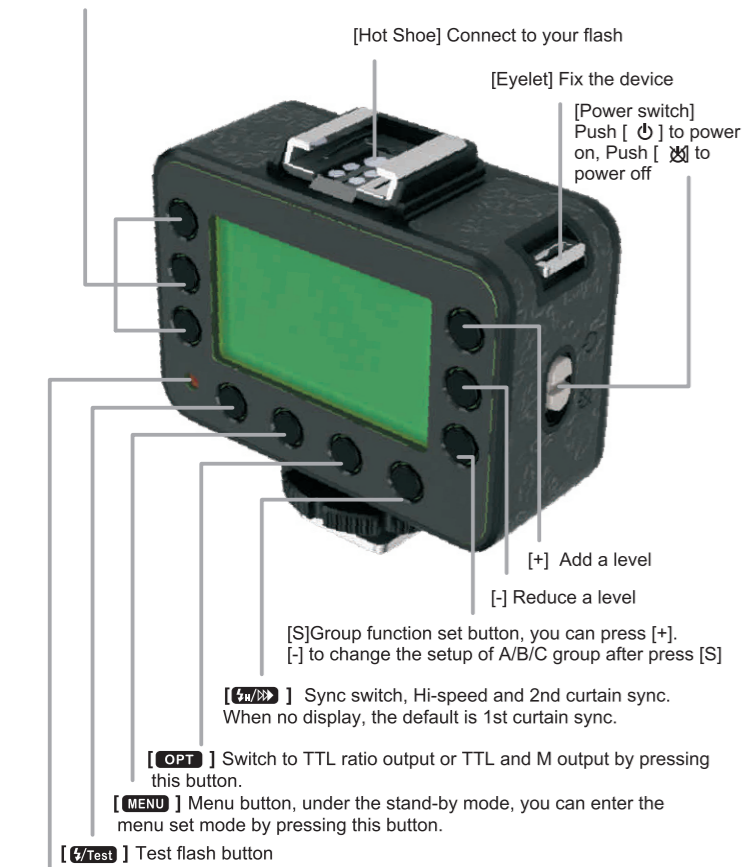

[LED 2 colors indicator] Blue lights means normal communication. Red lights means sending the signal.

Receiver

[LED 2 colors indicator] Blue lights means well received TX signal, Red lights means output flash trigger signal.

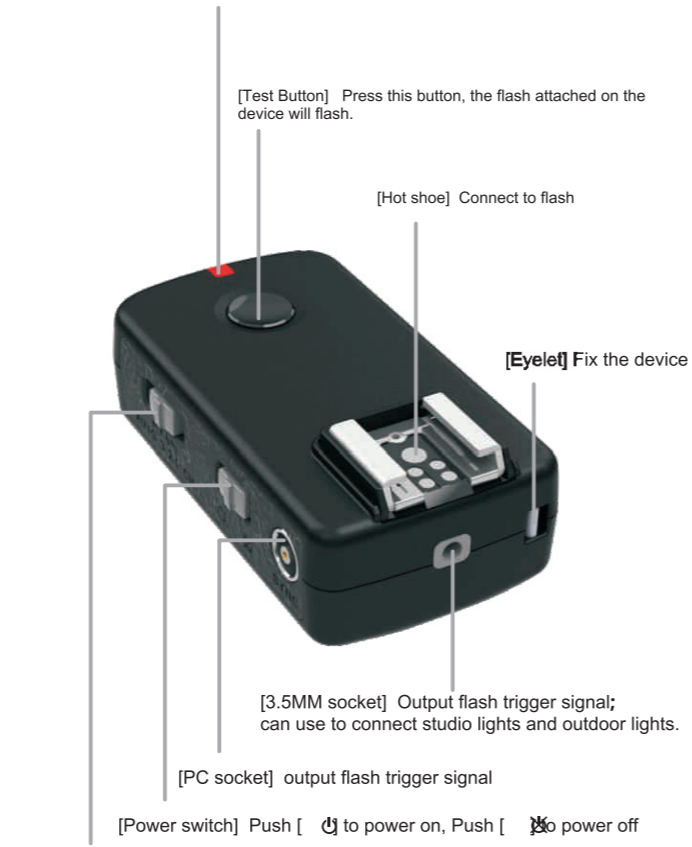

[Channel switch] 1 CH, 2CH, 3CH, AUTO.

Specifications:

System Mode: Digital FSK2.4GHz
 Distance Range: 400M+
 Channel: Transmitter: 15 Fixed Channels and 1 Auto Channel
 Receiver: 3 Fixed Channels and 1 Auto Channel
 Power: Transmitter: 2.4-3.3V (AA X 2pcs); Receiver: 4-3.3V (AA X 2pcs)
 Antenna: Built-in wire antenna
 Sync Speed: 1/8000s (different camera and flash models will differ)
 Shutter Release: Support Shutter releases
 Control: Transmitter: 5 Different groups; Receiver: 4 Different groups
 Interface: 3.5MM, USB2.0, PC
 Test Flash: Support
 Function: Support EOS E-TTL II flash mode, manual output..
 Battery Life: Transmitter: Approx. 600hrs under stand-by mode
 Receiver: Approx. 240hrs under stand-by mode.
 Display: LCD screen

Installation:

Installation for Transmitter:



1. Insert the board screw on the transmitter fixed screw as [1-1], lock the board screw on the tripods as [1-2]
2. Make sure the flash is powered off before attaching your flash to the transmitter hot shoe as [1-3]. Lock your flash as illustrated on [1-4].

Installation for Receiver:

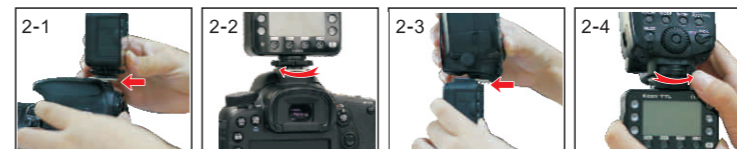

1. Make sure the camera is powered off, Loosen the fixed screw of receiver hot shoe by rotating right, insert the receiver on your camera top hot shoe as [2-1]. To lock, rotate the fixed screw of receiver hot shoe to lock.
2. Make sure the flash is powered off, attach your flash hot shoe on the receiver hot shoe as [2-3] and left. your flash as [2-4]

[Test] The use of Test button:

Test flash button, blue lights when the channel of the device is consistent. Press [Test] flash on transmitter and receiver will flash.

[MENU] The use of MENU button:

Press [MENU] can set up channel, press [MENU] gain, can set up focal length, press [MENU] again means quit.

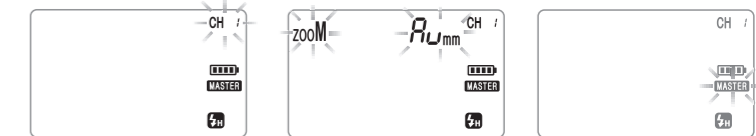

[+] and [-] can change the channel from AUTO, CH1 to CH15 with altogether 16 channels.

Focal length can be adjusted by pressing [S] button and A/B/C from AUTO and 24 to 105MM with altogether 8 levels.

Main and auxiliary lights setup by pressing [S], [+] and [-] buttons for the cycle switch of [MASTER] Remark: This function can be used after device upgrade.

[OPT] The use of OPT button:

Press [OPT] to set up your flash ratio, there are A:B and A:BC 2 options.

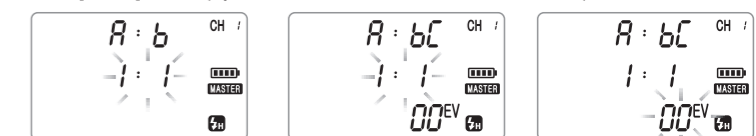

"A:b" Press [S], then [+] and [-] to set up ratio and EV. For ratio, there are 15 groups to choose. For EV, a total of 19 levels from -3.0EV to +3.0EV is available.

"A:bc" Press [S], then [+] and [-] to set up ratio and EV. For ratio, there are 15 groups to choose. For EV, a total of 19 levels from -3.0EV to +3.0EV is available.

[Sync] The use of Sync button:

Press [Sync] to set up the sync mode, Press [Sync] switch the high speed sync, Press [Sync] to switch the 2nd curtain sync. Press again will show the default as 1st curtain sync.

This instruction manual is updated at 1st Oct, 2012. If you want the new released product information after this date, you can contact the local dealer or visit to <http://www.dazzne.com>.

changes or modifications not expressly approved by the party responsible for compliance could void the user's authority to operate the equipment.

This device complies with Part 15 of the FCC Rules. Operation is subject to the following two conditions: (1) this device may not cause harmful interference, and (2) this device must accept any interference received, including interference that may cause undesired operation.

This equipment has been tested and found to comply with the limits for a Class B digital device, pursuant to Part 15 of the FCC Rules. These limits are designed to provide reasonable protection against harmful interference in a residential installation. This equipment generates, uses and can radiate radio frequency energy and, if not installed and used in accordance with the instructions, may cause harmful interference to radio communications. However, there is no guarantee that interference will not occur in a particular installation.

If this equipment does cause harmful interference to radio or television reception, which can be determined by turning the equipment off and on, the user is encouraged to try to correct the interference by one or more of the following measures:

- Reorient or relocate the receiving antenna.
- Increase the separation between the equipment and receiver.
- Connect the equipment into an outlet on a circuit different from that to which the receiver is connected.
- Consult the dealer or an experienced radio/TV technician for help.