

# Qi2 Wireless Car Charger

Quick start guide

Qi2 磁吸無線充電手機車用支架

型號：99M0243003

使用指南

設備指南

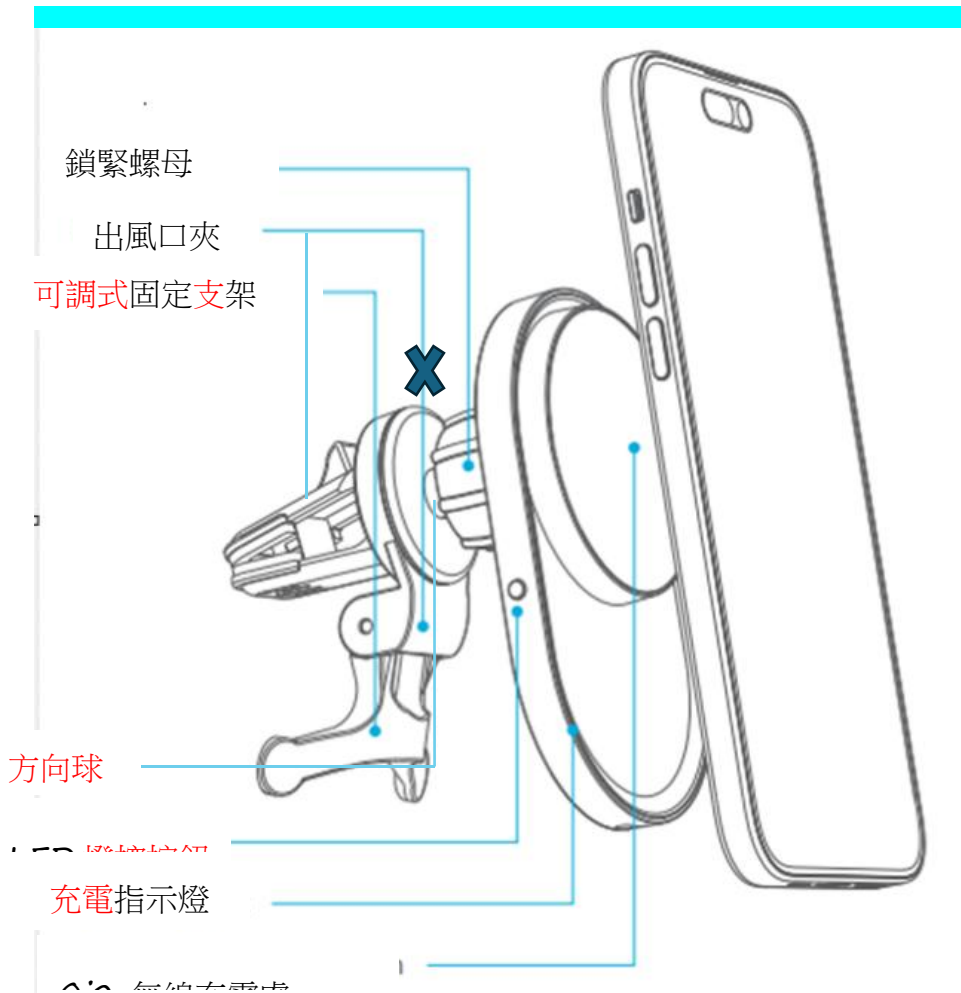

## 開始設置您的 Qi2 磁吸無線充電手機車用支架

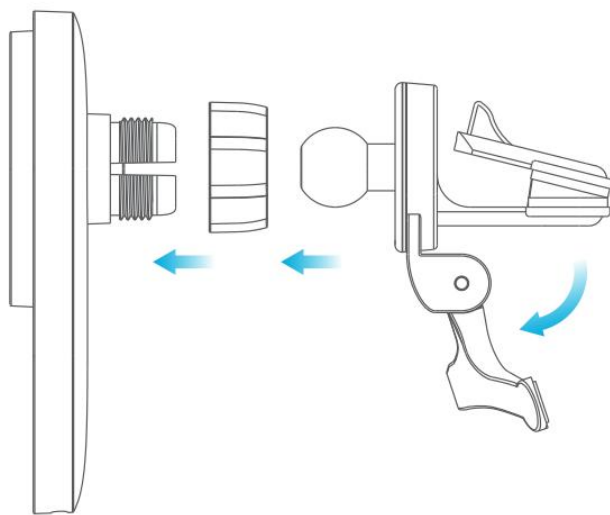

1. 將螺母套逆時鐘鬆開

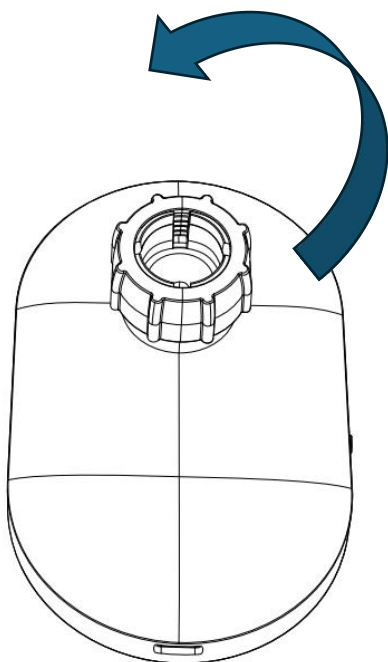

2. 將方向球坎入車架背面圓形台槽內並將螺母鎖緊。

3. 將出風口夾固定於乘車出風口葉片上，調整至合適角度後再將 *Type-C* 充電線連接車架電源接孔。

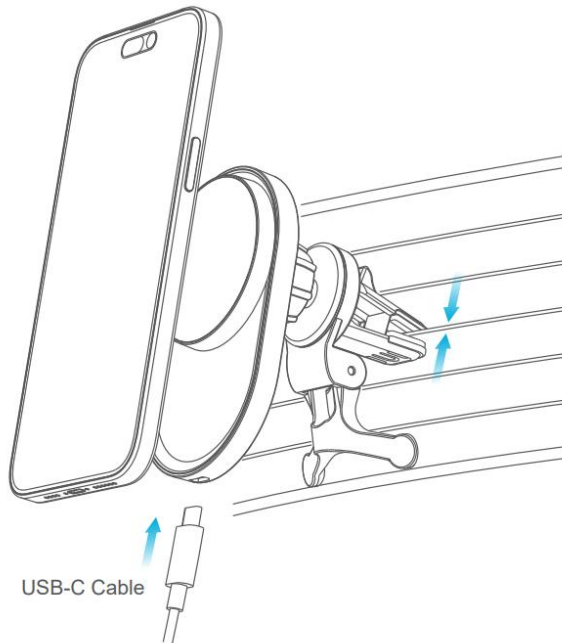

4.將另一端 *Type-C* 充電線連接您車上的 *Type-C* 充電口或是車載充電器（需將車載充電器置入汽車點煙器孔位內。）

## 開始使用 Qi2 磁吸無線充電手機車用支架

1. Qi2 磁吸無線充電手機車用支架的 LED 指示燈在電源供應妥當後即會亮燈。

2. 單擊 LED 指示燈控按鈕後即可開啟或關閉燈光。

## LED 指示燈

1. 當 Qi2 磁吸無線充電手機車用支架接上電後，LED 指示燈號對應狀態如下：

### LED 開啟狀態

---

待機	白光恆亮
----	------

---

充電中	恆亮橙光
-----	------

---

滿電	白光恆亮
----	------

---

異物偵測	閃爍橙光
------	------

---

### LED 關閉狀態

---

待機	無亮燈
----	-----

---

充電中	無亮燈
-----	-----

---

滿電	無亮燈
----	-----

---

異物偵測	閃爍橙光
------	------

---

### 注意事項：

Qi2 磁吸無線充電手機車用支架替行動裝置充電時，當您在行動裝置上運行耗電的應用程式或長時間於多工處理狀態下，行動裝置若因近場感應產生熱能係屬正常現象，還請放心使用。

- 1.本產品係與 moshi 磁吸手機殼套搭配設計，恕無法保證能與第三方磁鐵配件兼容適配。
- 2.手機車用支架可在 0°C-35°C 之間使用，並於-20°C-50°C 之間儲存。請避免於推薦的溫度範圍之外使用或存放，避免造成或導致其他衍生性使用傷害。
- 3.請防止兒童或動物咀嚼手機車用支架；並勿隨意拆卸、改裝或修理設備。
- 4.請勿在充電設備附近放置具有磁條之物品（例如：信用卡、電話卡、存摺、登記卡等），以免因設備磁力吸附效能造成磁場損傷或毀壞。

## NCC 警語

取得審驗證明之低功率射頻器材，非經核准，公司、商號使用者均不得擅自變更頻率、加大功率或變更原設計之特性及功能。低功率射頻器材之使用不得影響飛航安全及干擾合法通信；變發現有干擾現象時，應立即停用，並改善至無干擾時方得繼續使用。前述合法通信，指依電信管理法規定作業之無線電通信，低功率射頻器材須忍受合法通信或工業、科學及醫療用電波富射性電機設備之干擾。

限用物質含有情況標示聲明書：[http://file.moshi.com/download/bsmi\\_rohs.pdf](http://file.moshi.com/download/bsmi_rohs.pdf)

## Getting Started

### Device Layout

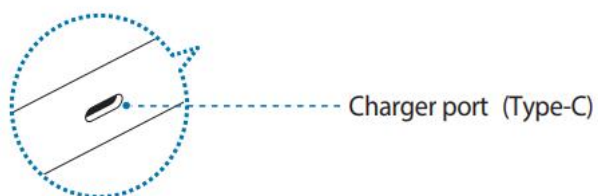
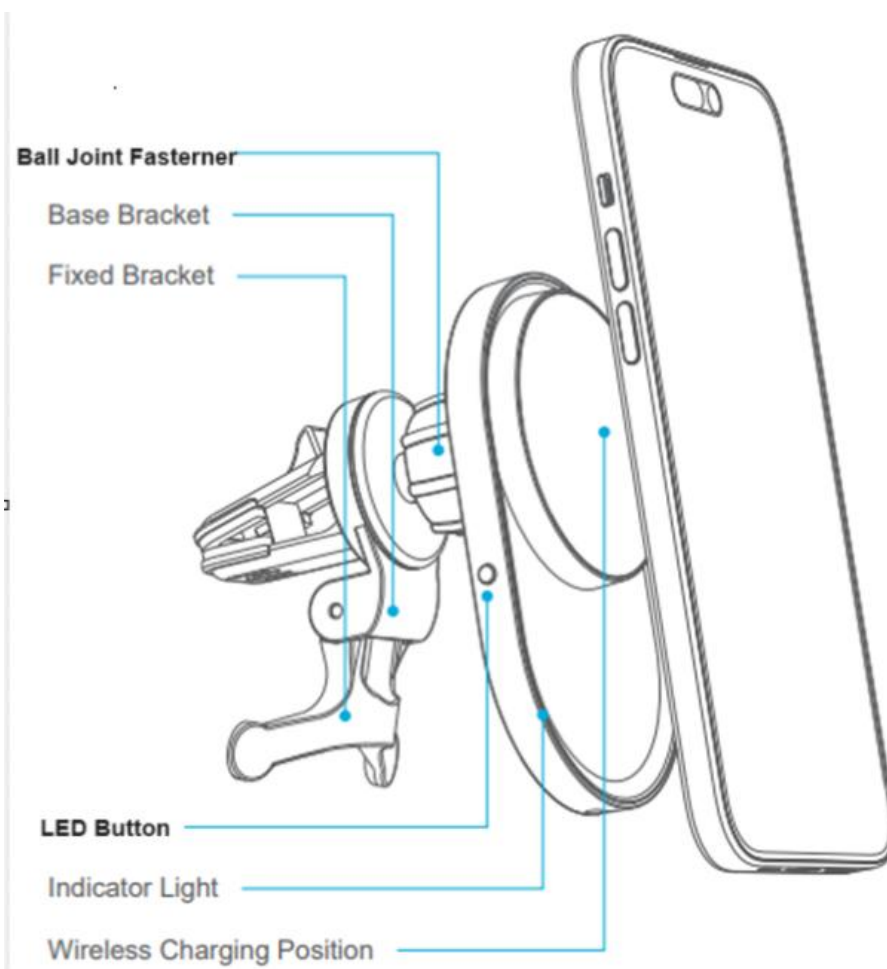

Set up your Qi2 Wireless Car Charger

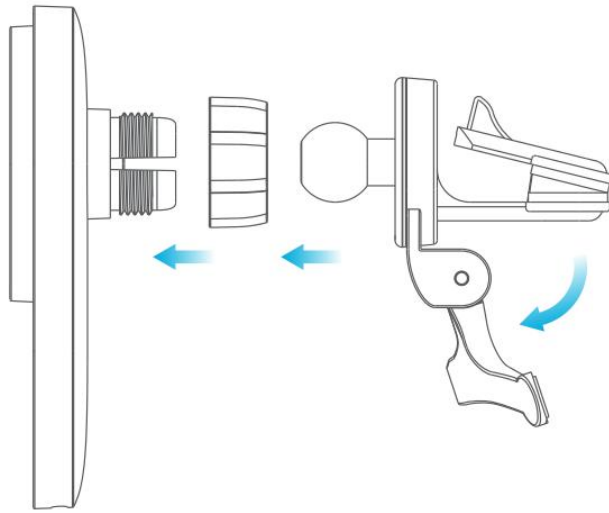

1. Remove the ball joint fastener from the wireless car charger by rotating it counterclockwise.

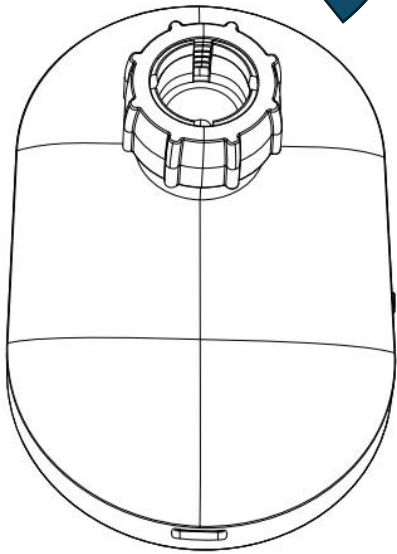

2. Put the clip through the ball joint fastener and assemble the clip on the Qi2 Wireless Car Charger.

3. Set the bracket with the proper angle to suit your car's air vent and the Qi2 Wireless Car Charger can be locked on the car's air vent, then connect the Type-C charging cable

to the port.

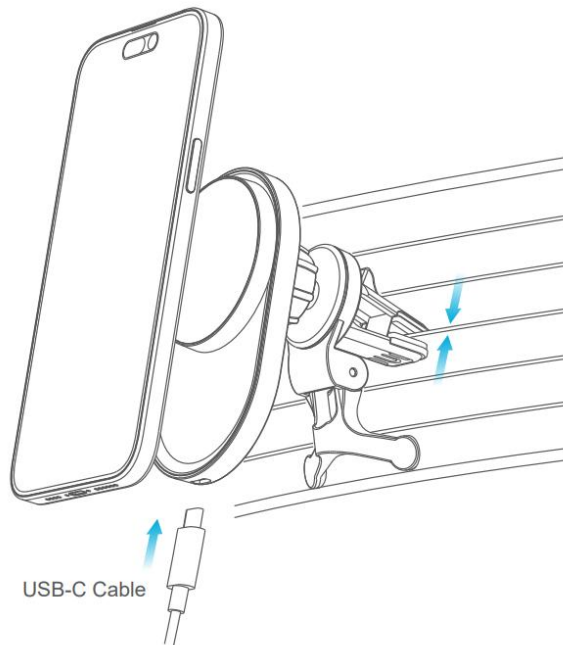

4. Connect the other charging cable end to the USB-C port of a USB car adapter, or a USB car adapter that fits into the cigarette lighter socket.

## Start using Qi2 Wireless Car Charger

1. The LED indicator will light up when properly supplied power.
2. Long press the LED button for 2 seconds to turn on or turn off the LED lights.

## LED light status

When the Qi2 magnetic wireless charging is connected to the power supply, the LED light indicators correspond to the following states.

### LED Light on status

Standby      White light



Charging      Orange light

Fully Charged      White light

FOD      Flashing orange light

LED Light off status

Standby      Lights off

Charging      Lights off

Fully Charged      Lights off

FOD      Flashing orange light

### Important Notes

When you run power-consuming applications on the mobile device or multiprocessing apps for a long time, the Qi2 Wireless Car Charger for mobile devices, the mobile device will heat up. This is a normal phenomenon and will not affect the service life or performance of the device.

1. This product is designed to work with the Moshi magnetic phone case, and we cannot guarantee that it is compatible with third-party magnet accessories.

2. The car mount can be used between 0°C-35°C and stored between -20°C-50°C.

Please avoid using it at temperatures other than those recommended. Please avoid using or storing outside the recommended temperature range to avoid causing or damaging the device.

3. Prevent children or animals from chewing on the equipment; and do not disassemble, modify, or tamper with the device.

4. Do not place items with magnetic stripes. cards (e.g., credit cards, phone cards, passbooks, registration cards, etc.) near the charging device to avoid damage or destruction of the magnetic field due to the magnetic adsorption effect of the device.

#### **FCC Caution :**

This device complies with part 15 of the FCC Rules. Operation is subject to the following two conditions: (1) This device may not cause harmful interference, and (2) this device must accept any interference received, including interference that may cause undesired operation.

**Note:** Changes or modifications to this unit not expressly approved by the party responsible for compliance could void the user's authority to operate the equipment. This equipment has been tested and found to comply with the limits for a Class B digital device, pursuant to Part 15 of the FCC Rules. These limits are designed to provide reasonable protection against harmful interference in a residential installation. This

equipment generates, uses and can radiate radio frequency energy and, if not installed and used in accordance with the instructions, may cause harmful interference to radio communications. However, there is no guarantee that interference will not occur in a particular installation. If this equipment does cause harmful interference to radio or television reception, which can be determined by turning the equipment off and on, the user is encouraged to try to correct the interference by one or more of the following measures:

- Reorient or relocate the receiving antenna.
- Increase the separation between the equipment and receiver.
- Connect the equipment into an outlet on a circuit different from that to which the receiver is connected.
- Consult the dealer or an experienced radio/TV technician for help.

#### *FCC Radiation Exposure Statement*

The antennas used for this transmitter must be installed to provide a separation distance of at least 20 cm from all persons and must not be co-located for operating in conjunction with any other antenna or transmitter.

#### *CE Statement*

Herby, Aveoe Inc. declares that the radio equipment type Taita M 3 in 1 foldable wireless charging station is in compliance with Directive 2013/53/EU.