

R1000 User Manual

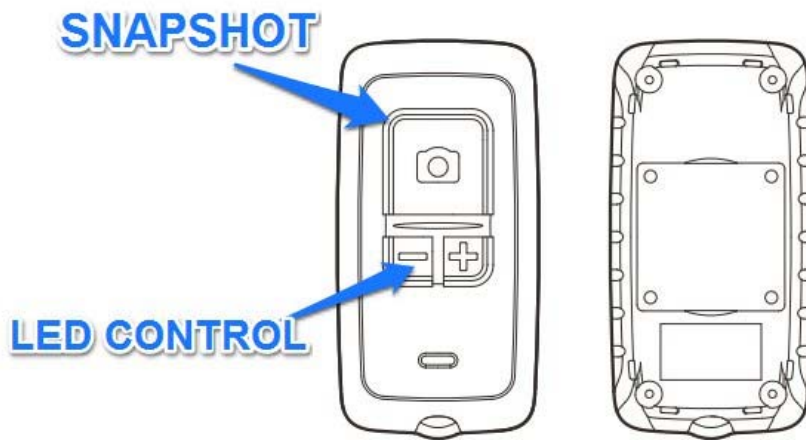

Dimension

71*36*23mm

Weight

40g

Operating Environment

System Operating Temperature	-10°C ~ 60°C
Tip Operating Temperature	
Storage Temperature	-20°C ~ 80°C
Battery Charging Temperature	10°C ~ 40°C
Waterproof & Dustproof	IP57
Drop survivability	1.0m

FCC NOTICE (Class A)

This device complies with Part 15 of the FCC Rules. Operation is subject to the following two conditions:

1. This device may not cause harmful interference.
2. This device must accept any interference received, including interference that may cause undesired operation.

Federal Communications Commission Statement

Note - This equipment has been tested and found to comply with the limits for a Class A digital device, pursuant to Part 15 of the FCC Rules. These limits are designed to provide reasonable protection against harmful interference when the equipment is operated in a commercial environment. This equipment generates, uses and can radiate radio frequency energy and, if not installed and used in accordance with the instruction manual, may cause harmful interference to radio communications. Operation of this equipment in a residential area is likely to cause harmful interference in which case the user will be required to correct the interference at his own expense

Caution: Any changes or modifications not expressly approved by the party responsible for compliance could void the user's authority to operate this equipment.