

3. When Soundbar has connected to the network, Airplay music to Soundbar :
I Select one music player, such as Apple music app. Click the Airplay icon.
II Select the device name and click to connect. Play control when casting, like volume down/up, play/pause, prev/next etc.

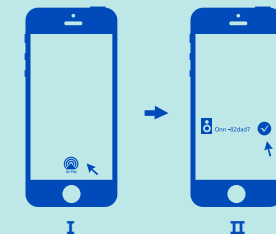

Use of the Works with Apple badge means that an accessory has been designed to work specifically with the technology identified in the badge and has been certified by the developer to meet Apple performance standards.

Hints and Tips

Problem	Solution
No power.	<ul style="list-style-type: none"> Ensure the adapter is connected securely at both ends. Make sure that the on mode is selected.
The remote control is not functioning.	<ul style="list-style-type: none"> Use the remote control near the unit. Point the remote control at the remote sensor on the unit. Replace the battery in the remote control with a new one. Remove any obstacles between the remote control and the unit.
Loud hum or noise is heard.	<ul style="list-style-type: none"> The plugs and sockets are dirty. Wipe them with a cloth slightly moistened with an appropriate on-abrasive cleaning solution.
Cannot connect to Wi-Fi	<ul style="list-style-type: none"> Make sure that the wireless networks is not disturbed by microwave ovens, DECT phones or other neighboring Wi-Fi devices. Make sure that the speaker and your device share the same network. Make sure that your router/modem is on and that you are within range of it.
I cannot find "Onn 32" Soundbar" on my Bluetooth® device.	<ul style="list-style-type: none"> Ensure the Bluetooth® function is activated on your Bluetooth® device. Ensure you have paired your unit with the Bluetooth® device.

Specifications

Model: ONN 32" 2.1 SOUNDBAR		
Soundbar	AC Power Adapter	Input: AC 100-240V ~50/60Hz, 1.2A Output: DC 18V, 2.0A
	Peak Power	120W
	Power Consumption	30W
	Speaker Output Power	2 x 15 W(RMS)
	Net Weight	1.6 Kg
	Dimension	812mm(W) x 68mm(D) x 82mm(H)
Subwoofer	Power Cord	internal power supply input 100-240V AC 50/60Hz US standard
	Peak Power	160W
	Power Consumption	40W
	Speaker Output Power	40W(RMS)
	Net Weight	2.7Kg
	Dimension	123mm(W) x 266mm(D) x 230mm(H)

We'd love to hear from you. Scan with your Walmart app and let us know what you think.



onn.™

ONN 32" 2.1 SOUNDBAR Quick Start Guide

106mm

Thank you for purchasing your new ONN 32" 2.1 SOUNDBAR

We recommend that you spend some time reading this Quick Start Guide so that you fully understand all the operational features it offers. You will also find some hints and tips to help you resolve any issues.

Unpacking

Remove all items from the packaging. Retain the packaging. If you dispose of it please do so according to local regulations.

The following items are included:

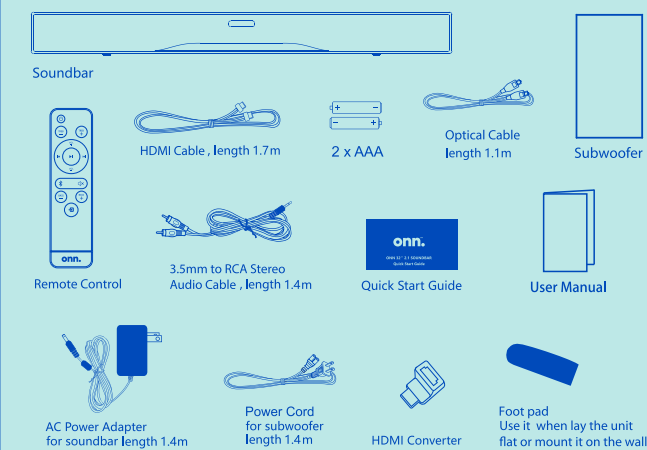

Product Overview

Front View

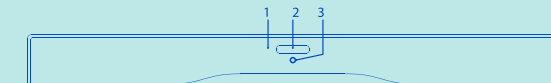

1. Source LED (AUX in: Green Bluetooth: Blue Optical: Purple ARC: Red)
2. Volume status LED
3. Remote Control Sensor

Top View



1. VOL + Button
2. Source Button
3. VOL - Button
4. VOL + Button
5. Bluetooth Button

Bottom View

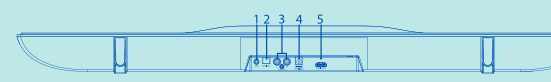

1. AUX IN Port
2. OPTICAL Port
3. AUDIO IN (L/R) Port
4. DC IN Port
5. HDMI Port

Rear View of Subwoofer

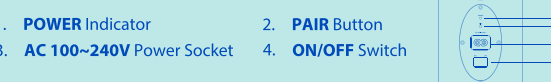

1. POWER Indicator
2. PAIR Button
3. AC 100~240V Power Socket
4. ON/OFF Switch

Remote Control

1. Power Button
2. TREB - Button
3. TREB + Button
4. VOL + Button
5. MUTE / PAUSE / STOP Button
6. VOL - Button
7. Switch to bluetooth mode
8. MUTE Button
9. BASS - Button
10. BASS + Button
11. Source Button

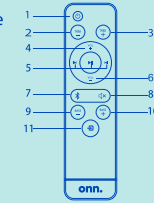

Preparation

Battery Replacement for the Remote Control

1. Press and slide the back cover to open the battery compartment of the remote control.
2. Insert two AAA size batteries.
3. Close the battery compartment cover.

Connections

Using the AUX Connection

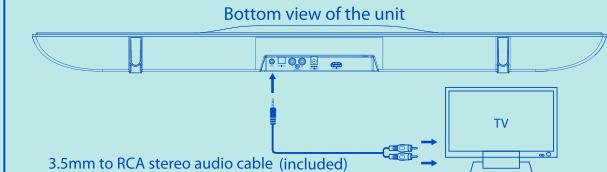

Using the OPTICAL Connection

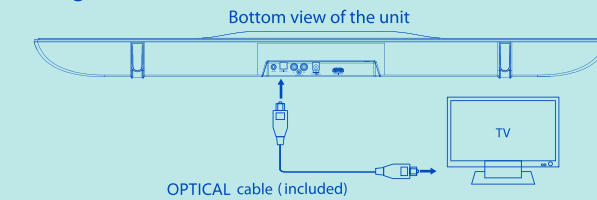

Using the Audio Connection

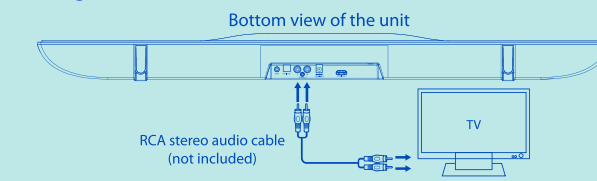

Using the HDMI Connection

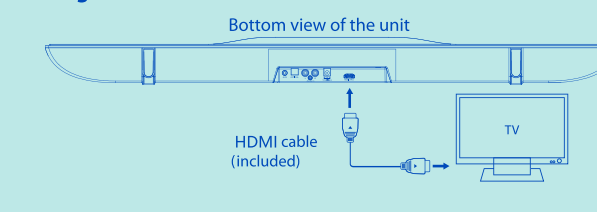

Establish Bluetooth connection

When unit power on, press **Source** button on soundbar change to bluetooth mode, and then short press this button about 2s to enter bluetooth pairing mode, blue led indicator fast flash, if long press this button >5s, will clear previous paired devices and goes to pairing mode.

Pairing the subwoofer

Pair manually : Long press source and vol+ button at same time on soundbar for 3s, and then long press pairing button on subwoofer for 3s, Soundbar's current LED indicator and subwoofer's red led will fast blink until be paired each other. After connected, led indicator will remain solid bright. PS: Subwoofer is paired with soundbar before ex-factory, when power on, they will be connected each other automatically.

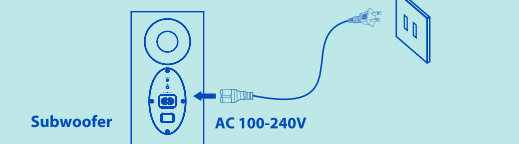

Connecting to the Power outlet Supply

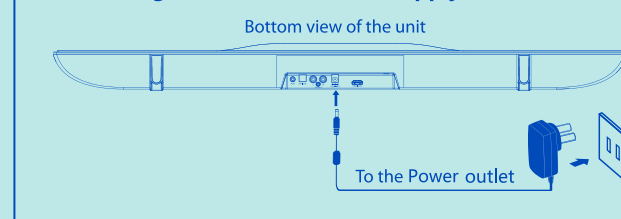

AirPlay 2

To control this AirPlay 2-enabled speaker, iOS 11.4 or later is required on your device.

Set up your device in the Apple Home app located on your iPhone or iPad

1. Connect your iOS device to the WiFi
2. Follow the Apple Home app configure process

- I Open Apple Home app.
- II Click the "+" icon, select "Add Accessory."
- III Click "Don't Have a Code or Can't Scan".
- IV Search the device and when you find the device, click the device name.
- V When prompted "Add Accessory to Network", click Allow.
- VI Waiting for network connection.
- VII After networking successfully, Accessory Added.
- VIII Go to My Home, you can find there has a new device that you added.

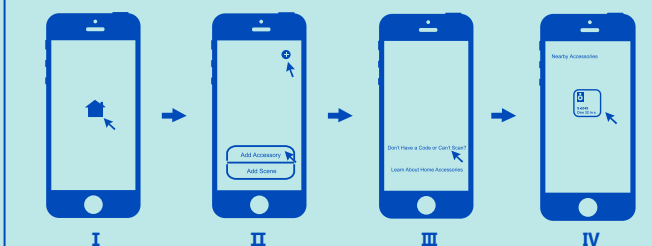

S-3049 PRODUCT GUIDE
 Unfold dimension: 568X106mm
 fold dimension: 188X106mm (accasions)
 Material: 80g matt art paper
 Printing: 4C, double sides
 Material Number : 47301265

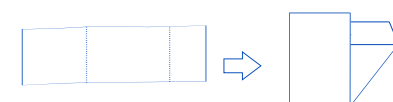

568mm