

- 1** **NOTE: This device is for commercial use only. It is not intended or suitable for any consumer applications.**
NOTE: This device requires professional installation to prevent tampering with or removal/replacement of the antenna by anyone other than qualified service professionals.

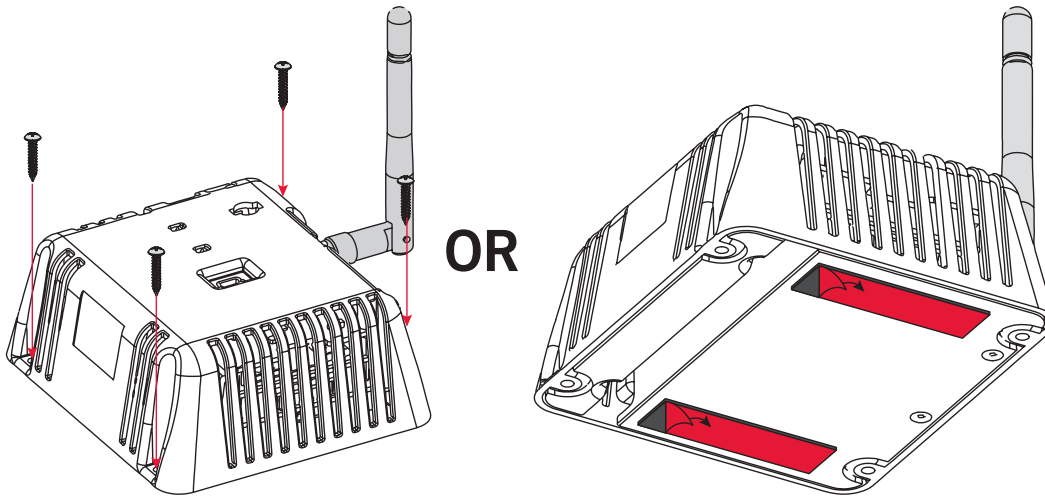

OR

- 2** Install the power supply and power up the Hub. Secure the power supply by wrapping the rubber flap around the connector and attaching into the opening on top of the Hub.

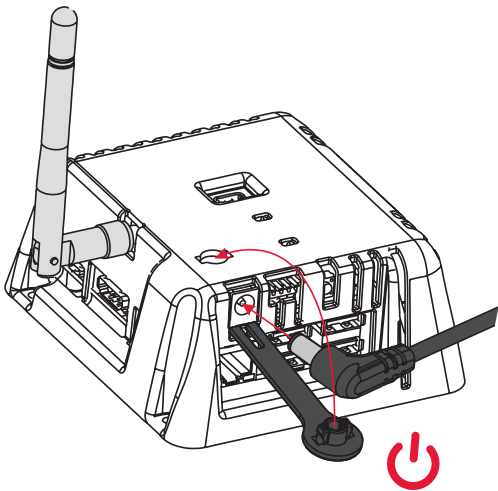

Main Plug of the adapter acts as disconnect device, the socket-outlet shall be installed near the equipment and shall be easily accessible.

Warning: The Adapter used must be marked with “LPS” or “Limited Power Sources”; otherwise those others are prohibited to use.



La prise principale de l’adaptateur agit comme un dispositif de déconnexion, la prise de courant doit être installée près de l’équipement et doit être facilement accessible.

Avertissement: L’adaptateur utilisé doit porter la mention «LPS» ou «Sources d’alimentation limitées». sinon, ces autres sont interdits d’utilisation.

- 3** If using with MTI Connect application software, plug the Hub into the internet with an available Ethernet cable or setup with WIFI credentials. If not using with MTI Connect, move on to Freedom Micro Provisioning.

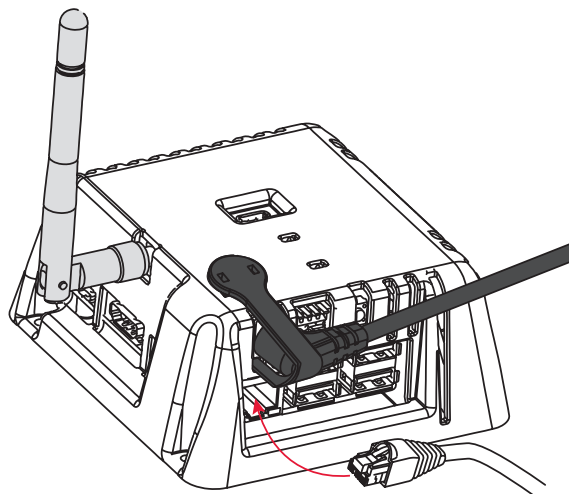

1 Ensure the Hub and all Freedom Micro positions are powered up. Once powered, the status light will illuminate (see page 3 for LED Status Indicators).

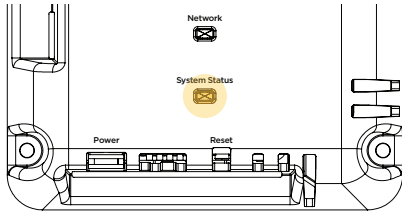

2 Plug user key into the USB port on the top of the Hub. When the key LED lights green, it has been added to the system whitelist. Remove and repeat for all other user keys.

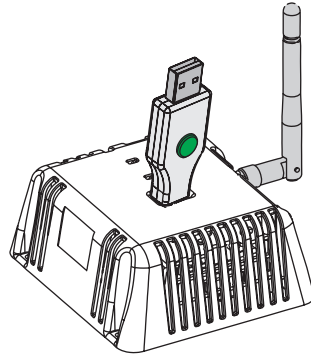

3 Plug in any user key in for 10 seconds. After 10 seconds, the Hub status indicator will flash blue, indicating the Hub is in network provisioning mode.

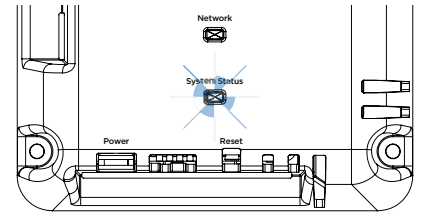

4 Remove the key (blue LED will stay flashing on Hub for up to 15 minutes).

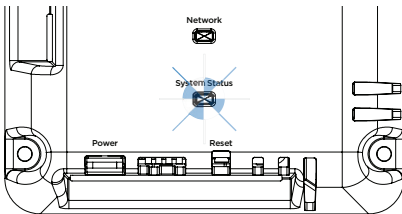

5 Take any of the user keys to each position that has a flashing yellow LED and plug in the key for 10 seconds (the key LED will light up red).

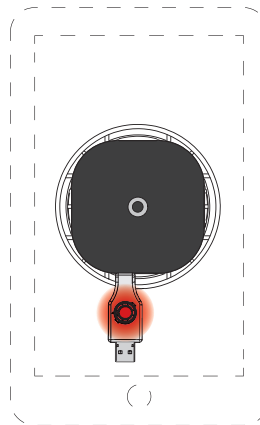

6 After 10 seconds, the puck LED will flash blue until it connects to the Hub's network.

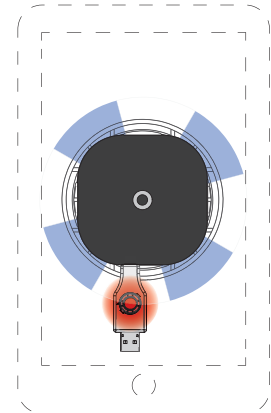

7 After connecting to the network, the LED on the puck will double white flash every 5 seconds, the key's LED will still remain red.

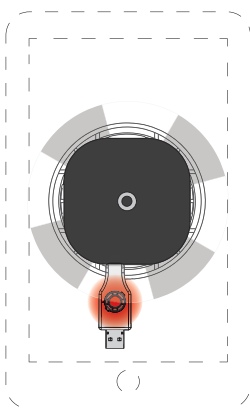

8 Remove and re-insert the key; the key's LED should light green, indicating the key will now control the puck.

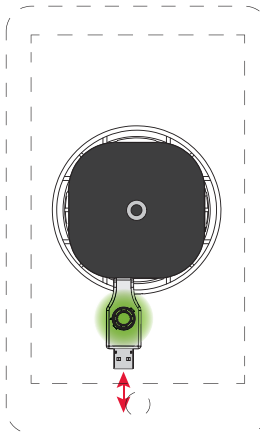

9 Removing the key after the LED illuminates green will arm the position if the position is fully merchandised.

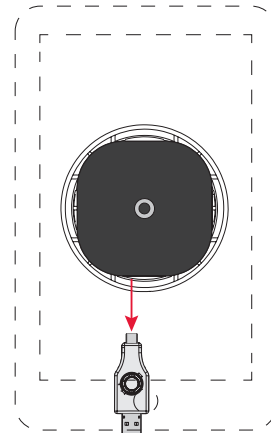

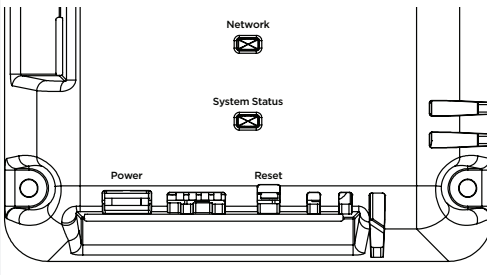
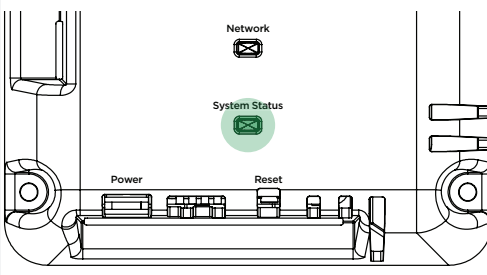
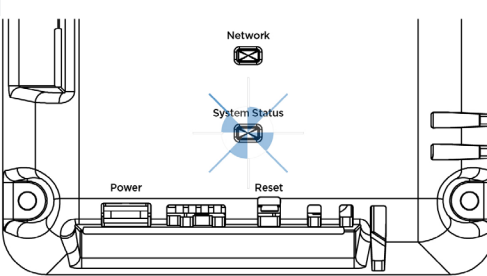
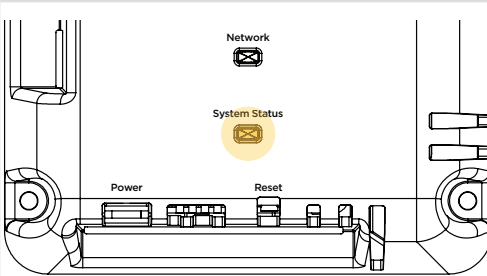
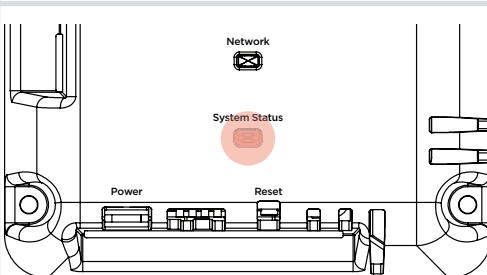
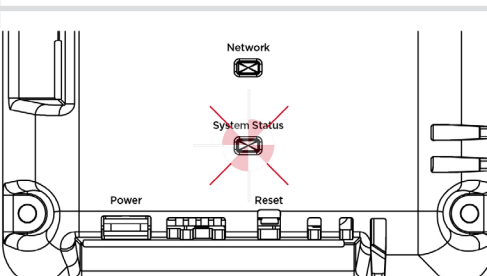
Visual Reference	System Status	Condition
	No Lights On	Hub has no power and backup battery has been depleted. Reconnect Hub to power.
	Status LED Solid Green	Hub is fully functional: <ul style="list-style-type: none"> - Mesh network communication is good - MTI Connect cloud communication is good
	Status LED Flashing Blue	Hub is in mesh provisioning mode.
	Status LED Solid Yellow	No mesh communication - provision Pucks/Locks or move Hub closer to them.
	Status LED Solid Red	MTI Connect cloud communication error. If this condition persists for more than 5 minutes, cycle power to the hub. If the condition continues, call for support.
	Status LED Flashing Red	Hub is in battery backup - connect to power.

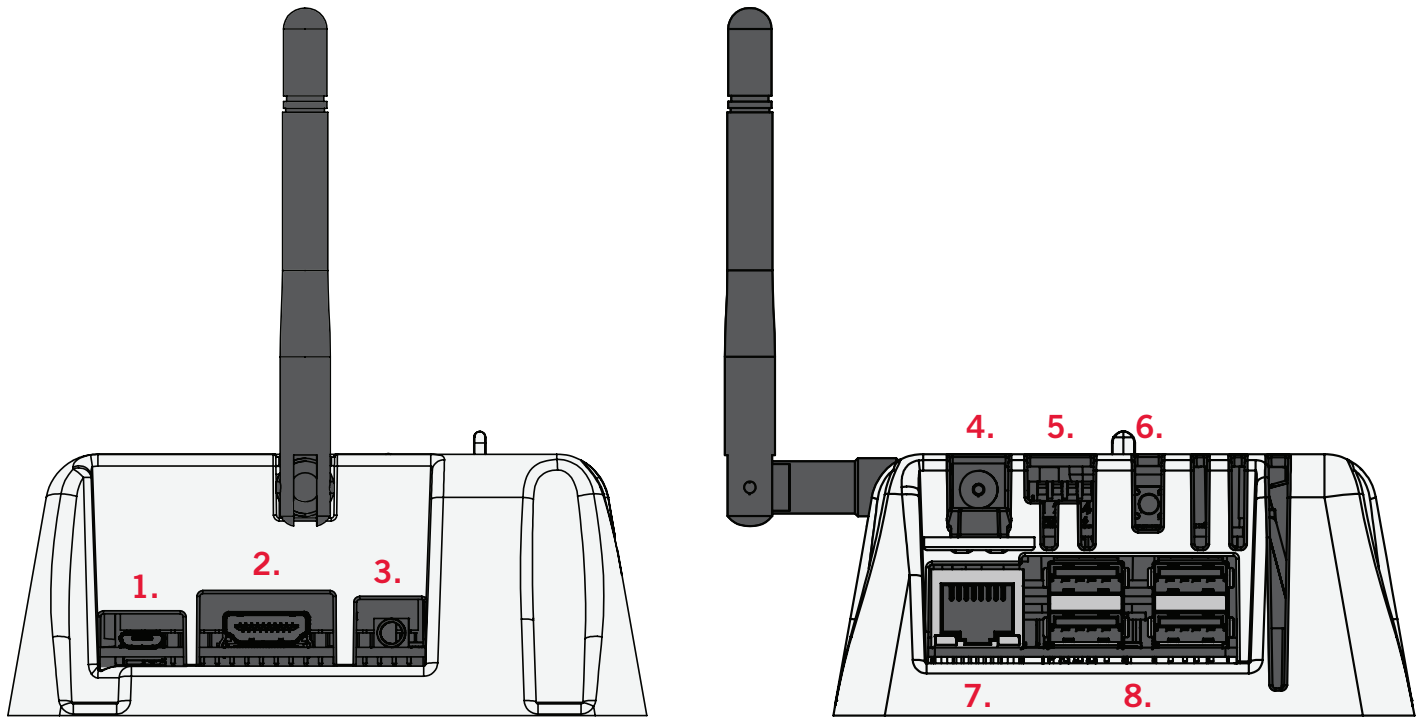

1. **Auxiliary Micro USB Power Port** - Used for installation and maintenance
2. **HDMI Port** - Used for installation and maintenance
3. **Audio/Video 3.5mm Port** - Used for installation and maintenance
4. **Primary Power Port** - The standard power input. Connect a 5V power supply, rated for 10 watts or more
5. **Dipswitches** - Sets configurations at installation. Refer to dipswitch setting table in appendix.
6. **Reset button** - Used to reset the list of whitelisted IntelliKeys
7. **Ethernet port** - Connect an Ethernet (RJ45) cable from a router or a broadband modem for network or Internet access. The two lights next to the connector indicate the connectivity status and network activity.
8. **USB ports** - Used for installation and maintenance



Warning: Ports designated as “used for installation and maintenance” must not be accessed by end users. Only MTI-certified technical personnel may use these ports during installation and maintenance.

FCC ID: 2AA2X-16500361

Model: Connect Hub

FCC Statement

This device complies with Part 15 of the FCC Rules.

Caution: If any changes or modifications not expressly approved by the party responsible for compliance could void the user's authority to operate the equipment.

Operation is subject to the following two conditions: (1) This device may not cause harmful interference, and (2) This device must accept any interference received, including interference that may cause undesired operation.

The grantee is not responsible for any changes or modifications not expressly approved by the party responsible for compliance. Such modifications could void the user's authority to operate the equipment.

The RF Exposure Compliance distance is 20 millimeters.

NOTE: This equipment has been tested and found to comply with the limits for a Class B digital device, pursuant to part 15 of the FCC Rules. These limits are designed to provide reasonable protection against harmful interference in a residential installation. This equipment generates, uses and can radiate radio frequency energy and, if not installed and used in accordance with the instructions, may cause harmful interference to radio communications. However, there is no guarantee that interference will not occur in a particular installation. If this equipment does cause harmful interference to radio or television reception, which can be determined by turning the equipment off and on, the user is encouraged to try to correct the interference by one or more of the following measures:

- Reorient or relocate the receiving antenna.
- Increase the separation between the equipment and receiver.
- Connect the equipment into an outlet on a circuit different from that to which the receiver is connected.
- Consult the dealer or an experienced radio/TV technician for help.

ISED Certification Number: 24439-16500361

Model: Connect Hub

ISED Statement

This device complies with Innovation, Science and Economic Development Canada licence-exempt RSS standard(s). Operation is subject to the following two conditions: (1) this device may not cause interference, and (2) this device must accept any interference, including interference that may cause undesired operation of the device.

CAN ICES-3(B)/NMB-3(B)

Le présent appareil est conforme aux CNR Innovation, Sciences et Développement économique Canada applicables aux appareils radio exempts de licence. L'exploitation est autorisée aux deux conditions suivantes:

(1) il ne doit pas produire de brouillage et (2) l'utilisateur du dispositif doit être prêt à accepter tout brouillage radioélectrique reçu, même si ce brouillage est susceptible de compromettre le fonctionnement du dispositif.

CAN ICES-3(B)/NMB-3(B)

The device meets the exemption from the routine evaluation limits in section 2.5 of RSS 102 and compliance with RSS-102 RF exposure, users can obtain Canadian information on RF exposure and compliance.

Le dispositif rencontre l'exemption des limites courantes d'évaluation dans la section 2.5 de RSS 102 et la conformité à l'exposition de RSS-102 rf, utilisateurs peut obtenir l'information canadienne sur l'exposition et la conformité de rf.

This transmitter must not be co-located or operating in conjunction with any other antenna or transmitter. This equipment should be installed and operated with a minimum distance of 20 millimeters between the radiator and your body.

Cet émetteur ne doit pas être Co-placé ou ne fonctionnant en même temps qu'aucune autre antenne ou émetteur. Cet équipement devrait être installé et actionné avec une distance minimum de 20 millimètres entre le radiateur et votre corps.

Technical Data

Operating Frequency:	2405- 2480MHz
Operating Temperature:	0° C to 40° C
Max Power:	2.4GHz < 20 dBm