



Smart Breathe Air Detail Manual

Contents

User Guide

2 Before Use

2 Precautions for using Smart Breathe Air

About Smart Breathe Air

4 Components

5 Part Name

6 Function of each part

How to use Smart Breathe Air

8 Bluetooth Connection

Smart Breathe Air Management

9 Mouthpiece

9 Body

About Smart Breathe Application

10 Sign up

11 Data

11 Training

12 Measurement

13 Measurement Records

Appendix

14 Product Specifications and Characteristics

14 Service & Support

14 Copyright

User Guide

Before use

Please read this User Manual before use to ensure safe and use of the product.

- The contents of this User Manual may differ from the actual ones depending on the software version of the product, the circumstances of the service provider, and the specifications of the model, and the images in this User Manual may differ from the actual ones. Some of the contents are subject to change without notice to users to improve performance.
- Bluetooth connection is required to use some services in the application.
- If the product software provided by the Company is arbitrarily changed or obtained through an unofficial route and downloaded to the product the product may malfunction or an error may occur. This infringes on the rights of the Company and the software licensor and is not covered by warranty service.
- Works and contents such as software, images, etc. used in this product are copyrighted works permitted for limited use in accordance with the agreement between the Company and the respective copyright holders. Extracting them arbitrarily and using it for other purposes, such as commercial purposes, constitutes an act of infringing the copyright of the copyright holders, and the user will be responsible for this infringement.
- The basic applications or services provided with this product are subject to change or suspension without notice due to unavoidable circumstances. In this case, please contact the customer service center. We will respond sincerely.

Precautions for using Smart Breathe Air

- ❗ **This product is not intended to be a substitute for professional medical advice, diagnosis, treatment, or care. Before you make any decision or take an action that may affect your health, please consult with a doctor or other qualified health care provider.**
- If you experience any abnormal symptoms such as chest pain or vomiting while using the product, stop using it immediately.
- We recommend that those with severe underlying medical conditions and those with diseases fully understand how to use it before using it.
- Do not use this product while driving. This may be illegal in some countries or regions. And lack of attention may lead to a risk of accidents.
- Do not shock or damage the product or battery.
- Be careful not to let any conductive material (metal, liquid, etc.) come into contact with the charger connector.
- If the product is damaged or has a problem, stop using it immediately and contact the customer service.

- The optimum operating temperature for this product is 85°C to 40°C. Higher or lower temperatures than the optimum one may damage the product or shorten the battery life.
- Place the product in a dry place away from moisture.
- Using uncertified software may cause damage to the product or mobile device. In this case, the Company and the place of purchase are not responsible for the damage.

About Smart Breathe Air

The Smart Breathe Air is a wellness device that connects to your mobile device to help you breathe properly and healthily in your daily life. It records your breathing data and visually presents them to you through a dedicated application.



Components

- ✓ Please check the simple user manual for the components provided at the time of purchase.
 - Components are for Smart Breathe Air only and may not be compatible with other devices.
 - Supplied components, separately sold items, and images are subject to change depending on region and head office circumstances.
 - Product appearance and specifications are subject to change without notice for performance improvement.
 - You can purchase optional items on the sales website. When purchasing an optional accessory, first check whether it is compatible with the model you are using.
 - For optional products, be sure to purchase genuine products provided by the company. The use of non-genuine accessories may cause deterioration or malfunction of the product, which will not be covered under warranty.

Part Name



Function of each part

Mouthpiece

- The basic component mouthpiece can be used, and a disposable paper mouthpiece sold separately can also be used.
- The mouthpiece (pc material) can be reused after washing with water, but disposable paper mouthpieces are recommended to be discarded after use once.

Oxygen saturation contact part

- Oxygen saturation can be measured only in individual training, and on/off operation of oxygen saturation measurement is possible in the personal training setting window.
- To measure oxygen saturation, you should touch the contact part with your finger for at least 5 seconds on average, and measurement may not be possible due to movement or surrounding environment during measurement.

※ Oxygen saturation numerical range

- ❗ Oxygen saturation is not data for medical diagnosis. Please use it for simple reference only.

Oxygen Saturation	State
80% or less	Dangerous, Severe hypoxia
81% – 90%	Warning, hypoxia alert
91% – 100%	Normal range

Load Level

- The load level is divided into a total of 15 levels.
- The load gets stronger as you go from level 1 to level 15. In level 15, the control fan is fully open.

Automatic load button

- The user can operate it through a button, and the function turns on automatically according to the situation when using the software.
- When using the spirometry and level test functions in the dedicated app Smart Breathe, the automatic load function needs to be turned on.

※ Automatic load state indicator

Color	State
Green on	Automatic load
Green off	Manual load

Manual load control button

- The manual load function is only available when using the personal training function in the dedicated app Smart Breathe.
- You can directly control the load level through the manual load control button in the product.

UV Sterilization

- UV sterilization works at the same time as charging and operates for 1 minutes after plugging in the charger.
- The UV sterilization works in front and back of the top of the product.
- Operation can be checked through the UV sterilization LED indicator.

Battery Charging

- ✓ When using the product for the first time after purchase or when using the product after leaving it for a while, fully charge the product. When charging for the first time or if the battery is discharged, it should be charged at least 10 minutes.
- Be sure to use the Type C USB cable provided with the product at the time of purchase. Otherwise, the product may be damaged.
- If a wrong cable is incorrectly connected, the product may not be charged or may be damaged. In this case, damages are not covered by warranty service.
- The wireless function cannot be used during charging.
- When storing the product for a long period of time, keep the battery charged.

※ Battery state indicator

Color	State
Red on	Charging
Green on	Charging completed

How to use Smart Breathe Air

Bluetooth Connection

Before start

- Fully charge the product before use.
- “Smart Breathe” should be installed on your mobile device. If the application is not installed, please download it from Google Play or App Store (Apple).

Bluetooth Connection

- 1 Turn on the product. The LED window of the power unit blinks in white with a “Beep” sound.
- 2 Turn on the Bluetooth function and location function of the mobile device.
- 3 Press the Bluetooth “Connect” button on the running app.



Smart Breathe Air Management

Mouthpiece

❗ Do not wash the disposable paper mouthpiece after use. Please through it away.

- 1 Before cleaning, separate the mouthpiece from the product.
- 2 After cleaning the separated mouthpiece under running water, wipe it with a dry towel.
- 3 Make sure it is completely dry before use.

Body

❗ The body cannot be cleaned with water.

- 1 Connect the type C charging cable to the charging terminal.
- 2 The UV sterilization function works for about one minute at the same time as charging.
- 3 Wipe the area around the control fan with dry cotton or a cotton swab for more hygienic use.

About Smart Breathe Application

Sign up

- ☑ In the last step of sign-up “e-mail confirmation”, the confirmation e-mail may be sent to the spam mailbox.
- For the device number, please refer to the product warranty within the brief manual provided with the product.

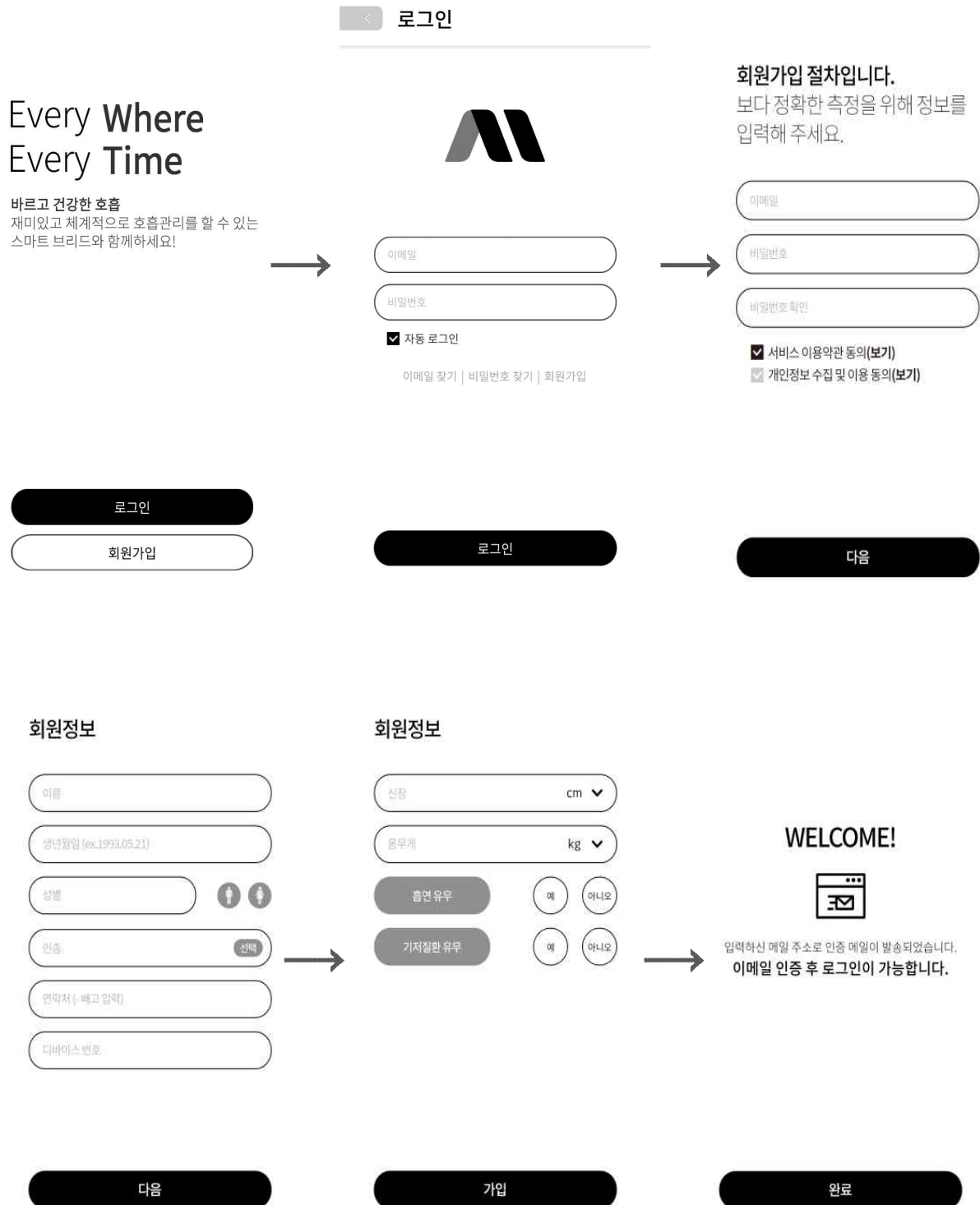

Data

☑ “Total lung capacity per day” and “Total training hours per day” data are reset at noon everyday, and “Maximum lung capacity for this week” and “Total training hours for this week” data are reset every Monday at noon.

• Personal training data is reflected.

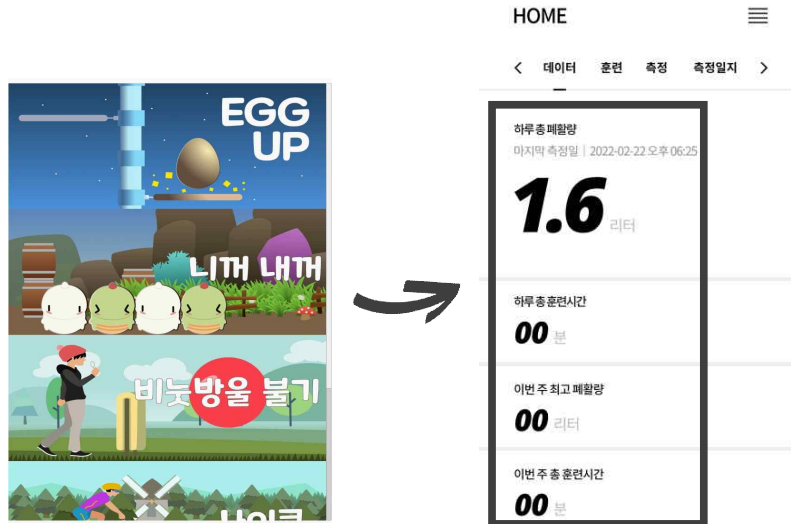

Training

Personal Training

☑ If the set load level is not appropriate, the user can directly set the load level through the manual load setting function.

- You can adjust the training difficulty level through automatic or manual load level functions.
- When the automatic load function is on, the recommended load value based on the latest level test result is applied to set the load level.



Category	Game Title	Features
Agility	EGG UP	• Fine control of inhalation and exhalation volumes
Endurance	Running	• Training to improve breathing ability • Lung capacity improvement through repetitive inhalation and exhalation training, diaphragm exercise, core exercise
	Cycle	• Training to improve breathing ability • Lung capacity improvement through repetitive inhalation and exhalation training, diaphragm exercise, core exercise
Mix	Yours and Mine	• Fine control of inhalation and exhalation volumes
	Blowing Bubbles	• Fine control of inhalation and exhalation volumes • Lung capacity improvement through repetitive inhalation and exhalation training, diaphragm exercise, core exercise

Training Records

- ⓘ This function is to check the calories consumed during use and exercise time. Please note that this is not scientific verification.

2021 년 08 월

Sun	Mon	Tue	Wed	Thu	Fri	Sat
1	2	3	4	5	6	7
8	9	10	11	12	13	14
15	16	17	18	19	20	21
22	23	24	25	26	27	28
29	30	31				

운동 횟수	0 회
운동 시간	0 분
연속 달성	0 회

0 회
00:00:00
총 훈련시간

0 Kcal
0 L

0 min
0 min

*70kg 남성 기준 50kcal 소모량은 계단오르기 6분, 걷기 11분, 수영 5분을 한 것과 같음

확인

자세히 보기

Measurement

Spirometry

- Before measuring, please check if all body information, including your height and weight, is accurate. (If the body information is not correct, the measurement result will not accurate.)
- Please check if the control fan of the product is fully open (Load Level: 10).
- If you wear the nose plug, part of the components, you can measure more accurately.
- It is measured a total of 3 times, and FOC (Forced vital capacity) data is displayed every time one measurement is completed.

1차 측정

1:70

1. |날숨| 숨을 강하고 빠르게 내뿜으세요

1 2 3

1차 측정

5:43

2. |들숨| 최대한 숨을 빠르게 마시세요

0%

1 2 3

LEVEL TEST

- You can very conveniently check the load level suitable for individual training and your current condition by popping a balloon through exhalation with maximum force for 1 minute.
- Check if the control fan of the product is fully open (Load Level: 10).



1분간 날숨으로 풍선 많이 터트리기

실행

조회

나의 폐활량

날짜	풍선 수	노력성 호기량
7/1	0	0.00
7/1	1	12.38
7/1	1	18.60
6/30	0	0.00
6/29	1	11.01
6/29	1	11.01
6/29	1	11.01
6/29	1	11.01
6/29	1	11.01
6/29	1	11.01
6/29	1	11.01
6/29	1	11.01

추진 부하

테스트 홈으로

나의 폐활량

날짜	최대 호기 압력 (cmH2O)	부하 단계
7/1	557.58	15
7/1	557.58	15
7/1	557.58	15
6/30	0.00	1
6/29	302.60	15
6/29	302.60	15
6/29	302.60	15
6/29	302.60	15
6/29	302.60	15
6/29	302.60	15
6/29	302.60	15
6/29	302.60	15
6/29	302.60	15

추진 부하

테스트 홈으로

Measurement Records

Measurement Data

- Data on spirometry results(FVC, FEV1, FEV1/FVC) are shown.
- If you click Detail View, you can check the details of each data.

결과

2021.06.28

FVC 3.75L 상세정보

FEV1 3.25L 상세정보

FEV1/FVC 86.7% 상세정보

FVC

FVC 가 폐용적에 끼치는 영향



노력성 폐활량(FVC, Forced vital capacity)

- 숨을 최대한 들이마신 상태에서 최대한 내뿔을 수 있는 폐의 용량

- 80% 미만이면 제한성폐질환 소견이 있다고 봅니다.

(80%= 해당 성별 및 나이의 사람이 가지고 있어야 할 폐 용적보다 20% 이상의 폐 용적이 감소되었는 뜻)

※ 최소한의 참고자료이며, 정확한 진단을 위해서는 전문적인 측정 및 평가가 필요합니다.

FVC

주별 차트

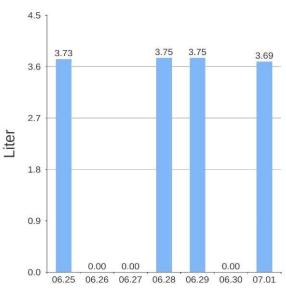

Appendix

Product Specifications and Characteristics

☑ Size and weight may vary depending on product configuration and manufacturing process.

Exterior(mm)	120(W)*155(H)*40(D)
Weight(g)	150
Material	ABS etc.
Connection method	BLE 4.1
Battery	Lithium Polymer 3.7v / 1,000mAh
Charging time (Use time)	About 90 minutes (About 12 hours of continuous use)

Service & Support

When inquiring about technical service, please provide the product model name (device number), failure status, and contact information.

- Service Center: 041-587-5030
- Customer Complaint Center: breatheon99@gmail.com

Copyright

Copyright © 2021 Addable Inc.

This instruction manual is protected under Copyright Law. No part of this manual may be reproduced, publicly transmitted, distributed, translated, or converted into an electronic medium or machine-readable format.

SMART BREATHE, SMART BREATHE AIR, The logo of Smart Breathe Air is a registered trademark of Addable Inc.

All other trademarks and copyrights are the properties of the respective owners.

Model Name : SMART BREATHE AIR / **Date of manufacture**: indicated separately

Manufacturer/Country of Manufacture: ADD ABLE Co., Ltd / Republic of Korea

KC Certificate Number: R-RBre-SMBREATHEAIR

Business Name: Addable Inc.



FCC Information to User

This equipment has been tested and found to comply with the limits for a Class B digital device, pursuant to part 15 of the FCC Rules. These limits are designed to provide reasonable protection against harmful interference in a residential installation. This equipment generates uses and can radiate radio frequency energy and, if not installed and used in accordance with the instructions, may cause harmful interference to radio communications. However, there is no guarantee that interference will not occur in a particular installation. If this equipment does cause harmful interference to radio or television reception, which can be determined by turning the equipment off and on, the user is encouraged to try to correct the interference by one or more of the following measures:

- Reorient or relocate the receiving antenna.
- Increase the separation between the equipment and receiver.
- Connect the equipment into an outlet on a circuit different from that to which the receiver is connected.
- Consult the dealer or an experienced radio/TV technician for help.

This device complies with Part 15 of the FCC Rules. Operation is subject to the following two conditions: (1) this device may not cause harmful interference, and (2) this device must accept any interference received, including interference that may cause undesired operation.

Any changes or modifications not expressly approved by the party responsible for compliance could void the user's authority to operate this equipment.

IMPORTANT NOTE:

FCC RF Radiation Exposure Statement:

This equipment complies with FCC radiation exposure limits set forth for an uncontrolled environment. This equipment should be installed and operated with minimum distance 20cm between the radiator & your body.

This transmitter must not be co-located or operating in conjunction with any other antenna or transmitter.