

12cm

Product Introduction

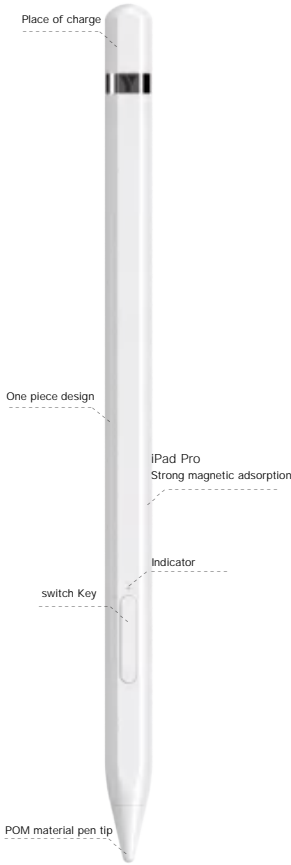

21.5cm

Quick User Guide

User Manual

1. Starting Up

Press the up button to turn on the device (after the device is turned on, the indicator will be steady on, and the Bluetooth will be connected within 30 seconds). Enter Settings, turn on Bluetooth, search for Yebos Pencil Bluetooth name, and click Connect.  
(Wait for 10s when the Bluetooth name appears for the first connection)  
When the blue light is on, the power level is 100%-70%.  
When the green light is steady on, the power level is 70%-10%.  
When the red light is blinking, the power level is 10%-0%.

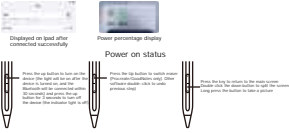

Tip: The eraser function is only supported (Procreate/GoodNotes)

2. Charging

1. Connect the data cable to charge
  2. Connect to support OTG device charging
- Red light on charging, green light on 80%. Full of bright blue light. After the blue light is on, continue charging for about 3 seconds and shut down.

3. Change the nib

Replace the pen tip. Rotate the pen tip clockwise, remove the pen tip, and then take the new pen tip and screw it in counterclockwise.

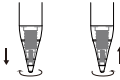

Compatible devices

Palm rejection function is available on iPad 2018&above  
\* The iPad must be upgraded to iOS13.4 or later.  
\* If your iPad has been paired with the Apple Pencil before,  
Unpair the device before using it.

Packing list

List of packing

Pencilx1 Data cable x1 Manual x1 nib x1

Parameter Specifications

Name of Product	T3B/T4B/T8/T8pro/T9
Main Functions	Drawing, writing, painting
Material of product	AluminumAlloy
Size of product	Tip 1.2" diameter 9" length 165mm
Charge time	40 minutes
Capacity of battery	150mAh
Voltage of charge	5V
Current of charge	0.2A
Current of operation	18mA
Duration of use	About 9 hours
Net weight of product	About 16 g

YEBOS  
Fine Apple digital accessories

Certification

(Perfect Substitute · ChooseYEBOS )

Brand name: YEBOS  
Material: Aluminum Alloy  
Grade: High Performance  
Origin: Dongguan

Shenzhen Jinji Digital Technology Co., LTD  
Address: 301-305, Building 6, Vanke Xinghuo,  
Bantian Street, Longgang District, Shenzhen

Dear users,  
Hello!

Thank you very much for your use. It is our duty to provide you with high-quality products and after-sales service to fully protect your consumer rights and interests. Therefore, our company implements the following standard service terms according to relevant national regulations.

1. Warranty Service: Users can go to the local after-sales service center to enjoy the replacement service provided by our company 15 days after purchase.
2. No warranty service will be provided if the damage is caused by the following circumstances.

(1) The original serial number label of the product is altered, replaced or torn, or the product model and number on the warranty certificate are inconsistent with the product without serial number;

(2) Products beyond the shelf life:

(3) Abnormal use of products leads to appearance damage;

(4) The outer packaging part and the enclosed gifts, the services beyond the products promised by the sales staff and the additional configuration and gifts;

(5) Performance damage caused by improper storage, such as products exposed to abnormal working temperature and temperature environment for a long time;

(6) Without following the operation instructions, it is considered that the product is damaged due to abuse and misuse;

3. Please take good care of the warranty card and valid shopping voucher, as the necessary documents for the warranty period. Please do not modify the contents without authorization, otherwise it will be deemed invalid.

4. The Company reserves the right to interpret the regulations on after-sales service of the products.

**FCC Warning:**

This equipment has been tested and found to comply with the limits for a Class B digital device, pursuant to part 15 of the FCC Rules. These limits are designed to provide reasonable protection against harmful interference in a residential installation. This equipment generates, uses and can radiate radio frequency energy and, if not installed and used in accordance with the instructions, may cause harmful interference to radio communications. However, there is no guarantee that interference will not occur in a particular installation. If this equipment does cause harmful interference to radio or television reception, which can be determined by turning the equipment off and on, the user is encouraged to try to correct the interference by one or more of the following measures:

- Reorient or relocate the receiving antenna.
- Increase the separation between the equipment and receiver.
- Connect the equipment into an outlet on a circuit different from that to which the receiver is connected.
- Consult the dealer or an experienced radio/TV technician for help.

**Caution:** Any changes or modifications to this device not explicitly approved by manufacturer could void your authority to operate this equipment.

This device complies with part 15 of the FCC Rules. Operation is subject to the following two conditions:

(1) This device may not cause harmful interference, and (2) this device must accept any interference received, including interference that may cause undesired operation.