

**ULTIMEA**

**HDMI™**

**Bluetooth®**



# ***User Manual***

**Apollo S70 Ultra**

**EN:** User Manual

**FR:** Manuel de l'utilisateur

**DE:** Benutzerhandbuch

**IT:** Manuale dell'utente

**JP:** ユーザーマニュアル

**ES:** Manual del usuario

Model No.: U3800

Apollo S70 Ultra Active Subwoofer

# Contents

01	User Manual	English
07	Benutzerhandbuch	Deutsch
13	ユーザーマニュアル	日本語
19	Manuel de l'utilisateur	Français
25	Manuale d'uso	Italiano
31	Manual del usuario	Español

Apollo S70 Ultra

# User Manual



Model No.: U3800

## WE ARE READY TO HELP



support@ultimea.com  
support.ultimea.com

### Scan code to download app

You can also search for "ULTIMEA" on Google Play or Apple Store to download the app.



Search for "ULTIMEA" on social media.

+1 888-598-8875 (US) Mon-Fri 9am-5pm (PST)  
+49 89-628-25828 (EU) Mon-Fri 9am-5pm (CET)



## 1 ACCESSORIES LIST

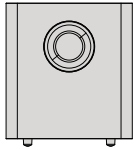

Subwoofer



Left subunit & Right subunit



Center Unit



Surround Speaker x2



Power Adaptor

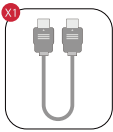

HDMI Cable

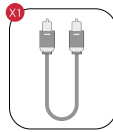

Digital Optical Cable

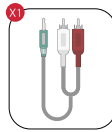

Stereo 3,5mm to RCA Audio Cable

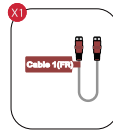

Front Right Cable for Soundbar Connection (2m)



Front Left Cable for Soundbar Connection (2m)

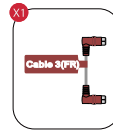

Front Right Cable for Soundbar Connection (150mm)

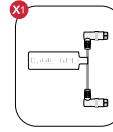

Front Left Cable for Soundbar Connection (150mm)

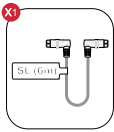

Rear Right Surround Cable(6m)

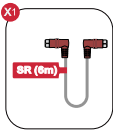

Rear Left Surround Cable(6m)



Wall Mounting Kit



Mounting Screw

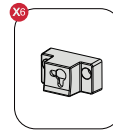

Wall Bracket



Remote Control

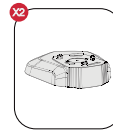

Base



User Manual

## 2 SOUNDBAR CONTROLS

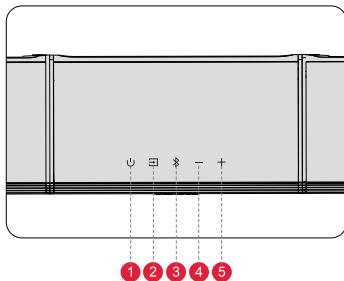

### Control Panel

- 1 "⏻": Power Button**  
Press to power on / standby.
- 2 "📺": Source**  
Press to switch channels: ARC-OPT(OPTICAL)-BT-AUX-USB.
- 3 "📶": Bluetooth**  
Press to switch to BT channel and enter pairing mode. Hold for 3 seconds to disconnect current device and choose to connect to a new device manually on your mobile phone / PC / TV (BT ID: Apollo S70 Ultra).
- 4 "⏮": Volume Down**
- 5 "⏭": Volume Up**

## Remote Control

- 1 "⏻": **Power Button**  
Press to power on / standby.
- 2 "☰": **SOURCE**  
Press to switch channel: ARC-OPT-BT-AUX-USB
- 3 "≡": **ARC**  
Press to switch to HDMI ARC channel.
- 4 "📺": **OPT**  
Press to switch to OPTICAL channel.
- 5 "🎧": **AUX**  
Press to switch to AUX channel.
- 6 "📶": **BT**  
Press to switch to BLUETOOTH channel.
- 7 "🔌": **USB**  
Press to switch to USB channel.
- 8 "🔗": **SUB PAIR**  
Press and hold the button for 3 seconds to put the Soundbar in a state ready to pair with the subwoofer.
- 9 "🔄": **USB REPEAT**  
USB mode: Press to switch between single loop playback and list loop playback.
- 10 "+": **Volume Up**
- 11 "-": **Volume Down**
- 12 "<": **Previous**  
For BT and USB mode only: Skip to previous track.
- 13 ">": **Next**  
For BT and USB mode only: Skip to next track.
- 14 "⏮": **Play / Pause**  
For BT and USB mode only.
- 15 "🔇": **MUTE**
- 16 "💡": **LED DIMMER**  
Press to adjust display brightness in 5 levels. Press and hold for 3s to turn off the LED display.
- 17 "BASS MAX": **BASSMAX™**  
Press to adjust bass level, the display will show: "B5-6", "B5-5", "B5-4", "B5-3", "B5-2", "B5-1", "B5 0", "B5 1", "B5 2", "B5 3", "B5 4", "B5 5", "B5 6".
- 18 "MIDRANGE": **MIDRANGE**  
Press to adjust alto level, the display will show: "MR-6", "MR-5", "MR-4", "MR-3", "MR-2", "MR-1", "MR 0", "MR 1", "MR 2", "MR 3", "MR 4", "MR 5", "MR 6".
- 19 "TREBLE": **TREBLE**  
Press to adjust treble level, the display will show: "T3-6", "T3-5", "T3-4", "T3-3", "T3-2", "T3-1", "T3 0", "T3 1", "T3 2", "T3 3", "T3 4", "T3 5", "T3 6".
- 20 "🎬": **MOVIE**  
Press to switch to MOVIE mode, the display will show: "MOVI".
- 21 "🎵": **MUSIC**  
Press to switch to MUSIC mode, the display will show: "MUSC".
- 22 "🔊": **VOICE**  
Press to switch to VOICE mode, the display will show: "VOIC".
- 23 "🏃": **SPORT**  
Press to switch to SPORT mode, the display will show: "SPRT".
- 24 "🎮": **GAME**  
Press to switch to GAME mode, the display will show: "GAME".
- 25 "🌙": **NIGHT**  
Press to switch to NIGHT mode, the display will show: "NIGT".
- 26 "SURROUND": **SURROUND**  
Press to adjust surround sound level, the display will show: "SR-6", "SR-5", "SR-4", "SR-3", "SR-2", "SR-1", "SR 0", "SR 1", "SR 2", "SR 3", "SR 4", "SR 5", "SR 6".
- 27 "RGB LIGHTING": **RGB LIGHTING**  
Press "+" or "-" to adjust the brightness of RGB lighting effects. Short press the middle button to turn on and switch the lighting effect mode, long press for 3 seconds to turn off the lighting effect.

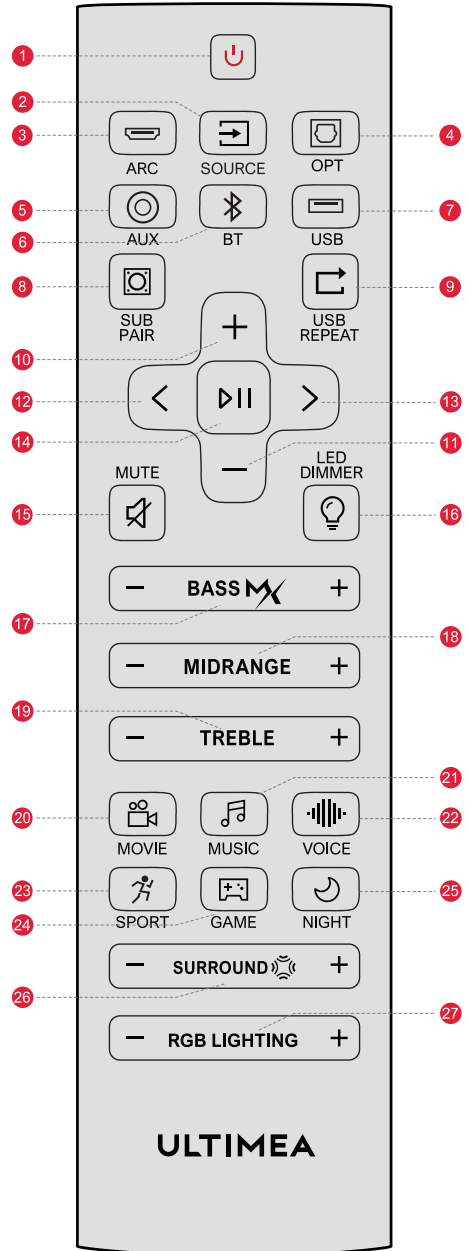

## 3 SOUNDBAR INSTALLATION

### Detached and stand on base:

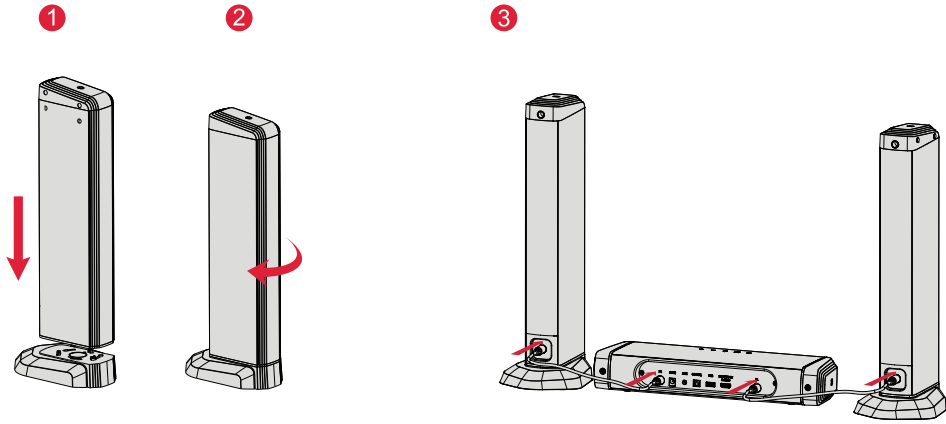

- 1 Set the soundbar on the base and align the joints.
- 2 Twist to connect with the base.
- 3 Plug in the Cable 1(FR) & Cable 2(FL) for Soundbar Connection.

Note: When connecting the cable, the red terminal is plugged into the red port and the white terminal is plugged into the white port.

### Horizontal placement:

- 1 Remove the covers on both sides of the host.

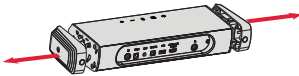

- 2 Align the joints of the three parts.



- 3 Twist to connect.

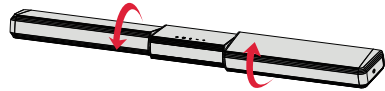

- 4 Plug in the Cable 3(FR) & Cable 4(FL) for Soundbar Connection.



## 4 REAR PANEL

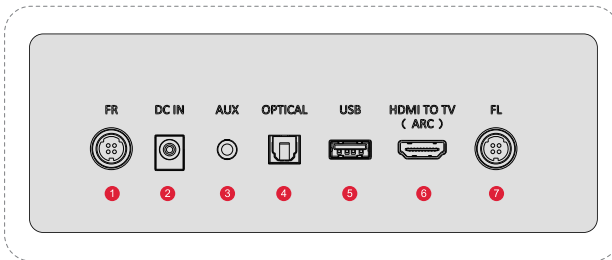

- 1 **FR: FRONT RIGHT**  
Used to connect the auxiliary machine on the right
- 2 **DC IN**
- 3 **AUX**
- 4 **OPTICAL**
- 5 **USB**  
Support MP3 file with 128G max memory
- 6 **HDMI TO TV(ARC)**
- 7 **FL: FRONT LEFT**  
Used to connect the auxiliary machine on the left



## 5 CONNECT TO TV VIA HDMI OUT ARC

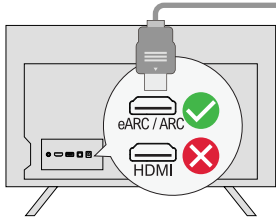

### Step 1:

Connect one end of the HDMI cable to the eARC / ARC port on the back of your TV.

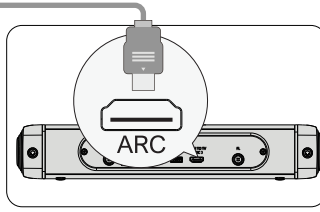

### Step 2:

Then connect the other end into the ARC port of the soundbar.

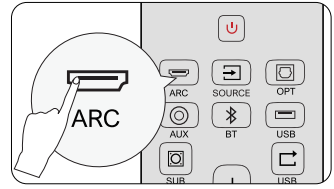

### Step 3:

Press "ARC" button on the remote control to select "ARC" input.

**If there is no sound, try setting the TV audio output to PCM:**

TV Settings > Home > Settings > Sound > Digital Audio Output > PCM

**Note: Please turn on the "CEC" function on your TV.**

When eARC / ARC is connected, your TV remote control can control the soundbar and TV simultaneously:

- ❶ Turn on / standby
- ❷ Adjust the volume

## 6 CONNECT TO TV VIA OPTICAL / AUX

### OPTICAL

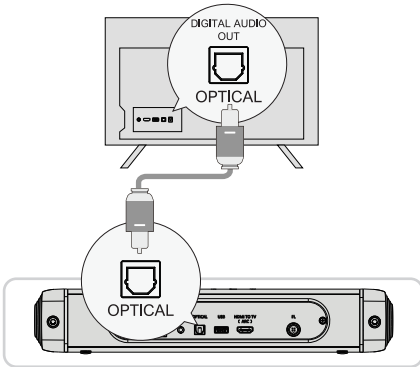

#### OPTION 1: OPTICAL

- ❶ Make sure the TV's port is OPTICAL OUT, connect both sides of the cable to OPTICAL, for both the TV and the soundbar.
- ❷ Make sure the optical plug is inserted correctly as it shows in the picture. Do not insert the plug upside down and break the optical.

**Note:** If audio is coming from the internal TV speakers, mute or minimize the TV volume.

### AUX

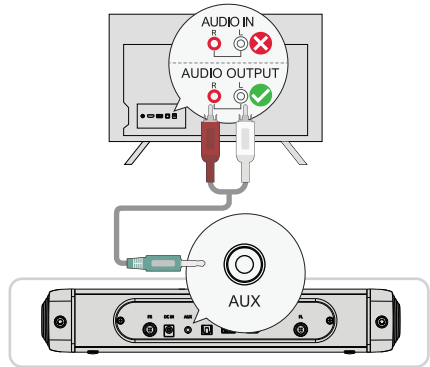

#### OPTION 2: AUX

- ❶ Connect the 3.5mm RCA audio cable to connect to your TV's RCA AUDIO OUT port.
- ❷ Make sure the color of the cables ends matches the color of the TV ports.

**Note:** Please remember to unplug the AUX cable from TV and Soundbar when you want to switch other mode.

**In Optical Mode:** If there is no sound, try setting the TV audio output to PCM: TV Settings > Home > Settings > Sound > Digital Audio Output > PCM

## 7 CONNECT TO BLUETOOTH®

- ❶ Press the "⌘" button on the soundbar or press the "⌘" button on the remote control to enter Bluetooth pairing mode.
- ❷ Go to the Bluetooth setting on your phone, find and select "Apollo S70 Ultra" to connect the soundbar.

**Note:** If it's already in the Bluetooth mode and connected, press and hold "⌘" button for 3 seconds to disconnect current device and choose to connect to a new device manually on your mobile phone / PC / TV.

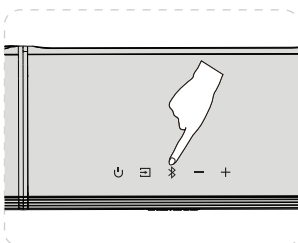

or

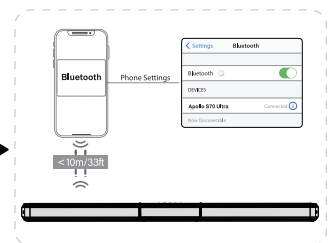
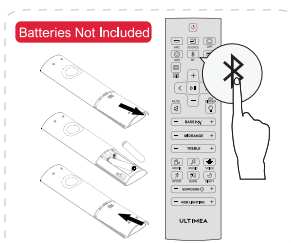

## 8 CONNECT TO SUBWOOFER AND SURROUND SPEAKER

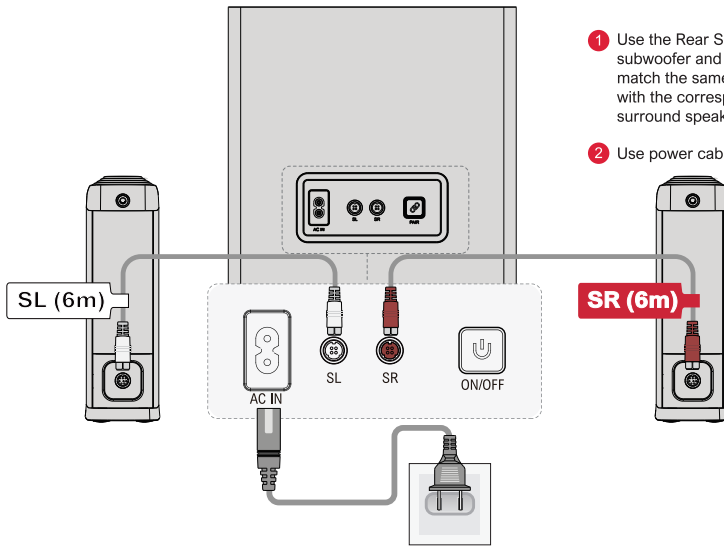

- 1 Use the Rear Surround Cables (SL & SR) to connect the subwoofer and surround speakers, please pay attention to match the same color interfaces on the surround speakers with the corresponding ones on the subwoofer and place the surround speakers accordingly.
- 2 Use power cable to connect your subwoofer and power port.

## 9 PAIRING SUBWOOFER

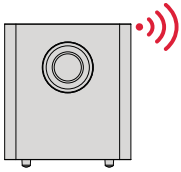

The subwoofer has been paired with the soundbar by factory.  
If there is no sound coming from the subwoofer, you need to re-pair the soundbar with the subwoofer.

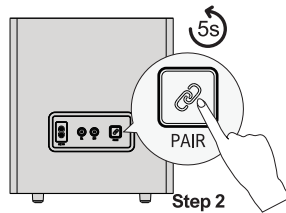

### Step 1:

Press and hold the "SUB PAIR" button on the remote control for 3 seconds, the display will show "5JJ" flashing.

### Step 2:

Press and hold the PAIR button on subwoofer for 5 seconds, the white LED will be fast flashing.  
The white LED will be always on when the subwoofer is paired successfully.

## 10 PLACEMENT OPTIONS

### Detached and stand on base

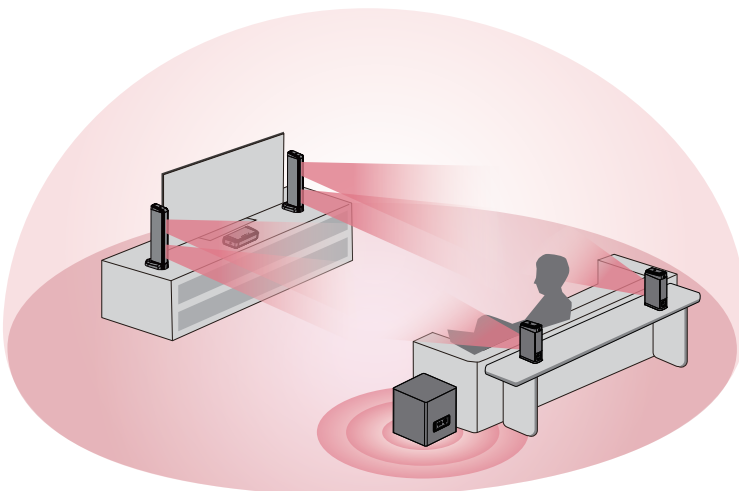

## Horizontal placement

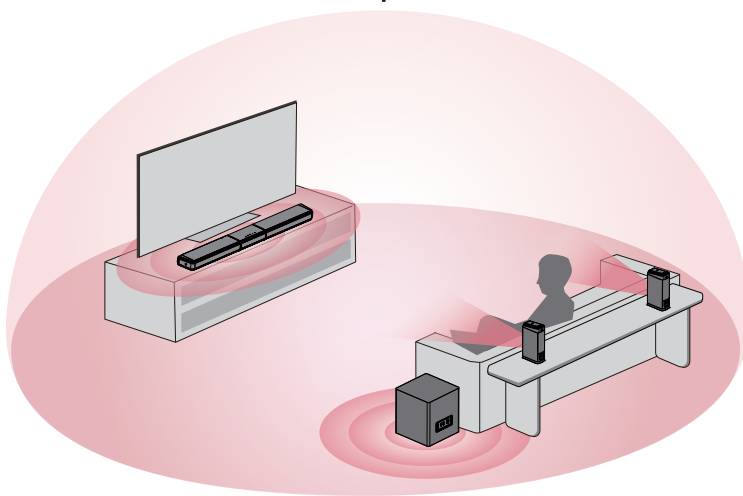

**Note:** The soundbar should be placed at or near ear level.

## 11 WALL MOUNT INSTALLATION

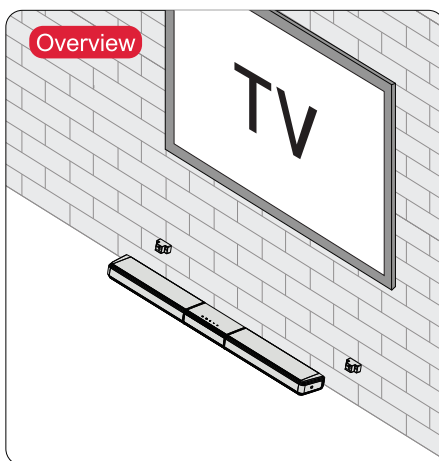
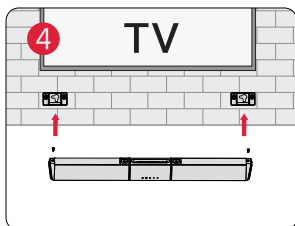
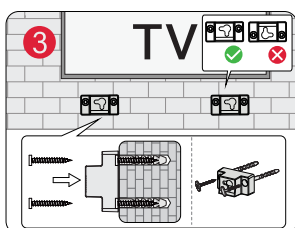
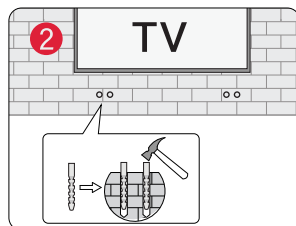
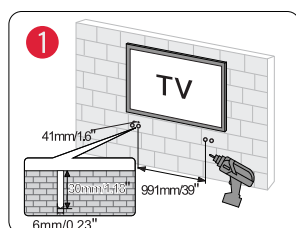

## 12 SPECIFICATIONS

<b>Model Number</b>	U3800
<b>Power Supply</b>	DC18V $\approx$ 3A(Soundbar) / AC 100 - 240V~ 50/60Hz(Subwoofer)
<b>Soundbar Drivers</b>	2" x 5(Soundbar) + 2" x 2(Surround Speaker) + 6.5"(Subwoofer)
<b>Frequency Response</b>	55Hz - 18kHz
<b>Auto Standby</b>	The soundbar will turn to standby mode if there is no audio signal for 4 hours. You can set the standby time in the App.
<b>Standby Power</b>	<0.5W
<b>Operating Temperature</b>	0°C - 35°C / 32°F - 95°F
<b>Bluetooth Version</b>	5.3
<b>Soundbar</b>	1072 (W) x 107 (D) x 58 (H) / 42.2" (W) x 4.21" (D) x 2.28" (H)
<b>Subwoofer</b>	232 (W) x 232 (D) x 264 (H) / 9.13" (W) x 9.13" (D) x 10.39" (H)
<b>Surround Speaker</b>	198 (W) x 112 (D) x 60 (H) / 7.8" (W) x 4.41" (D) x 2.36" (H)
<b>Packaging</b>	468 (W) x 298 (D) x 488 (H) / 18.43" (W) x 11.73" (D) x 19.21" (H)
<b>Net Weight</b>	4.6kg / 10.14lbs
<b>Gross Weight</b>	6.7kg / 14.77lbs



# IMPORTANT SAFETY INSTRUCTIONS

**EN**

## SAFETY INSTRUCTIONS

**Please read this user manual carefully and save it for future reference.**

Do not make unauthorized alterations to the product, doing so may compromise safety, regulatory compliance, system performance, and may void the warranty.

Avoid dropping.

Do not disassemble.

Do not submerge in water.

Avoid extreme temperatures.

Do not use the device outdoors during thunderstorms.

Use original or certified cables.

Do not place dangerous items on top of this device (e.g. liquid filled objects, lit candles).

Clean with a dry, soft lint-free cloth. Do not use any corrosive cleaner or oil.

To avoid hearing damage, do not listen for extended periods at high volume.

Do not expose the batteries to extreme heat sources such as direct sunlight or open flames.

The ideal operating temperature for this product and its accessories is between 41°F/5°C and 95°F/35°C.

The adapter should be installed near the device and should be easily accessible.

Do not use this product in environments of extreme heat or cold. Never expose this device to strong sunshine or wet environments.

## PROPER DISPOSAL INSTRUCTIONS



This mark shown on the product or its packaging, indicates that this product should not be disposed of with other household waste at the end of its working life.

To prevent possible harm to the environment or human health from uncontrolled waste disposal, please separate this from other types of wastes and recycle it responsibly to promote the sustainable reuse of material resources.

## Waste Electrical & Electronic Equipment

Household user should contact either the retailer where they purchased this product, or their local government office, for details of where and how they can take this item for environmentally safe recycling.

Business users should contact their suppliers and check the terms and conditions of the purchase contract. This product should not be mixed with other commercial wastes for disposal.

## FCC REGULATORY COMPLIANCE

Any changes or modifications not expressly approved by the party responsible for compliance could void the user's authority to operate the equipment.

This device complies with Part 15 of the FCC Rules.

Operation is subject to the following two conditions:

(1) This device may not cause harmful interference.

(2) This device must accept any interference received, including interference that may cause undesired operation.

NOTE: This equipment has been tested and found to comply with the limits for a Class B digital device, pursuant to part 15 of the FCC Rules. These limits are designed to provide reasonable protection against harmful interference in a residential installation. This equipment generates, uses, and can radiate radio frequency energy, and if not installed and used in accordance with the instructions, may cause harmful interference to radio communications.

However, there is no guarantee that interference will not occur in a particular installation. If this equipment does cause harmful interference to radio or television reception, which can be determined by turning the equipment off and on, the user is encouraged to try to correct the interference by one or more of the following measures:

- Reorient or relocate the receiving antenna.

- Increase the separation between the equipment and the receiver.

- Connect the equipment to an outlet on a circuit different from that to which the receiver is connected.

- Consult the dealer or an experienced radio / TV technician for help.

This equipment complies with FCC radiation exposure limits set forth for an uncontrolled environment. This equipment should be installed and operated with a minimum distance of 20cm between the radiator & your body. This transmitter must not be co-located or operating in conjunction with any other antenna or transmitter.

## CE WARNINGS

1) Do not install this equipment in a confined or building-in space such as a book case or similar unit, and remain a well ventilation conditions. The ventilation should not be impeded by covering the ventilation openings with items such as newspaper, table-cloths, curtains etc.

2) WARNING: To reduce the risk of fire or electric shock, do not expose this apparatus to rain or moisture. The apparatus shall not be exposed to dripping or splashing and that objects filled with liquids, such as vases, shall not be placed on apparatus.

3) WARNING: The adapter plug is used as disconnect device, the disconnect device shall remain readily operable.

5) Frequency: 2.402GHz-2.48GHz

6) The Max. transmit power: 10 dBm

## ISED WARNINGS

This device contains licence-exempt transmitter (s) / receiver (s) that comply with Innovation, Science and Economic Development Canada's licence-exempt RSS (s). Operation is subject to the following two conditions:

(1) This device may not cause interference.

(2) This device must accept any interference, including interference that may cause undesired operation of the device.

The device meets the exemption from the routine evaluation limits in section 2.5 of RSS 102 and compliance with RSS-102 RF exposure, users can obtain Canadian information on RF exposure and compliance.

This transmitter must not be co-located or operating in conjunction with any other antenna or transmitter. This equipment should be installed and operated with a minimum distance of 20 centimeters between the radiator and your body.

**DE**

## SICHERHEITSANWEISUNGEN

**Bitte lesen Sie dieses Benutzerhandbuch sorgfältig durch und bewahren Sie es für zukünftige Referenz auf.**

Nehmen Sie keine unbefugten Änderungen am Produkt vor, da dies die Sicherheit, die Einhaltung von Vorschriften, die Systemleistung gefährden und die Garantie erlöschen lassen kann.

Nicht fallen lassen.

Nicht zerlegen.

Nicht in Wasser tauchen.

Extreme Temperaturen vermeiden.

Verwenden Sie das Gerät bei Gewittern nicht im Freien.

Verwenden Sie originale oder zertifizierte Kabel.

Platzieren Sie keine gefährlichen Gegenstände auf diesem Gerät (z. B. flüssigkeitsgefüllte Gegenstände, brennende Kerzen).

Reinigen Sie mit einem trockenen, weichen, fusselfreien Tuch. Verwenden Sie keine korrosiven Reiniger oder Öle.

Um Hörschäden zu vermeiden, hören Sie nicht über längere Zeiträume mit hoher Lautstärke.

Setzen Sie die Batterien keiner extremen Hitze wie direktem Sonnenlicht oder offenen Flammen aus.

Die ideale Betriebstemperatur für dieses Produkt und seine Zubehörteile liegt zwischen 5°C (41°F) und 35°C (95°F).

Der Adapter sollte in der Nähe des Geräts installiert und leicht zugänglich sein.

Verwenden Sie dieses Produkt nicht in extrem heißen oder kalten Umgebungen. Setzen Sie dieses Gerät niemals direktem Sonnenlicht oder feuchten Umgebungen aus.

## ANWEISUNGEN ZUR ORDNUNGSGEMÄSSEN ENTSORGUNG



Dieses Zeichen auf dem Produkt oder seiner Verpackung weist darauf hin, dass dieses Produkt am Ende seiner Lebensdauer nicht mit dem normalen Haushaltsabfall entsorgt werden darf. Um mögliche Schäden für die Umwelt oder die menschliche Gesundheit durch unkontrollierte Abfallentsorgung zu vermeiden, trennen Sie dieses Produkt von anderen Abfällen und recyceln Sie es verantwortungsbewusst, um die nachhaltige Wiederverwendung von Materialressourcen zu fördern.

## Elektro- und Elektronik-Altgeräte

Privathaushalte sollten sich entweder an den Händler wenden, bei dem sie dieses Produkt gekauft haben, oder an ihre örtliche Gemeindeverwaltung, um Informationen darüber zu erhalten, wo und wie sie dieses Gerät für ein umweltfreundliches Recycling abgeben können. Geschäftskunden sollten sich an ihre Lieferanten wenden und die Geschäftsbedingungen des Kaufvertrags überprüfen. Dieses Produkt darf nicht mit anderem gewerblichen Abfall zur Entsorgung vermischt werden.

## CE-WARNHINWEISE

1) Installieren Sie dieses Gerät nicht in einem geschlossenen oder eingebauten Raum wie einem Bücherregal oder ähnlichem und achten Sie auf ausreichende Belüftung. Die Belüftung darf nicht durch Abdeckung der Lüftungsöffnungen mit Gegenständen wie Zeitungen, Tischdecken, Vorhängen usw. behindert werden.

2) WARNUNG: Um das Risiko von Feuer oder elektrischem Schlag zu verringern, setzen Sie dieses Gerät nicht Regen oder Feuchtigkeit aus. Das Gerät darf nicht tropfendem oder spritzendem Wasser ausgesetzt werden, und es dürfen keine mit Flüssigkeiten gefüllten Gegenstände, wie z. B. Vasen, auf dem Gerät platziert werden.

3) WARNUNG: Der Adapterstecker wird als Trennvorrichtung verwendet, die Trennvorrichtung muss leicht zu bedienen sein.

5) Frequenz: 2,402 GHz - 2,48 GHz

6) Maximale Sendeleistung: 10 dBm

## ISED-WARNHINWEISE

Dieses Gerät enthält lizenzfreie Sender / Empfänger, die den lizenzfreien RSS (s) von Innovation, Science and Economic Development Canada entsprechen. Der Betrieb unterliegt den folgenden zwei Bedingungen:

(1) Dieses Gerät darf keine Interferenzen verursachen.

(2) Dieses Gerät muss alle empfangenen Interferenzen akzeptieren, einschließlich solcher, die zu einem unerwünschten Betrieb des Geräts führen können.

Das Gerät entspricht den Ausnahmen von den routinemäßigen Bewertungslimits in Abschnitt 2.5 von RSS 102 und der Einhaltung der RSS-102-HF-Exposition. Benutzer können kanadische Informationen zur HF-Exposition und -Einhaltung erhalten. Dieser Sender darf nicht zusammen mit einer anderen Antenne oder einem anderen Sender aufgestellt oder betrieben werden. Dieses Gerät sollte mit einem Mindestabstand von 20 Zentimetern zwischen dem Strahler und Ihrem Körper installiert und betrieben werden.

**FR**

## INSTRUCTIONS DE SÉCURITÉ

**Veillez lire attentivement ce manuel d'utilisation et le conserver pour une référence future.**

Ne procédez à aucune modification non autorisée du produit, car cela pourrait compromettre la sécurité, la conformité réglementaire, les performances du système et annuler la garantie.

Évitez de laisser tomber.

Ne démontez pas.

Ne plongez pas dans l'eau.

Évitez les températures extrêmes.

N'utilisez pas l'appareil à l'extérieur pendant les orages.

Utilisez des câbles d'origine ou certifiés.

Ne placez pas d'objets dangereux sur cet appareil (par exemple, des objets remplis de liquide, des bougies allumées).

Nettoyez avec un chiffon doux et sec, non pelucheux. N'utilisez pas de nettoyant corrosif ni d'huile.

Pour éviter d'endommager votre audition, n'écoutez pas pendant de longues périodes à volume élevé.

Ne pas exposer les piles à des sources de chaleur extrême, telles que la lumière directe du soleil ou les flammes nues.

La température de fonctionnement idéale pour ce produit et ses accessoires se situe entre 5°C (41°F) et 35°C (95°F).

L'adaptateur doit être installé près de l'appareil et doit être facilement accessible.

N'utilisez pas ce produit dans des environnements de chaleur ou de froid extrêmes. N'exposez jamais cet appareil à un fort ensoleillement ou à des environnements humides.

## ISTRUZIONI DE MISE AU REBUT APPROPRIÉE



Ce symbole, indiqué sur le produit ou son emballage, indique que ce produit ne doit pas être éliminé avec les autres déchets ménagers à la fin de sa durée de vie. Pour éviter tout dommage possible à l'environnement ou à la santé humaine causé par une élimination incontrôlée des déchets, veuillez le séparer des autres types de déchets et le recycler de manière responsable pour promouvoir la réutilisation durable des ressources matérielles.

## Déchets d'équipements électriques et électroniques

Les utilisateurs domestiques doivent contacter soit le détaillant où ils ont acheté ce produit, soit leur bureau gouvernemental local, pour obtenir des informations sur l'endroit et la manière dont ils peuvent apporter cet article pour un recyclage respectueux de l'environnement. Les utilisateurs professionnels doivent contacter leurs fournisseurs et vérifier les termes et conditions du contrat d'achat. Ce produit ne doit pas être mélangé avec d'autres déchets commerciaux pour l'élimination.

### AVERTISSEMENTS CE

- 1) N'installez pas cet équipement dans un espace confiné ou intégré comme une bibliothèque ou une unité similaire, et maintenez des conditions de ventilation adéquates. La ventilation ne doit pas être obstruée en recouvrant les ouvertures de ventilation avec des articles tels que des journaux, des nappes, des rideaux, etc.
- 2) AVERTISSEMENT : Pour réduire le risque d'incendie ou de choc électrique, n'exposez pas cet appareil à la pluie ou à l'humidité. L'appareil ne doit pas être exposé à l'égouttement ou aux éclaboussures, et aucun objet rempli de liquide, tel qu'un vase, ne doit être placé sur l'appareil.
- 3) AVERTISSEMENT : La fiche de l'adaptateur est utilisée comme dispositif de déconnexion, le dispositif de déconnexion doit rester facilement opérationnel.
- 5) Fréquence : 2,402 GHz - 2,48 GHz
- 6) Puissance de transmission maximale : 10 dBm

### AVERTISSEMENTS ISED

Cet appareil contient des émetteurs/récepteurs exemptés de licence conformes aux RSS exemptés de licence d'Innovation, Science et Développement économique Canada. Le fonctionnement est soumis aux deux conditions suivantes :

- (1) Cet appareil ne doit pas causer d'interférences.
  - (2) Cet appareil doit accepter toute interférence, y compris celles pouvant entraîner un fonctionnement indésirable de l'appareil.
- L'appareil respecte l'exemption des limites d'évaluation de routine dans la section 2.5 de la RSS 102 et la conformité à l'exposition RF de la RSS-102, les utilisateurs peuvent obtenir des informations canadiennes sur l'exposition RF et la conformité. Cet émetteur ne doit pas être co-localisé ou fonctionner conjointement avec une autre antenne ou un autre émetteur. Cet équipement doit être installé et utilisé avec une distance minimale de 20 centimètres entre le radiateur et votre corps.



## ISTRUZIONI DI SICUREZZA

**Si prega di leggere attentamente questo manuale utente e conservarlo per riferimenti futuri.**

Non apportare modifiche non autorizzate al prodotto, poiché ciò potrebbe compromettere la sicurezza, la conformità normativa, le prestazioni del sistema e potrebbe annullare la garanzia.

Evitare cadute.

Non smontare.

Non immergere in acqua.

Evitare temperature estreme.

Non utilizzare il dispositivo all'aperto durante i temporali.

Utilizzare cavi originali o certificati.

Non posizionare oggetti pericolosi sopra questo dispositivo (ad es. oggetti pieni di liquido, candele accese).

Pulire con un panno morbido e asciutto, privo di lanugine. Non utilizzare detergenti corrosivi o olio.

Per evitare danni all'udito, non ascoltare a volume elevato per lunghi periodi.

Non esporre le batterie a fonti di calore estremo come la luce solare diretta o fiamme libere.

La temperatura di funzionamento ideale per questo prodotto e i suoi accessori è compresa tra 5°C (41°F) e 35°C (95°F).

L'adattatore dovrebbe essere installato vicino al dispositivo e facilmente accessibile.

Non utilizzare questo prodotto in ambienti di caldo o freddo estremo. Non esporre mai questo dispositivo a forte luce solare o ambienti umidi.

### ISTRUZIONI PER LO SMALTIMENTO CORRETTO



Questo simbolo, mostrato sul prodotto o sul suo imballaggio, indica che questo prodotto non deve essere smaltito con altri rifiuti domestici alla fine della sua vita utile. Per evitare possibili danni all'ambiente o alla salute umana causati dallo smaltimento incontrollato dei rifiuti, si prega di separarlo dagli altri tipi di rifiuti e di riciclarlo responsabilmente per promuovere il riutilizzo sostenibile delle risorse materiali.

### Rifiuti di apparecchiature elettriche ed elettroniche

Gli utenti domestici devono contattare il rivenditore presso cui hanno acquistato questo prodotto o l'ufficio governativo locale per dettagli su dove e come possono portare questo articolo per un riciclaggio rispettoso dell'ambiente. Gli utenti aziendali devono contattare i loro fornitori e controllare i termini e le condizioni del contratto di acquisto. Questo prodotto non deve essere mescolato con altri rifiuti commerciali per lo smaltimento.

### AVVERTENZE CE

- 1) Non installare questo apparecchio in uno spazio chiuso o incorporato, come una libreria o un'unità simile, e mantenere condizioni di ventilazione adeguate. La ventilazione non deve essere ostacolata coprendo le aperture di ventilazione con oggetti come giornali, tovaglie, tende, ecc.
- 2) AVVERTENZA: per ridurre il rischio di incendio o scossa elettrica, non esporre questo apparecchio alla pioggia o all'umidità. L'apparecchio non deve essere esposto a gocciolamenti o spruzzi e nessun oggetto pieno di liquido, come vasi, deve essere posizionato sull'apparecchio.
- 3) AVVERTENZA: La spina dell'adattatore viene utilizzata come dispositivo di disconnessione, il dispositivo di disconnessione deve rimanere facilmente operabile.
- 5) Frequenza: 2,402 GHz - 2,48 GHz
- 6) Potenza massima di trasmissione: 10 dBm