

USER MANUAL HT RQ1

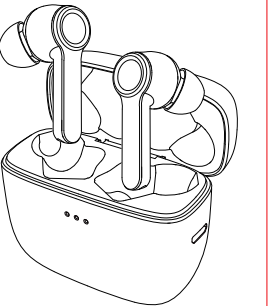

DEVICE LAYOUT

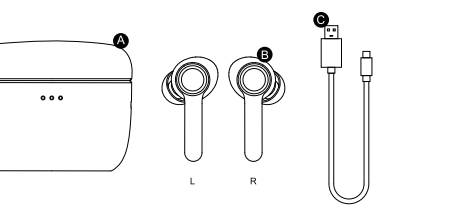

A Charging Case X1 B Earphones X1 C Type-c Cable X1

* This product is equipped with different types of ear tips. Different users should choose suitable ear tips to wear.
(Rcture8 are for refererca only.)

OPERATION GUIDELINE

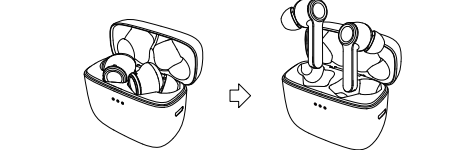

POWER ON: Uncover the charging case, the earphones will turn on automatically.

POWER OFF: Put the earphones back into the charging case and dose the cover, they will automatically turn off and start charging.

EARPHONES PAIRING: The earphones will automatically pair to each other after the cover is open when they are in the case.

* Note: Above functions are available for either earphone in individual or stereo mode.

BLUETOOTH PAIRING TO THE DEVICE

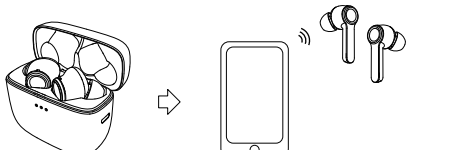

- 1.To connect to your device during first use, turn the earphones on to enter pairing mode.
- 2.Enable Bluetooth function on your device, connect the "HT RQ1". You will hear "Connected*" in a voice. Connection is succeeded.
- 3.After first successful pairing, earphones will automatically connect to your device.
- 4.To pair with a new device, put earphones back into the case, unpair the original device at first.

Note: Above functions are available for either earphone in individual or stereo mode.

CHARGING METHODS

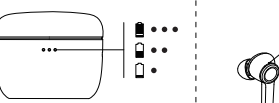

With the Type-c cable, a full charge will take around 2 hours. And the 3 LED lighting of charging case indicates full battery.

Tips
Please fully charge the battery before first use.
If the earphones have been unused for more than 3 months, we recommend that you charge them. This will improve battery capacity.

BATTERY NOTIFICATION

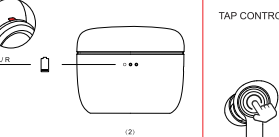

When the battery is low on earphones, the LED indicator will flash red, you will hear the notification sound "Low Battery".
When case battery is too low on charge, there is only 1 LED indicator flashing.

TAP CONTROLS

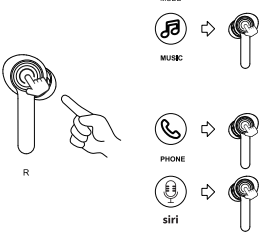

MODE	TAPPING COUNT
MUSIC	X1 L/R: Pause/ Play X2 L: Previous track X2 R: Next track X3 L:Volume - X3 R:Volume +
PHONE	X1 L/R: Answer/ Hang up X2 L/R: Reject
siri	L/R:Hold down for 2 seconds

Important Safety Information

1. Don't use the headphone at a high volume for any extended period.
-To avoid hearing damage, use your headphones at a comfortable, moderate volume level.
-Turn the volume down on your device before placing the headphones in your ears, then turn the volume up gradually until you reach a comfortable listening level.
- 2.This device complies with Part 15 of the FCC Rules. Operation is subject to the following two conditions:
(1) this device may not cause harmful interference, and
(2) this device must accept any interference received, including interference that may cause undesired operation.

FCC Caution:

This device complies with part 15 of the FCC Rules. Operation is subject to the following two conditions: (1) This device may not cause harmful interference, and (2) this device must accept any interference received, including interference that may cause undesired operation.

Any changes or modifications not expressly approved by the party responsible for compliance could void the user's authority to operate the equipment.

NOTE: This equipment has been tested and found to comply with the limits for a Class B digital device, pursuant to Part 15 of the FCC Rules. These limits are designed to provide reasonable protection against harmful interference in a residential installation. This equipment generates, uses and can radiate radio frequency energy and, if not installed and used in accordance with the instructions, may cause harmful interference to radio communications. However, there is no guarantee that interference will not occur in a particular installation.

If this equipment does cause harmful interference to radio or television reception,

which can be determined by turning the equipment off and on, the user is encouraged to try to correct the interference by one or more of the following measures:

-- Reorient or relocate the receiving antenna.

-- Increase the separation between the equipment and receiver.

-- Connect the equipment into an outlet on a circuit different

from that to which the receiver is connected.

-- Consult the dealer or an experienced radio/TV technician for help.

The device has been evaluated to meet general RF exposure requirement. The device can be used in portable exposure condition without restriction.