

D2-6X Quick Start Manual



Product Overview



Important Reminder:
Before installing the headset, please connect your cell phone according to the quick manual guide to test the sound effect and volume.
If there is a big difference in sound effect and volume after installing into the helmet, please adjust the position of the speaker inside the helmet.

1-channel-5 intercom pairing mode of operation

When making a 1-out-5 intercom connection, it is recommended that you use your cell phone to connect to Bluetooth before making the intercom connection.

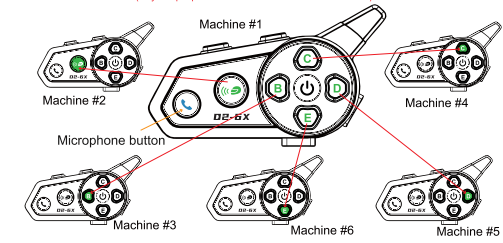
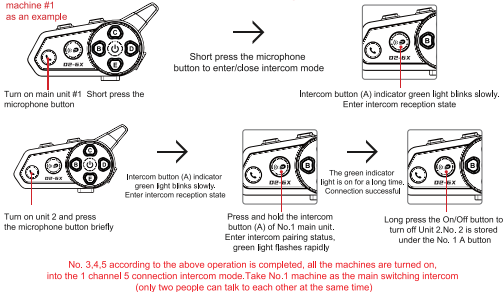

Introduction to Bluetooth intercom connection operation (intercom and music sharing are turned off by default every time you turn on the power).

1 channel 5 connection intercom (intercom button (A) / B / C / D / E button function)
After the machine is turned on, short press the microphone button to enter the intercom mode, the following has been a machine connection as an example (hereinafter referred to as No. 1,2,3,4,5,6), the connection operation is as follows (No. 1 machine is the host connection).
Power on the first to open the No. 1 machine, short press the microphone button, so that the No. 1 machine into the intercom mode, intercom button (A) indicator green light flashes slowly into the intercom receiving state, open the No. 2 machine, short press the microphone button to enter the intercom mode, intercom button (A) indicator green light flashes slowly, into the intercom receiving state, long press the No. 1 intercom key (A) to enter the intercom pairing state, the No. 2 machine to keep motionless, after the connection is successful, the green light When the connection is successful, the green indicator light is on, the connection is successful, at this time, long press the on/off button to turn off the No.2 machine, the No.2 machine will be stored in the No.1 machine under the A button.
No.1 host is not turned off, keep in intercom mode state, turn on No.3 machine and turn on the machine, short press the microphone key to make it enter into intercom receiving mode, at this time, long press No.1 machine B key, enter into intercom pairing state, after connecting successfully, the green indicator light will be on long time, the connection is successful, turn off the No.3 machine, the No.3 machine will be stored in the No.1 machine under the B key.
No.1 host does not turn off the power, keeps in the intercom mode state, turn on No.4 machine, short press the microphone key to make it enter the intercom receiving mode, at this time, long press the No.1 machine C key, enter the intercom pairing state, after connecting successfully, the green indicator light is on, the connection is successful, turn off the No.4, the No.4 machine will be stored in the No.1 machine under the C key.
No.1 host does not turn off the power, keep in the intercom mode state, open the No.5 machine on, short press the microphone key to make it enter the intercom receiving mode, at this time, long press the No.1 machine D key, enter the intercom pairing state, after connecting successfully, the green indicator light is on, the connection is successful, turn off the No.5, No.5 is stored in the No.1 machine under the D key.
No.1 host does not turn off the machine, keep in the intercom mode state, open the No.6 machine boot, short press the microphone key to make it enter the intercom receiving mode, at this time, long press the No.1 machine E key, enter the intercom pairing state, connect successfully, the green indicator light is on, the connection is successful, turn off the No.6 machine, the No.6 machine will be stored in the No.1 machine under the E key.
According to the above operation is completed, all the machines are turned on, enter the intercom mode, with the No.1 machine as the main switching intercom (each time only two people at the same time intercom calls)
When machine 1 wants to talk to machine 2, press A key of machine 1 to connect back to machine 2; when machine 1 wants to talk to machine 3, press B key of machine 1 to connect back to machine 3;
If No.1 wants to talk to No.4, press No.1's C key briefly to return to No.4; if No.1 wants to talk to No.5, press No.1's D key briefly to return to No.5;
If machine 1 wants to talk to machine 6 at this time, press the E key of machine 1 to connect back to machine 6; if several other machines switch the call, repeat the operation of machine 1 to realize this function!

Intercom button (A)/B/C/D/E

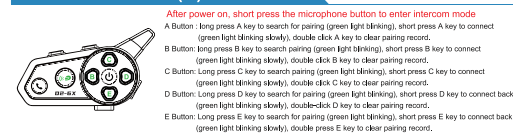

Connecting to third parties

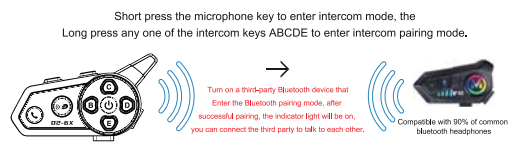

Reset intercom

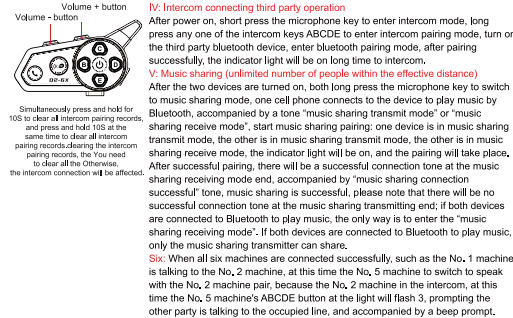
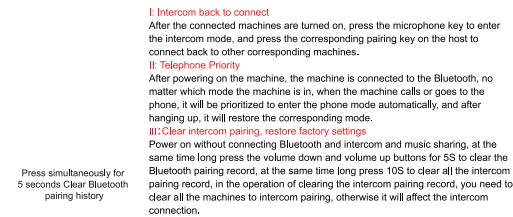

Power on/off



Bluetooth connection

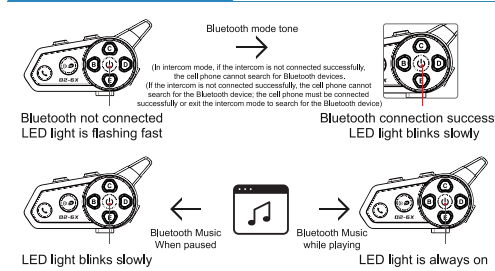

Music features

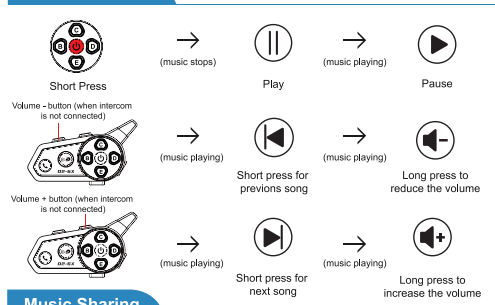

Music Sharing

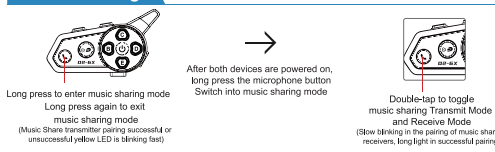

Charging function

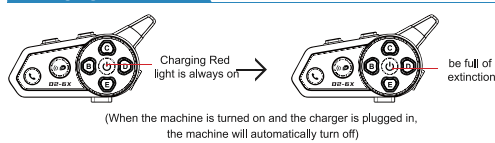

Mixing function

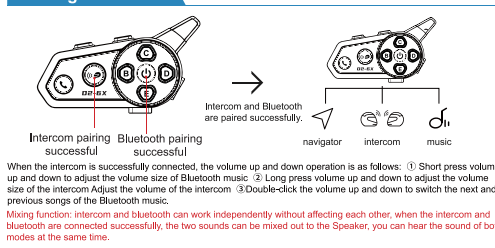

Telephone function

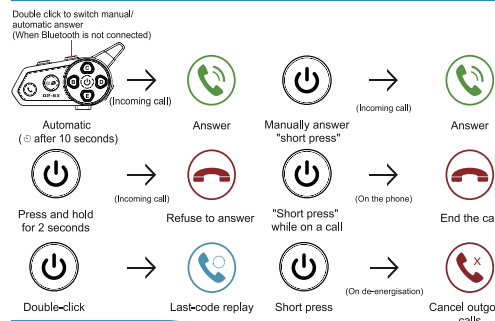

Voice assistant

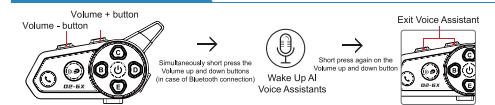

Music Sharing Pairing

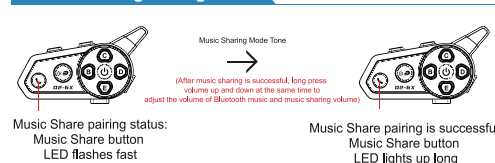

Product List

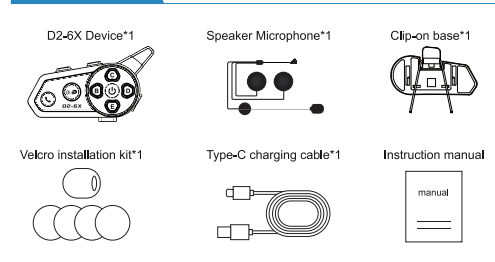

Caveat

- Please do not put the product into the open fire to avoid explosion;
- Please do not disassemble the product to avoid damage to the product's electronic devices;
- Please do not close to sharp objects to cause damage to the product;
- Long time not used, please place in a dry place;
- Before using the Bluetooth device, please fully charge it;
- If the red light does not come on when charging, it may be the voltage is too low;
- To extend the life of the built-in polymer battery, please charge the device at least once a month.

Instruction warning

NOTE: This equipment has been tested and found to comply with the limits for a Class B digital device, pursuant to part 15 of the FCC Rules. These limits are designed to provide reasonable protection against harmful interference in a residential installation. This equipment generates uses and can radiate radio frequency energy and, if not installed and used in accordance with the instructions may cause harmful interference to radio communications. However, there is no guarantee that interference will not occur in a particular installation. If this equipment does cause harmful interference to radio or television reception, which can be determined by turning the equipment off and on, the user is encouraged to try to correct the interference by one or more of the following measures.

- Reorient or relocate the receiving antenna.
- Increase the separation between the equipment and receiver.
- Connect the equipment into an outlet on a circuit different from that to which the receiver is connected.
- Consult the dealer or an experienced radio/TV technician for help.

Changes or modifications not expressly approved by the party responsible for compliance could void the user's authority to operate this equipment. This device complies with Part 15 of the FCC Rules. Operation is subject to the following two conditions.
(1) This device may not cause harmful interference.
(2) This device must accept any interference received, including interference that may cause undesired operation.

